

# Ground Floor

Approx. 69.8 sq. metres (750.9 sq. feet)

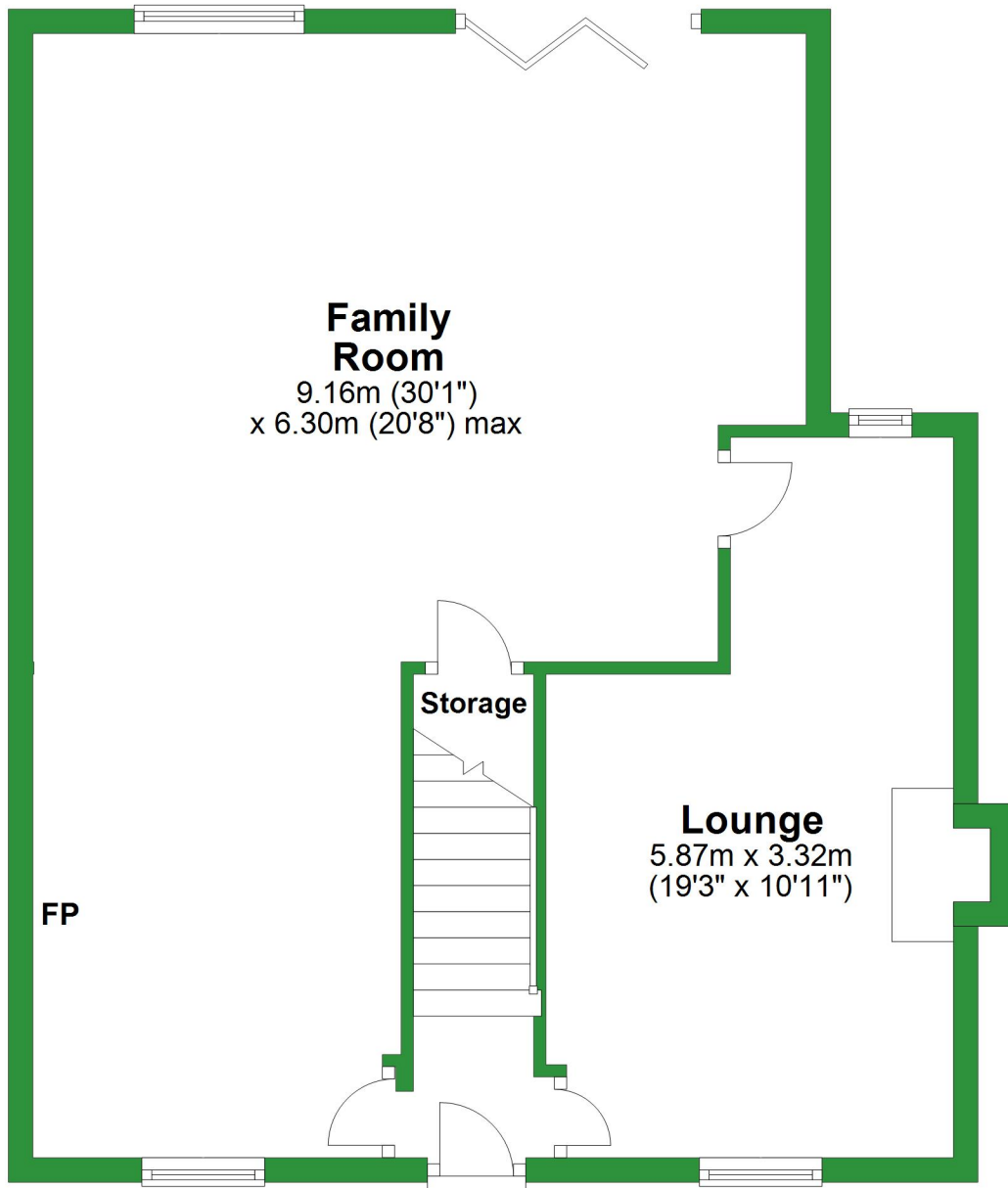

Total area: approx. 147.2 sq. metres (1584.1 sq. feet)

For illustrative purposes only. Not to scale. All sizes are approximate.

Plan produced using PlanUp.

## First Floor

Approx. 43.9 sq. metres (472.7 sq. feet)

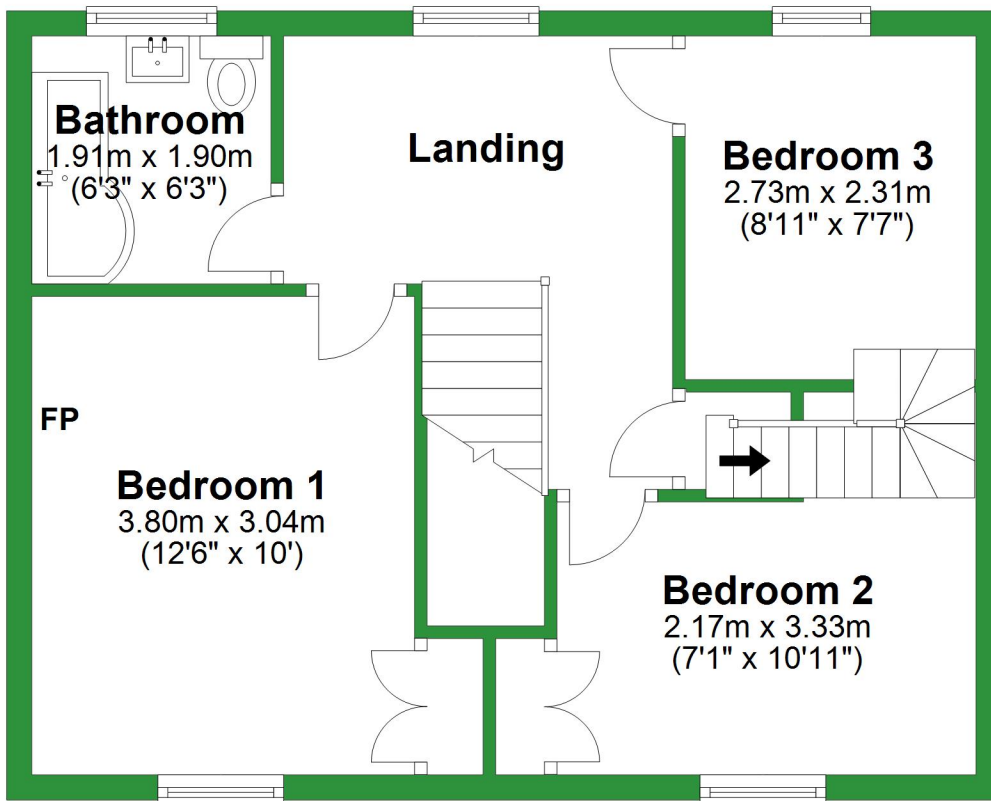

## Second Floor

Approx. 33.5 sq. metres (360.5 sq. feet)

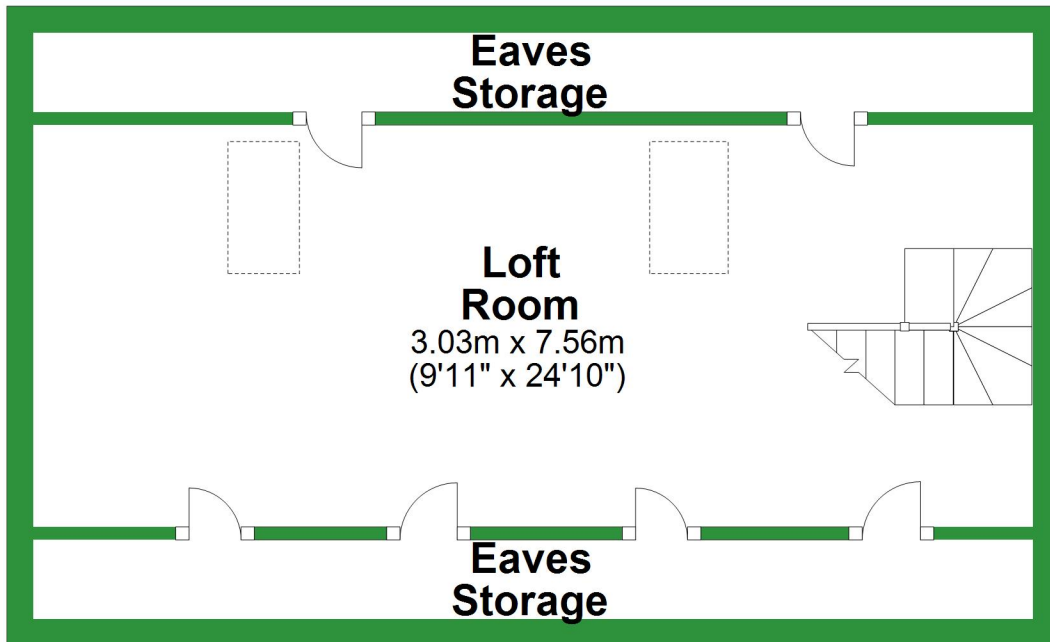

## Ground Floor

Approx. 69.8 sq. metres (750.9 sq. feet)

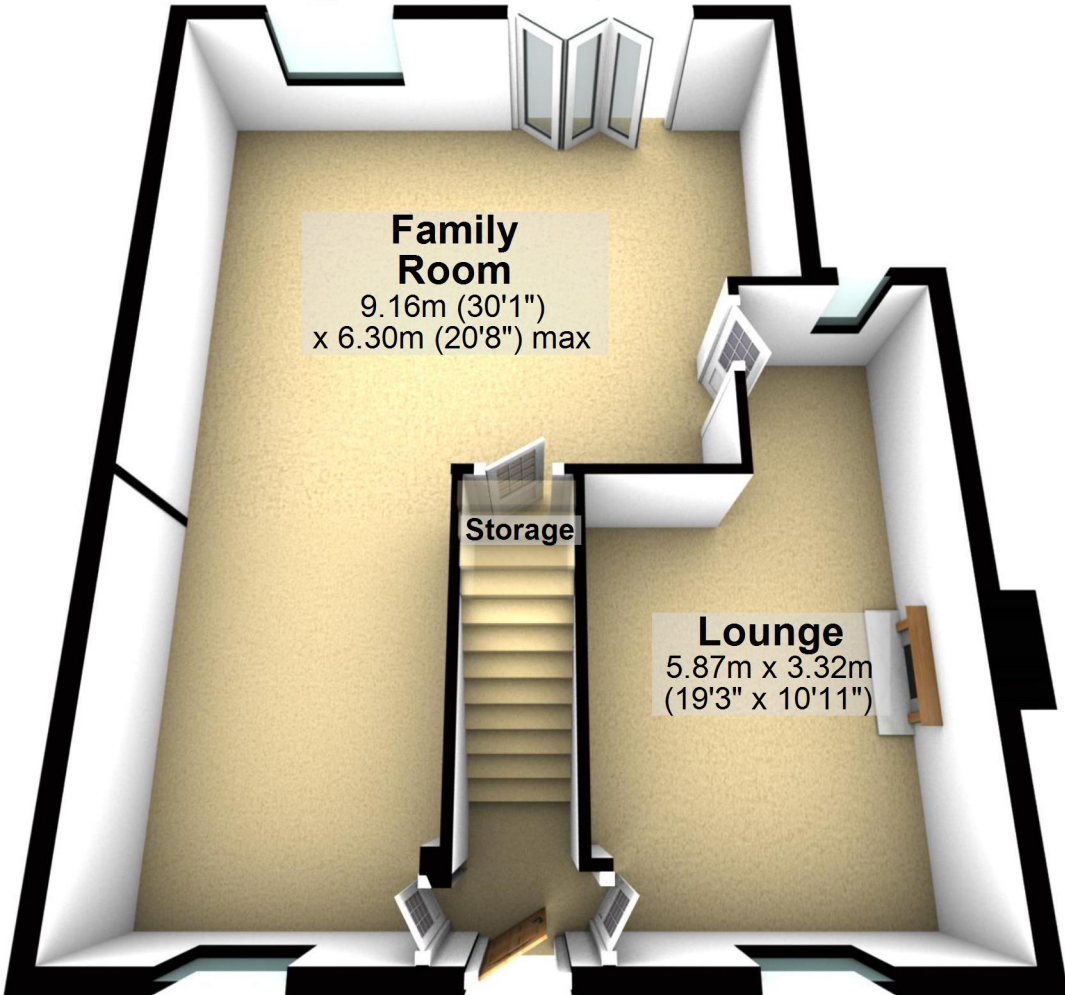

Total area: approx. 147.2 sq. metres (1584.1 sq. feet)

For illustrative purposes only. Not to scale. All sizes are approximate.

Plan produced using PlanUp.

# First Floor

Approx. 43.9 sq. metres (472.7 sq. feet)

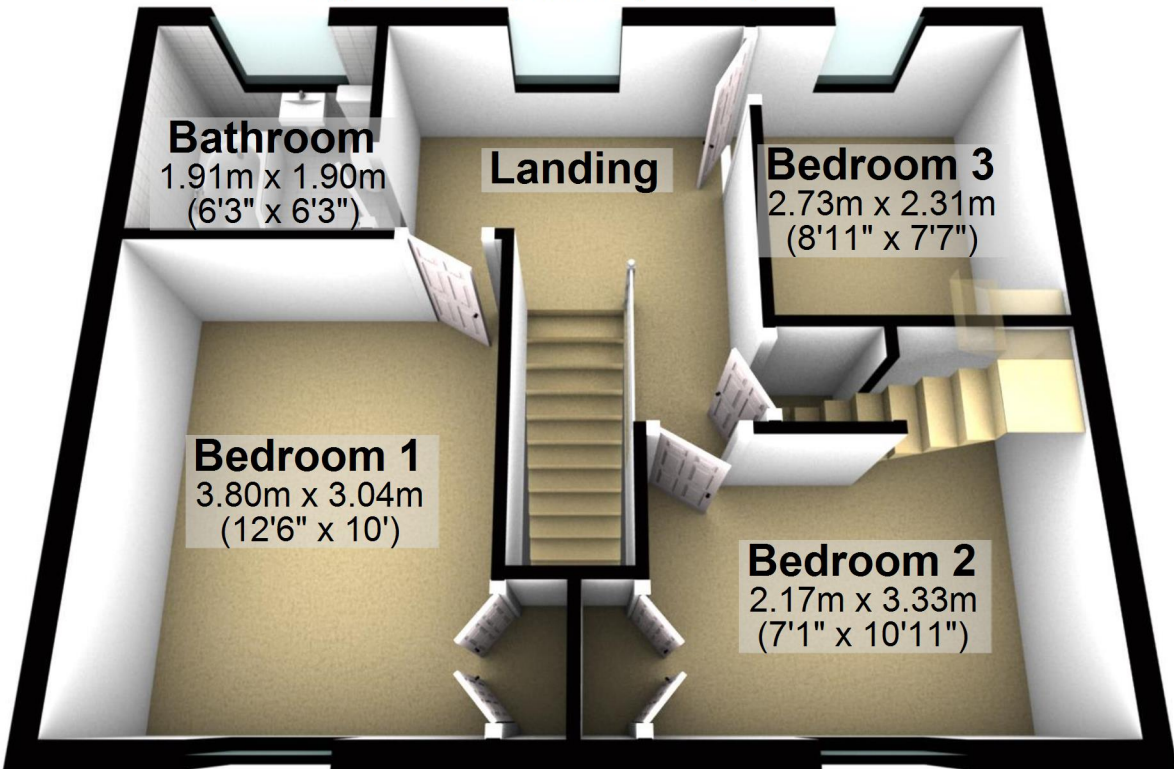

## Second Floor

Approx. 33.5 sq. metres (360.5 sq. feet)

