

Ground Floor

Approx. 62.2 sq. metres (669.8 sq. feet)

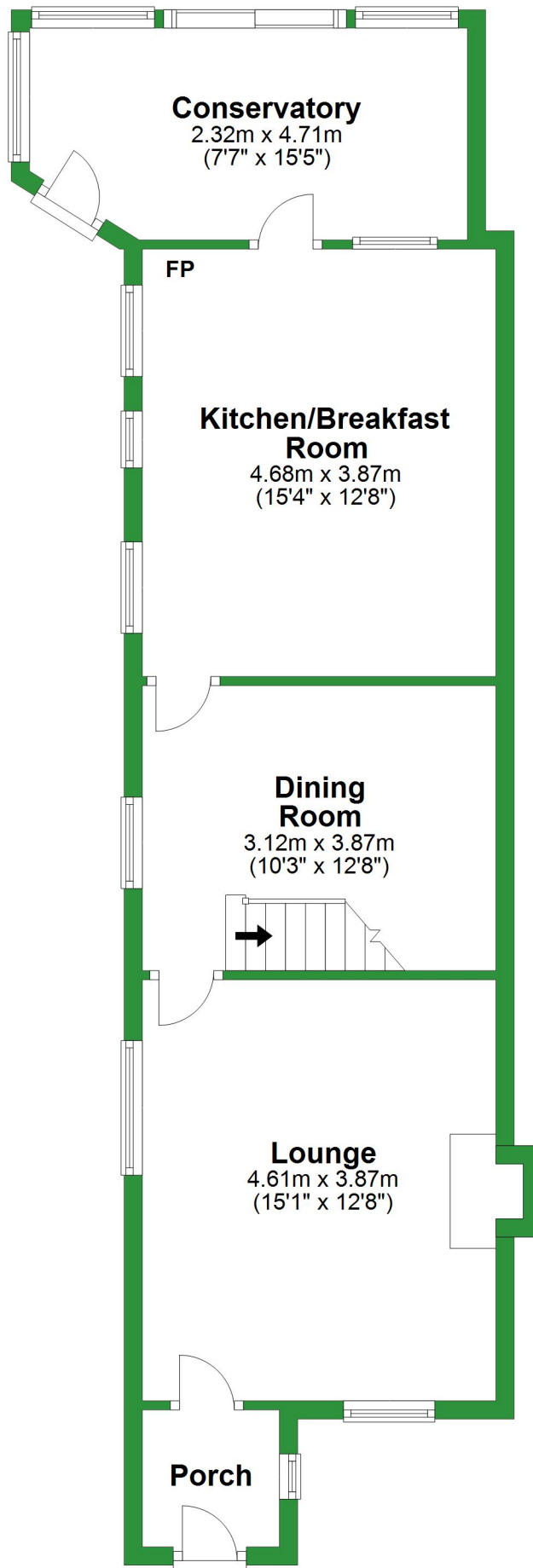

Total area: approx. 117.6 sq. metres (1266.2 sq. feet)

For illustrative purposes only. Not to scale. All sizes are approximate.
Plan produced using PlanUp.

First Floor

Approx. 30.3 sq. metres (326.2 sq. feet)

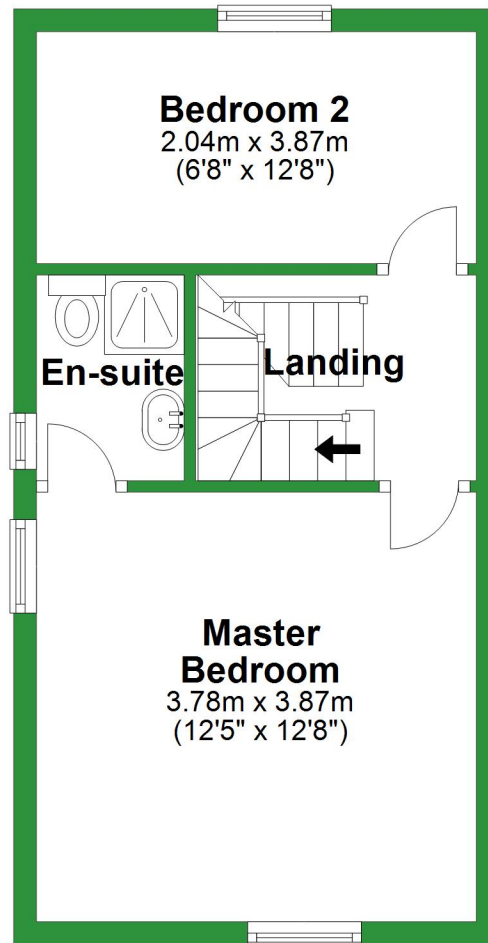

Second Floor

Approx. 25.1 sq. metres (270.2 sq. feet)

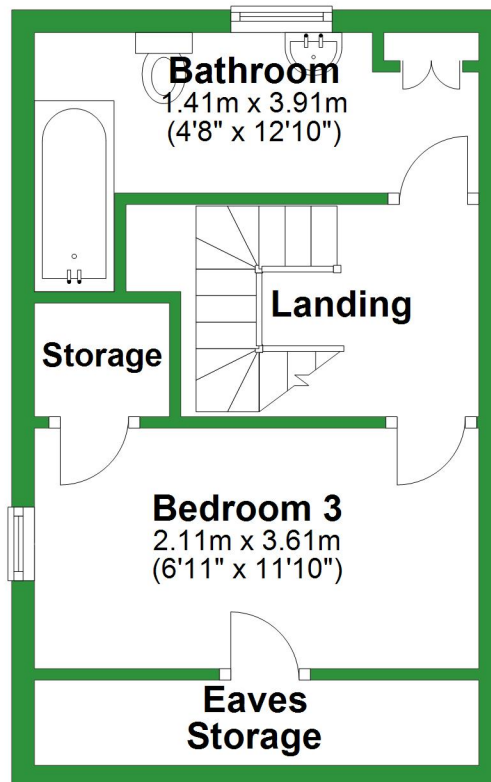

Ground Floor

Approx. 62.2 sq. metres (669.8 sq. feet)

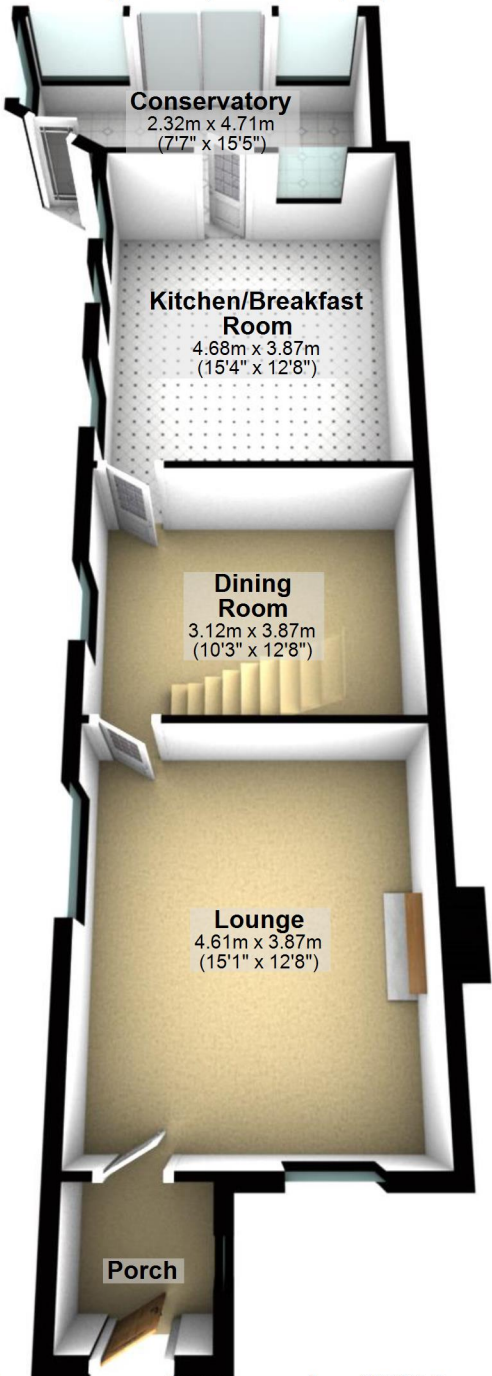

Conservatory

2.32m x 4.71m
(7'7" x 15'5")

Kitchen/Breakfast Room

4.68m x 3.87m
(15'4" x 12'8")

Dining Room

3.12m x 3.87m
(10'3" x 12'8")

Lounge

4.61m x 3.87m
(15'1" x 12'8")

Porch

Total area: approx. 117.6 sq. metres (1266.2 sq. feet)

For illustrative purposes only. Not to scale. All sizes are approximate.

Plan produced using PlanUp.

First Floor

Approx. 30.3 sq. metres (326.2 sq. feet)



Bedroom 2
2.04m x 3.87m
(6'8" x 12'8")

This 3D architectural rendering shows the first floor layout. At the top is a light blue rectangular feature, possibly a skylight or a recessed ceiling area. Below it is Bedroom 2, which contains a bed and a desk. To the left of Bedroom 2 is an en-suite bathroom with a toilet, sink, and shower. To the right is a landing area with a desk and a chair. At the bottom is the Master Bedroom, which is the largest room and contains a bed. The floor is a light beige color, and the walls are white. The overall layout is rectangular with a central hallway connecting the rooms.

En-suite

Landing

**Master
Bedroom**
3.78m x 3.87m
(12'5" x 12'8")

Second Floor

Approx. 25.1 sq. metres (270.2 sq. feet)

