

## Ground Floor

Approx. 93.6 sq. metres (1007.1 sq. feet)

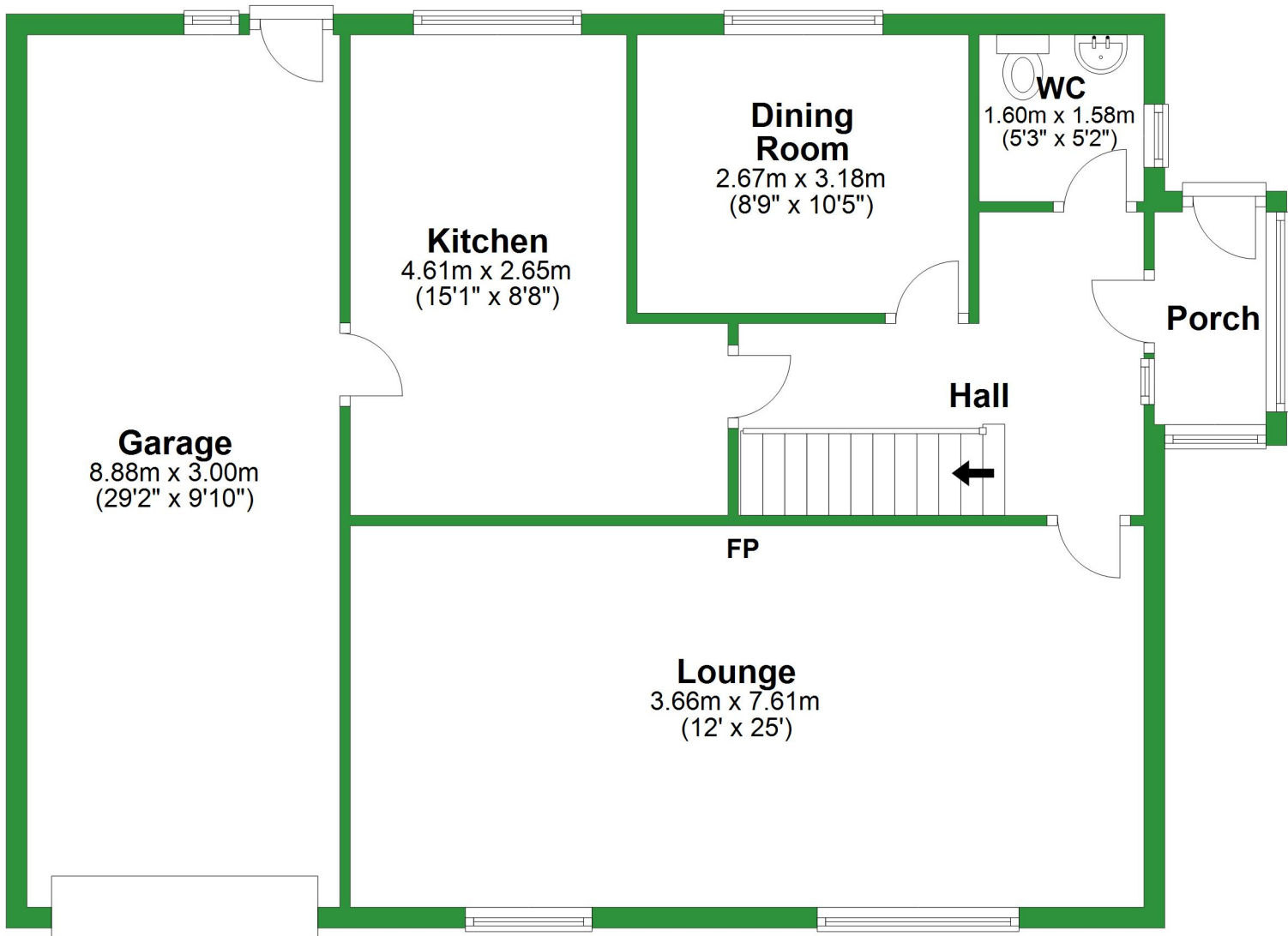

Total area: approx. 157.3 sq. metres (1692.7 sq. feet)

For illustrative purposes only. Not to scale. All sizes are approximate.

Plan produced using PlanUp.

# First Floor

Approx. 63.7 sq. metres (685.6 sq. feet)

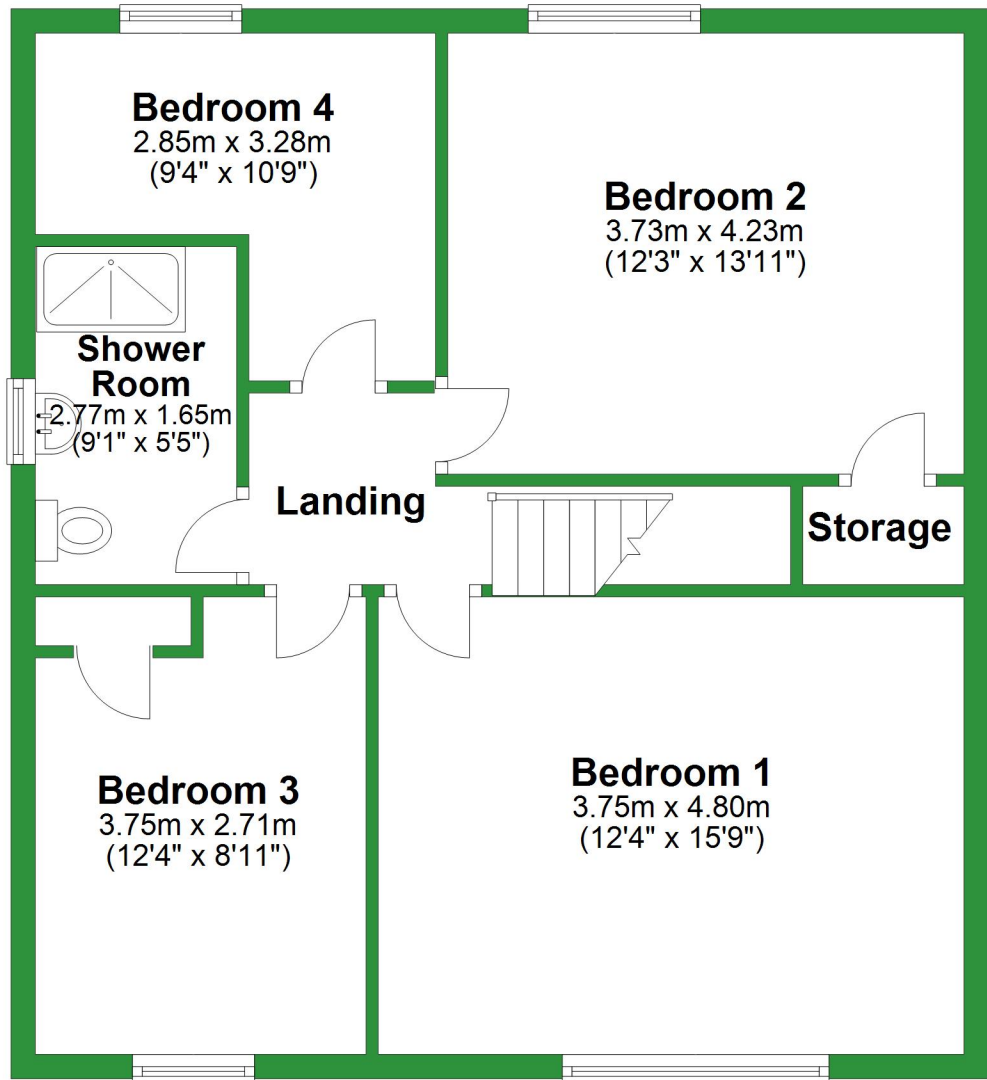

## Ground Floor

Approx. 93.6 sq. metres (1007.1 sq. feet)

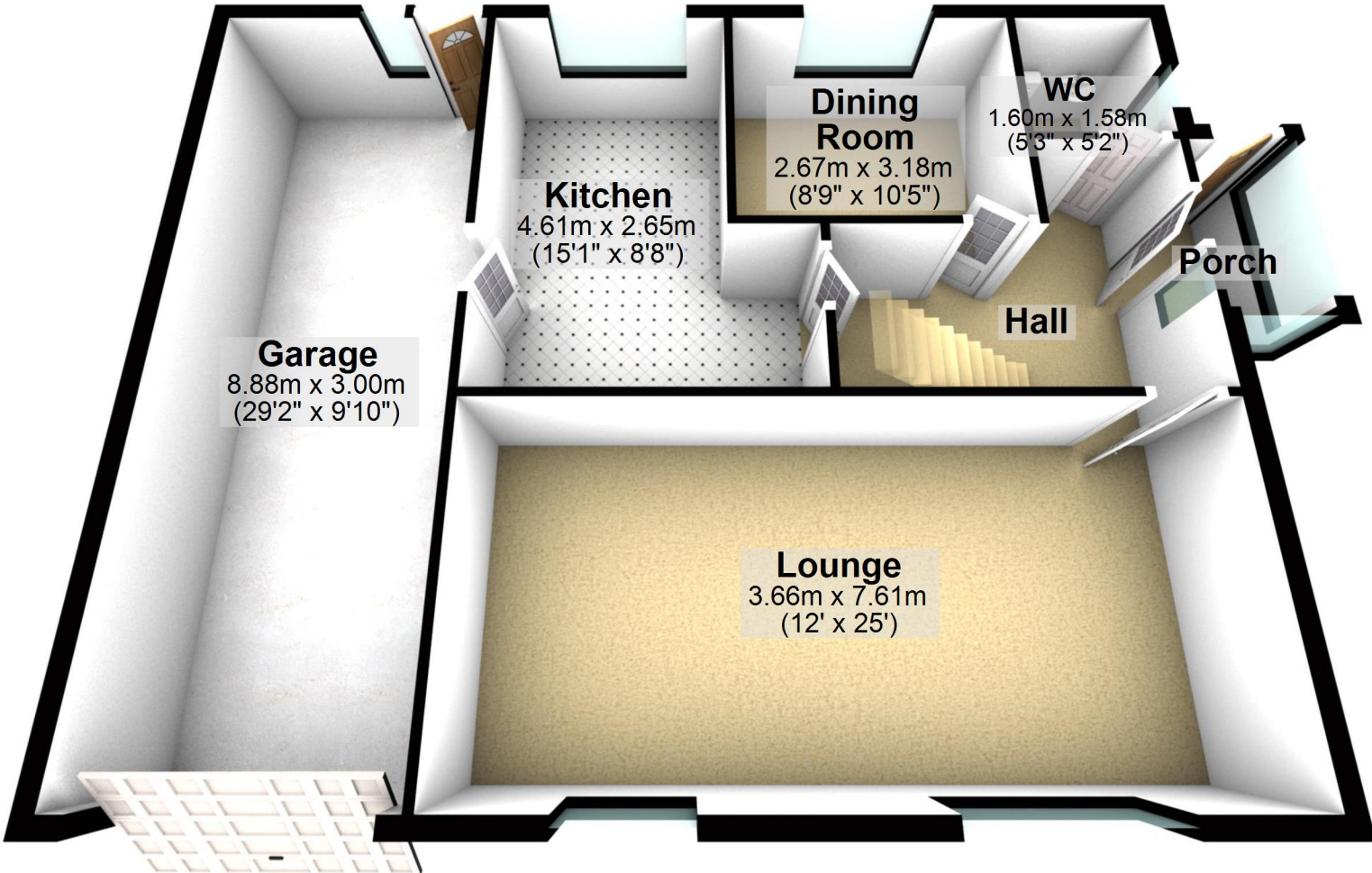

Total area: approx. 157.3 sq. metres (1692.7 sq. feet)

For illustrative purposes only. Not to scale. All sizes are approximate.

Plan produced using PlanUp.

# First Floor

Approx. 63.7 sq. metres (685.6 sq. feet)

## Bedroom 4

2.85m x 3.28m  
(9'4" x 10'9")

## Bedroom 2

3.73m x 4.23m  
(12'3" x 13'11")

## Shower Room

2.77m x 1.65m  
(9'1" x 5'5")

## Landing

## Storage

## Bedroom 3

3.75m x 2.71m  
(12'4" x 8'11")

## Bedroom 1

3.75m x 4.80m  
(12'4" x 15'9")

