

## Ground Floor

Approx. 128.3 sq. metres (1381.3 sq. feet)

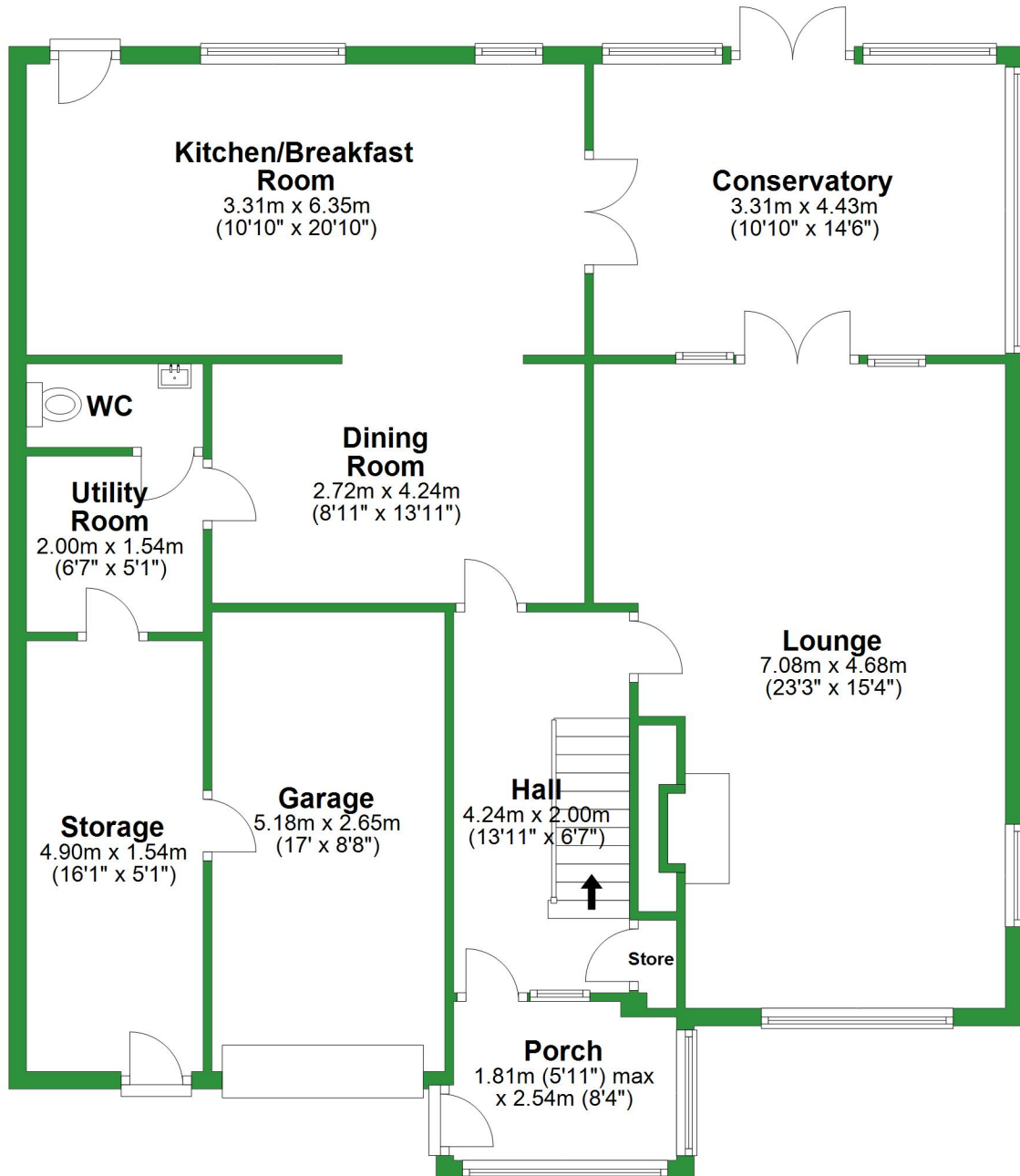

Total area: approx. 178.9 sq. metres (1925.8 sq. feet)

For illustrative purposes only. Not to scale. All sizes are approximate.  
Plan produced using PlanUp.

## First Floor

Approx. 50.6 sq. metres (544.6 sq. feet)

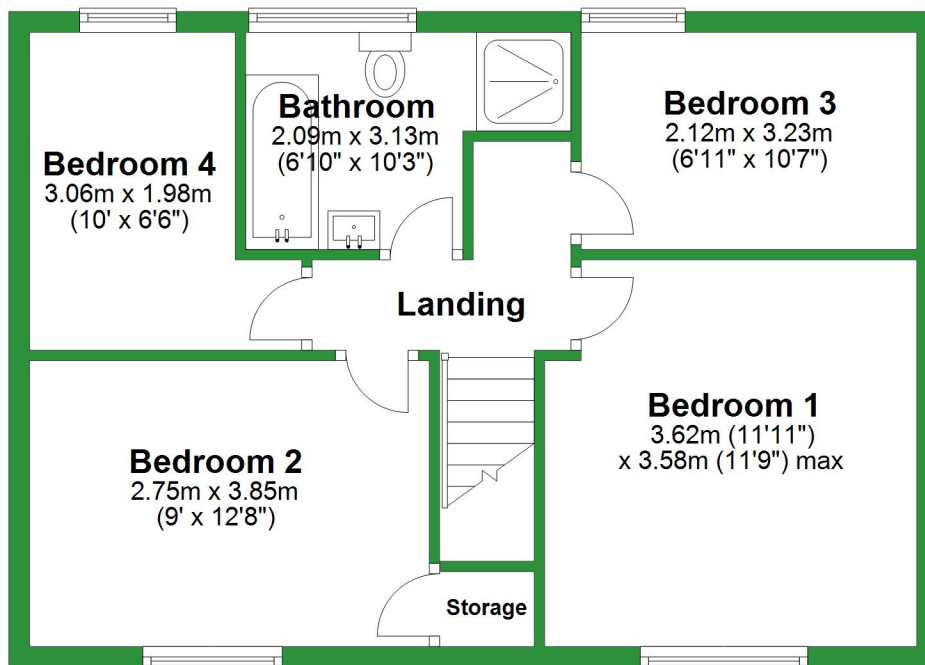

## Ground Floor

Approx. 128.3 sq. metres (1381.3 sq. feet)

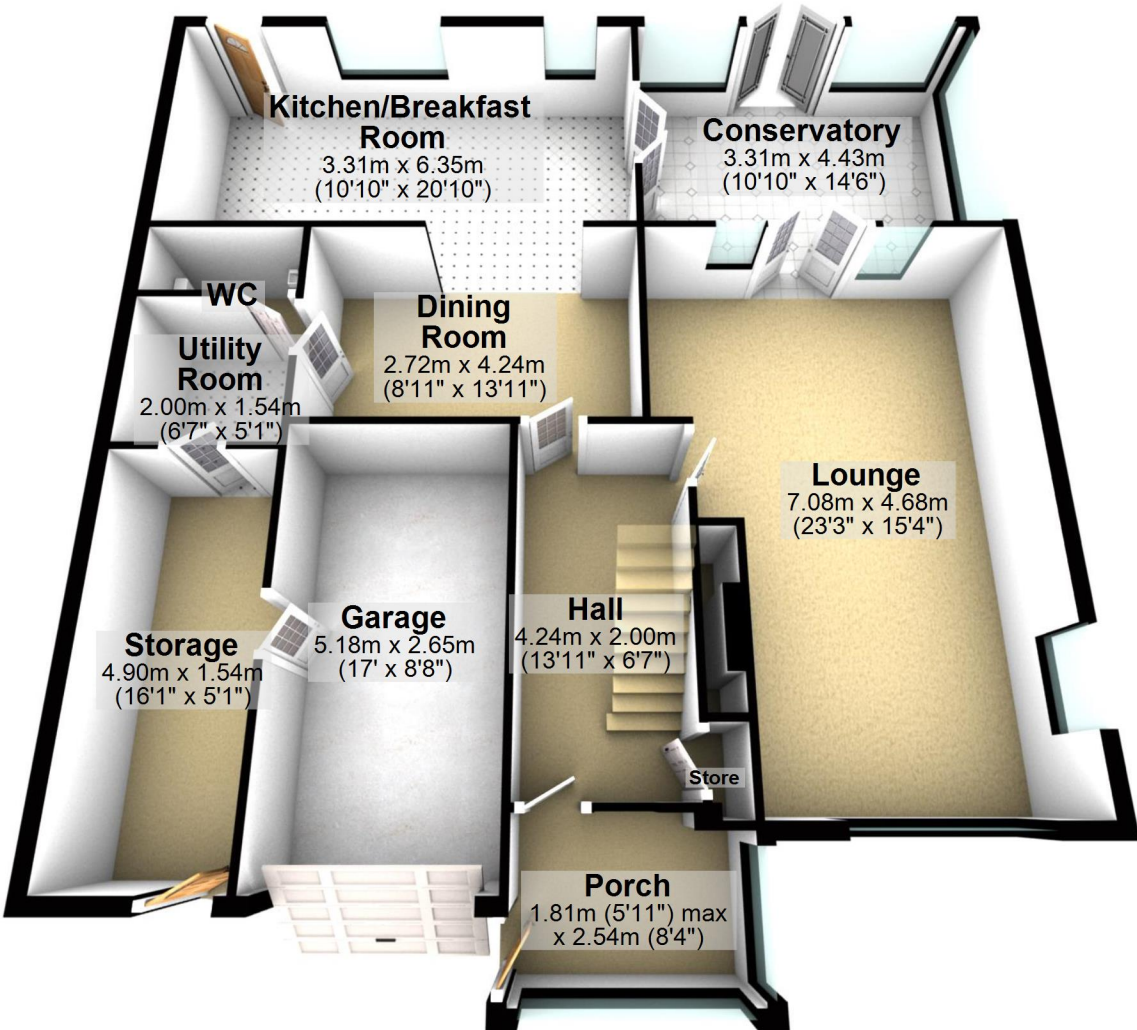

Total area: approx. 178.9 sq. metres (1925.8 sq. feet)

For illustrative purposes only. Not to scale. All sizes are approximate.  
Plan produced using PlanUp.

## First Floor

Approx. 50.6 sq. metres (544.6 sq. feet)

