

# Ground Floor

Approx. 45.7 sq. metres (491.4 sq. feet)

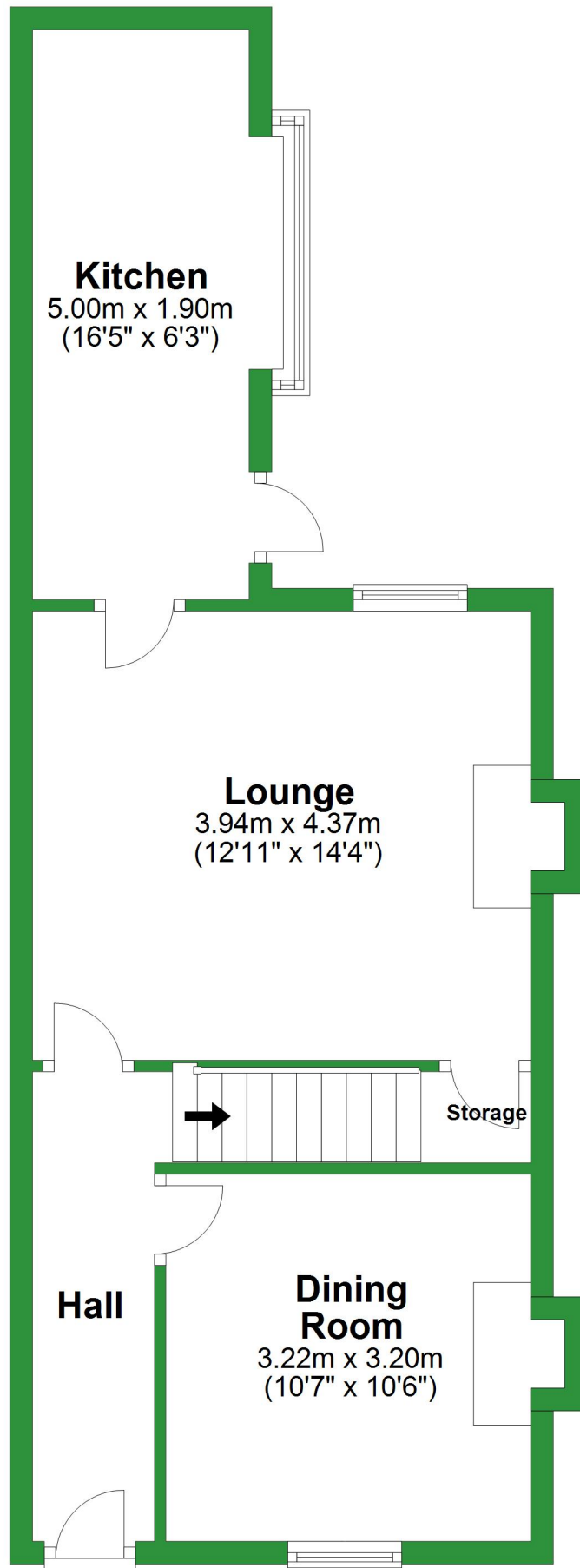

Total area: approx. 80.0 sq. metres (860.9 sq. feet)

For illustrative purposes only. Not to scale. All sizes are approximate.  
Plan produced using PlanUp.

## First Floor

Approx. 34.3 sq. metres (369.5 sq. feet)

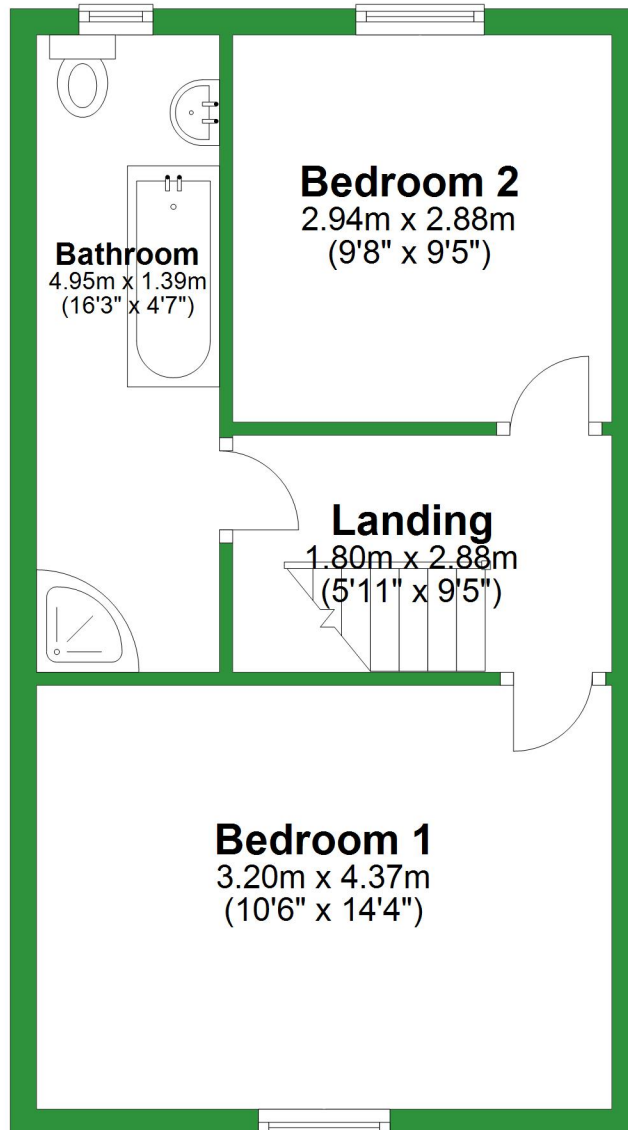

# Ground Floor

Approx. 45.7 sq. metres (491.4 sq. feet)

## Kitchen

5.00m x 1.90m  
(16'5" x 6'3")

## Lounge

3.94m x 4.37m  
(12'11" x 14'4")

Storage

## Hall

## Dining Room

3.22m x 3.20m  
(10'7" x 10'6")

Total area: approx. 80.0 sq. metres (860.9 sq. feet)

For illustrative purposes only. Not to scale. All sizes are approximate.

Plan produced using PlanUp.

# First Floor

Approx. 34.3 sq. metres (369.5 sq. feet)

