

# Ground Floor

Approx. 39.2 sq. metres (421.7 sq. feet)

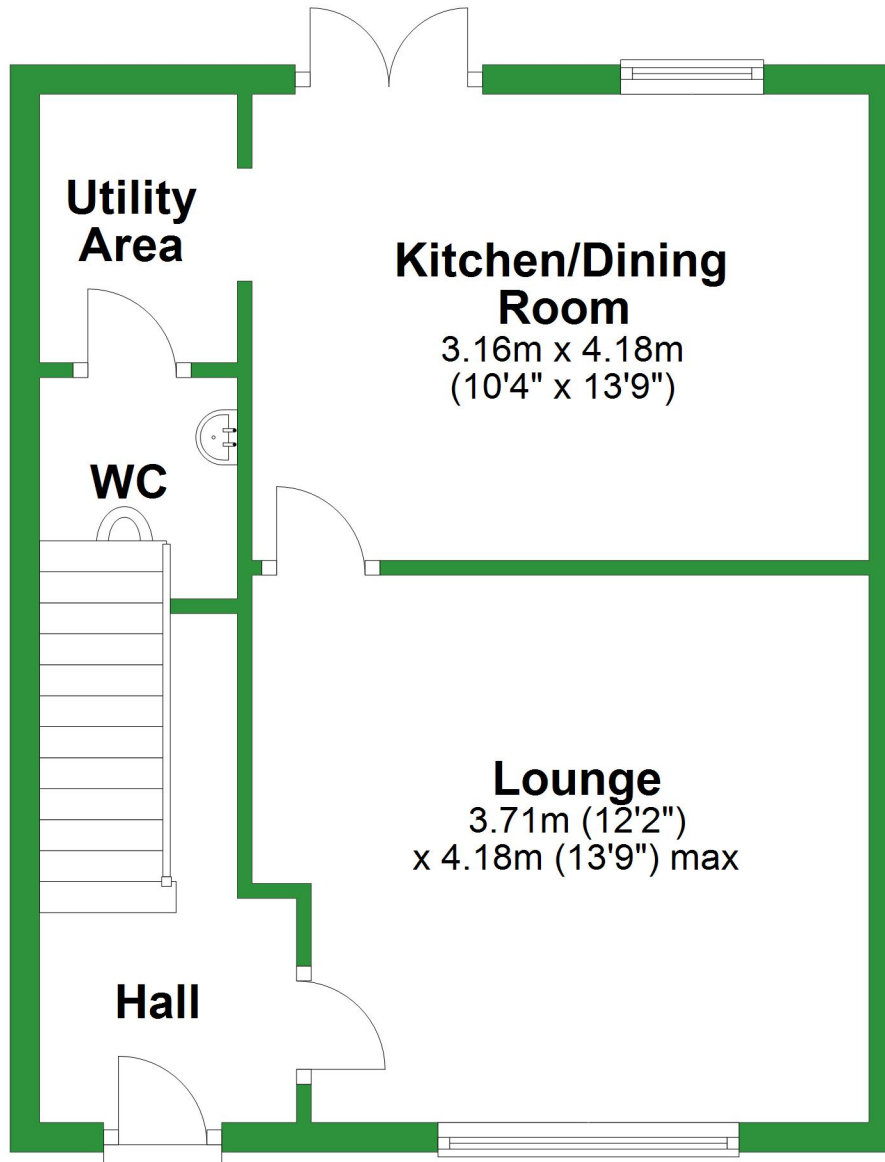

Total area: approx. 78.4 sq. metres (843.4 sq. feet)

For illustrative purposes only. Not to scale. All sizes are approximate.  
Plan produced using PlanUp.

# First Floor

Approx. 39.2 sq. metres (421.7 sq. feet)

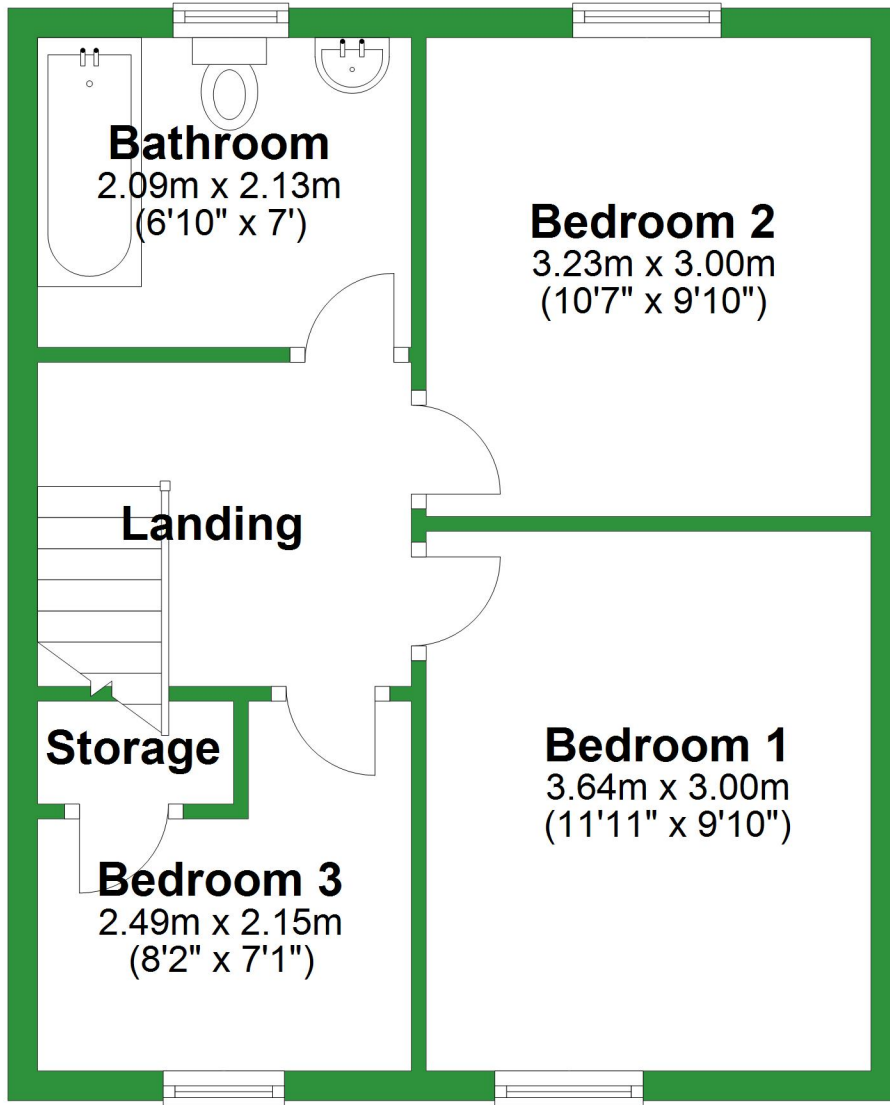

# Ground Floor

Approx. 39.2 sq. metres (421.7 sq. feet)

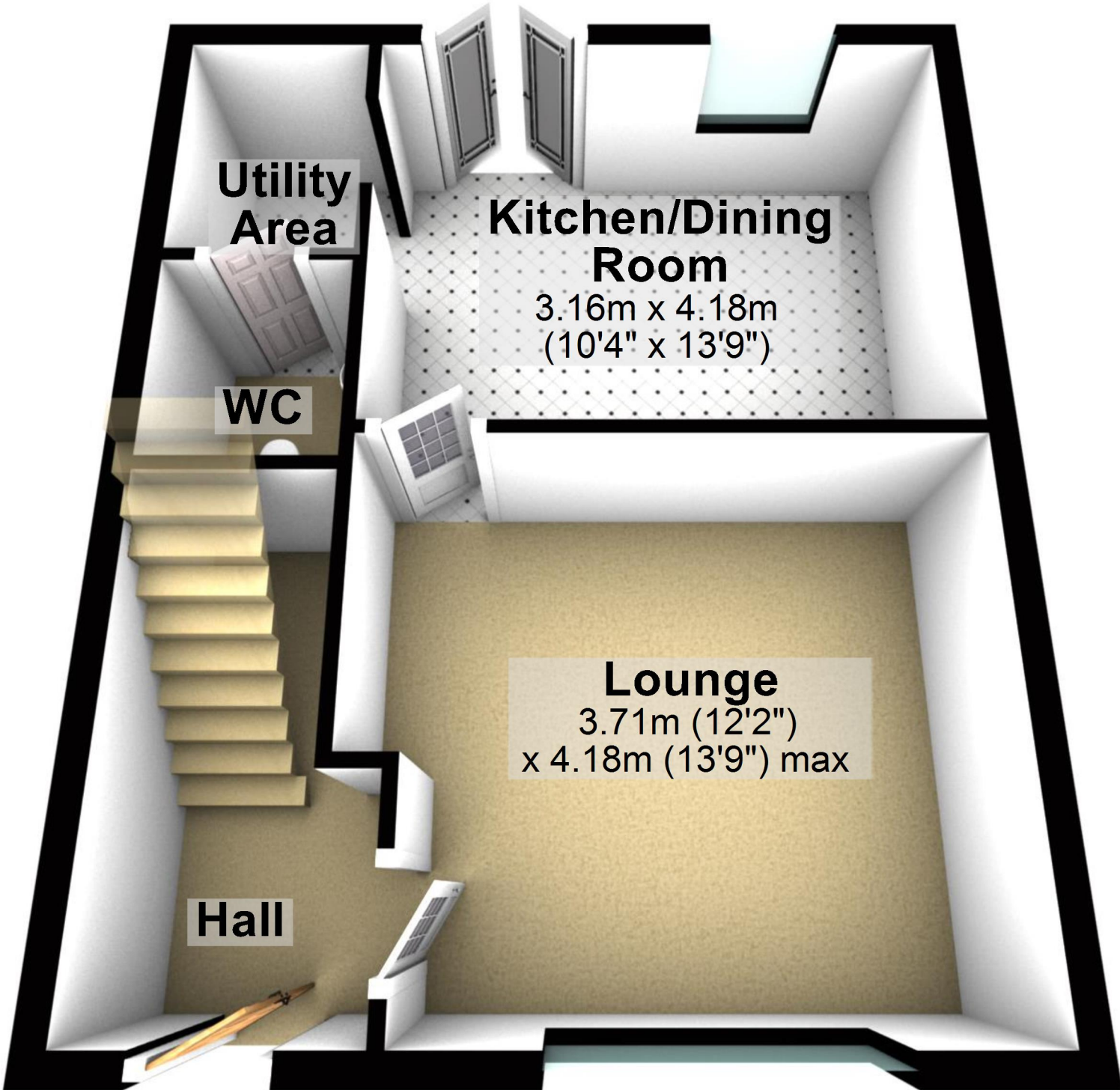

Total area: approx. 78.4 sq. metres (843.4 sq. feet)

For illustrative purposes only. Not to scale. All sizes are approximate.

Plan produced using PlanUp.

# First Floor

Approx. 39.2 sq. metres (421.7 sq. feet)

## Bathroom

2.09m x 2.13m  
(6'10" x 7')

## Bedroom 2

3.23m x 3.00m  
(10'7" x 9'10")

## Landing

## Storage

## Bedroom 1

3.64m x 3.00m  
(11'11" x 9'10")

## Bedroom 3

2.49m x 2.15m  
(8'2" x 7'1")

