

Basement

Approx. 24.2 sq. metres (260.7 sq. feet)

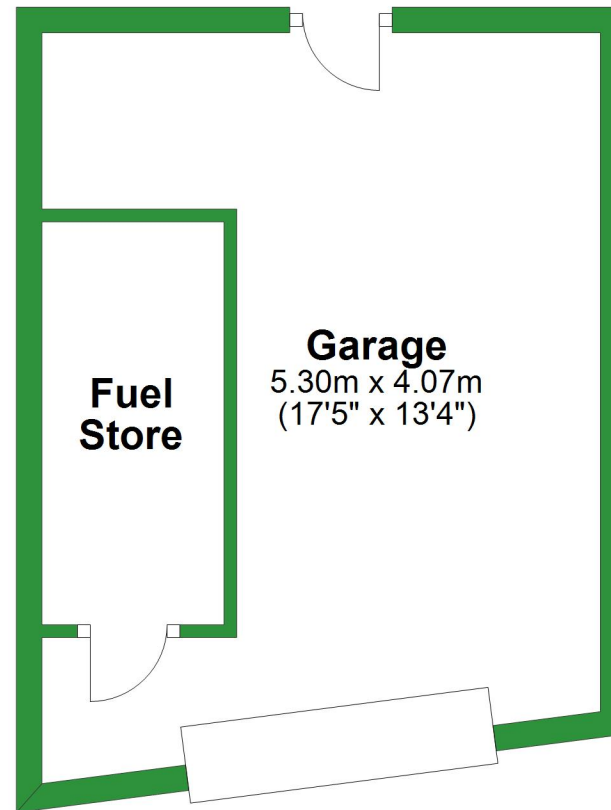

Total area: approx. 149.5 sq. metres (1609.7 sq. feet)

For illustrative purposes only. Not to scale. All sizes are approximate.
Plan produced using PlanUp.

Ground Floor

Approx. 67.2 sq. metres (723.3 sq. feet)

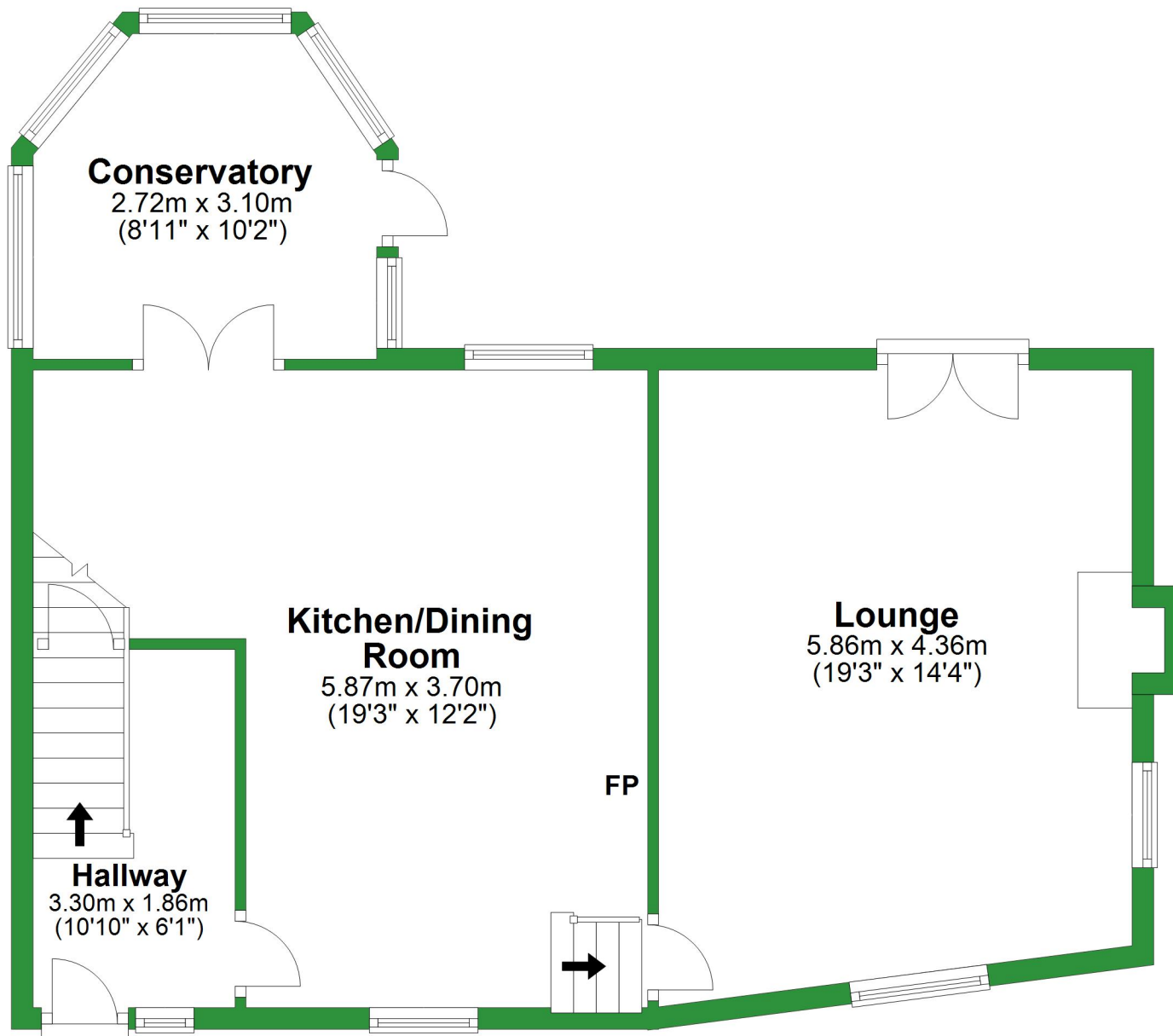

First Floor

Approx. 58.1 sq. metres (625.8 sq. feet)

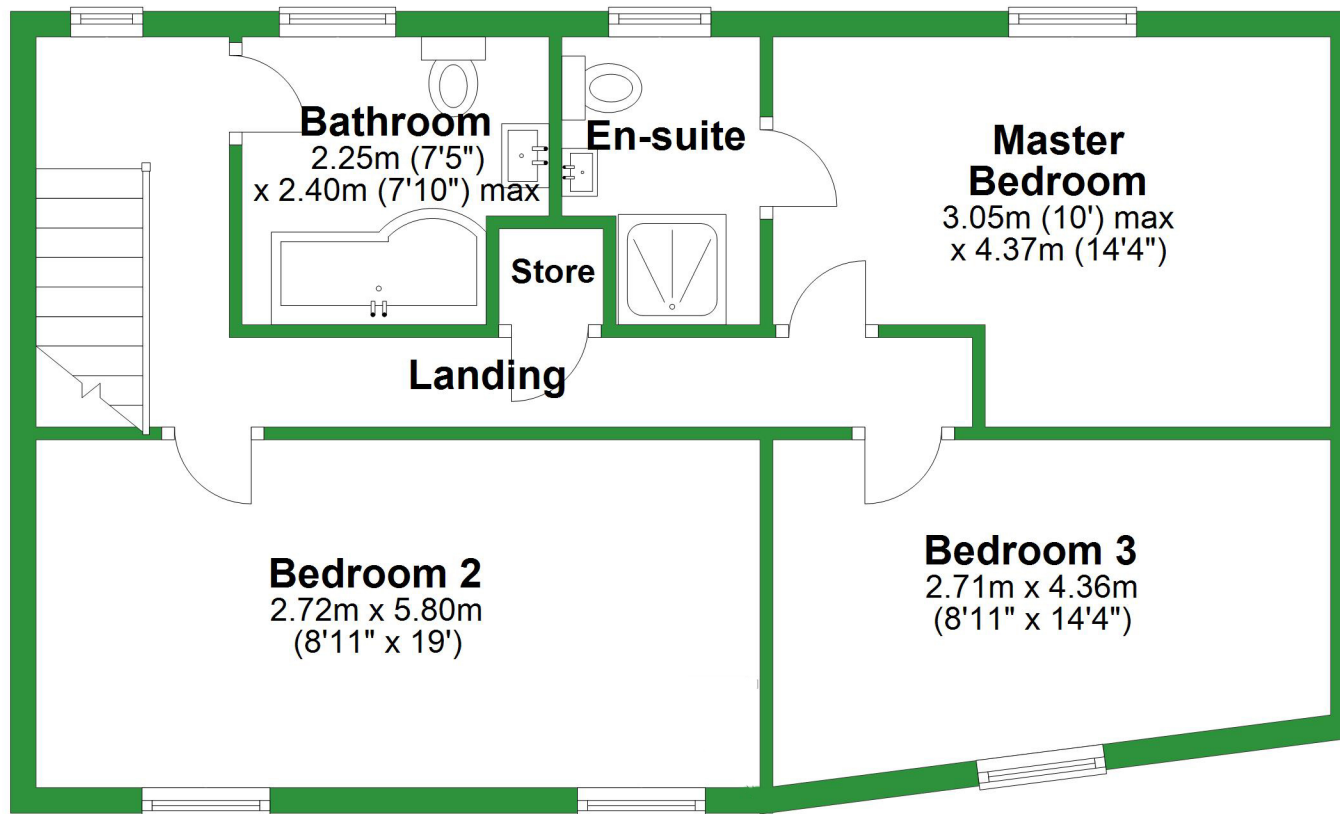

Basement

Approx. 24.2 sq. metres (260.7 sq. feet)

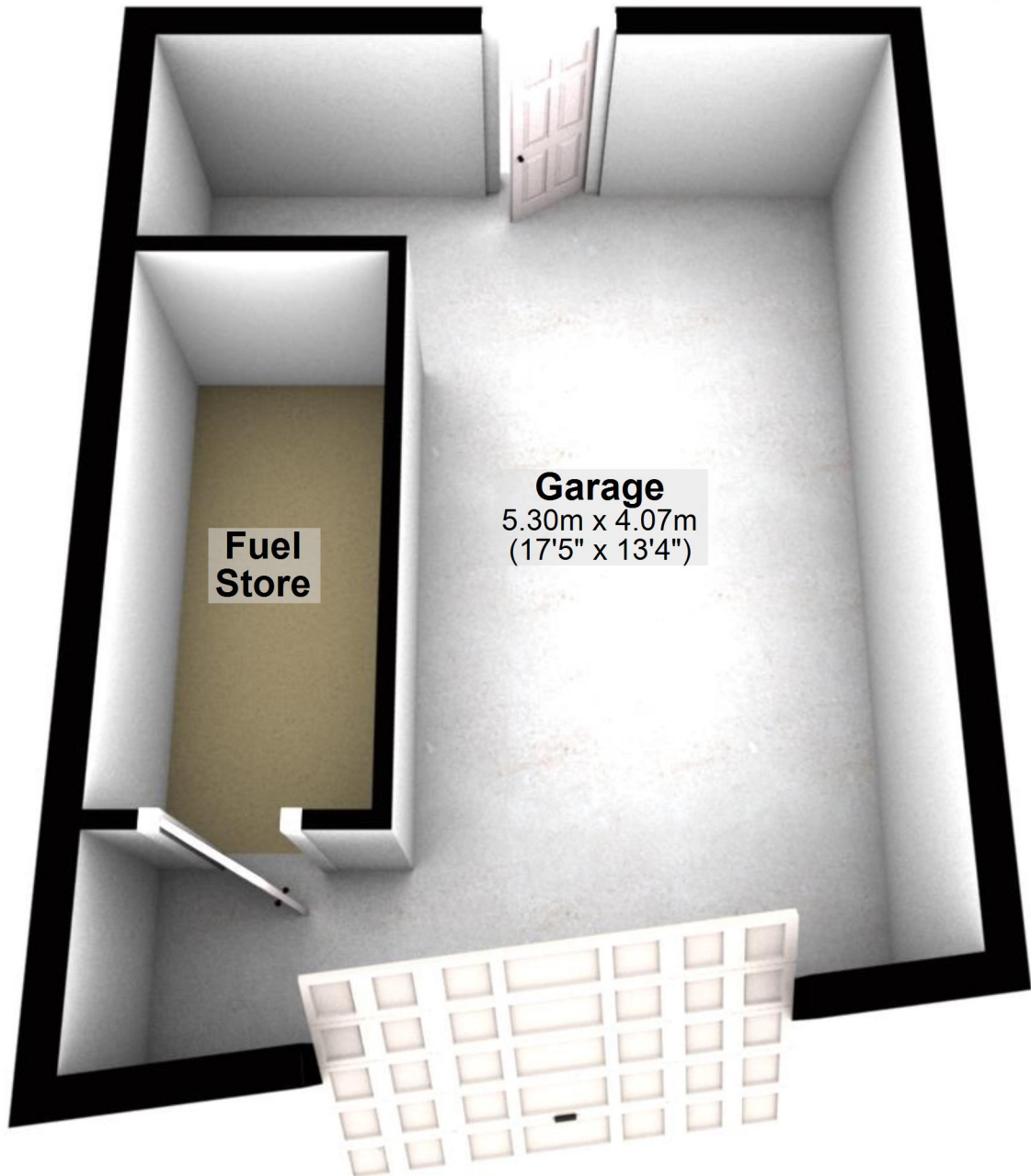

**Fuel
Store**

Garage
5.30m x 4.07m
(17'5" x 13'4")

Total area: approx. 149.5 sq. metres (1609.7 sq. feet)

For illustrative purposes only. Not to scale. All sizes are approximate.
Plan produced using PlanUp.

Ground Floor

Approx. 67.2 sq. metres (723.3 sq. feet)

Conservatory

2.72m x 3.10m
(8'11" x 10'2")

Kitchen/Dining Room

5.87m x 3.70m
(19'3" x 12'2")

Lounge

5.86m x 4.36m
(19'3" x 14'4")

Hallway

3.30m x 1.86m
(10'10" x 6'1")

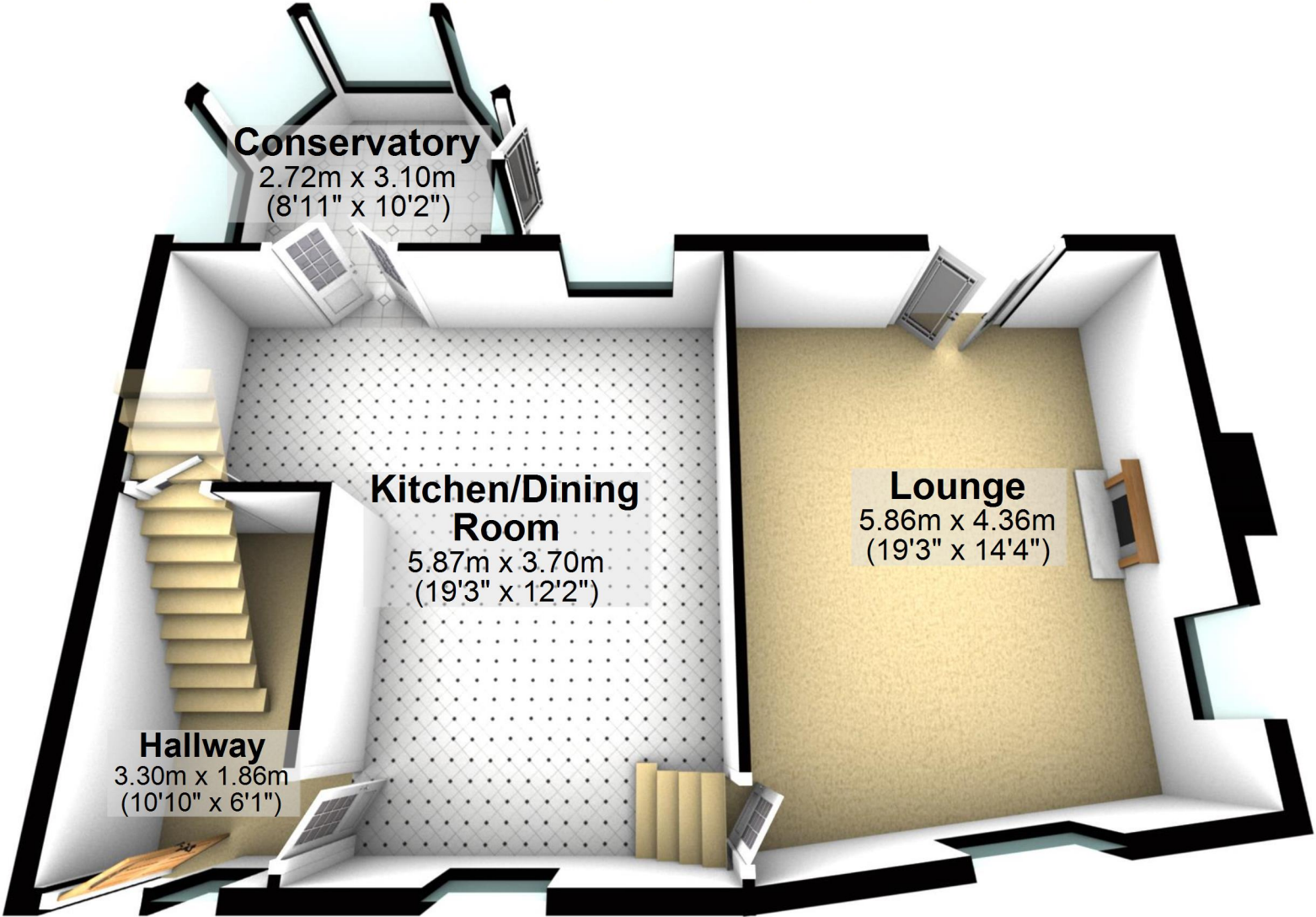

First Floor

Approx. 58.1 sq. metres (625.8 sq. feet)

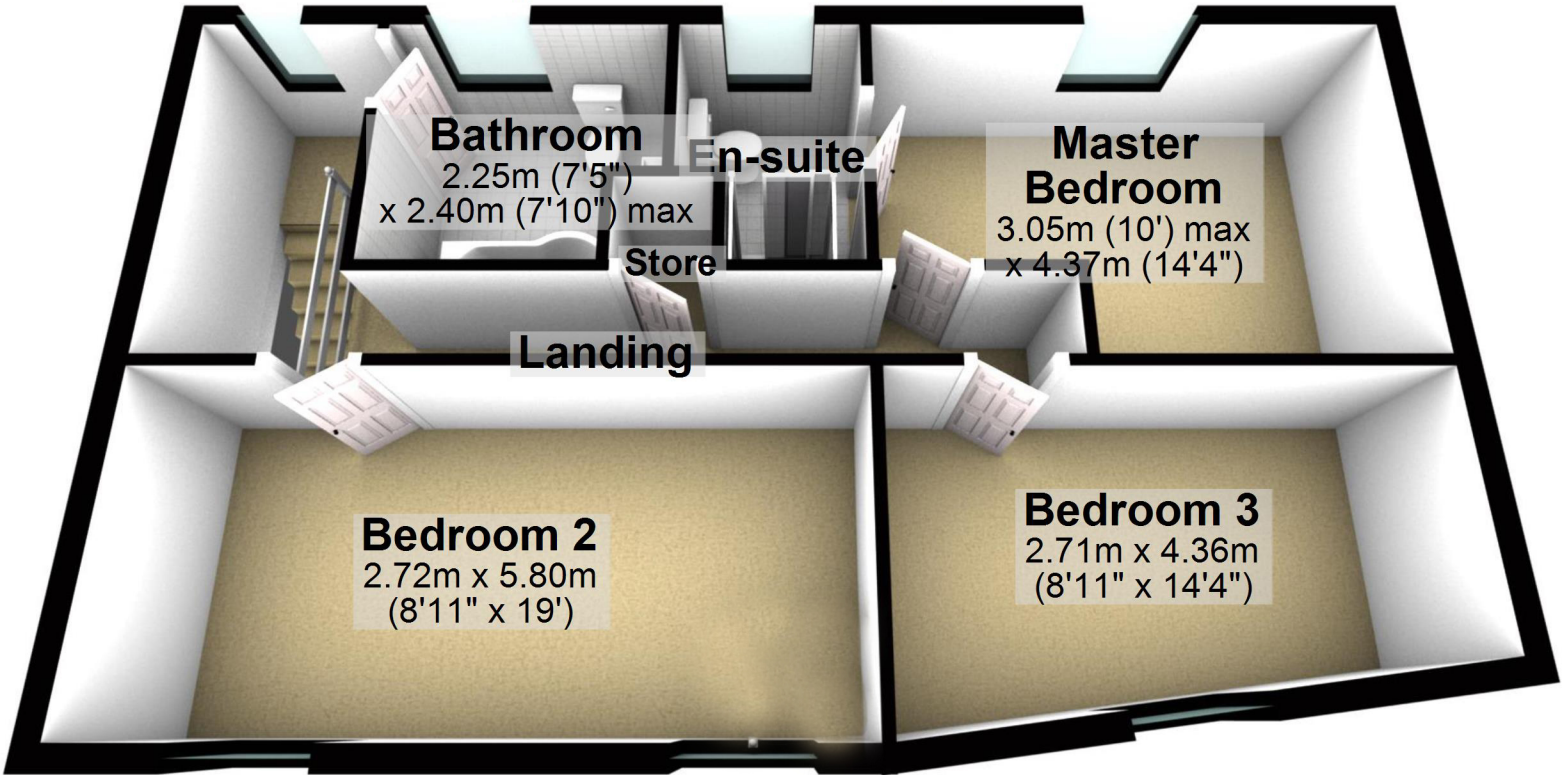

Bathroom
2.25m (7'5")
x 2.40m (7'10") max

En-suite

Store

**Master
Bedroom**
3.05m (10') max
x 4.37m (14'4")

Landing

Bedroom 2
2.72m x 5.80m
(8'11" x 19')

Bedroom 3
2.71m x 4.36m
(8'11" x 14'4")