

Ground Floor

Approx. 43.1 sq. metres (464.2 sq. feet)

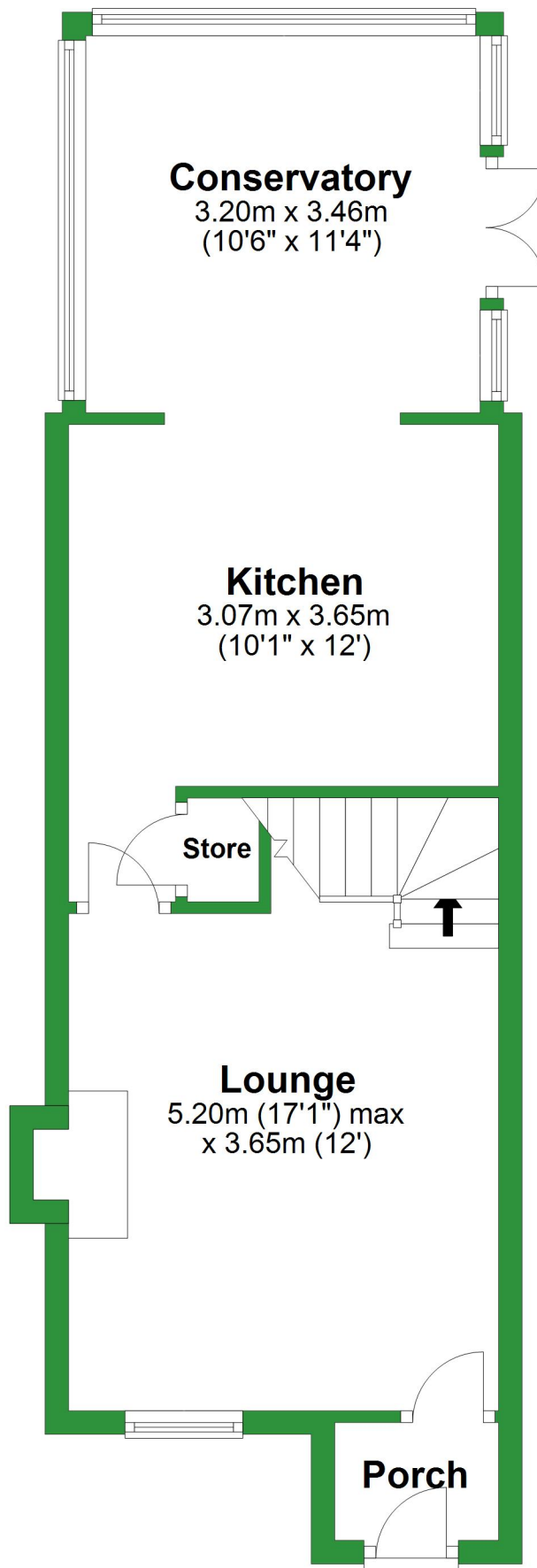

Total area: approx. 73.7 sq. metres (793.0 sq. feet)

For illustrative purposes only. Not to scale. All sizes are approximate.
Plan produced using PlanUp.

First Floor

Approx. 30.6 sq. metres (328.8 sq. feet)

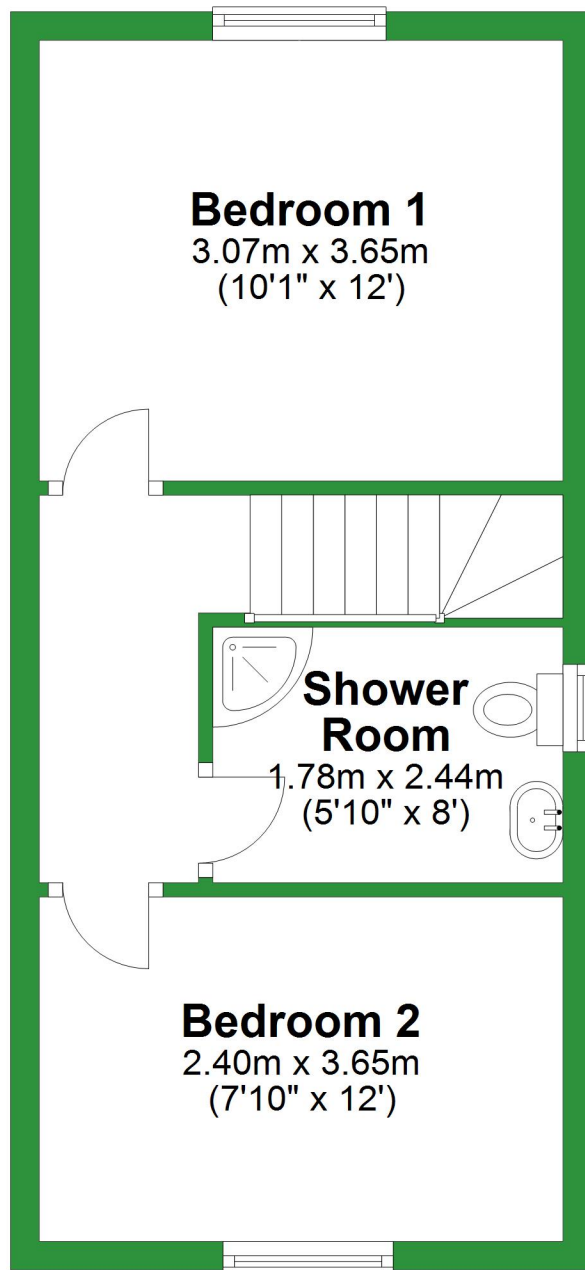

Ground Floor

Approx. 43.1 sq. metres (464.2 sq. feet)

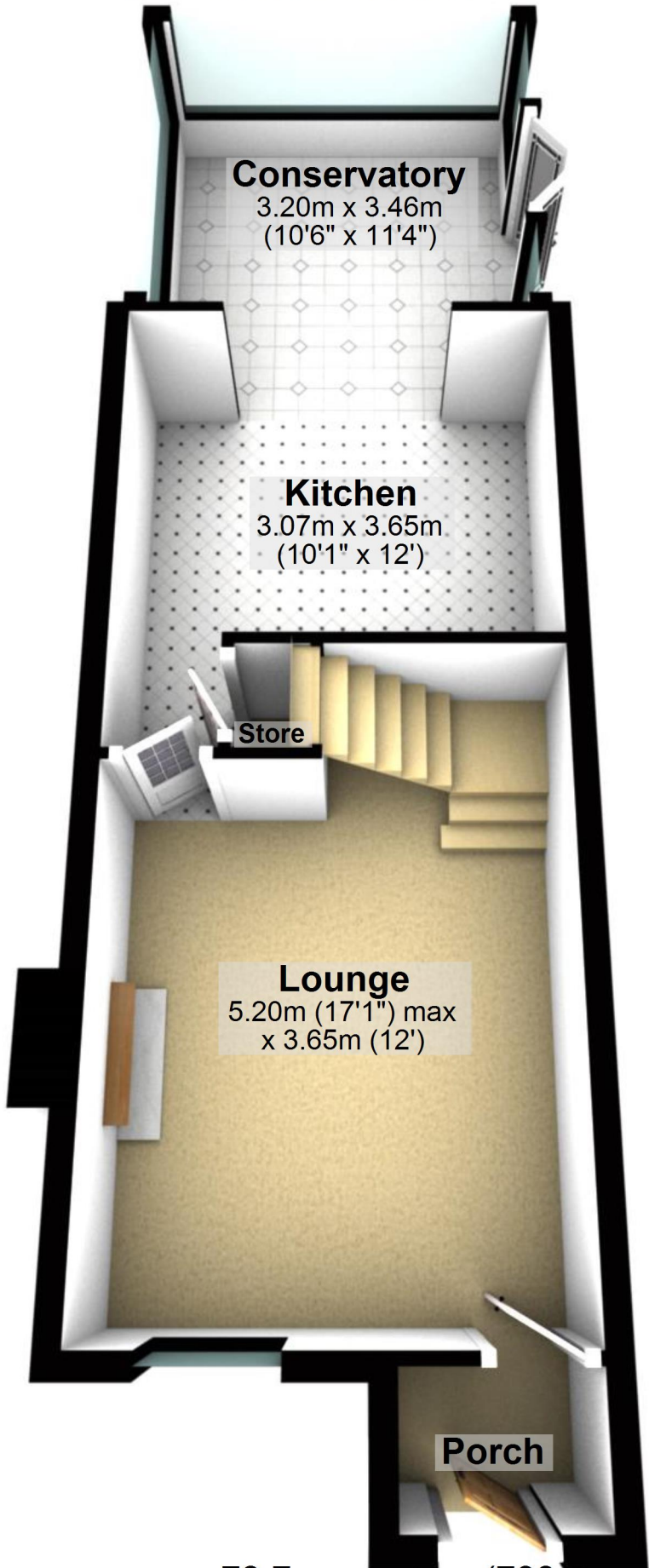

Conservatory

3.20m x 3.46m
(10'6" x 11'4")

Kitchen

3.07m x 3.65m
(10'1" x 12')

Store

Lounge

5.20m (17'1") max
x 3.65m (12')

Porch

Total area: approx. 73.7 sq. metres (793.0 sq. feet)

For illustrative purposes only. Not to scale. All sizes are approximate.

Plan produced using PlanUp.

First Floor

Approx. 30.6 sq. metres (328.8 sq. feet)

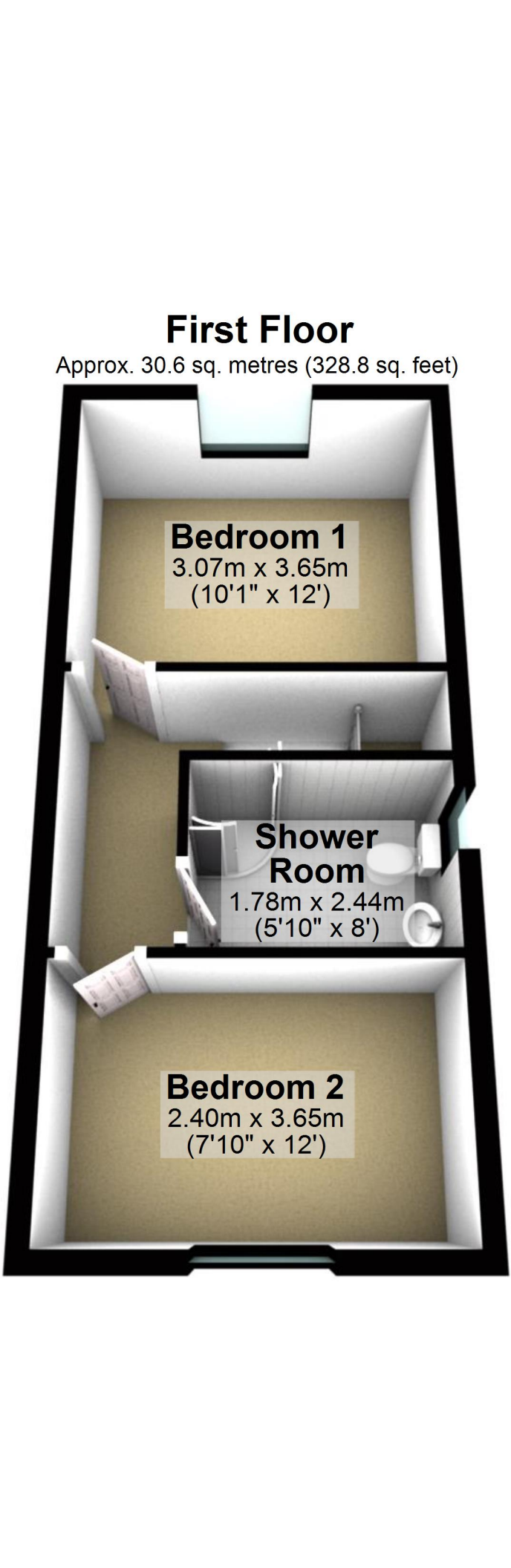

A 3D perspective rendering of a first-floor apartment layout. The floor is a light tan color, and the walls are white. The layout includes two bedrooms, a shower room, and a central hallway. Bedroom 1 is at the top, Bedroom 2 is at the bottom, and the Shower Room is in the middle. There are two doors leading outside, one at the top and one at the bottom. The rendering shows the depth of the rooms and the placement of doors and windows.

Bedroom 1
3.07m x 3.65m
(10'1" x 12')

Shower Room
1.78m x 2.44m
(5'10" x 8')

Bedroom 2
2.40m x 3.65m
(7'10" x 12')