

# Ground Floor

Approx. 68.6 sq. metres (738.6 sq. feet)

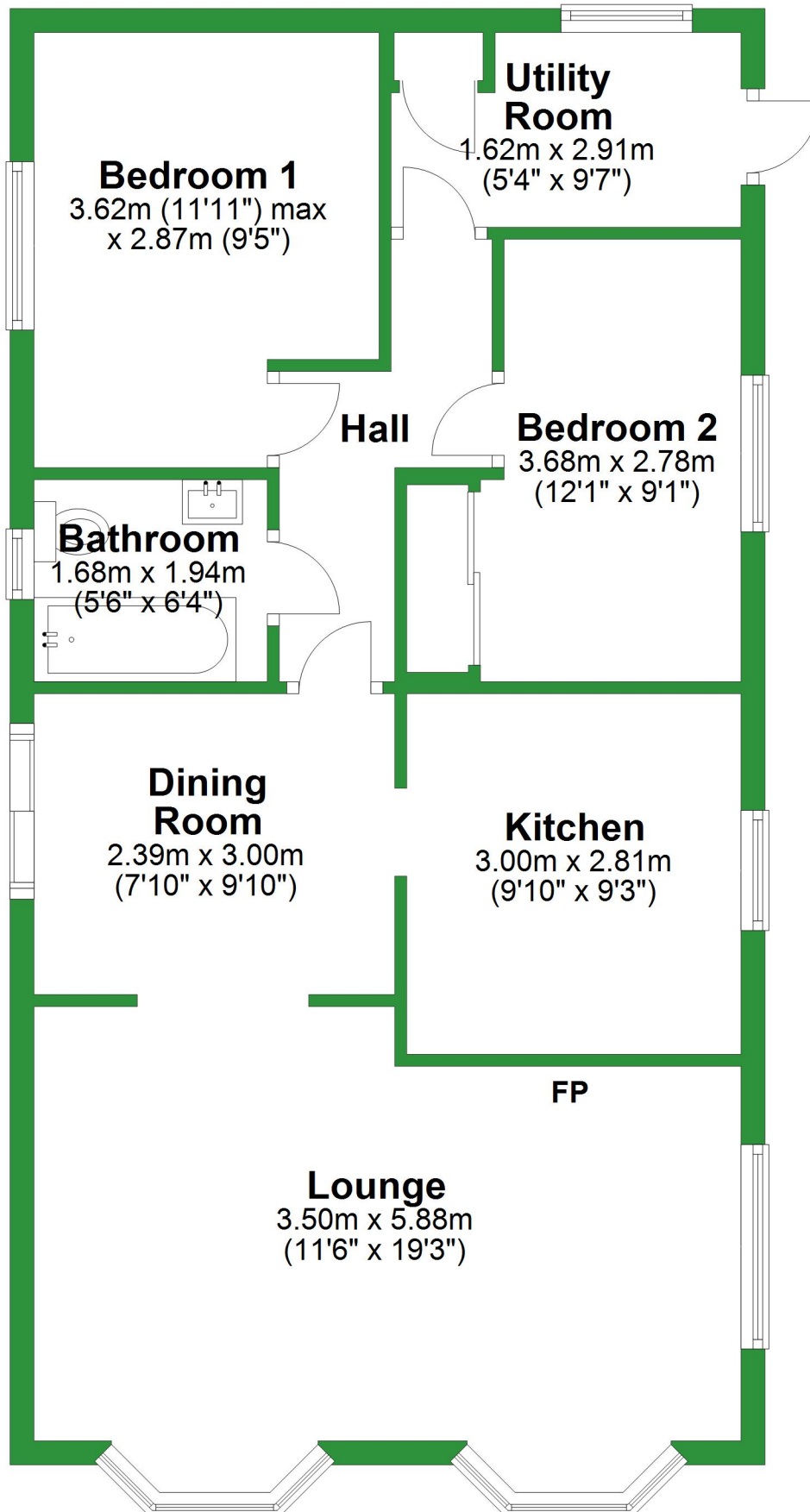

Total area: approx. 68.6 sq. metres (738.6 sq. feet)

For illustrative purposes only. Not to scale. All sizes are approximate.  
Plan produced using PlanUp.

# Ground Floor

Approx. 68.7 sq. metres (740.0 sq. feet)

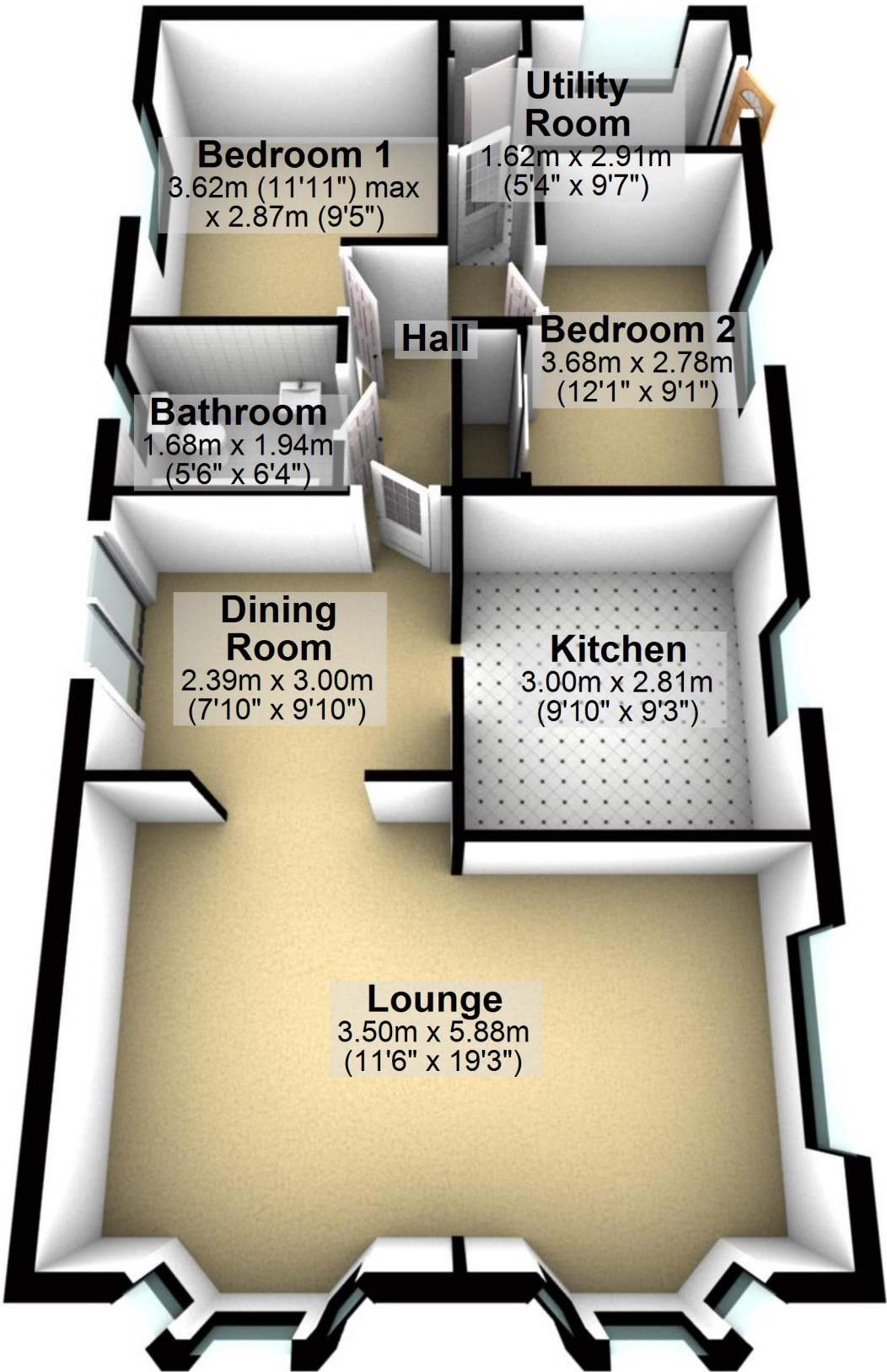

Total area: approx. 68.7 sq. metres (740.0 sq. feet)

For illustrative purposes only. Not to scale. All sizes are approximate.

Plan produced using PlanUp.