

# Ground Floor

Approx. 38.0 sq. metres (409.1 sq. feet)

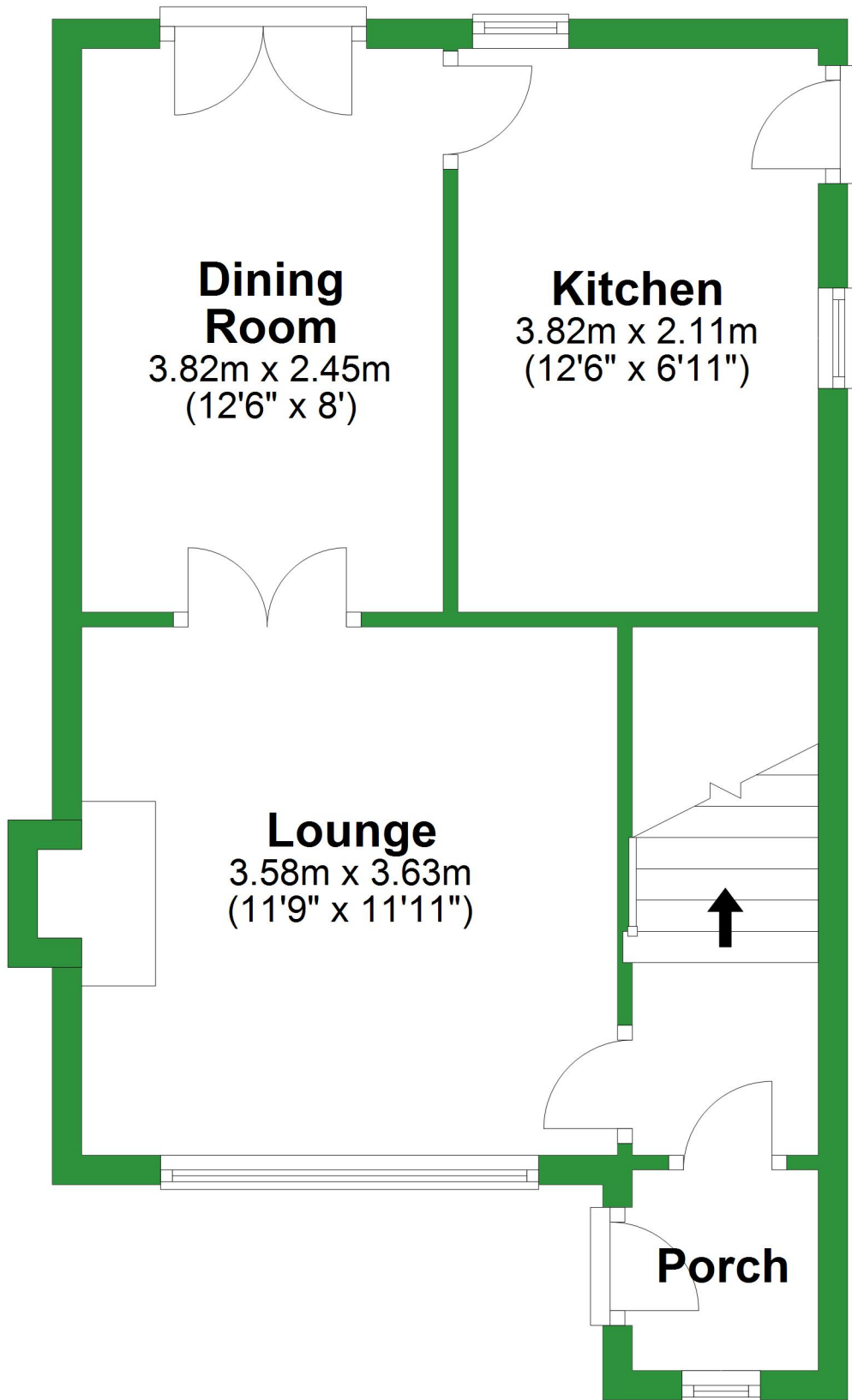

Total area: approx. 90.3 sq. metres (972.1 sq. feet)

For illustrative purposes only. Not to scale. All sizes are approximate.

Plan produced using PlanUp.

Approx. 37.4 sq. metres (403.0 sq. feet)

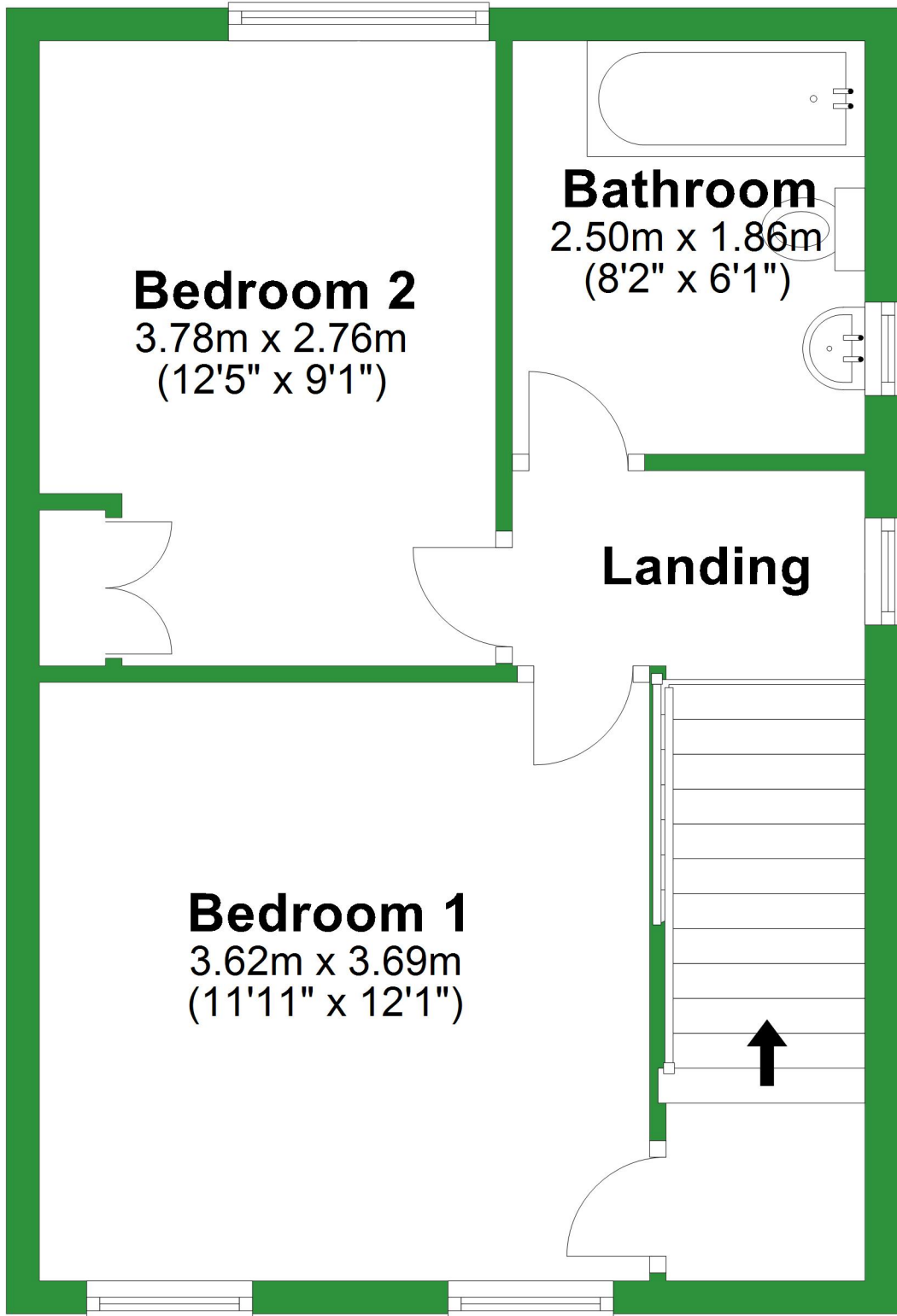

# Second Floor

Approx. 14.9 sq. metres (160.0 sq. feet)

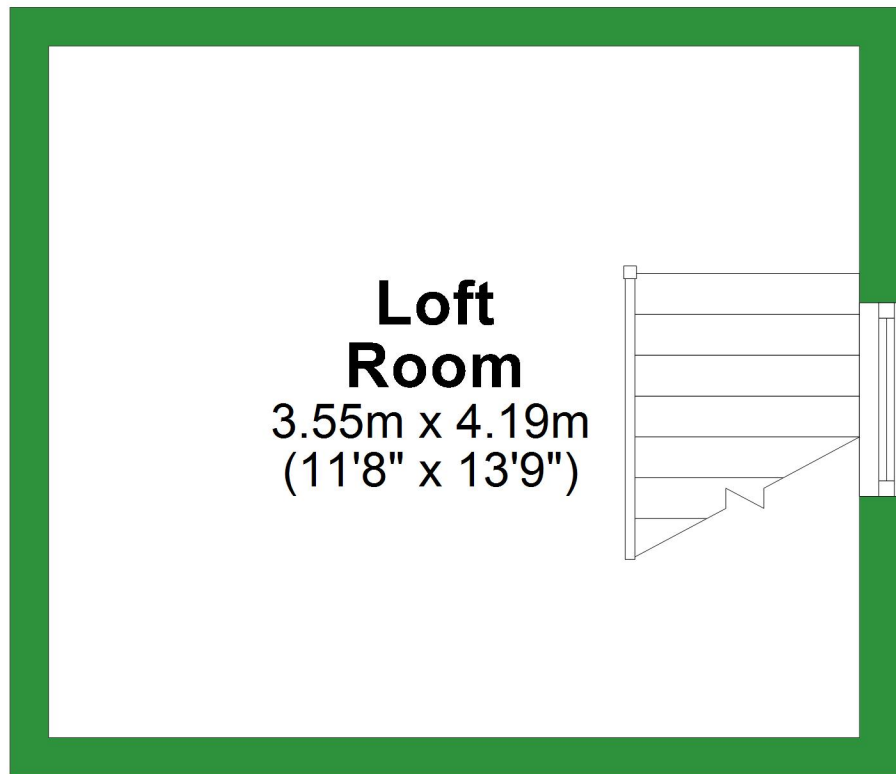

# Ground Floor

Approx. 38.0 sq. metres (409.1 sq. feet)

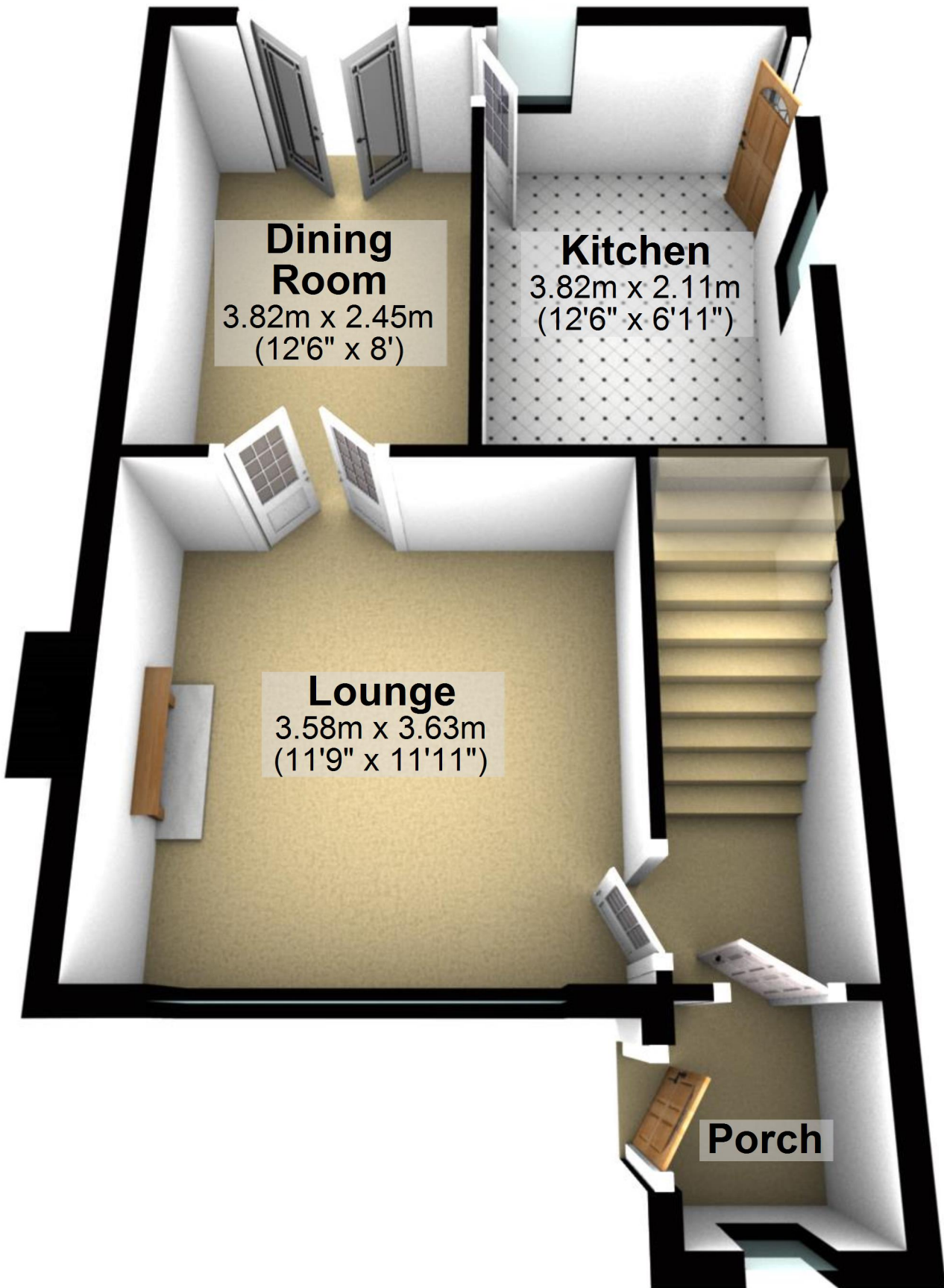

Total area: approx. 90.3 sq. metres (972.1 sq. feet)

For illustrative purposes only. Not to scale. All sizes are approximate.

Plan produced using PlanUp.

# First Floor

Approx. 37.4 sq. metres (403.0 sq. feet)

**Bedroom 2**  
3.78m x 2.76m  
(12'5" x 9'1")

**Bathroom**  
2.50m x 1.86m  
(8'2" x 6'1")

**Landing**

**Bedroom 1**  
3.62m x 3.69m  
(11'11" x 12'1")



## Second Floor

Approx. 14.9 sq. metres (160.0 sq. feet)

A 3D architectural rendering of a loft room. The room has a light-colored carpeted floor and walls. A staircase with a silver handrail is visible on the right side. The room is viewed from a high angle, looking down into the space.

**Loft**

**Room**

3.55m x 4.19m  
(11'8" x 13'9")