

# Ground Floor

Approx. 36.9 sq. metres (397.1 sq. feet)

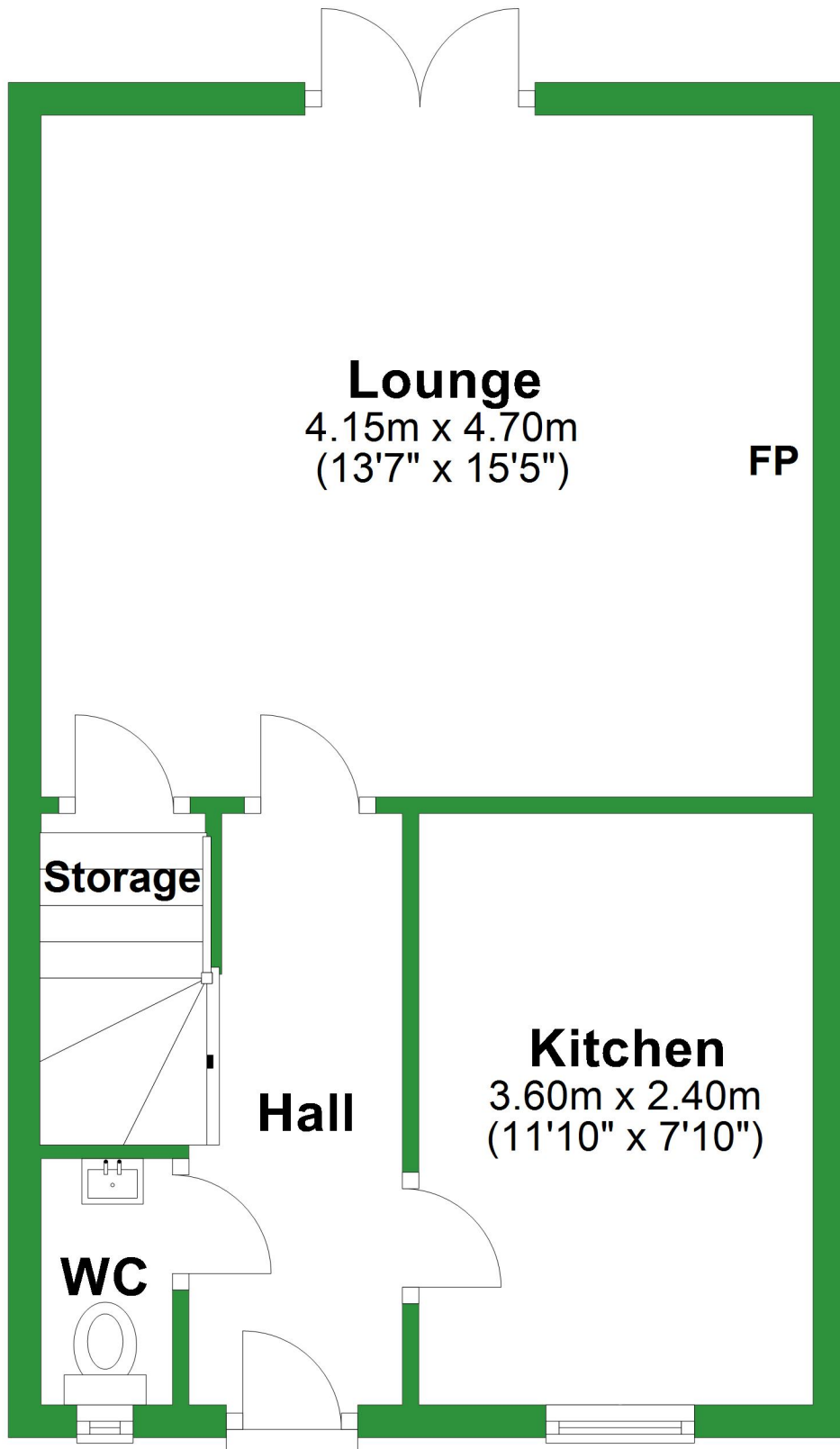

Total area: approx. 73.8 sq. metres (794.5 sq. feet)

For illustrative purposes only. Not to scale. All sizes are approximate.

Plan produced using PlanUp.

# First Floor

Approx. 36.9 sq. metres (397.4 sq. feet)

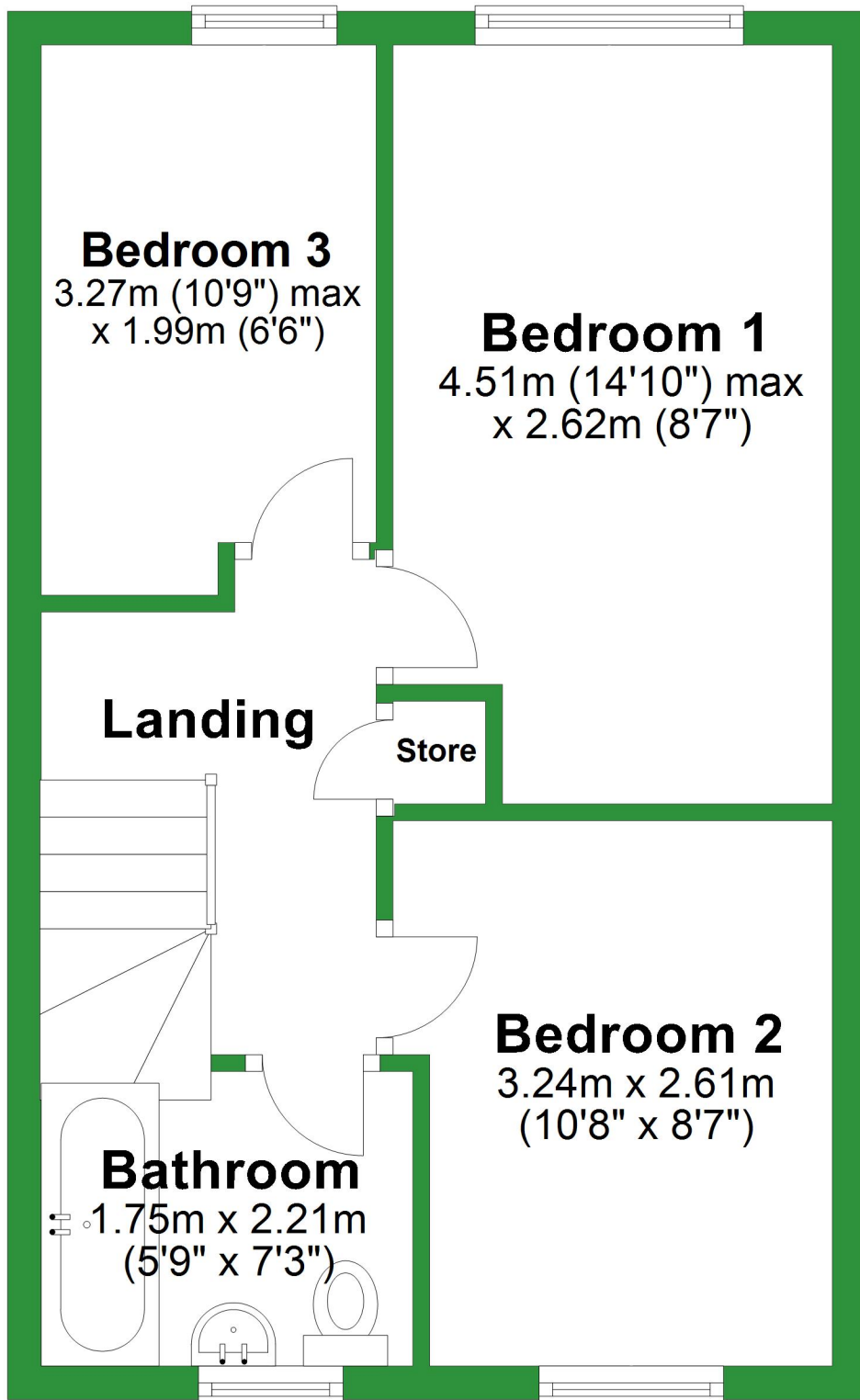

# Ground Floor

Approx. 36.9 sq. metres (397.1 sq. feet)

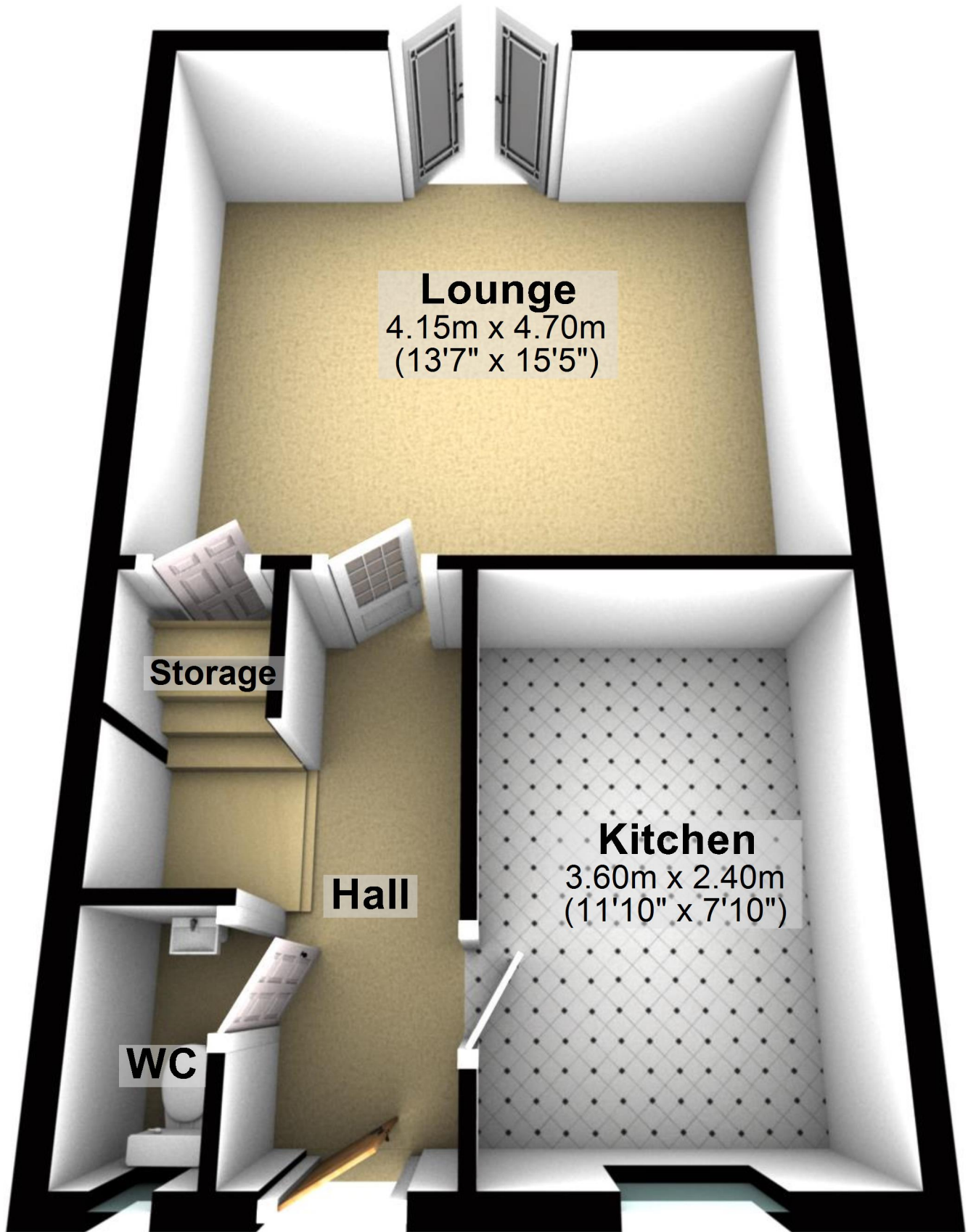

Total area: approx. 73.8 sq. metres (794.5 sq. feet)

For illustrative purposes only. Not to scale. All sizes are approximate.

Plan produced using PlanUp.

# First Floor

Approx. 36.9 sq. metres (397.4 sq. feet)

## Bedroom 3

3.27m (10'9") max  
x 1.99m (6'6")

## Bedroom 1

4.51m (14'10") max  
x 2.62m (8'7")

## Landing

Store

## Bedroom 2

3.24m x 2.61m  
(10'8" x 8'7")

## Bathroom

1.75m x 2.21m  
(5'9" x 7'3")

