

Ground Floor

Approx. 50.1 sq. metres (538.8 sq. feet)

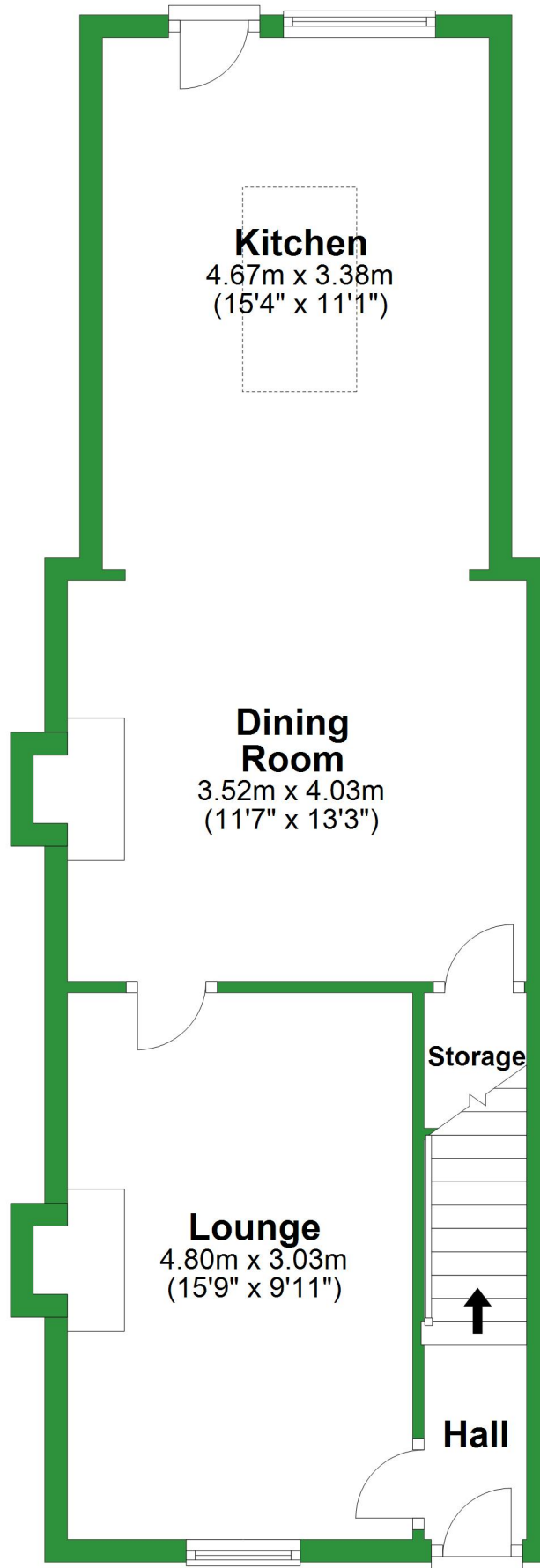

Total area: approx. 101.8 sq. metres (1095.4 sq. feet)

For illustrative purposes only. Not to scale. All sizes are approximate.
Plan produced using PlanUp.

First Floor

Approx. 33.9 sq. metres (365.1 sq. feet)

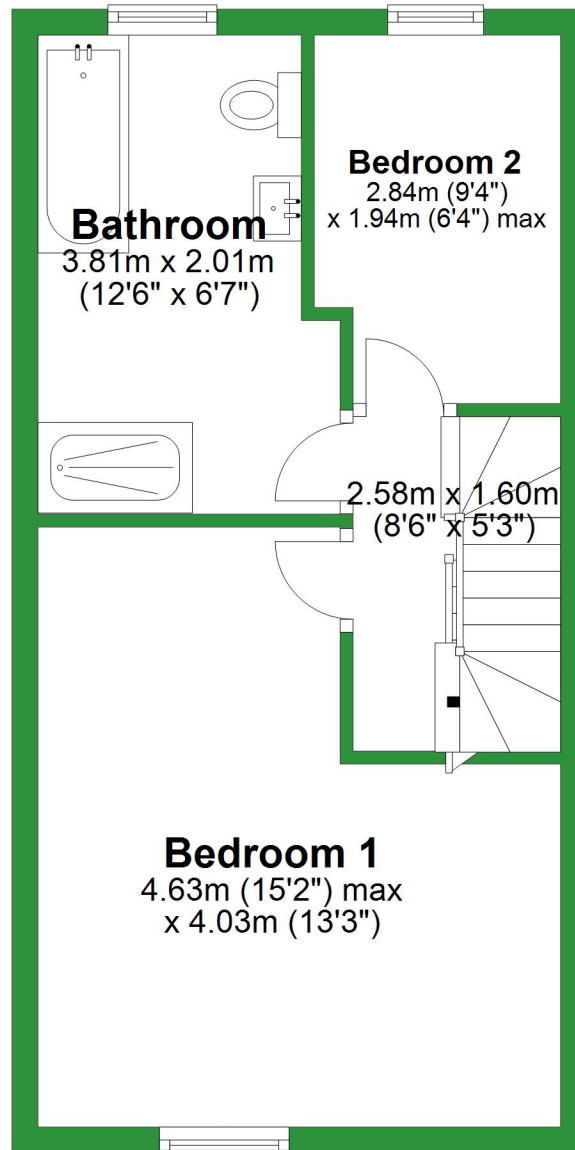

Second Floor

Approx. 17.8 sq. metres (191.5 sq. feet)

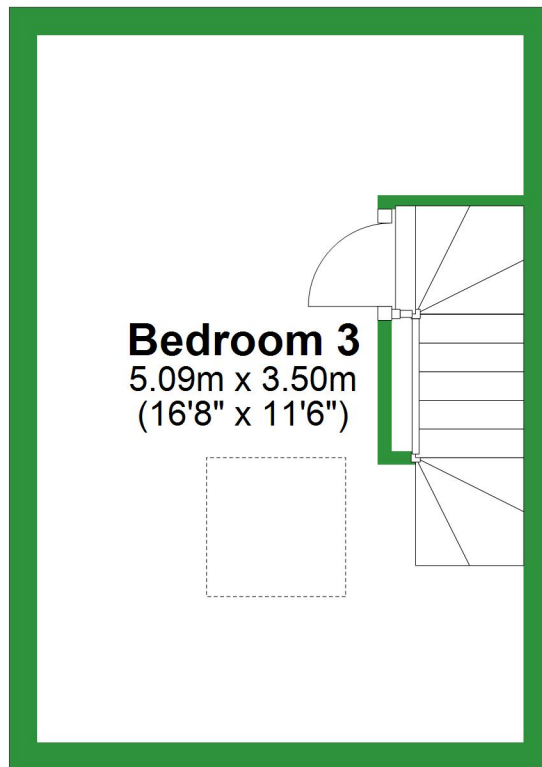

Ground Floor

Approx. 50.1 sq. metres (538.8 sq. feet)

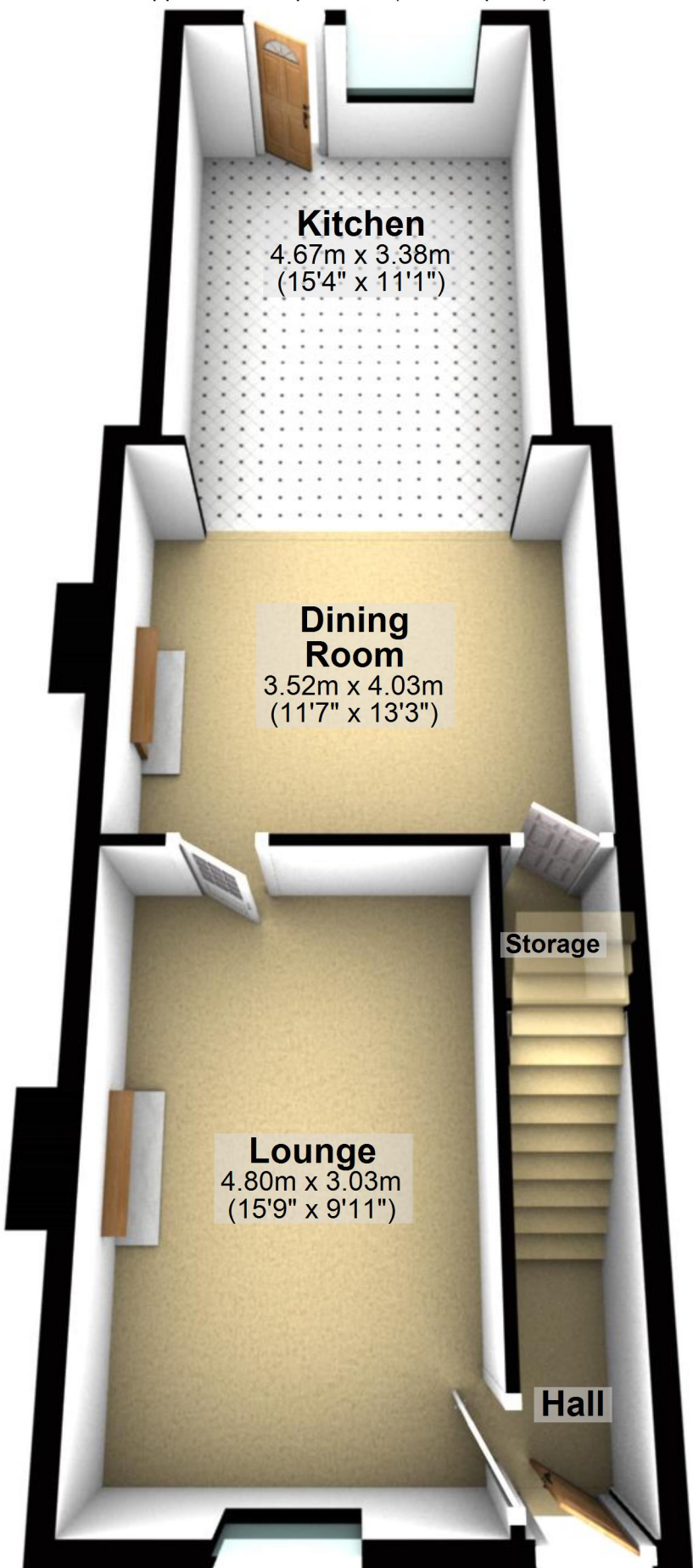

Kitchen

4.67m x 3.38m
(15'4" x 11'1")

Dining Room

3.52m x 4.03m
(11'7" x 13'3")

Lounge

4.80m x 3.03m
(15'9" x 9'11")

Storage

Hall

Total area: approx. 101.8 sq. metres (1095.4 sq. feet)

For illustrative purposes only. Not to scale. All sizes are approximate.

Plan produced using PlanUp.

First Floor

Approx. 33.9 sq. metres (365.1 sq. feet)

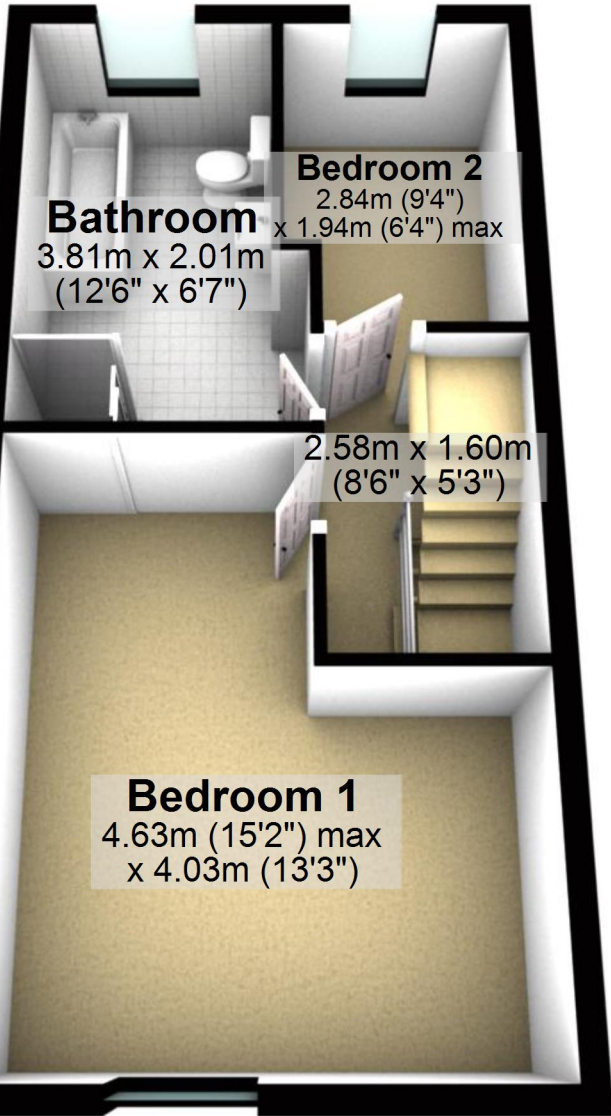

Second Floor

Approx. 17.8 sq. metres (191.5 sq. feet)

A 3D architectural rendering of a bedroom. The room is rectangular with light-colored walls and a beige carpet. A white door is open on the right side, leading to a hallway. The room is framed by a thick black border.

Bedroom 3
5.09m x 3.50m
(16'8" x 11'6")