

# Ground Floor

Approx. 50.1 sq. metres (539.0 sq. feet)

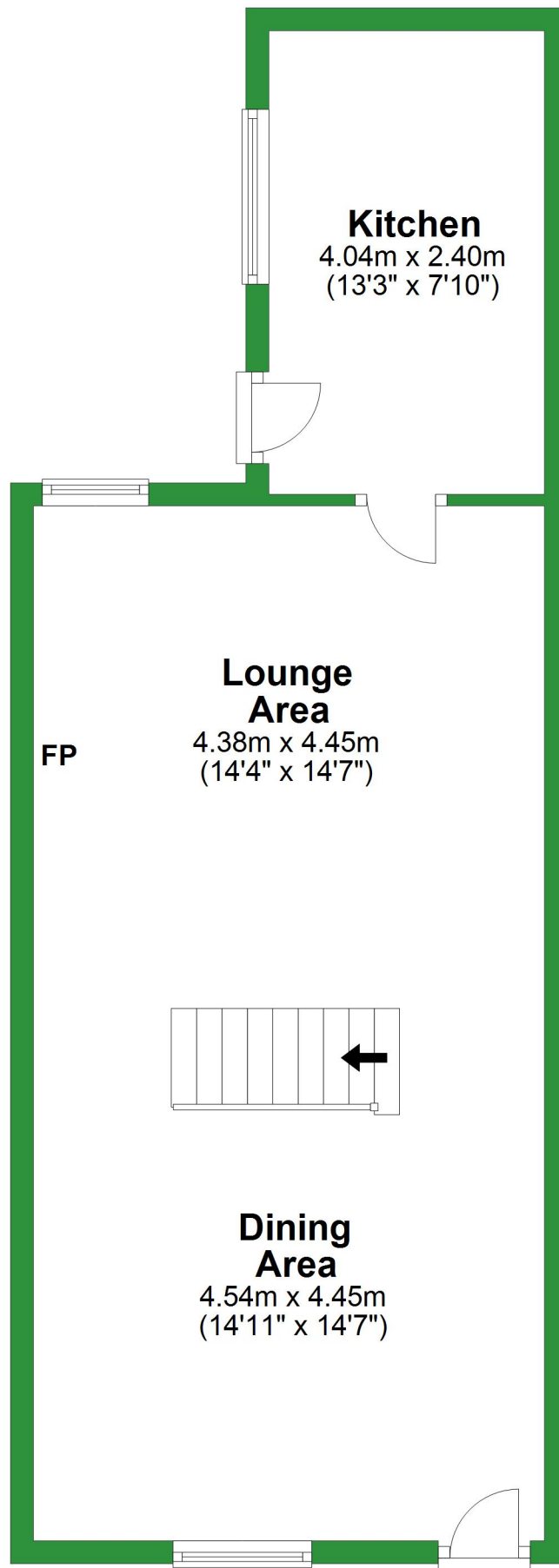

Total area: approx. 89.9 sq. metres (967.4 sq. feet)

For illustrative purposes only. Not to scale. All sizes are approximate.  
Plan produced using PlanUp.

# First Floor

Approx. 39.8 sq. metres (428.4 sq. feet)

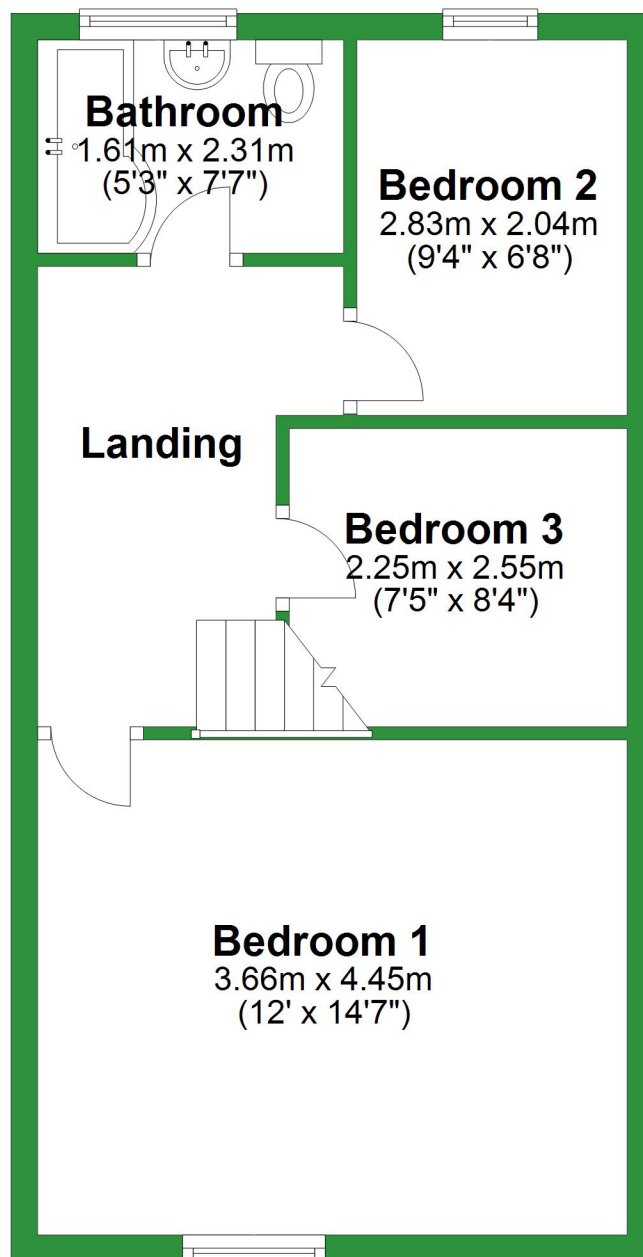

# Ground Floor

Approx. 50.1 sq. metres (539.0 sq. feet)

## Kitchen

4.04m x 2.40m  
(13'3" x 7'10")

## Lounge Area

4.38m x 4.45m  
(14'4" x 14'7")

## Dining Area

4.54m x 4.45m  
(14'11" x 14'7")

Total area: approx. 89.9 sq. metres (967.4 sq. feet)

For illustrative purposes only. Not to scale. All sizes are approximate.

Plan produced using PlanUp.

# First Floor

Approx. 39.8 sq. metres (428.4 sq. feet)

## Bathroom

1.61m x 2.31m  
(5'3" x 7'7")

## Bedroom 2

2.83m x 2.04m  
(9'4" x 6'8")

## Landing

## Bedroom 3

2.25m x 2.55m  
(7'5" x 8'4")

## Bedroom 1

3.66m x 4.45m  
(12' x 14'7")

