

# Ground Floor

Approx. 118.0 sq. metres (1270.0 sq. feet)

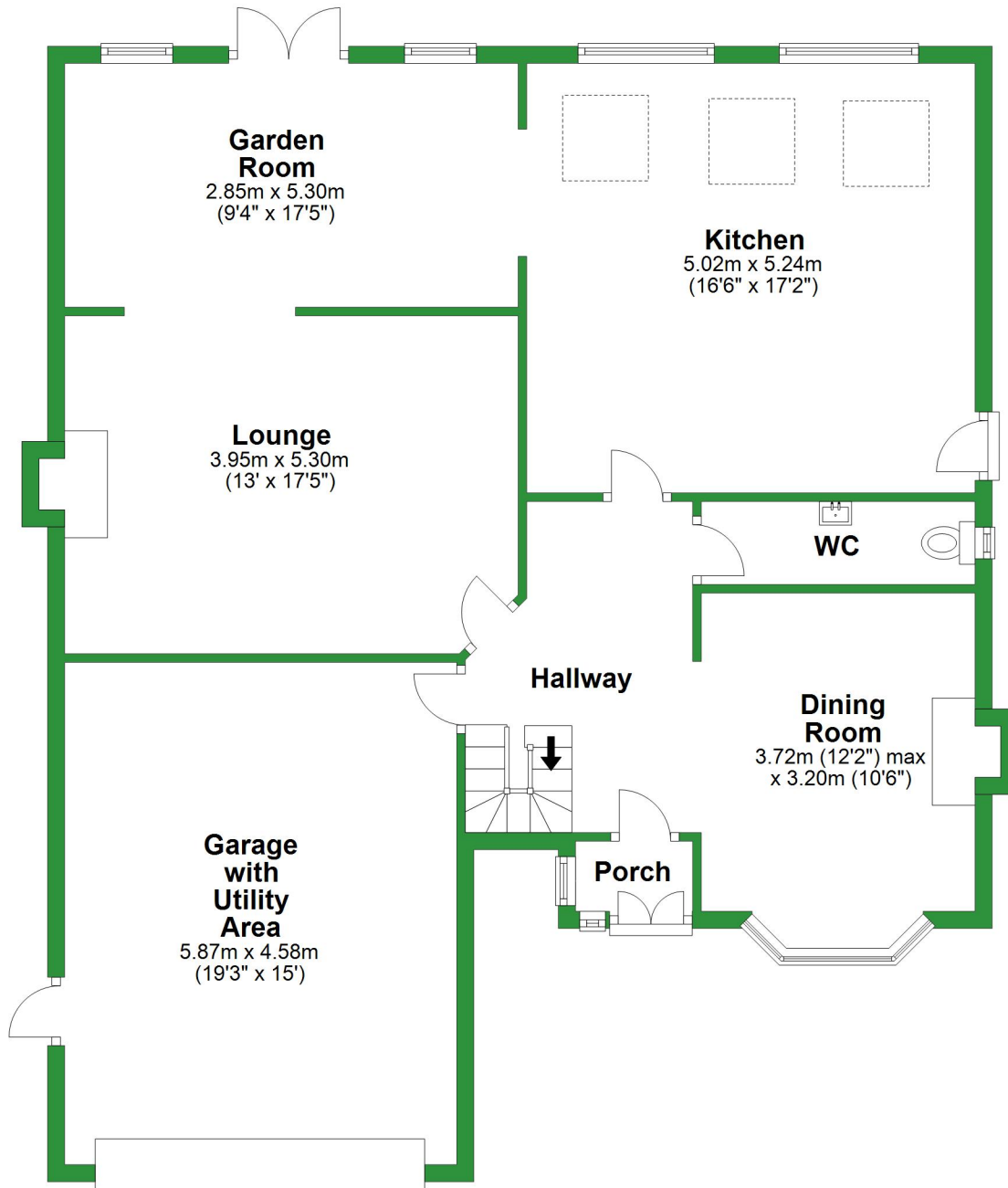

Total area: approx. 201.9 sq. metres (2173.6 sq. feet)

For illustrative purposes only. Not to scale. All sizes are approximate.  
Plan produced using PlanUp.

# First Floor

Approx. 84.0 sq. metres (903.7 sq. feet)

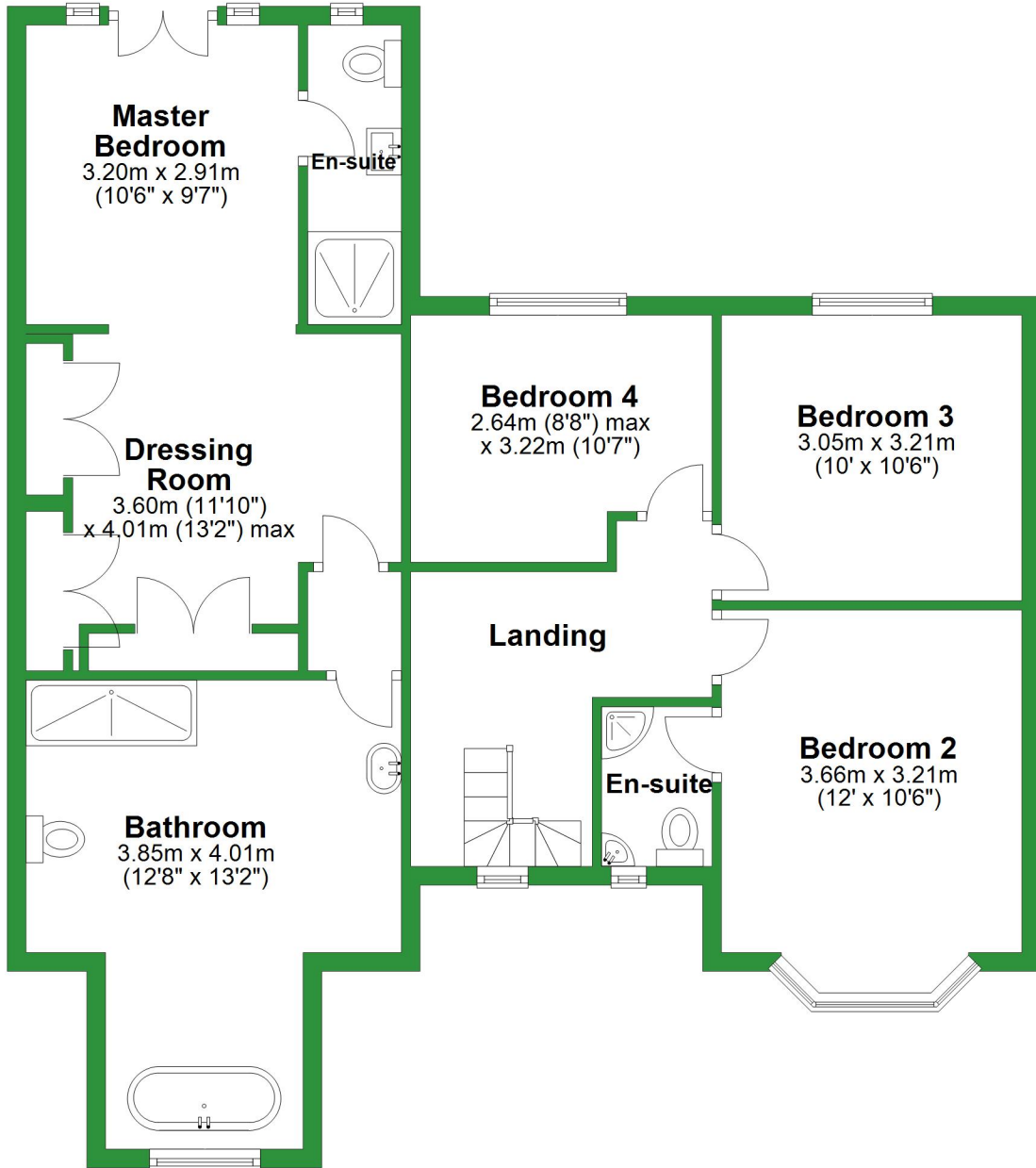

# Ground Floor

Approx. 118.0 sq. metres (1270.0 sq. feet)

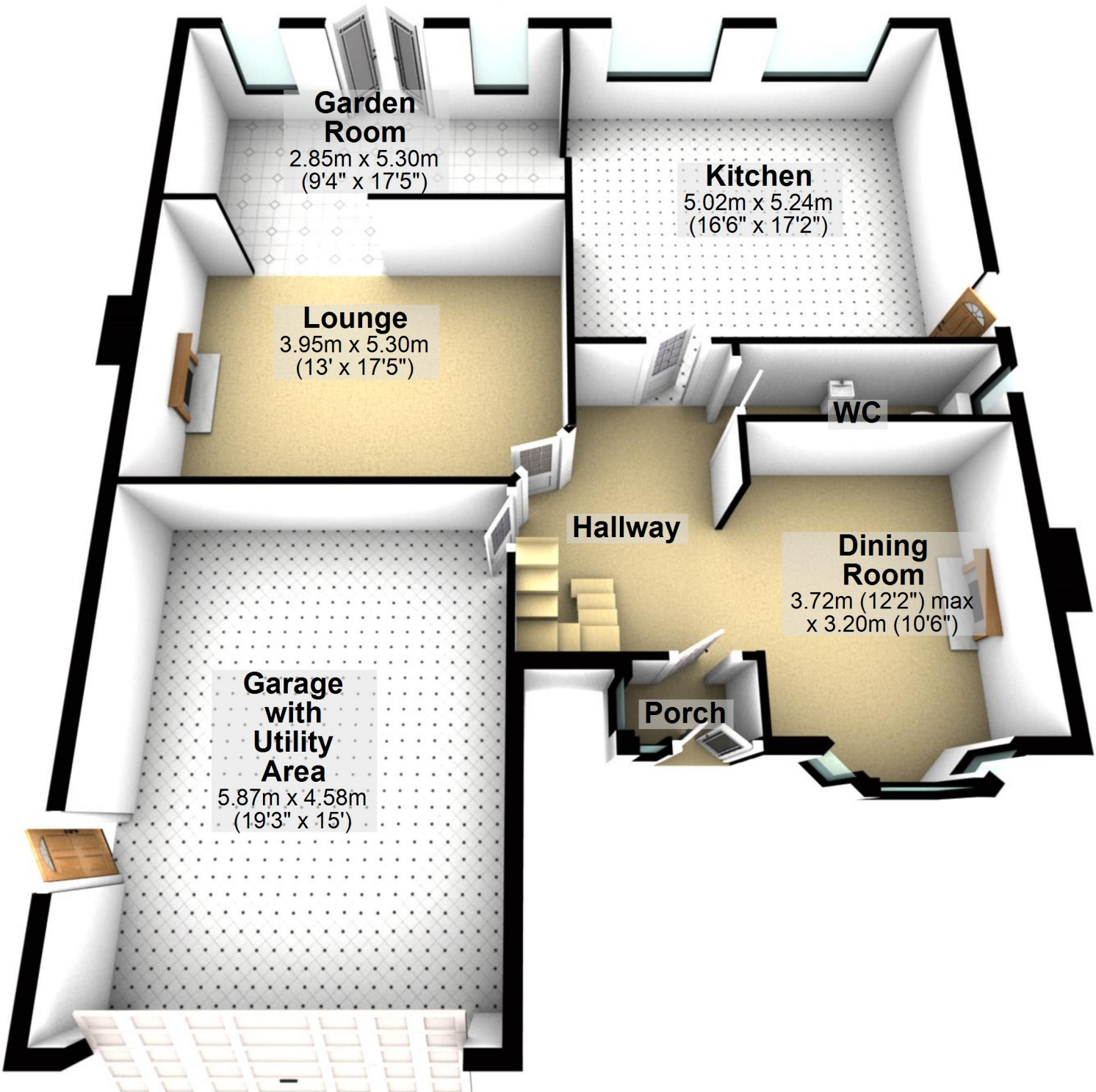

Total area: approx. 201.9 sq. metres (2173.6 sq. feet)

For illustrative purposes only. Not to scale. All sizes are approximate.  
Plan produced using PlanUp.

# First Floor

Approx. 84.0 sq. metres (903.7 sq. feet)

