

# Ground Floor

Approx. 52.2 sq. metres (561.8 sq. feet)

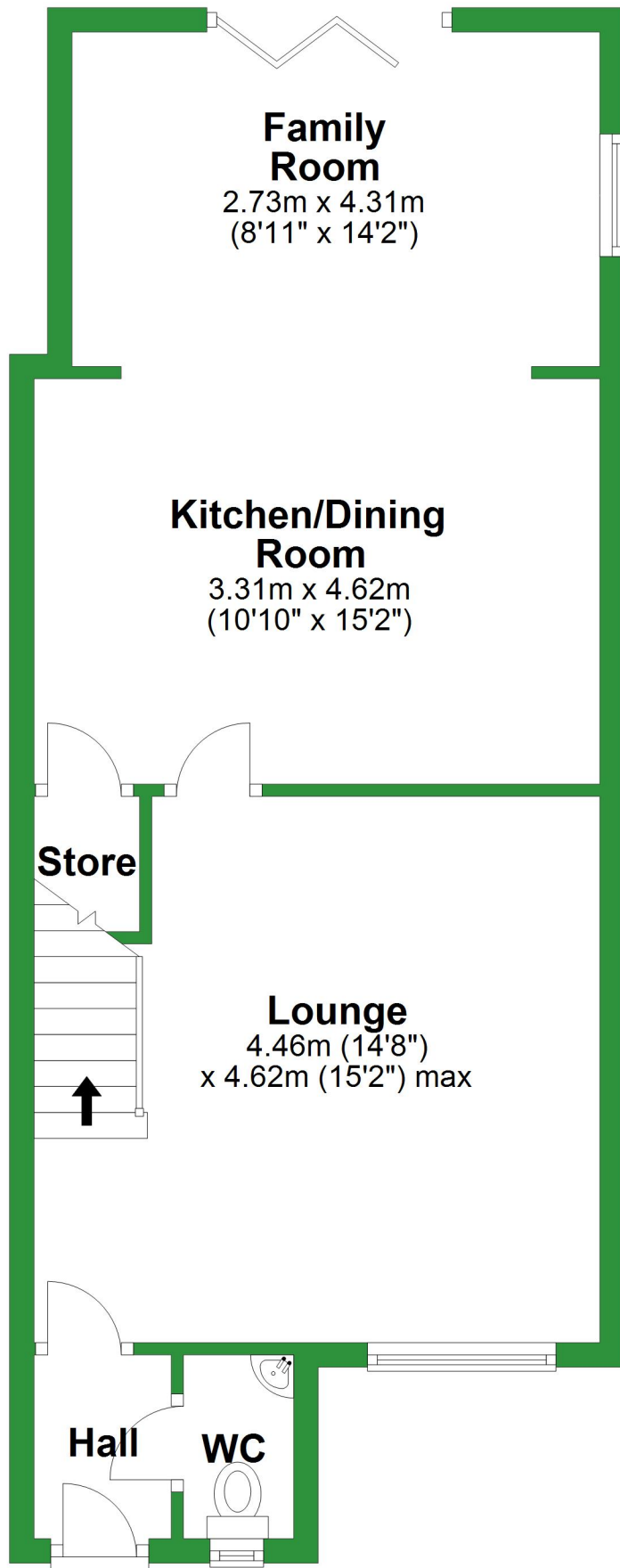

Total area: approx. 91.9 sq. metres (989.6 sq. feet)

For illustrative purposes only. Not to scale. All sizes are approximate.  
Plan produced using PlanUp.

# First Floor

Approx. 39.8 sq. metres (427.9 sq. feet)

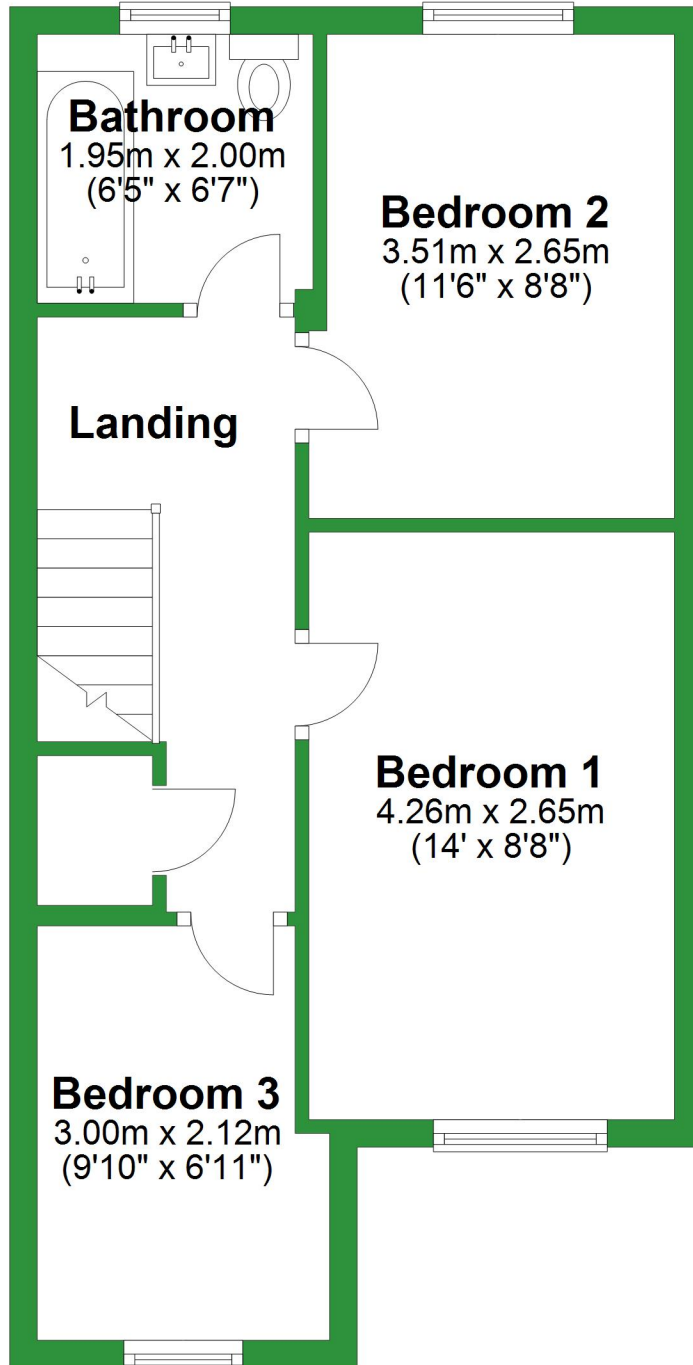

# Ground Floor

Approx. 52.2 sq. metres (561.8 sq. feet)

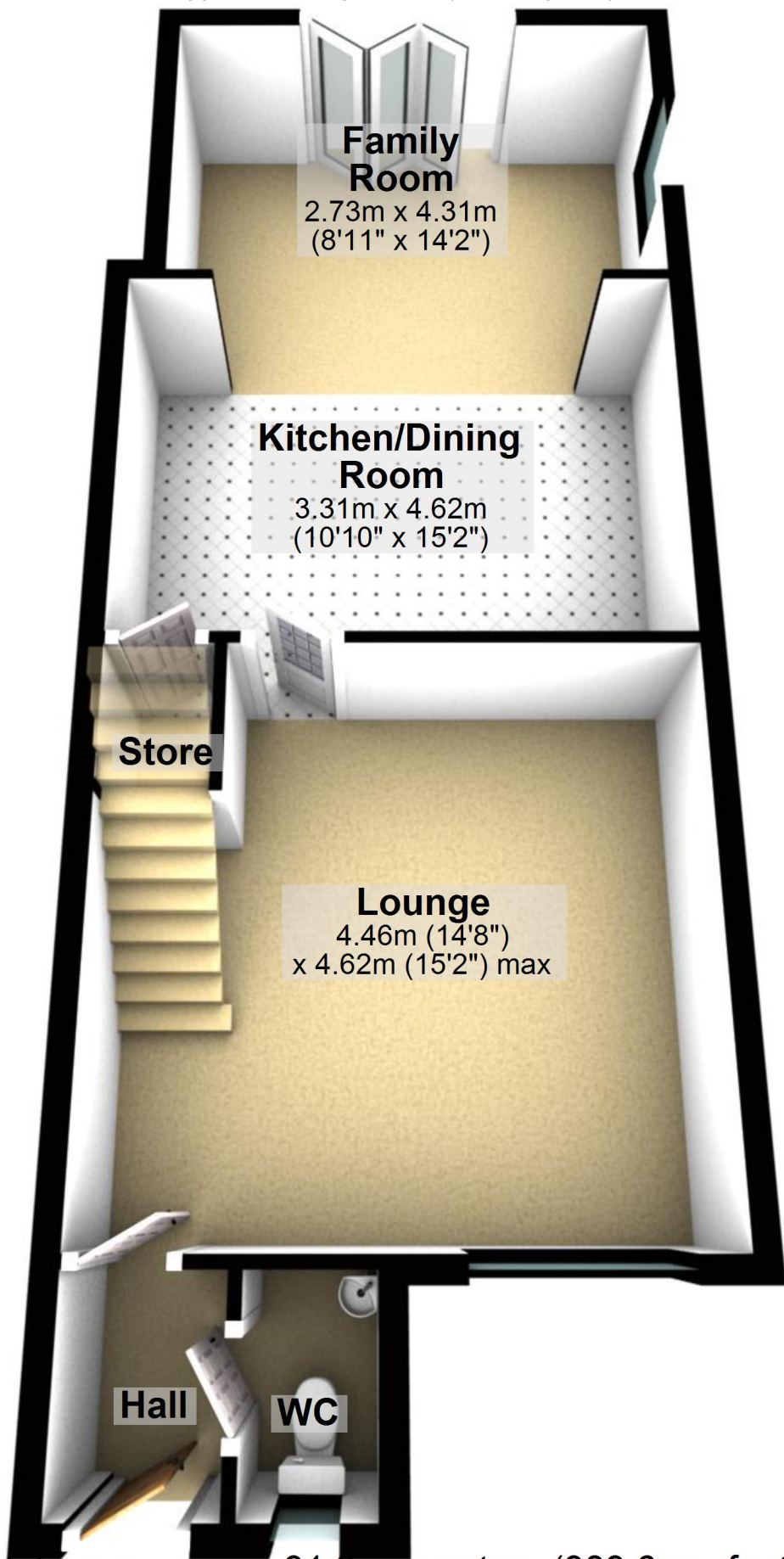

Total area: approx. 91.9 sq. metres (989.6 sq. feet)

For illustrative purposes only. Not to scale. All sizes are approximate.

Plan produced using PlanUp.

# First Floor

Approx. 39.8 sq. metres (427.9 sq. feet)

## Bathroom

1.95m x 2.00m  
(6'5" x 6'7")

## Bedroom 2

3.51m x 2.65m  
(11'6" x 8'8")

## Landing

## Bedroom 1

4.26m x 2.65m  
(14' x 8'8")

## Bedroom 3

3.00m x 2.12m  
(9'10" x 6'11")

