

Basement

Approx. 5.2 sq. metres (56.2 sq. feet)

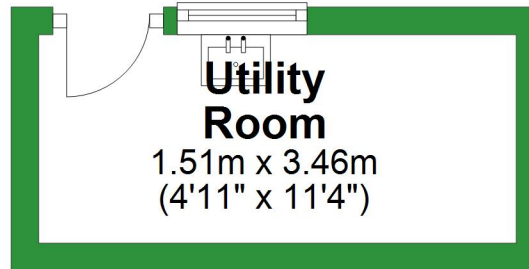

Total area: approx. 133.5 sq. metres (1436.8 sq. feet)

For illustrative purposes only. Not to scale. All sizes are approximate.
Plan produced using PlanUp.

Ground Floor

Approx. 77.5 sq. metres (834.1 sq. feet)

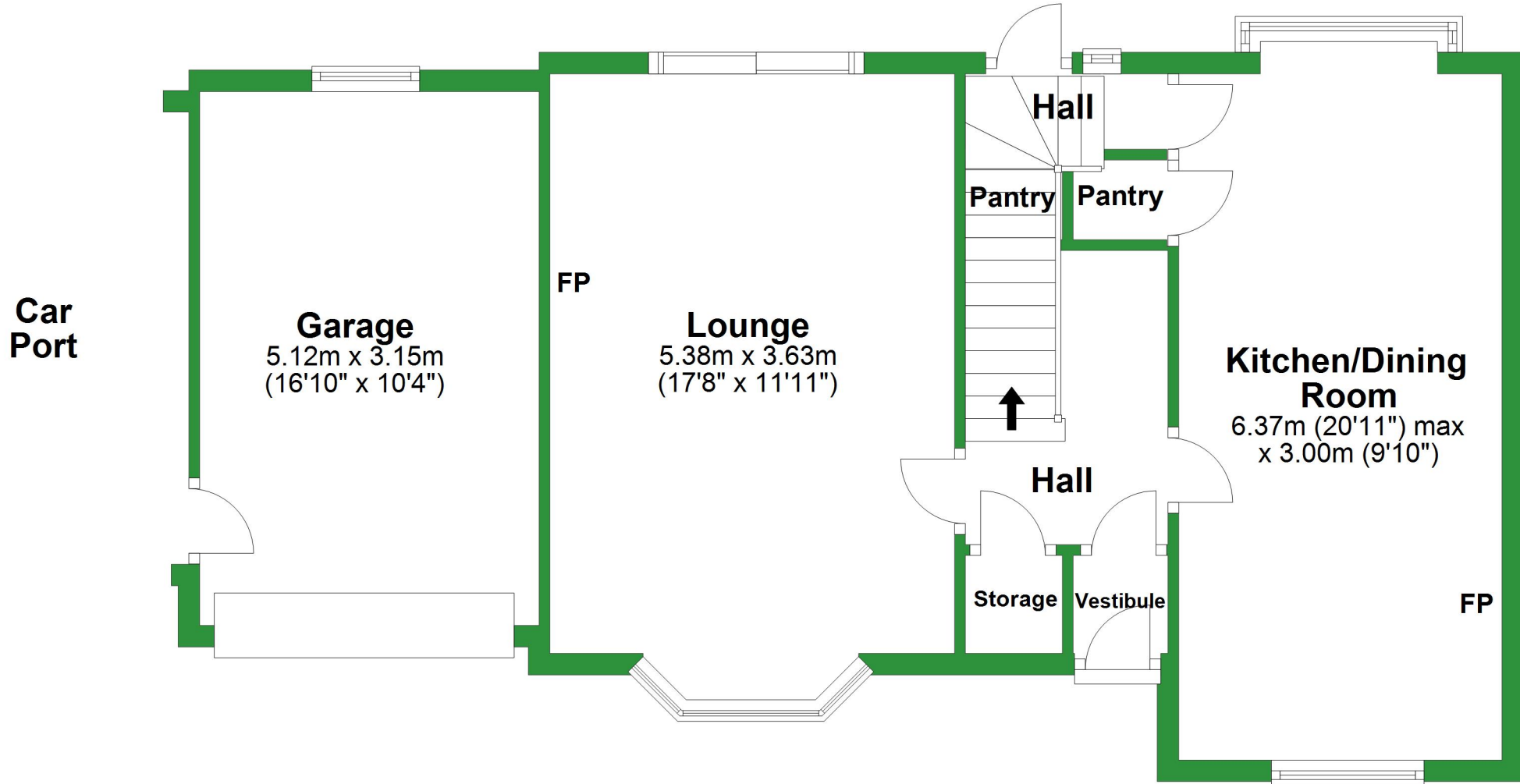

First Floor

Approx. 50.8 sq. metres (546.5 sq. feet)

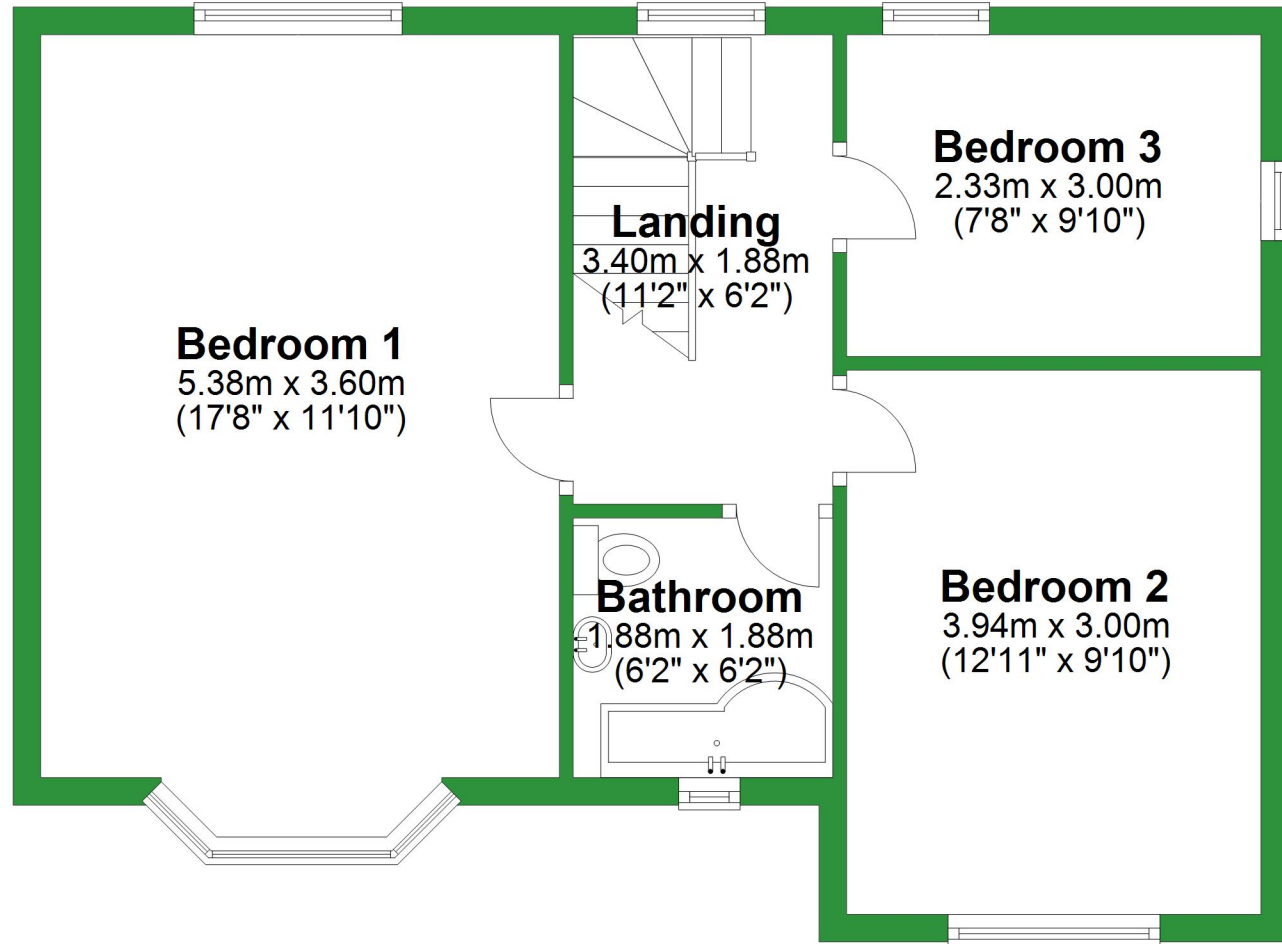

Basement

Approx. 5.2 sq. metres (56.2 sq. feet)

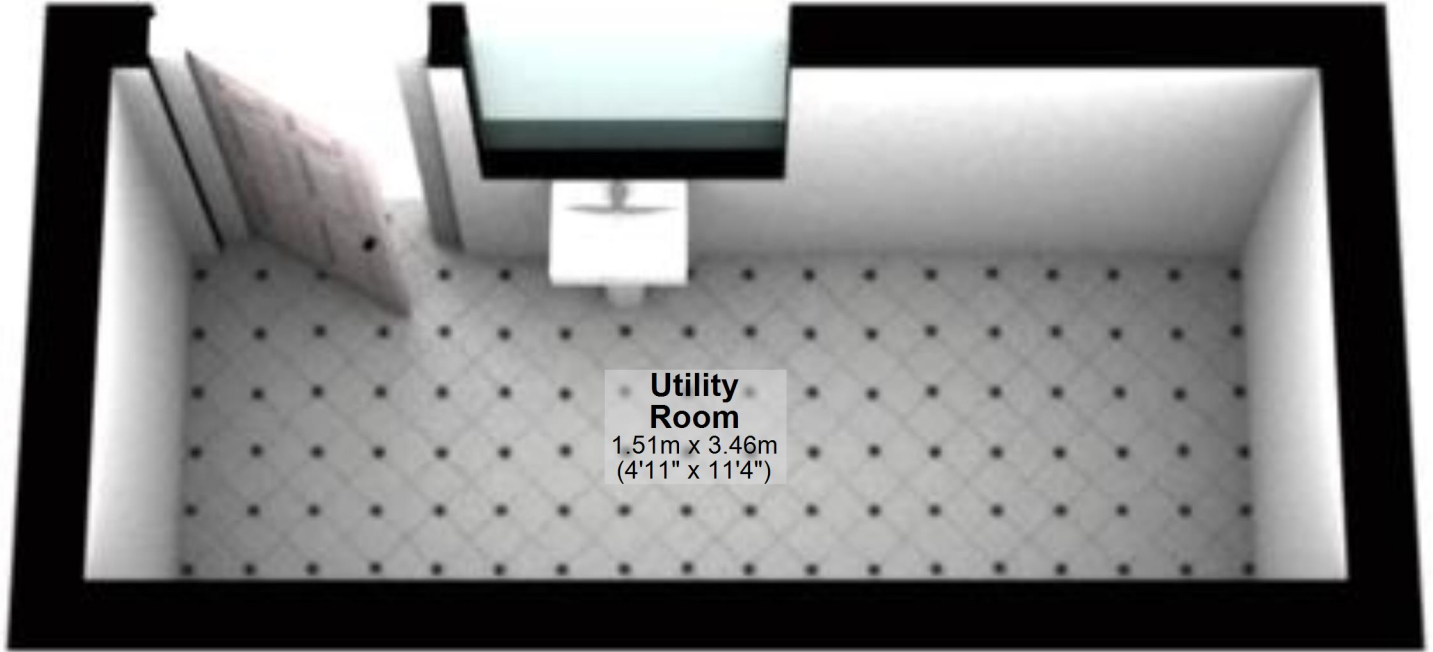

Utility Room

1.51m x 3.46m
(4'11" x 11'4")

Total area: approx. 133.5 sq. metres (1436.8 sq. feet)

For illustrative purposes only. Not to scale. All sizes are approximate.
Plan produced using PlanUp.

Ground Floor

Approx. 77.5 sq. metres (834.1 sq. feet)

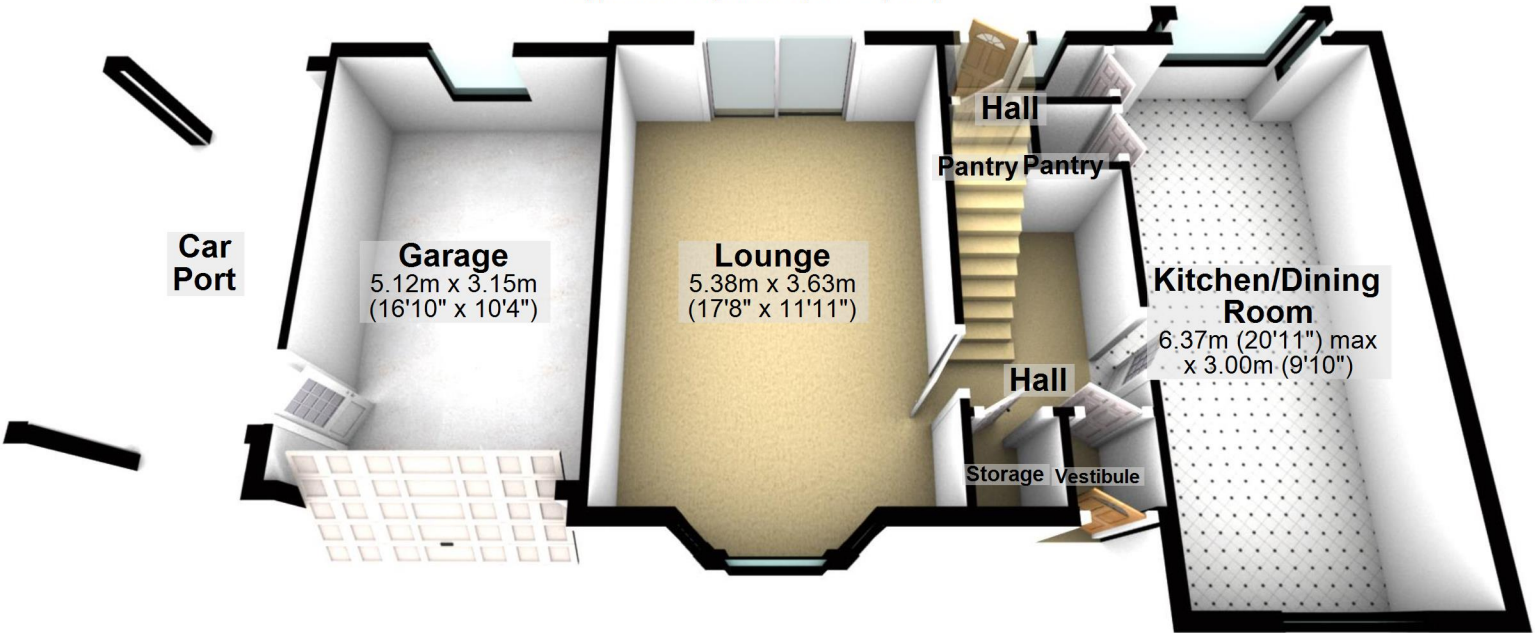

Car Port

Garage
5.12m x 3.15m
(16'10" x 10'4")

Lounge
5.38m x 3.63m
(17'8" x 11'11")

Hall

Pantry Pantry

Kitchen/Dining Room
6.37m (20'11") max
x 3.00m (9'10")

Hall

Storage Vestibule

First Floor

Approx. 50.8 sq. metres (546.5 sq. feet)

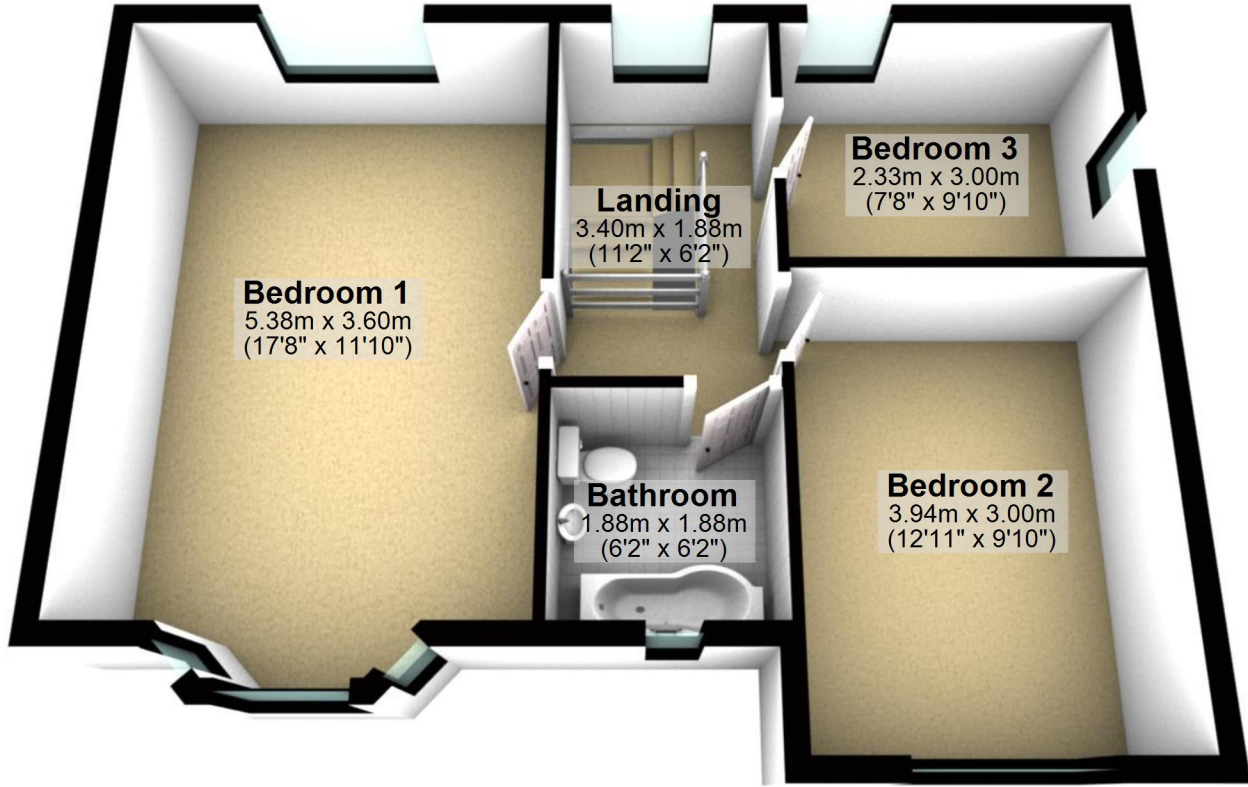

Bedroom 1
5.38m x 3.60m
(17'8" x 11'10")

Landing
3.40m x 1.88m
(11'2" x 6'2")

Bedroom 3
2.33m x 3.00m
(7'8" x 9'10")

Bathroom
1.88m x 1.88m
(6'2" x 6'2")

Bedroom 2
3.94m x 3.00m
(12'11" x 9'10")