

# Ground Floor

Approx. 43.4 sq. metres (466.7 sq. feet)

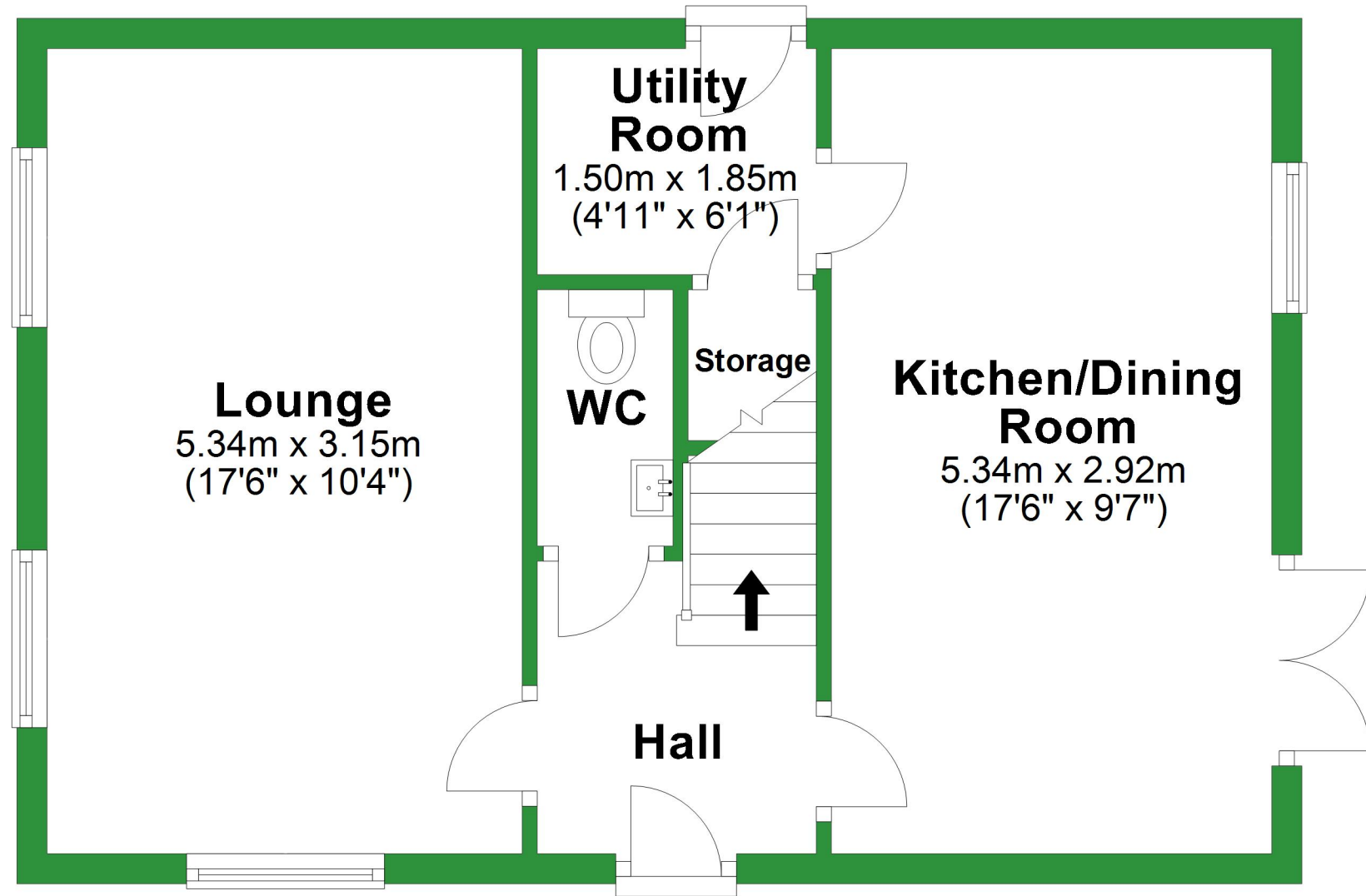

Total area: approx. 86.6 sq. metres (931.6 sq. feet)

For illustrative purposes only. Not to scale. All sizes are approximate.  
Plan produced using PlanUp.

# First Floor

Approx. 43.2 sq. metres (464.9 sq. feet)

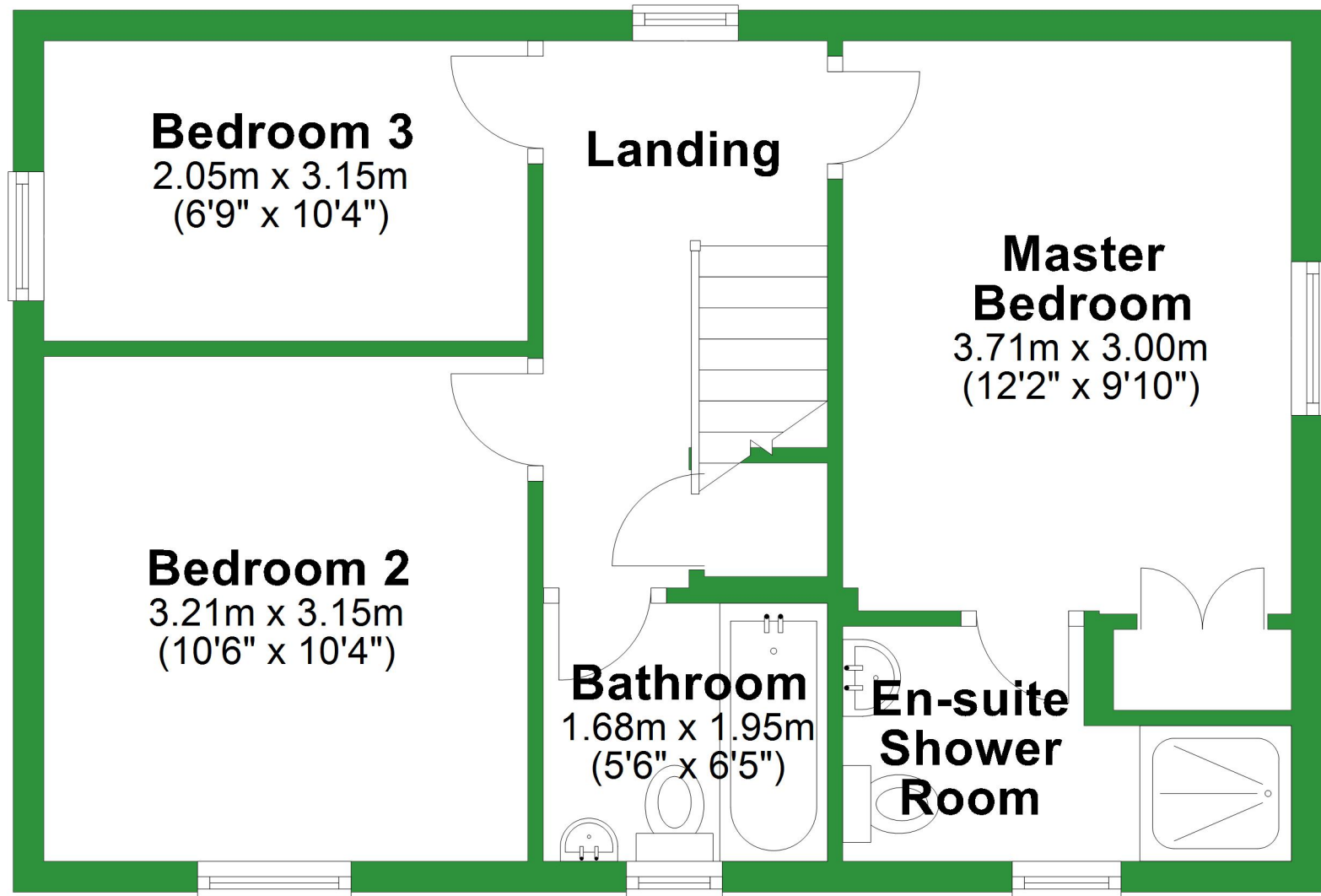

# Ground Floor

Approx. 43.4 sq. metres (466.7 sq. feet)

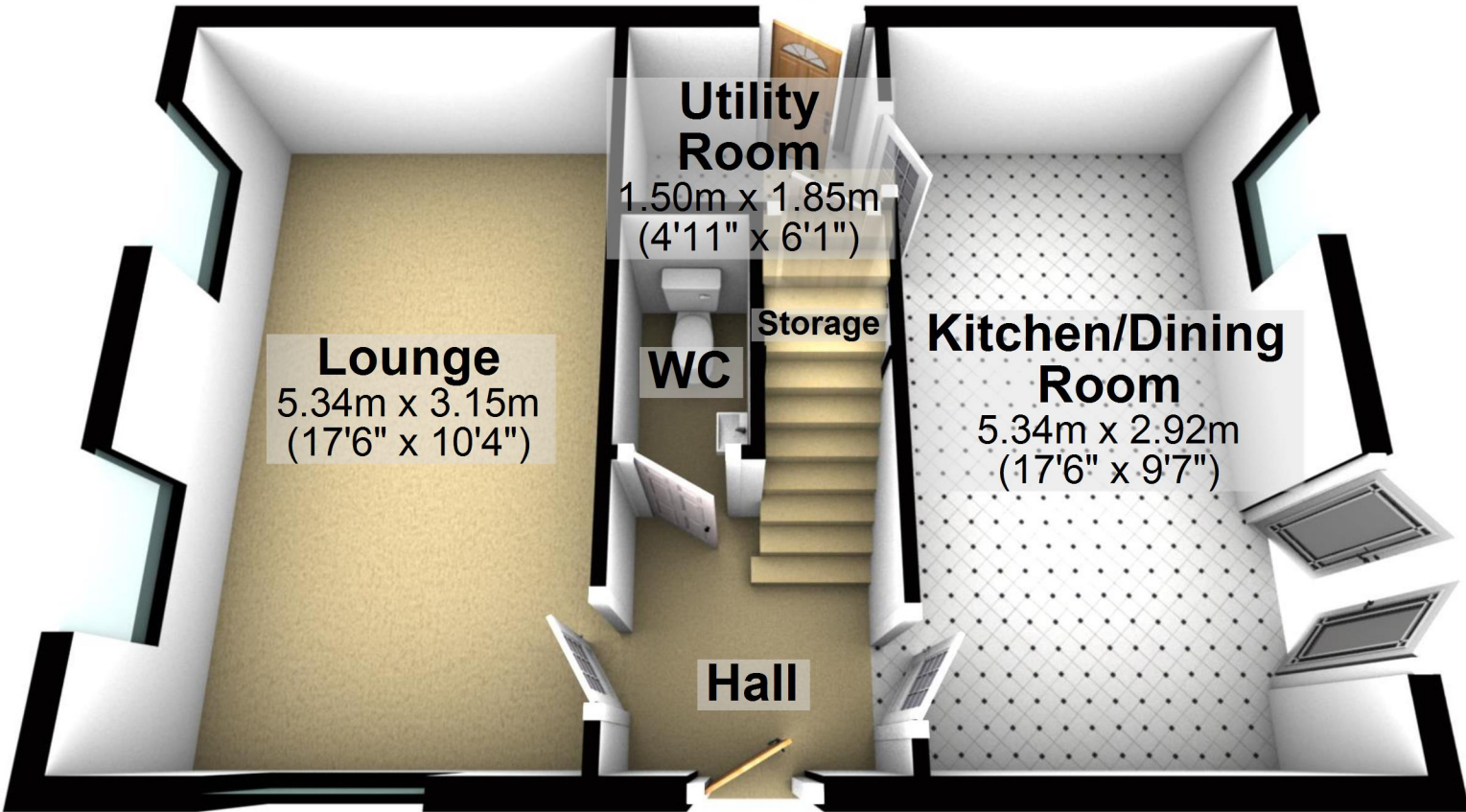

Total area: approx. 86.6 sq. metres (931.6 sq. feet)

For illustrative purposes only. Not to scale. All sizes are approximate.  
Plan produced using PlanUp.

# First Floor

Approx. 43.2 sq. metres (464.9 sq. feet)

