

# Ground Floor

Approx. 41.5 sq. metres (447.1 sq. feet)

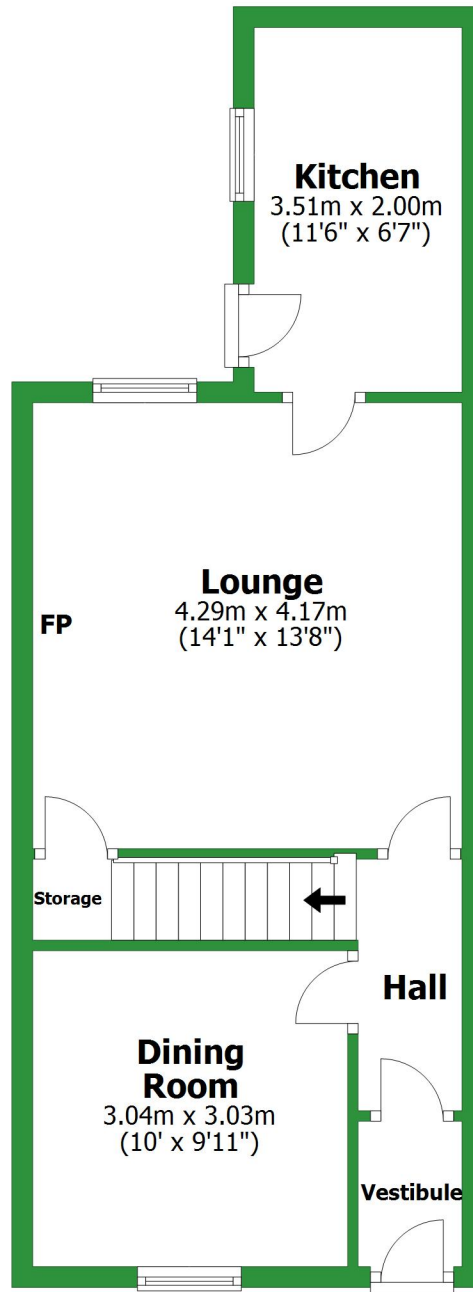

Total area: approx. 75.9 sq. metres (816.6 sq. feet)

For illustrative purposes only. Not to scale. All sizes are approximate.  
Plan produced using PlanUp.

## First Floor

Approx. 34.3 sq. metres (369.4 sq. feet)

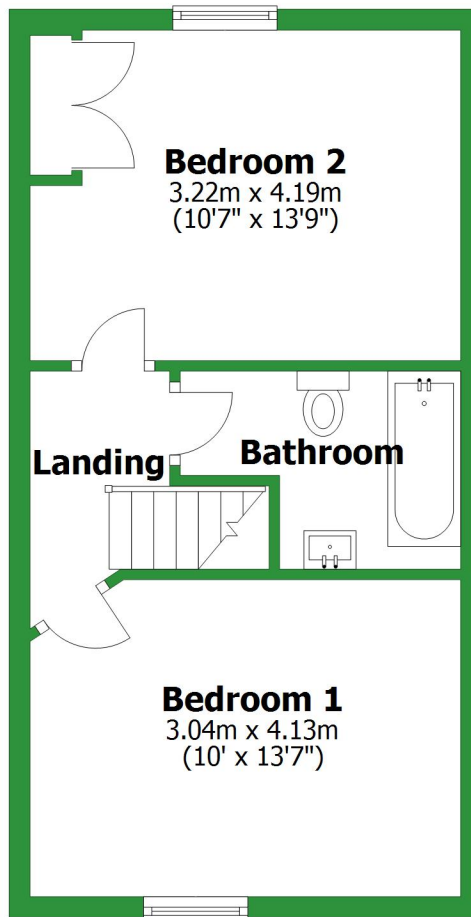

# Ground Floor

Approx. 41.5 sq. metres (447.1 sq. feet)

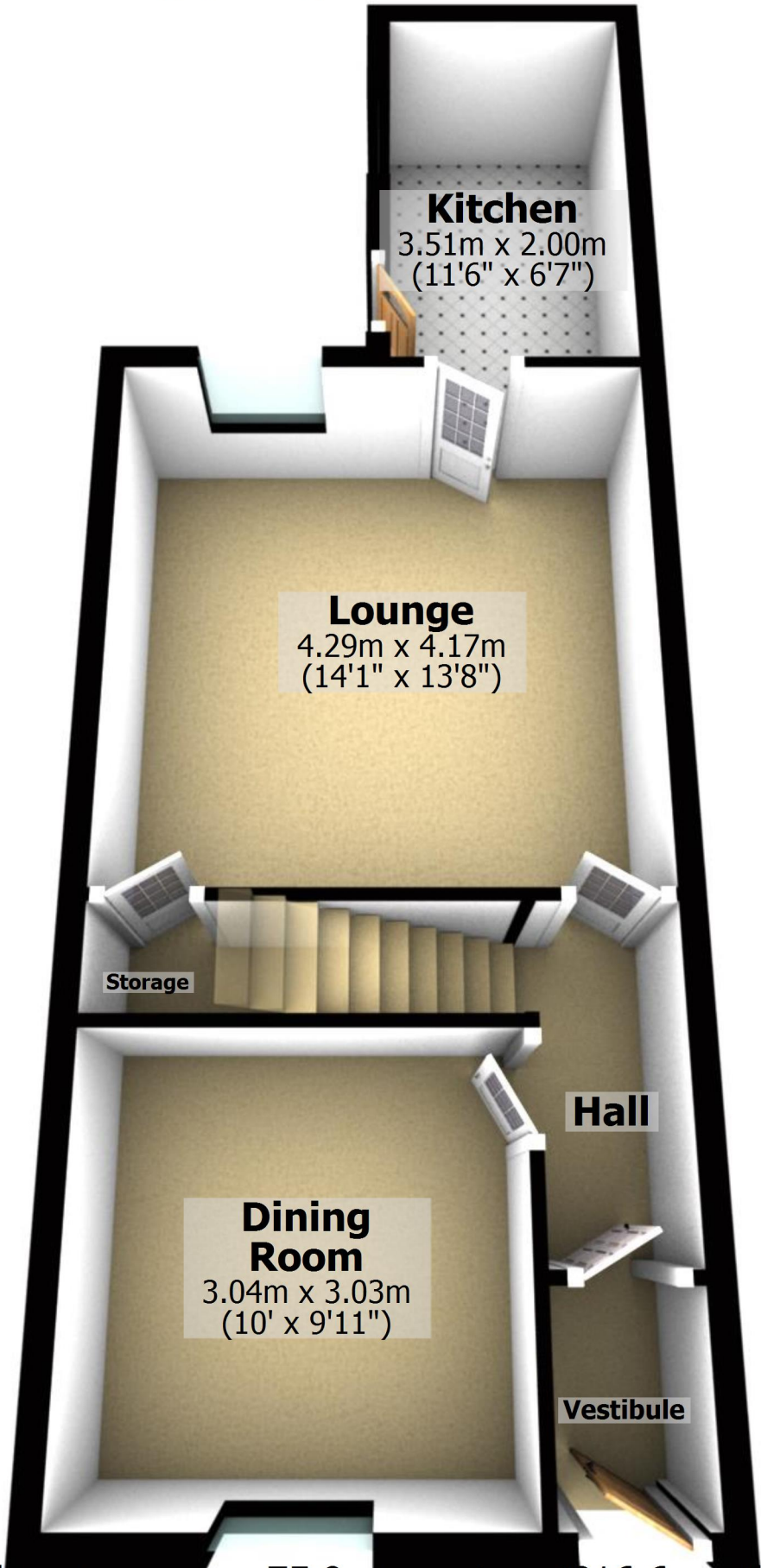

Total area: approx. 75.9 sq. metres (816.6 sq. feet)

For illustrative purposes only. Not to scale. All sizes are approximate.

Plan produced using PlanUp.

# First Floor

Approx. 34.3 sq. metres (369.4 sq. feet)

