

# Ground Floor

Approx. 67.5 sq. metres (726.6 sq. feet)

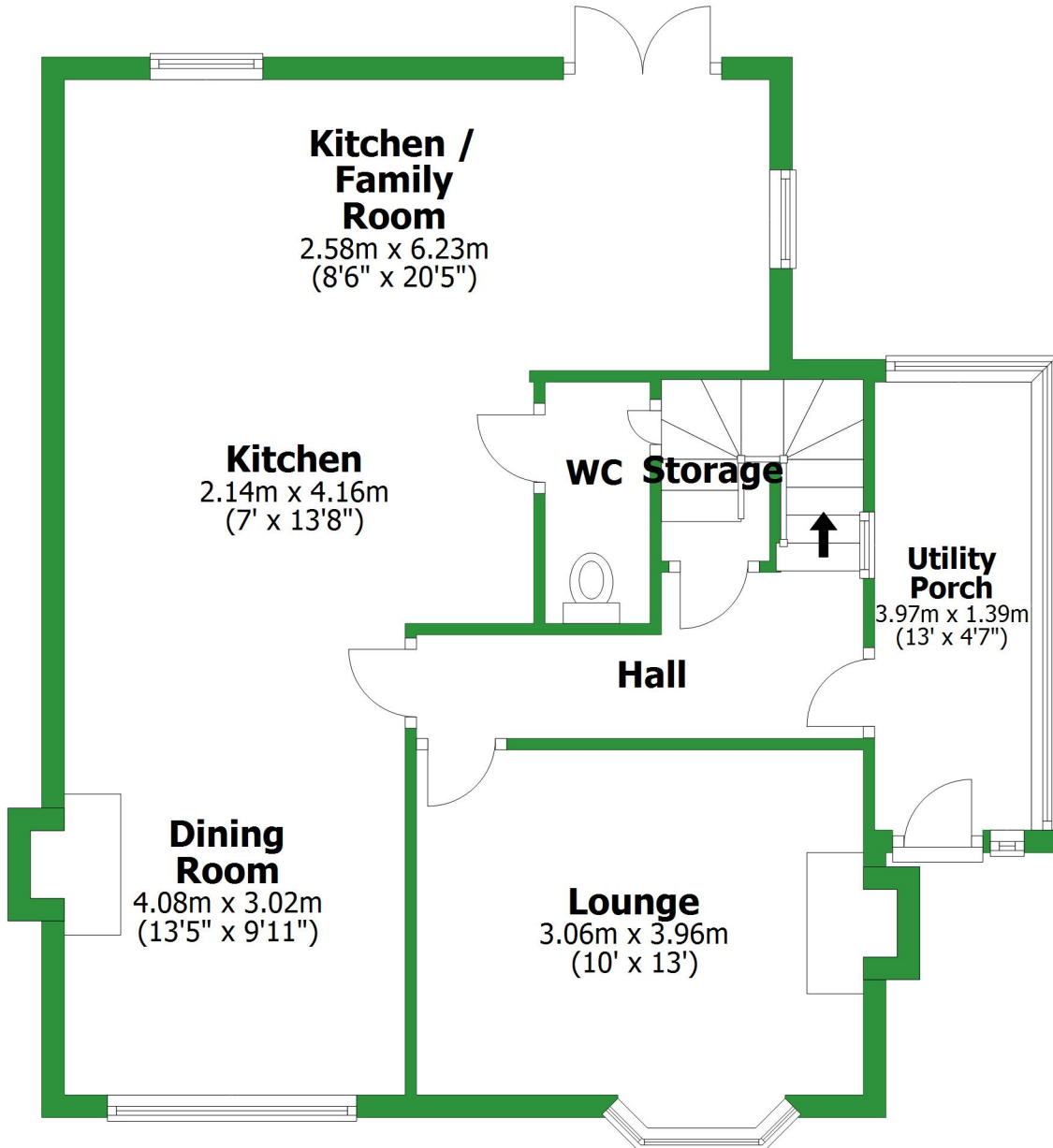

Total area: approx. 112.2 sq. metres (1208.2 sq. feet)

For illustrative purposes only. Not to scale. All sizes are approximate.

Plan produced using PlanUp.

## First Floor

Approx. 44.7 sq. metres (481.6 sq. feet)

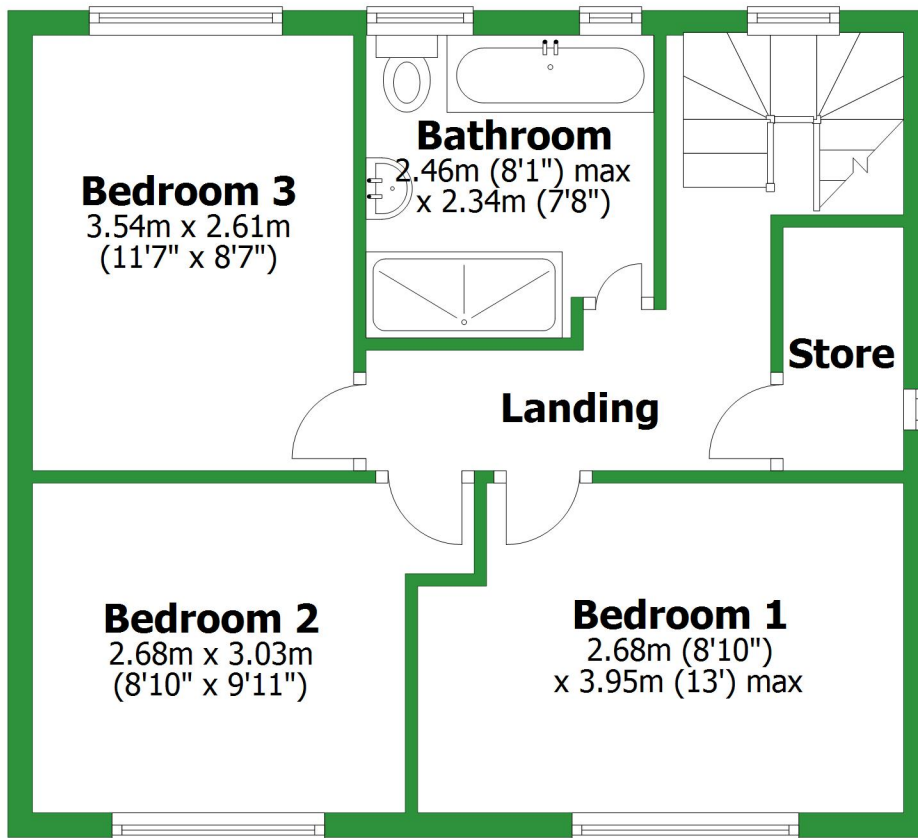

# Ground Floor

Approx. 67.5 sq. metres (726.6 sq. feet)

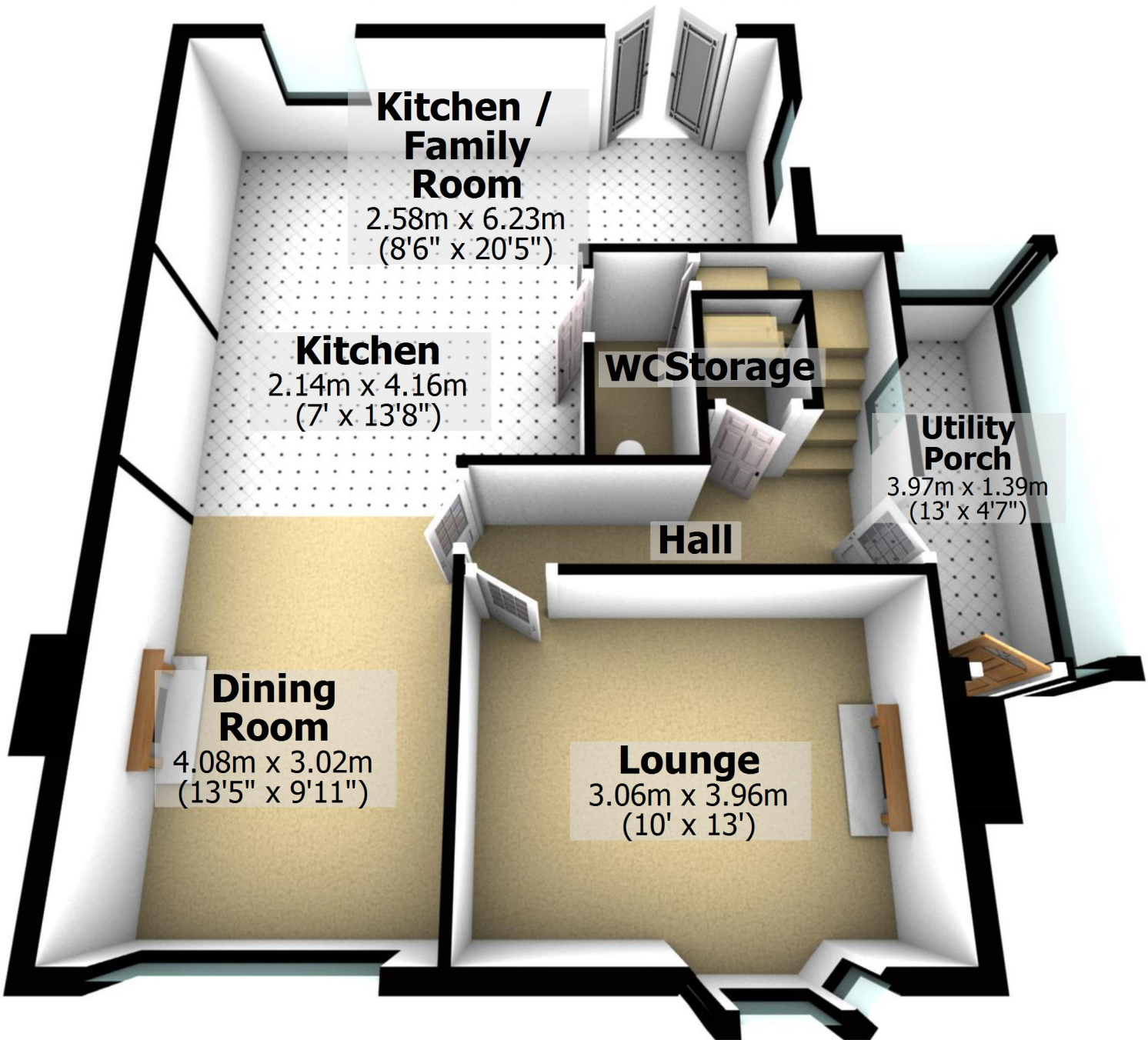

Total area: approx. 112.2 sq. metres (1208.2 sq. feet)

For illustrative purposes only. Not to scale. All sizes are approximate.

Plan produced using PlanUp.

# First Floor

Approx. 44.7 sq. metres (481.6 sq. feet)

**Bedroom 3**  
3.54m x 2.61m  
(11'7" x 8'7")

**Bathroom**  
2.46m (8'1") max  
x 2.34m (7'8")

**Store**

**Landing**

**Bedroom 2**  
2.68m x 3.03m  
(8'10" x 9'11")

**Bedroom 1**  
2.68m (8'10")  
x 3.95m (13') max

