

# Ground Floor

Approx. 35.5 sq. metres (381.8 sq. feet)

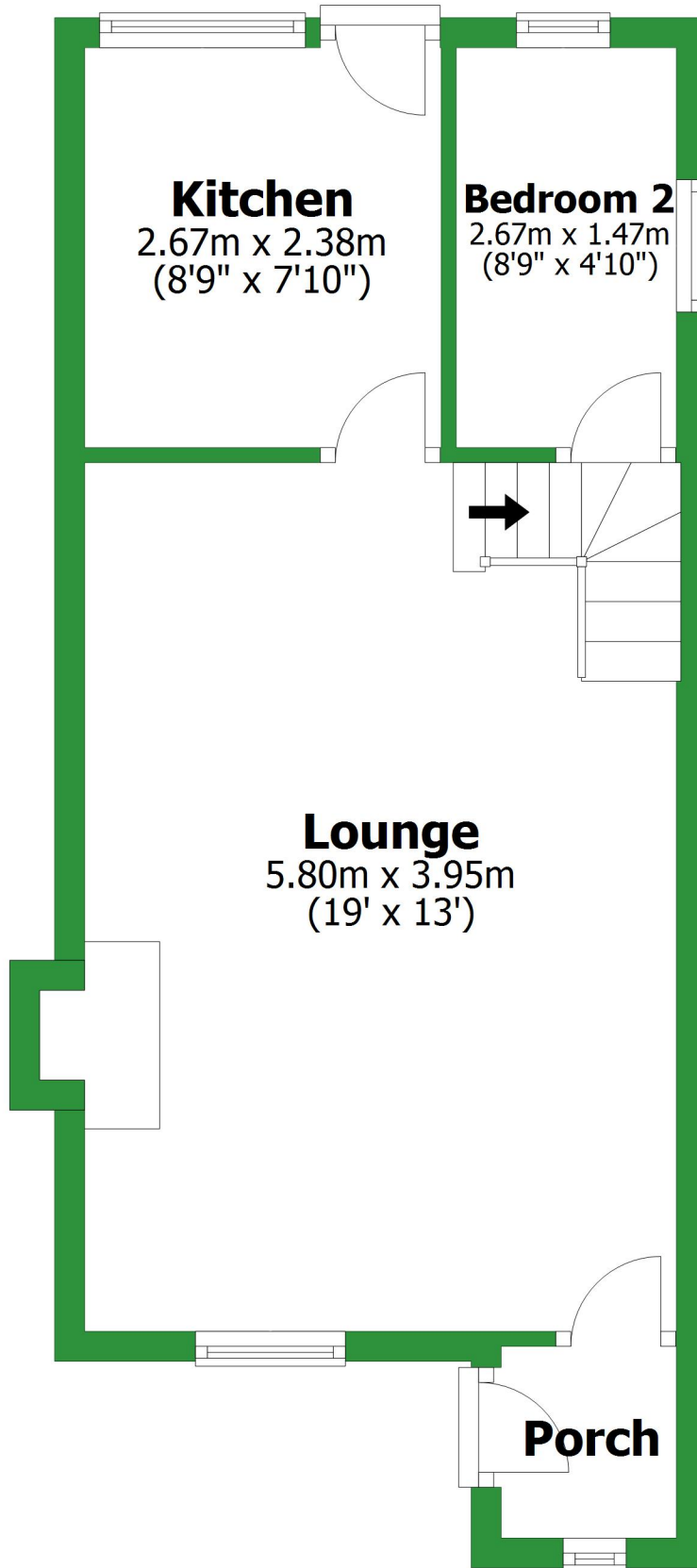

Total area: approx. 58.4 sq. metres (628.4 sq. feet)

For illustrative purposes only. Not to scale. All sizes are approximate.  
Plan produced using PlanUp.

# First Floor

Approx. 22.9 sq. metres (246.6 sq. feet)

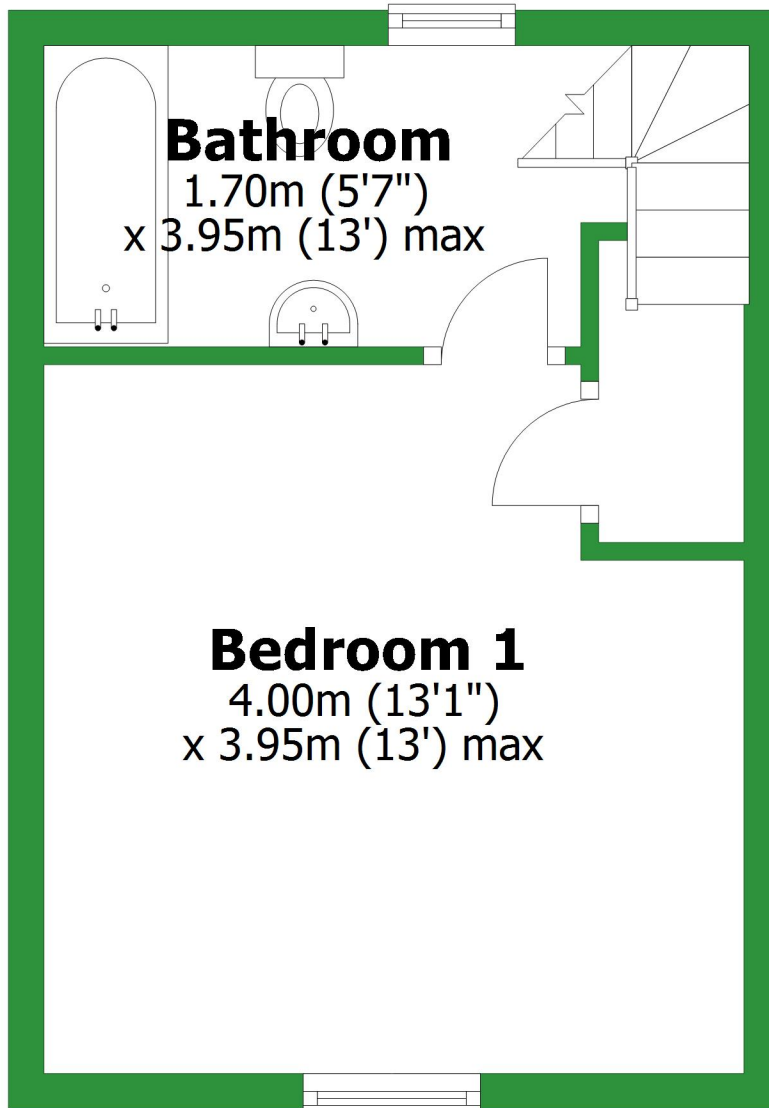

# Ground Floor

Approx. 35.5 sq. metres (381.8 sq. feet)

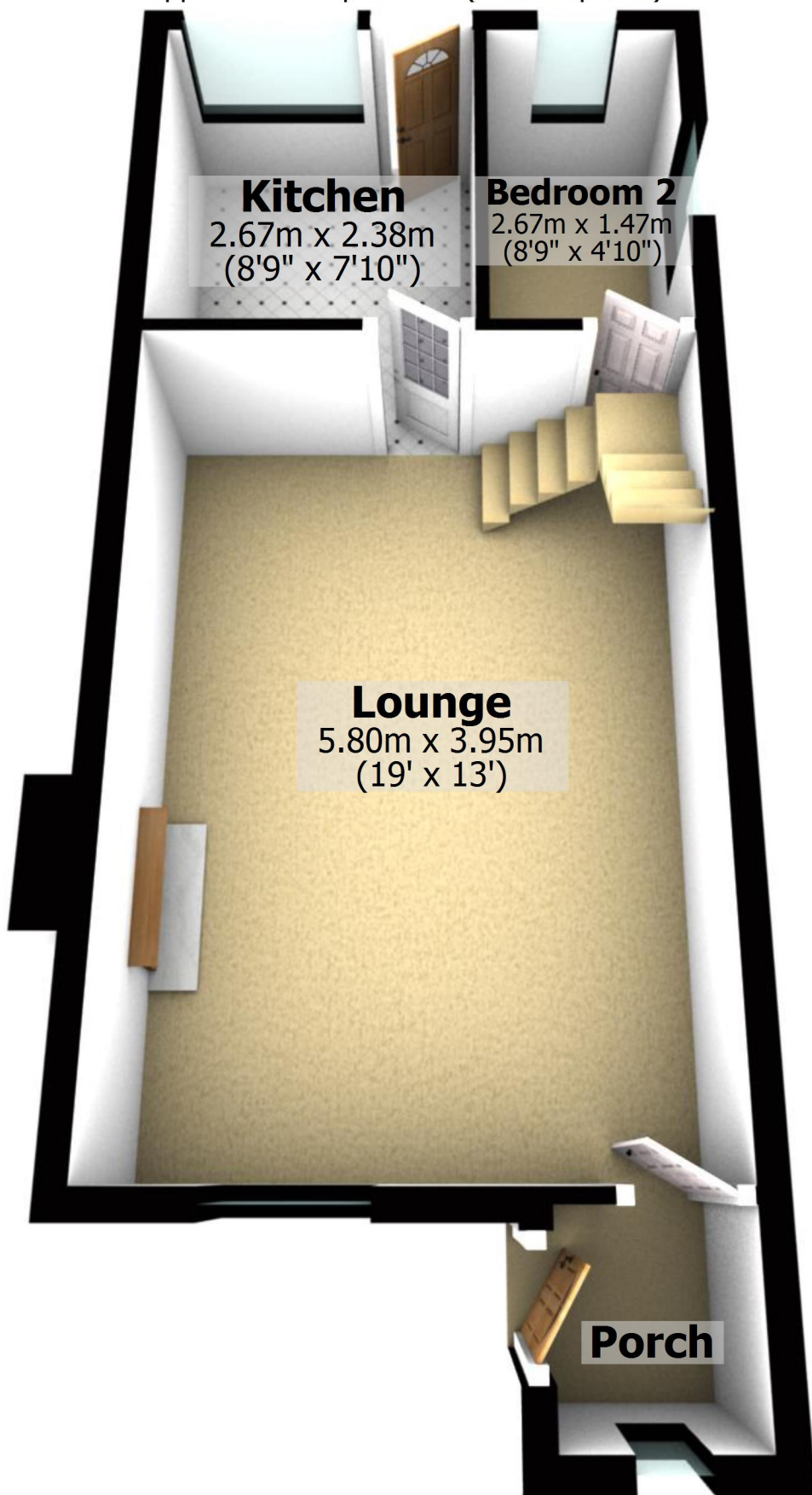

Total area: approx. 58.4 sq. metres (628.4 sq. feet)

For illustrative purposes only. Not to scale. All sizes are approximate.

Plan produced using PlanUp.

# First Floor

Approx. 22.9 sq. metres (246.6 sq. feet)

## Bathroom

1.70m (5'7")  
x 3.95m (13') max

## Bedroom 1

4.00m (13'1")  
x 3.95m (13') max

