

Ground Floor

Approx. 50.7 sq. metres (545.8 sq. feet)

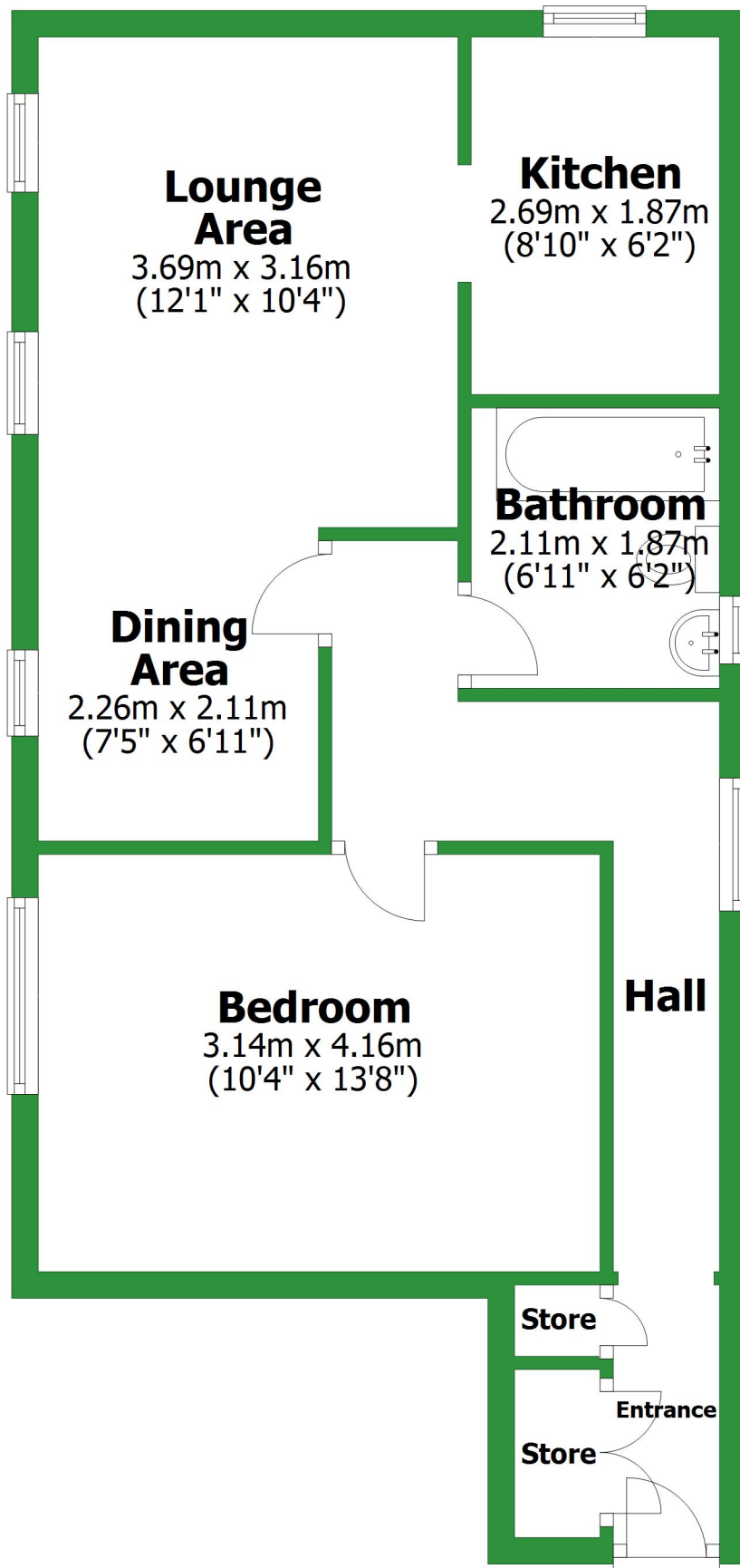

Total area: approx. 50.7 sq. metres (545.8 sq. feet)

For illustrative purposes only. Not to scale. All sizes are approximate.
Plan produced using PlanUp.

Ground Floor

Approx. 50.7 sq. metres (545.8 sq. feet)

Lounge Area

3.69m x 3.16m
(12'1" x 10'4")

Kitchen

2.69m x 1.87m
(8'10" x 6'2")

Bathroom

2.11m x 1.87m
(6'11" x 6'2")

Dining Area

2.26m x 2.11m
(7'5" x 6'11")

Bedroom

3.14m x 4.16m
(10'4" x 13'8")

Hall

Store

Entrance

Store

Total area: approx. 50.7 sq. metres (545.8 sq. feet)

For illustrative purposes only. Not to scale. All sizes are approximate.

Plan produced using PlanUp.