

# Ground Floor

Approx. 35.1 sq. metres (377.6 sq. feet)

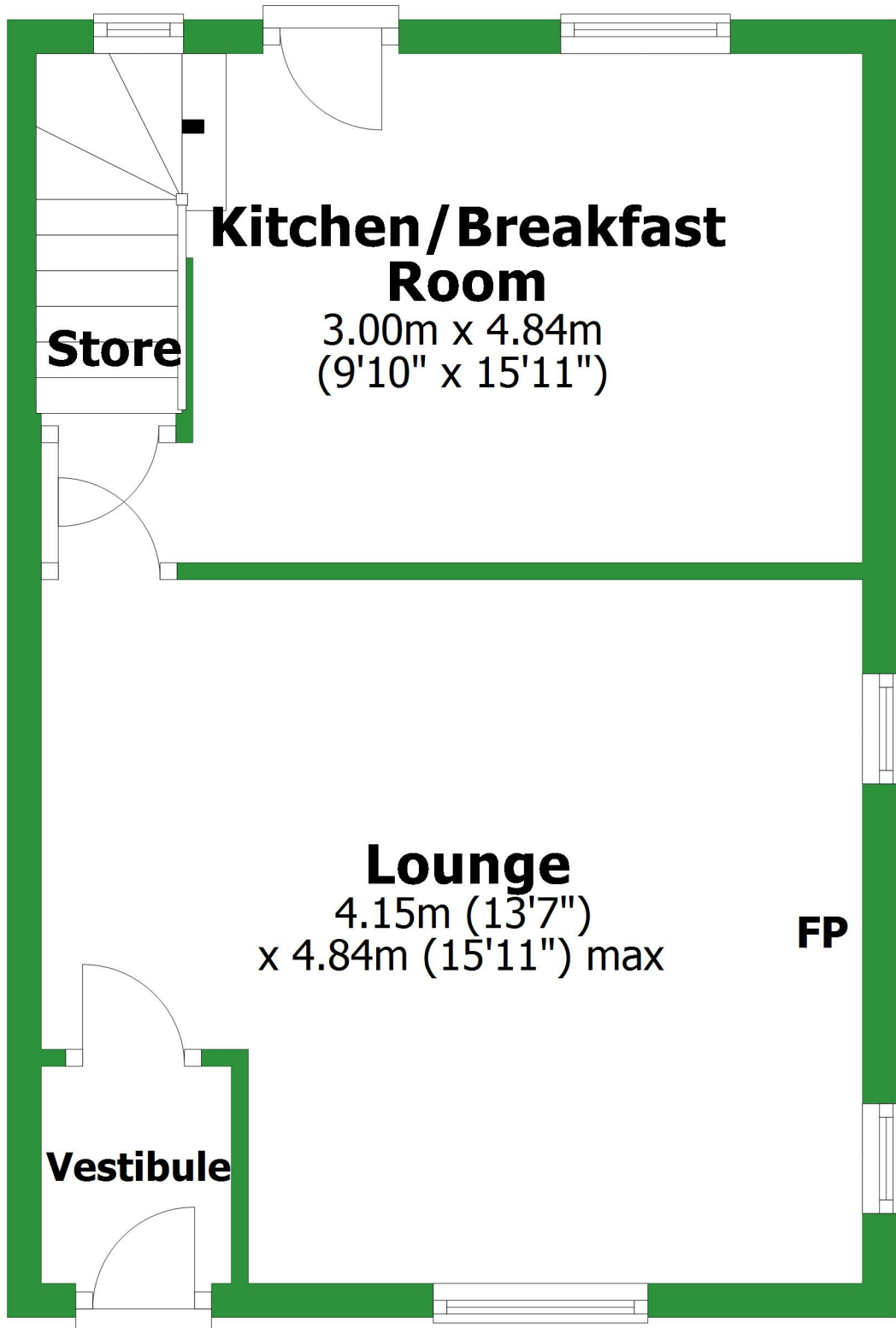

Total area: approx. 70.2 sq. metres (755.2 sq. feet)

For illustrative purposes only. Not to scale. All sizes are approximate.

Plan produced using PlanUp.

# First Floor

Approx. 35.1 sq. metres (377.6 sq. feet)

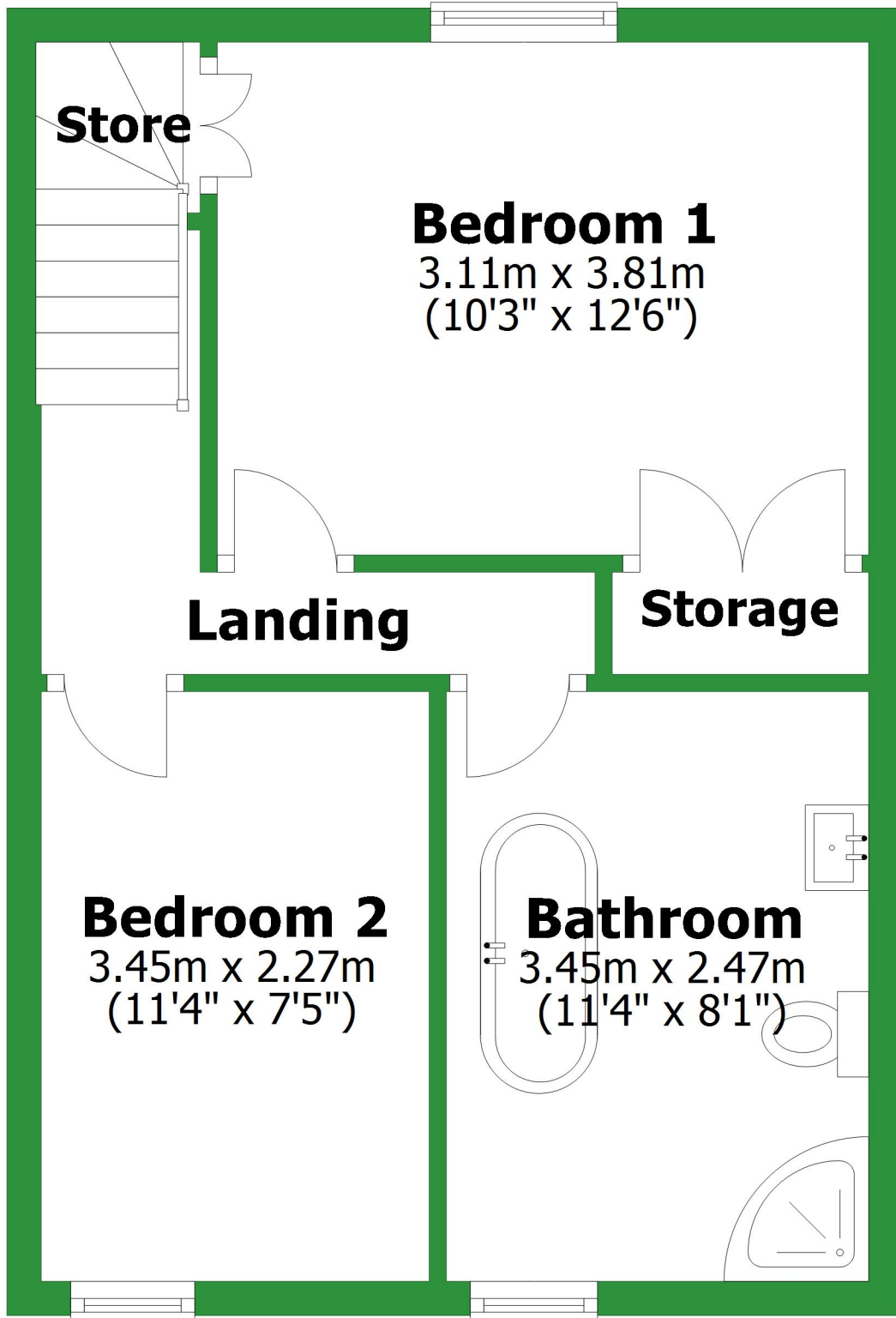

# Ground Floor

Approx. 35.1 sq. metres (377.6 sq. feet)

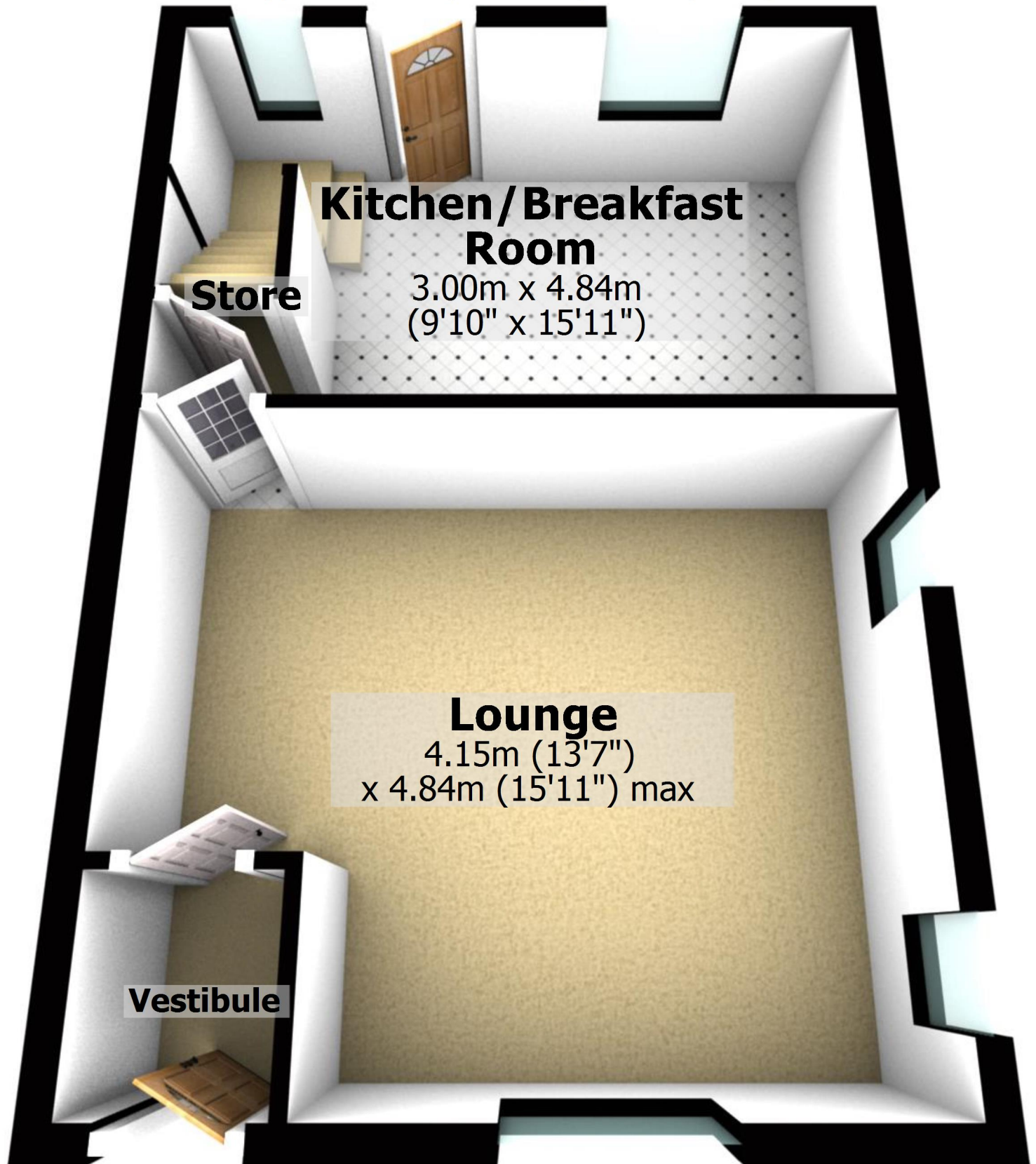

## Kitchen / Breakfast Room

3.00m x 4.84m  
(9'10" x 15'11")

Store

## Lounge

4.15m (13'7")  
x 4.84m (15'11") max

Vestibule

Total area: approx. 70.2 sq. metres (755.2 sq. feet)

For illustrative purposes only. Not to scale. All sizes are approximate.

Plan produced using PlanUp.

# First Floor

Approx. 35.1 sq. metres (377.6 sq. feet)

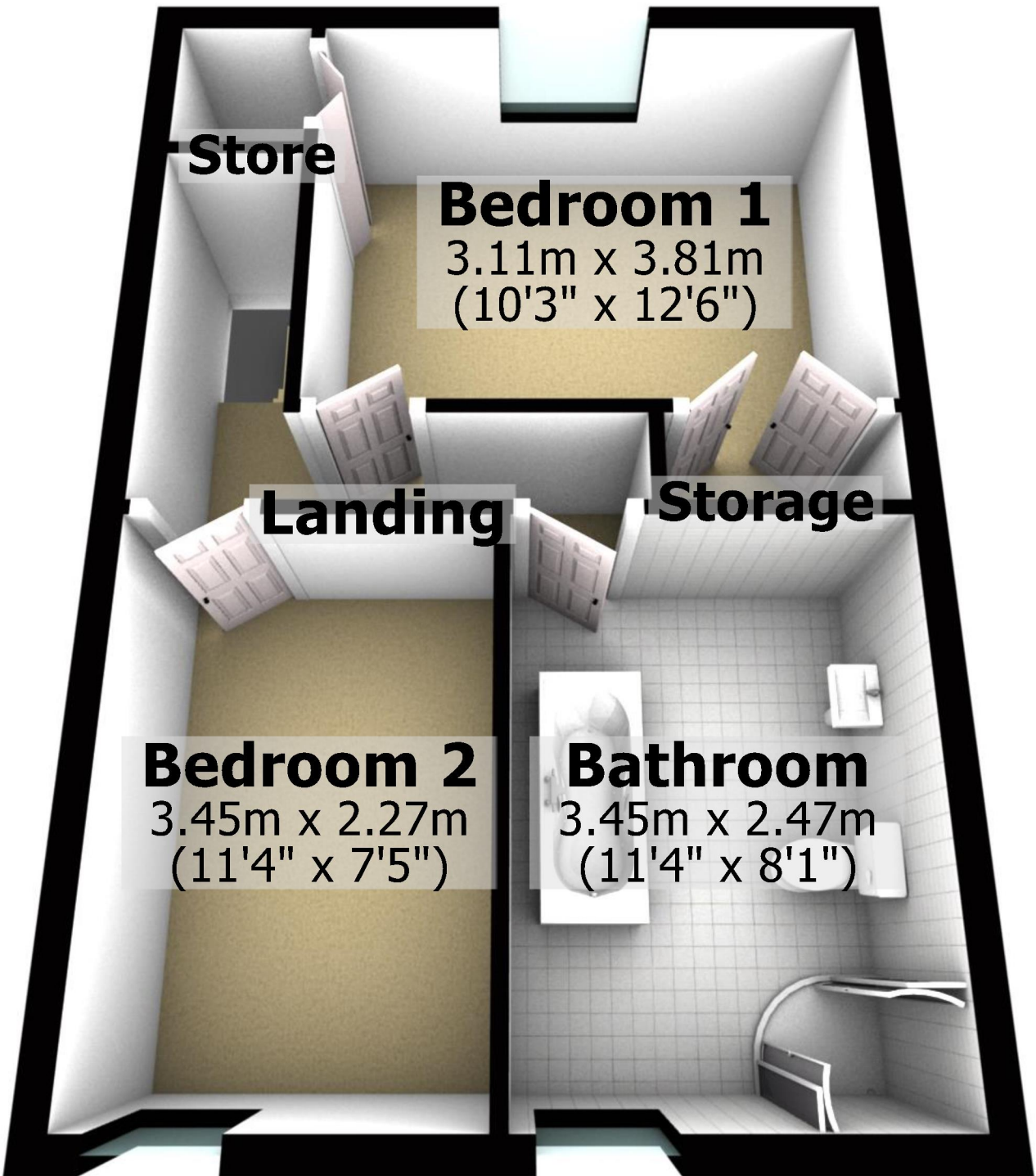

**Store**

**Bedroom 1**  
3.11m x 3.81m  
(10'3" x 12'6")

**Landing**

**Storage**

**Bedroom 2**  
3.45m x 2.27m  
(11'4" x 7'5")

**Bathroom**  
3.45m x 2.47m  
(11'4" x 8'1")