

Basement

Approx. 23.6 sq. metres (254.2 sq. feet)

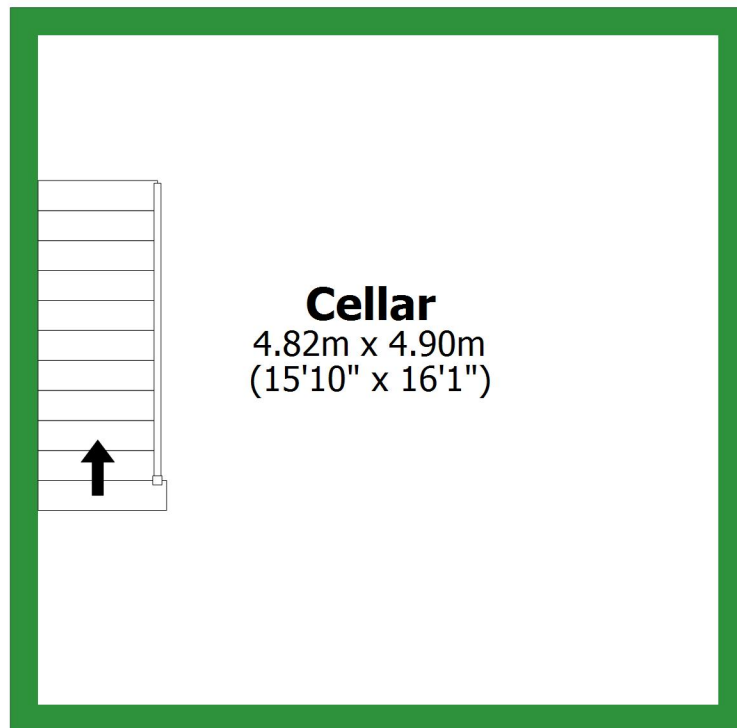

Total area: approx. 128.6 sq. metres (1384.4 sq. feet)

For illustrative purposes only. Not to scale. All sizes are approximate.
Plan produced using PlanUp.

Ground Floor

Approx. 54.8 sq. metres (589.6 sq. feet)

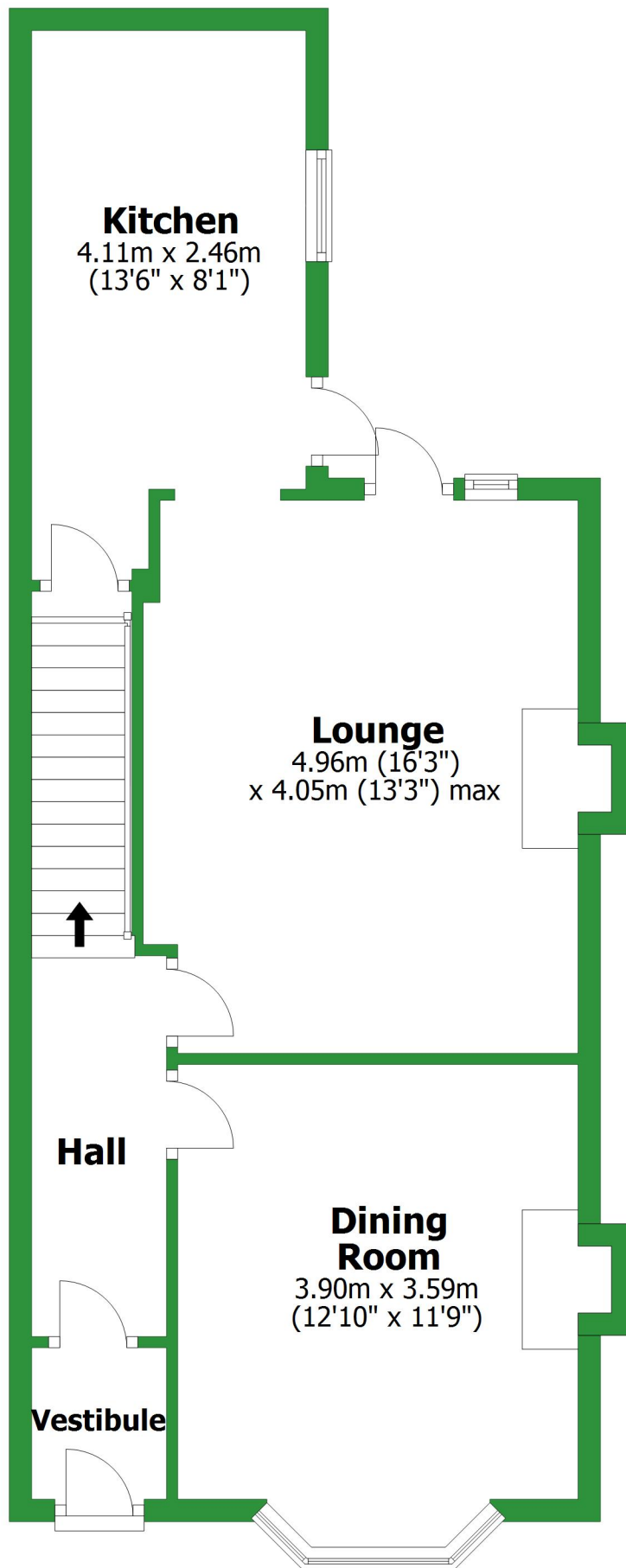

First Floor

Approx. 50.2 sq. metres (540.5 sq. feet)

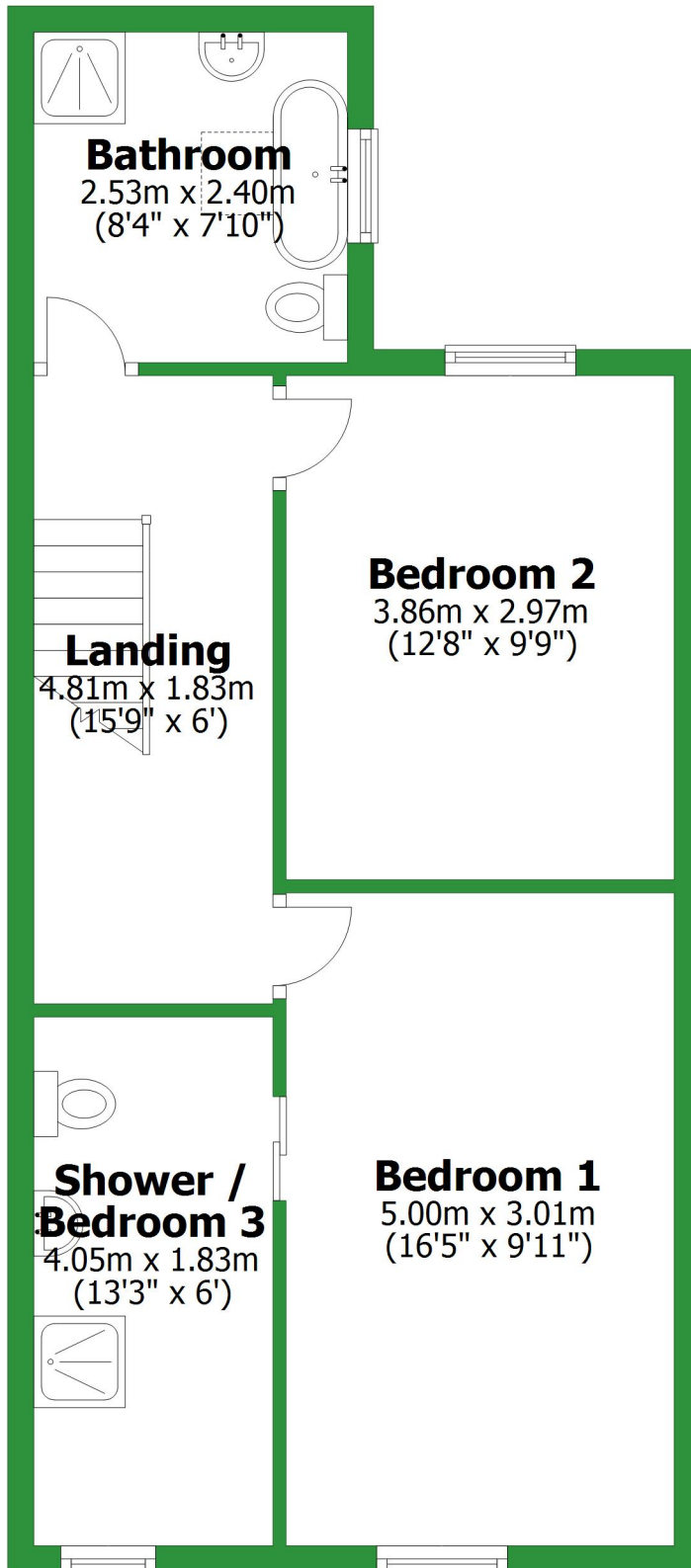

Basement

Approx. 23.6 sq. metres (254.2 sq. feet)



A 3D perspective rendering of a basement interior. On the left side, there is a staircase with approximately 10 steps, colored in a light yellow or gold hue. The walls and ceiling are covered in a white grid pattern with small black dots at the intersections. The floor is also covered in a similar grid pattern. The entire scene is framed by a thick black border.

Cellar

4.82m x 4.90m
(15'10" x 16'1")

Total area: approx. 128.6 sq. metres (1384.4 sq. feet)

For illustrative purposes only. Not to scale. All sizes are approximate.

Plan produced using PlanUp.

Ground Floor

Approx. 54.8 sq. metres (589.6 sq. feet)

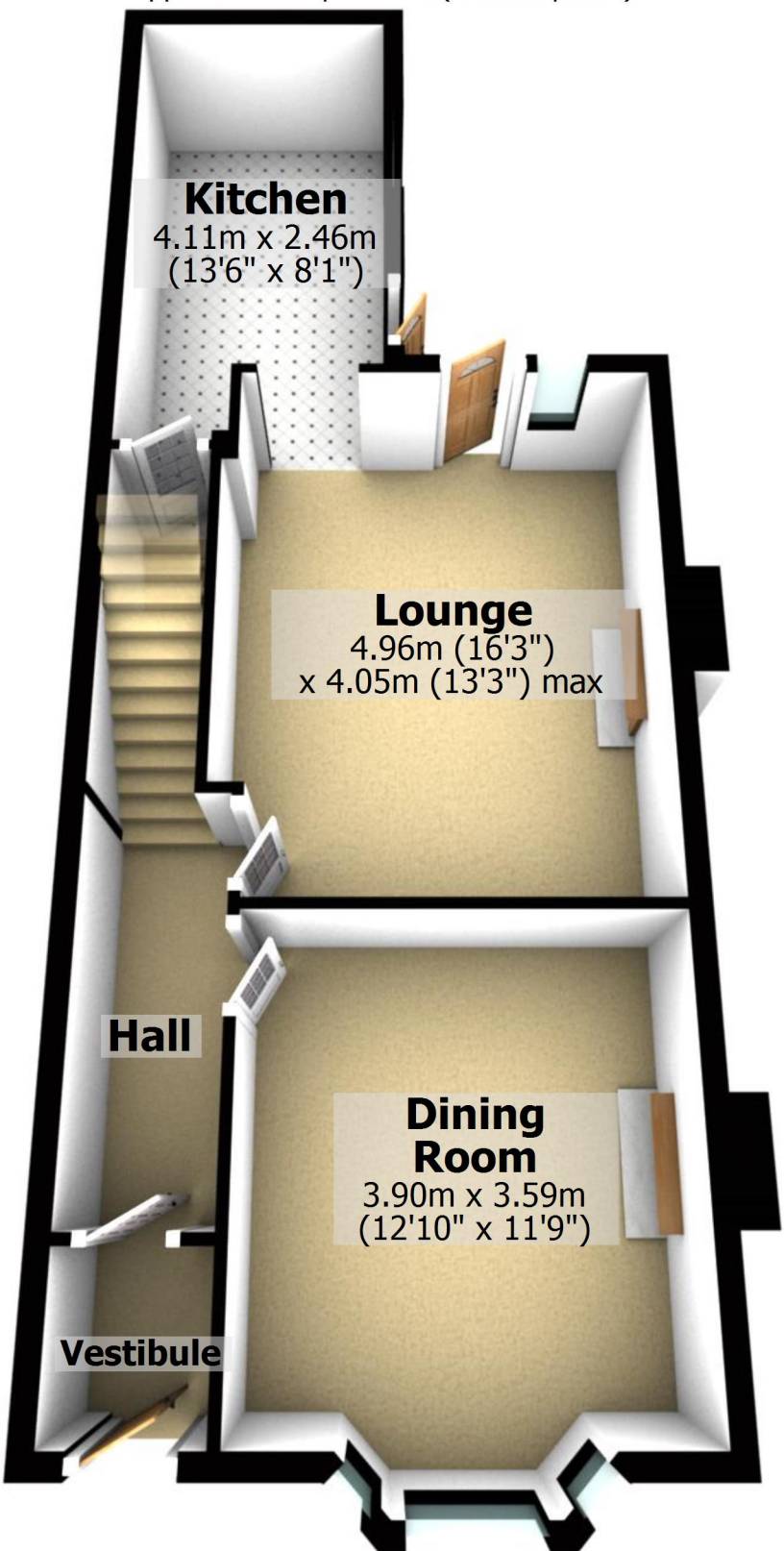

Kitchen

4.11m x 2.46m
(13'6" x 8'1")

Lounge

4.96m (16'3")
x 4.05m (13'3") max

Hall

Dining Room

3.90m x 3.59m
(12'10" x 11'9")

Vestibule

First Floor

Approx. 50.2 sq. metres (540.5 sq. feet)

Bathroom

2.53m x 2.40m
(8'4" x 7'10")

Landing

4.81m x 1.83m
(15'9" x 6')

Bedroom 2

3.86m x 2.97m
(12'8" x 9'9")

Shower / Bedroom 3

4.05m x 1.83m
(13'3" x 6')

Bedroom 1

5.00m x 3.01m
(16'5" x 9'11")

