

# Ground Floor

Approx. 44.2 sq. metres (475.8 sq. feet)

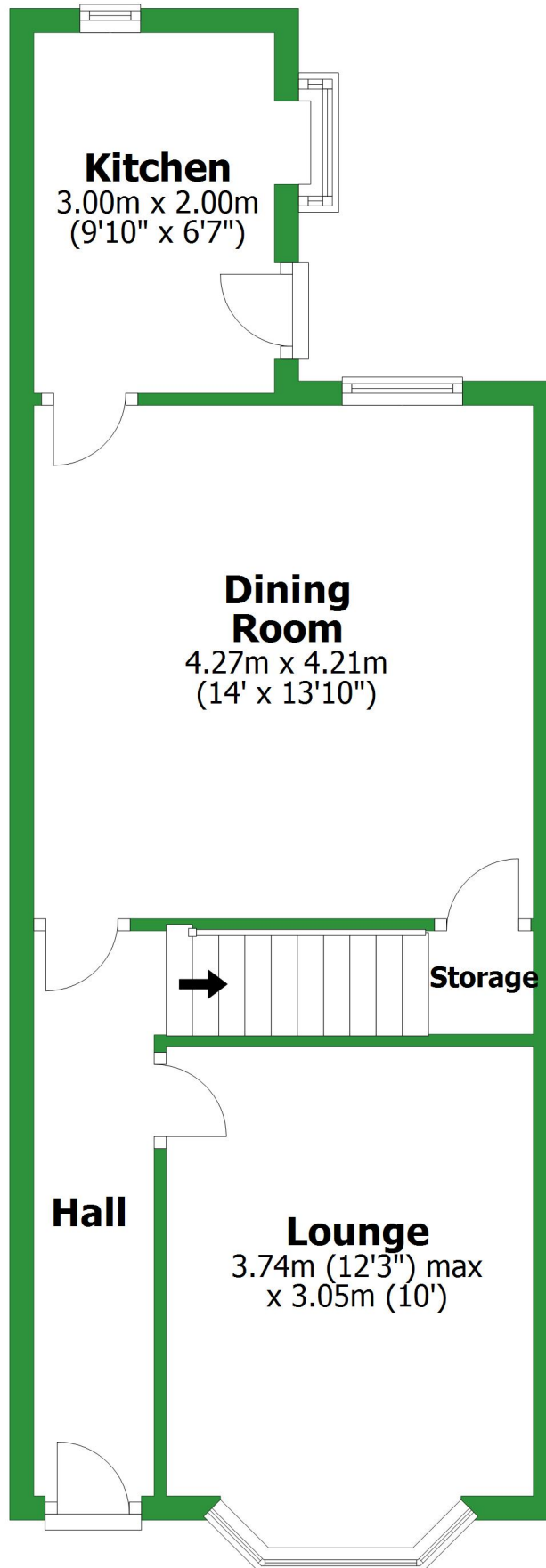

Total area: approx. 81.8 sq. metres (880.9 sq. feet)

For illustrative purposes only. Not to scale. All sizes are approximate.  
Plan produced using PlanUp.

## First Floor

Approx. 37.6 sq. metres (405.2 sq. feet)

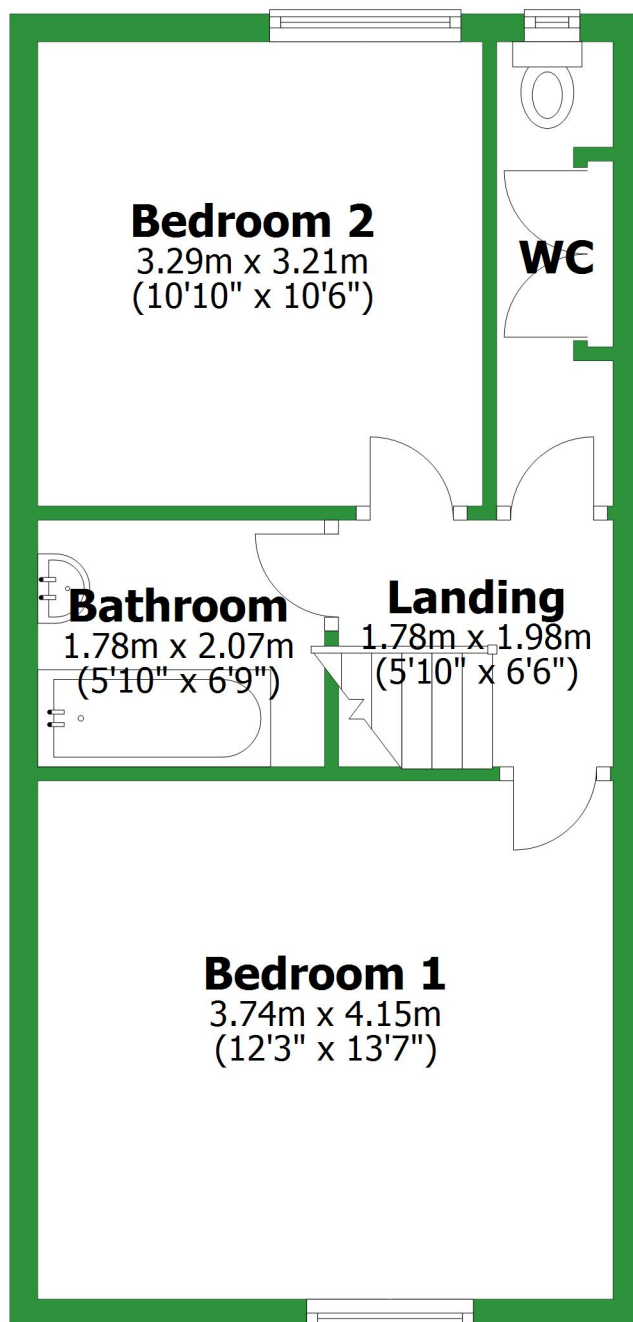

# Ground Floor

Approx. 44.2 sq. metres (475.8 sq. feet)

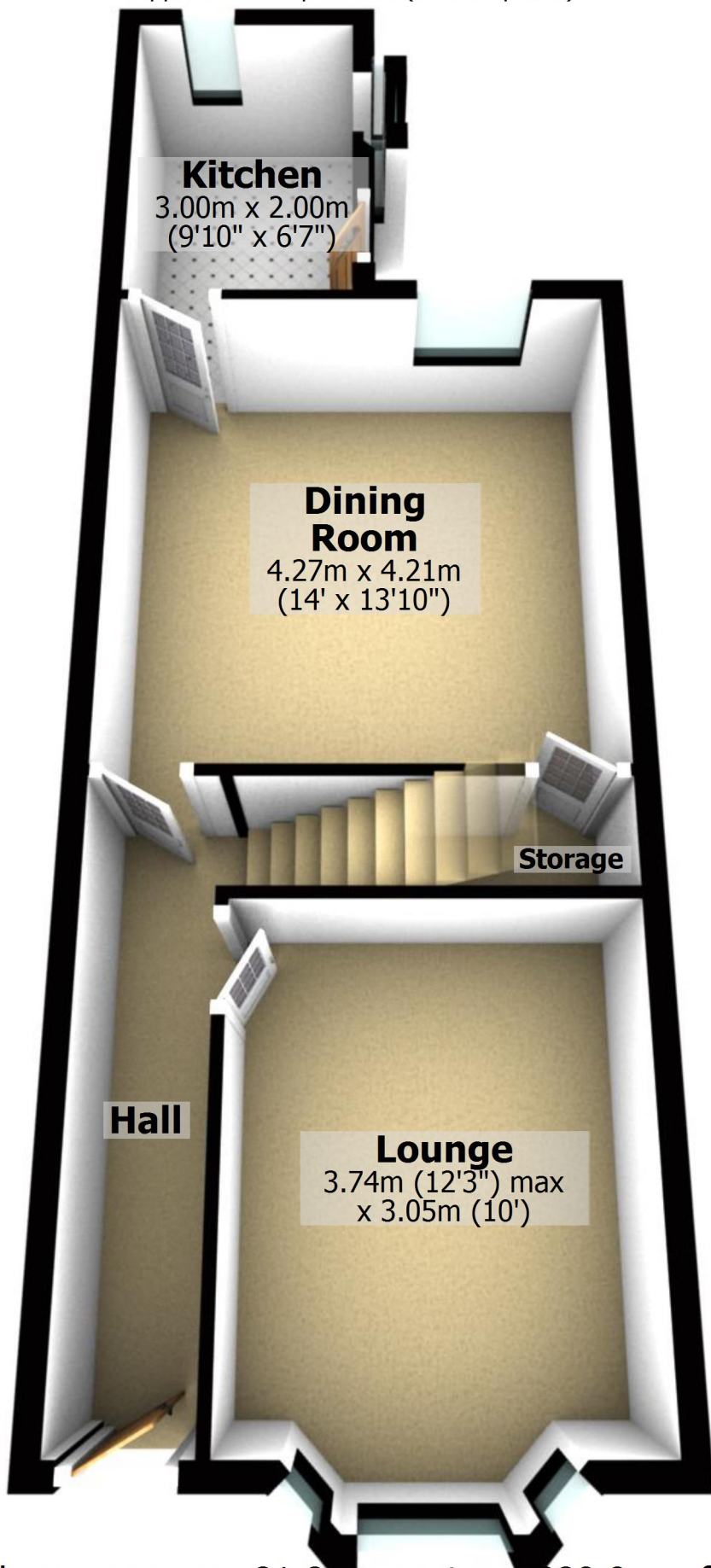

Total area: approx. 81.8 sq. metres (880.9 sq. feet)

For illustrative purposes only. Not to scale. All sizes are approximate.

Plan produced using PlanUp.

# First Floor

Approx. 37.6 sq. metres (405.2 sq. feet)

