

# Ground Floor

Approx. 39.9 sq. metres (429.4 sq. feet)

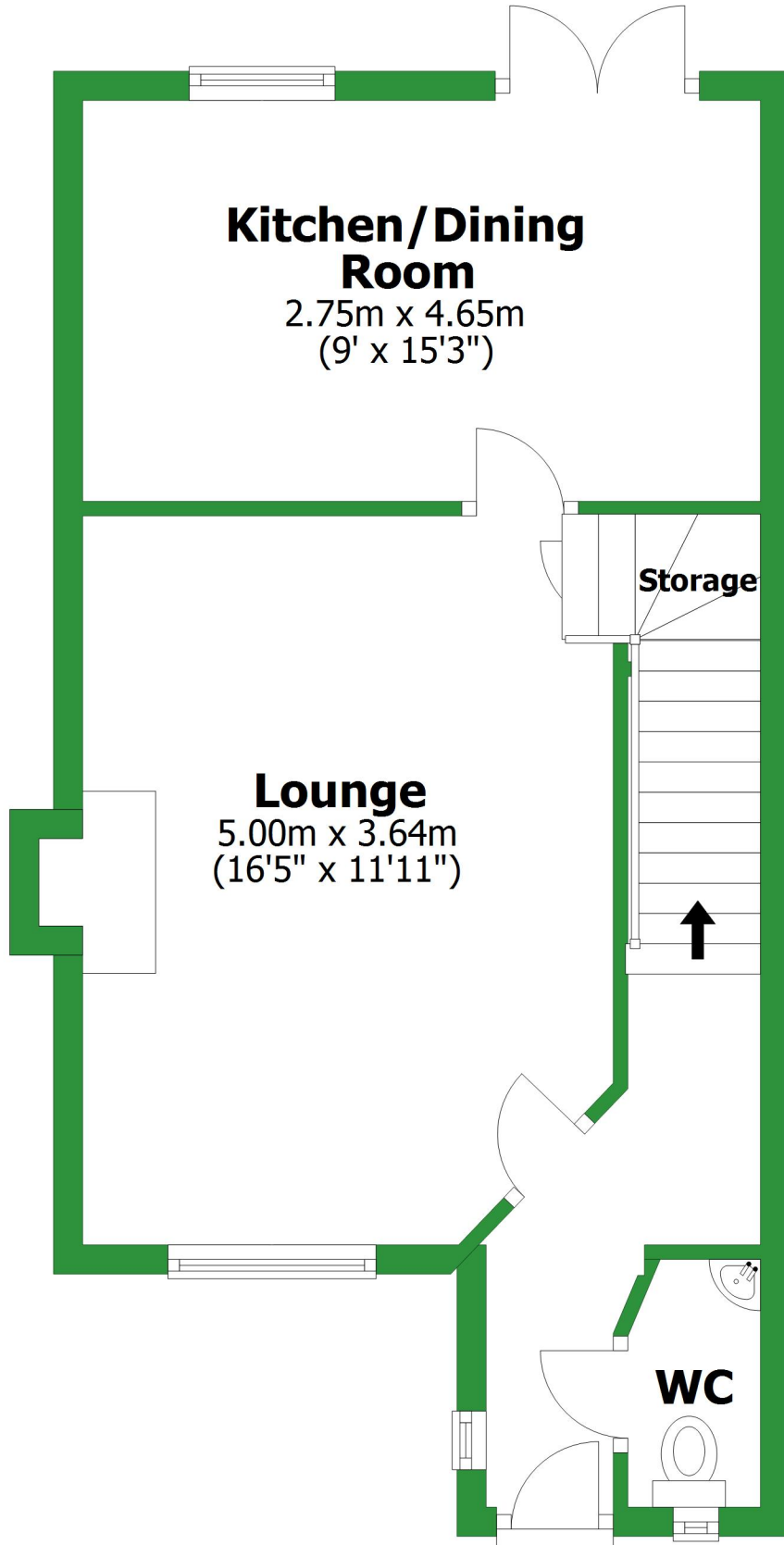

Total area: approx. 76.4 sq. metres (822.3 sq. feet)

For illustrative purposes only. Not to scale. All sizes are approximate.

Plan produced using PlanUp.

# First Floor

Approx. 36.5 sq. metres (392.9 sq. feet)

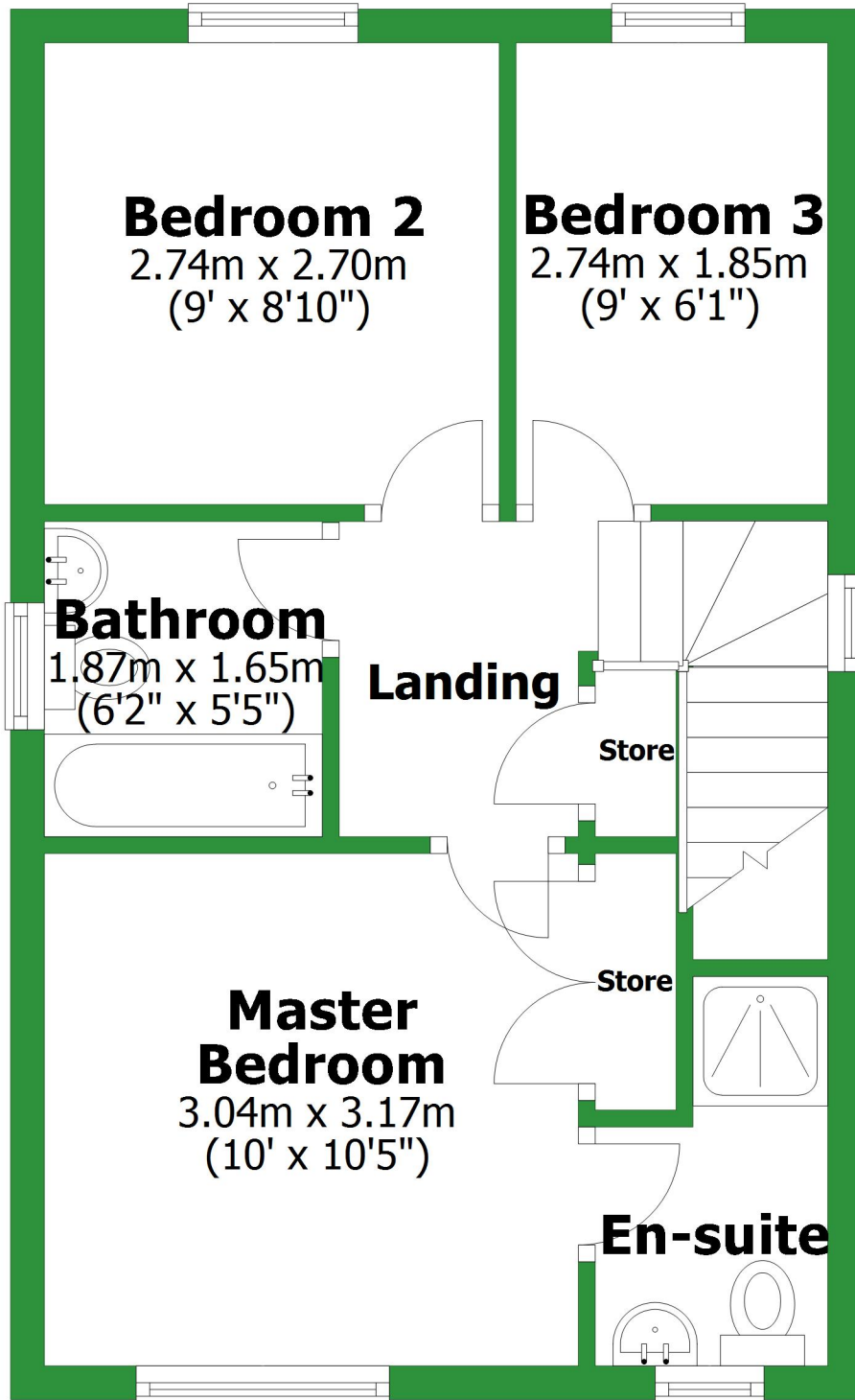

# Ground Floor

Approx. 39.9 sq. metres (429.4 sq. feet)

## Kitchen/Dining Room

2.75m x 4.65m  
(9' x 15'3")

Storage

## Lounge

5.00m x 3.64m  
(16'5" x 11'11")

WC

Total area: approx. 76.4 sq. metres (822.3 sq. feet)

For illustrative purposes only. Not to scale. All sizes are approximate.

Plan produced using PlanUp.

# First Floor

Approx. 36.5 sq. metres (392.9 sq. feet)

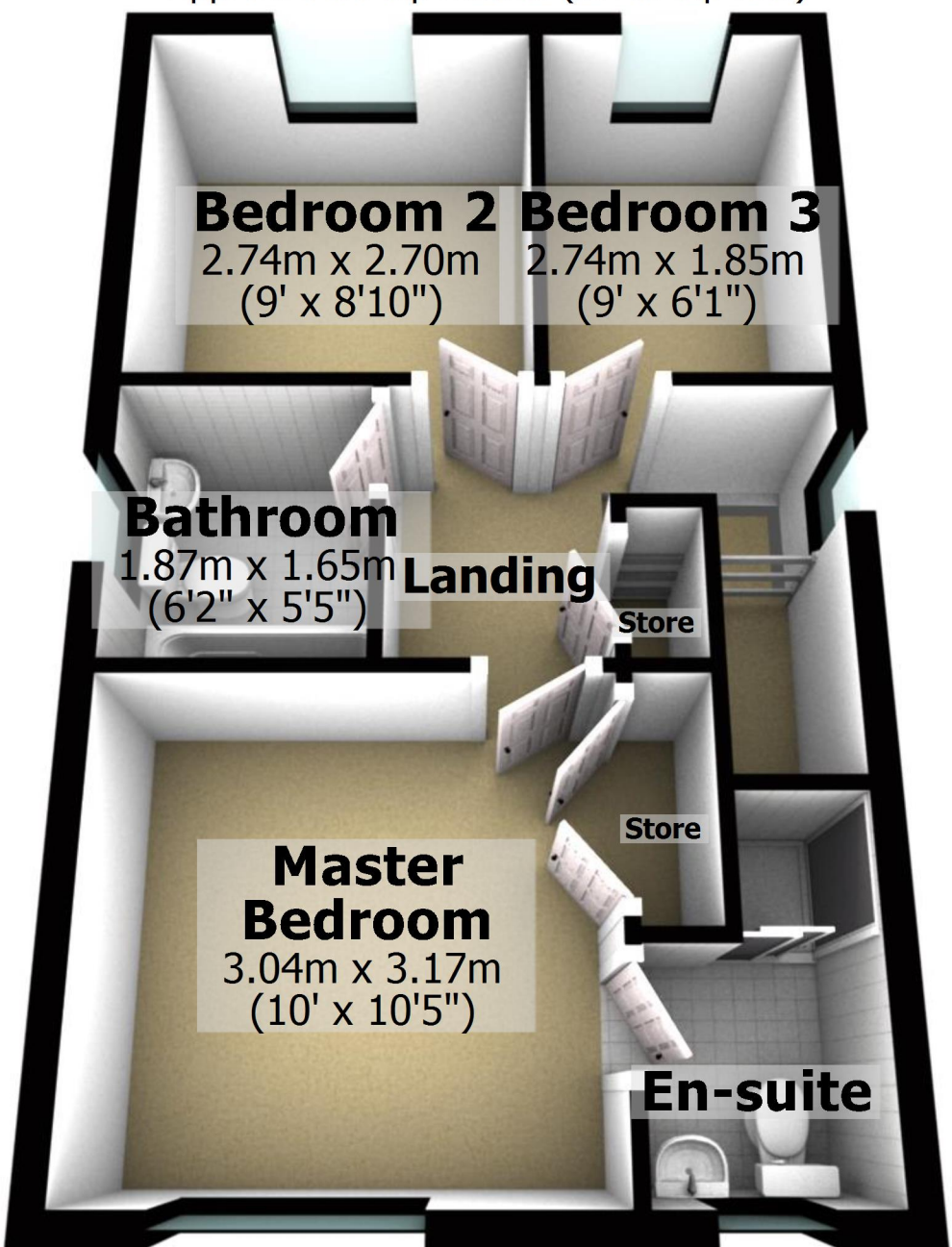

**Bedroom 2**  
2.74m x 2.70m  
(9' x 8'10")

**Bedroom 3**  
2.74m x 1.85m  
(9' x 6'1")

**Bathroom**  
1.87m x 1.65m  
(6'2" x 5'5")

**Landing**

Store

Store

**Master  
Bedroom**  
3.04m x 3.17m  
(10' x 10'5")

**En-suite**