

Ground Floor

Approx. 25.0 sq. metres (269.5 sq. feet)

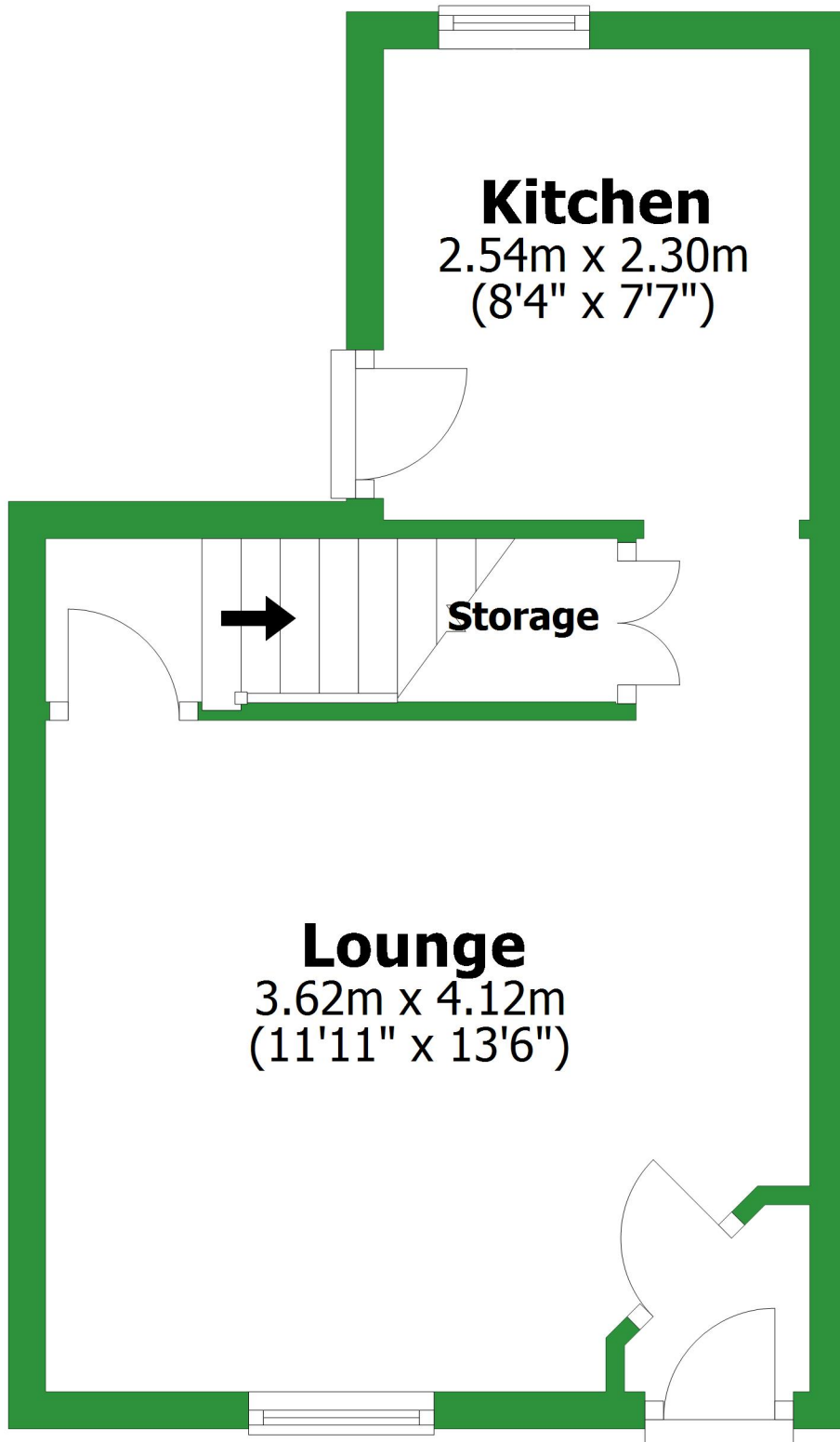

Total area: approx. 50.0 sq. metres (538.7 sq. feet)

For illustrative purposes only. Not to scale. All sizes are approximate.

Plan produced using PlanUp.

First Floor

Approx. 25.0 sq. metres (269.2 sq. feet)

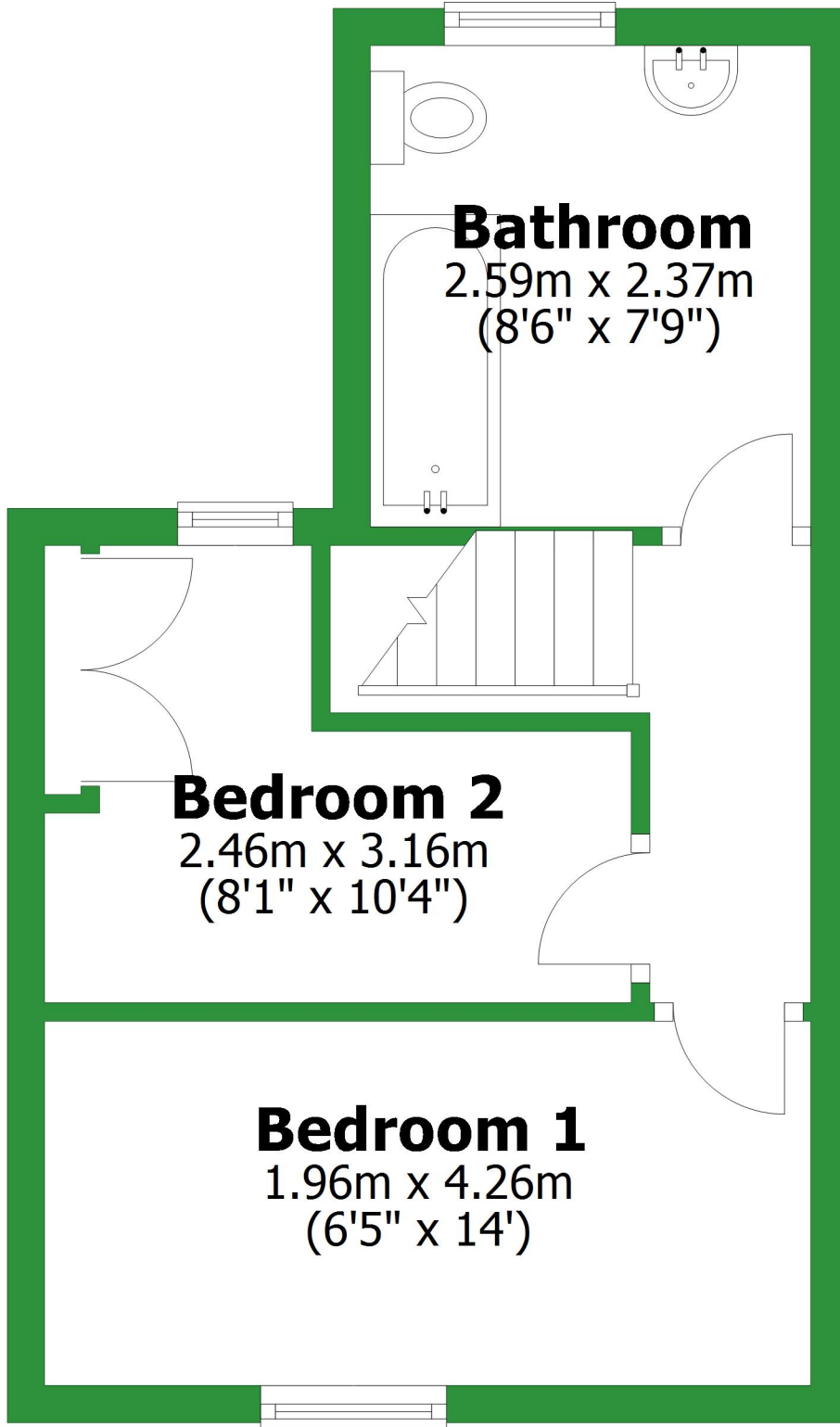

Ground Floor

Approx. 25.0 sq. metres (269.5 sq. feet)

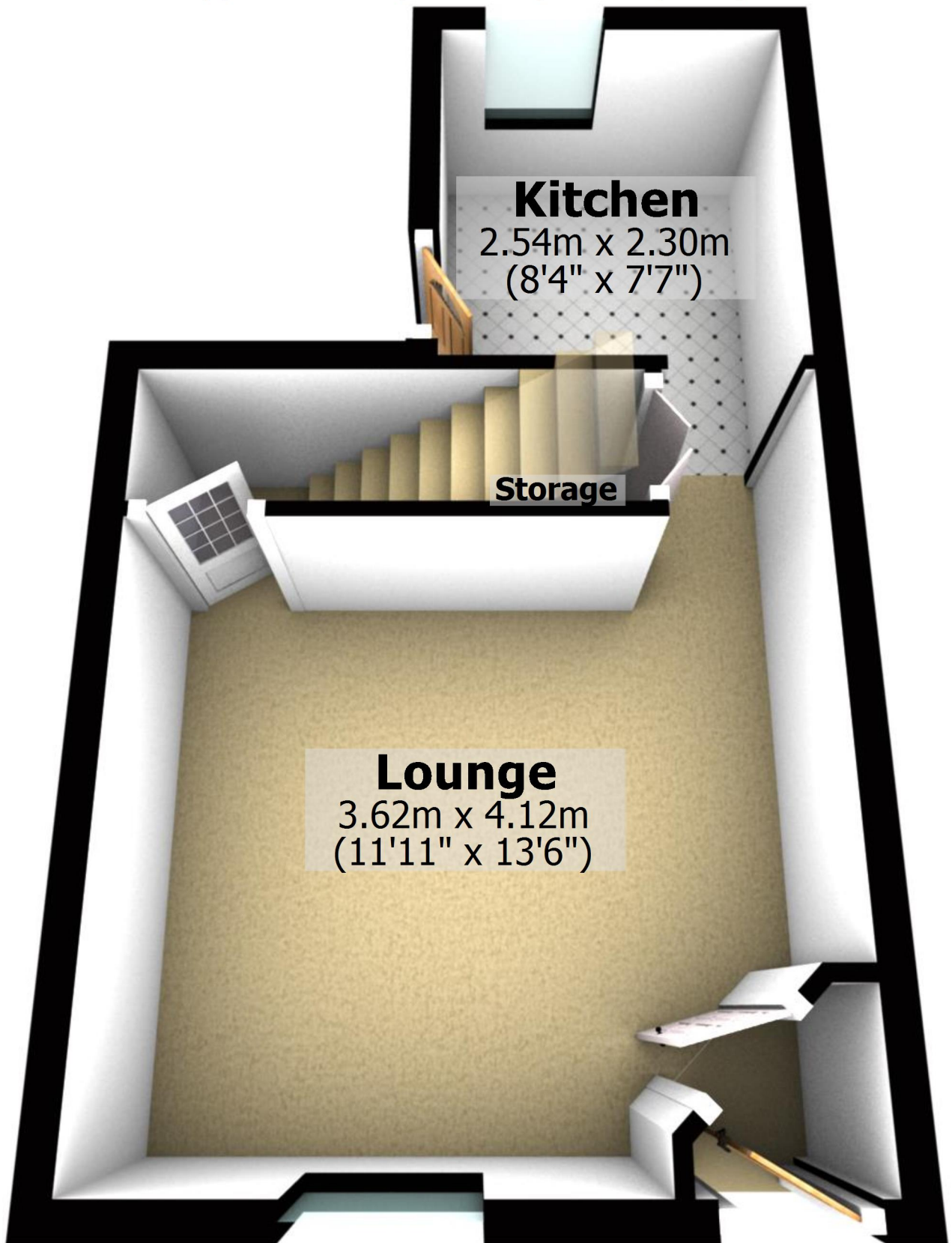

Kitchen

2.54m x 2.30m
(8'4" x 7'7")

Storage

Lounge

3.62m x 4.12m
(11'11" x 13'6")

Total area: approx. 50.0 sq. metres (538.7 sq. feet)

For illustrative purposes only. Not to scale. All sizes are approximate.

Plan produced using PlanUp.

First Floor

Approx. 25.0 sq. metres (269.2 sq. feet)



The image is a 3D architectural rendering of a first floor. It shows a central hallway with a door leading to a bathroom at the top. To the left of the hallway is a bedroom (Bedroom 2) with a bed and a desk. At the bottom is a larger bedroom (Bedroom 1). The walls are white, and the floor is a light brown color. The rendering is viewed from a high angle, looking down into the rooms.

Bathroom

2.59m x 2.37m
(8'6" x 7'9")

Bedroom 2

2.46m x 3.16m
(8'1" x 10'4")

Bedroom 1

1.96m x 4.26m
(6'5" x 14')