

# Ground Floor

Approx. 111.1 sq. metres (1196.1 sq. feet)

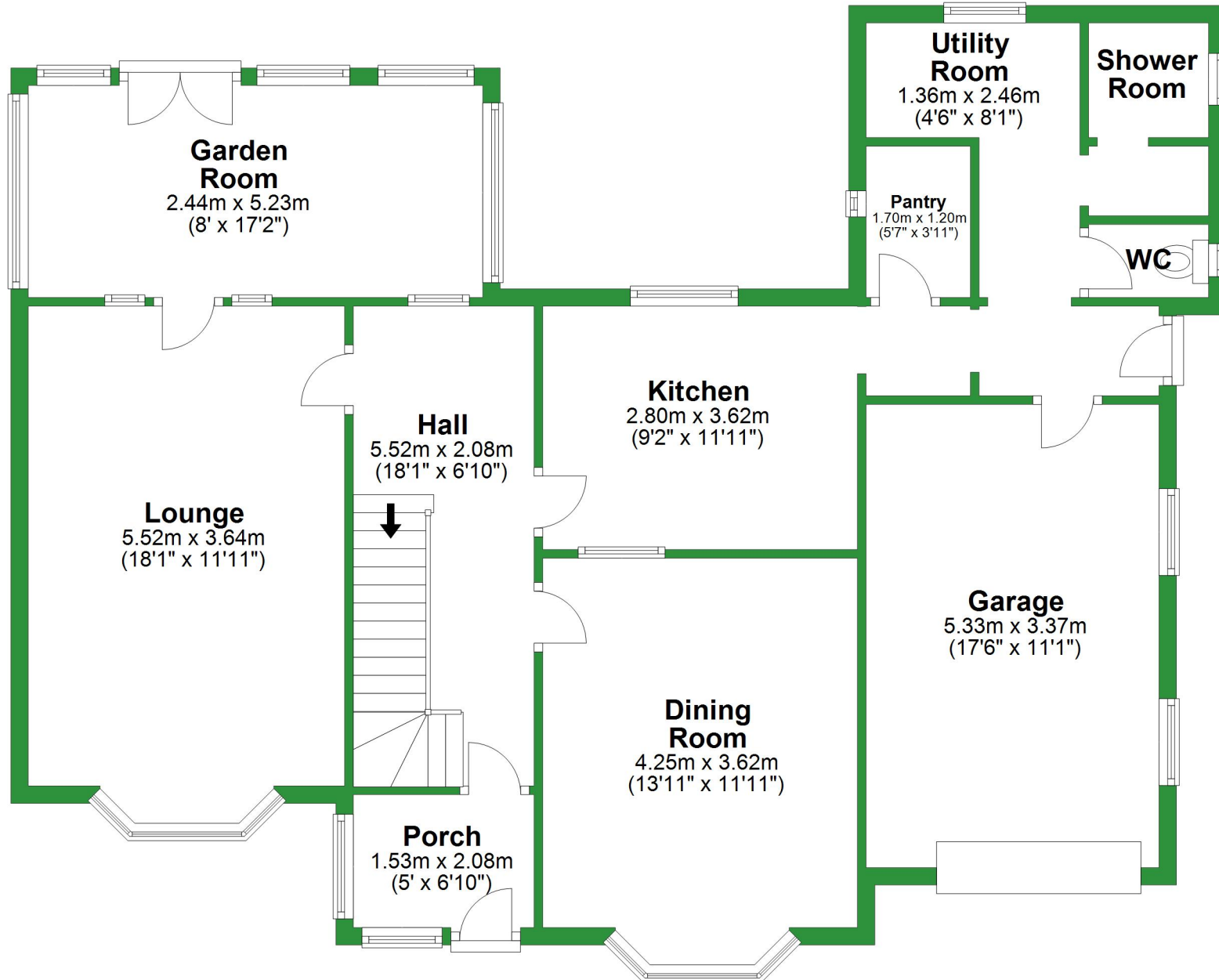

Total area: approx. 170.3 sq. metres (1832.6 sq. feet)

For illustrative purposes only. Not to scale. All sizes are approximate.

Plan produced using PlanUp.

## First Floor

Approx. 59.1 sq. metres (636.5 sq. feet)

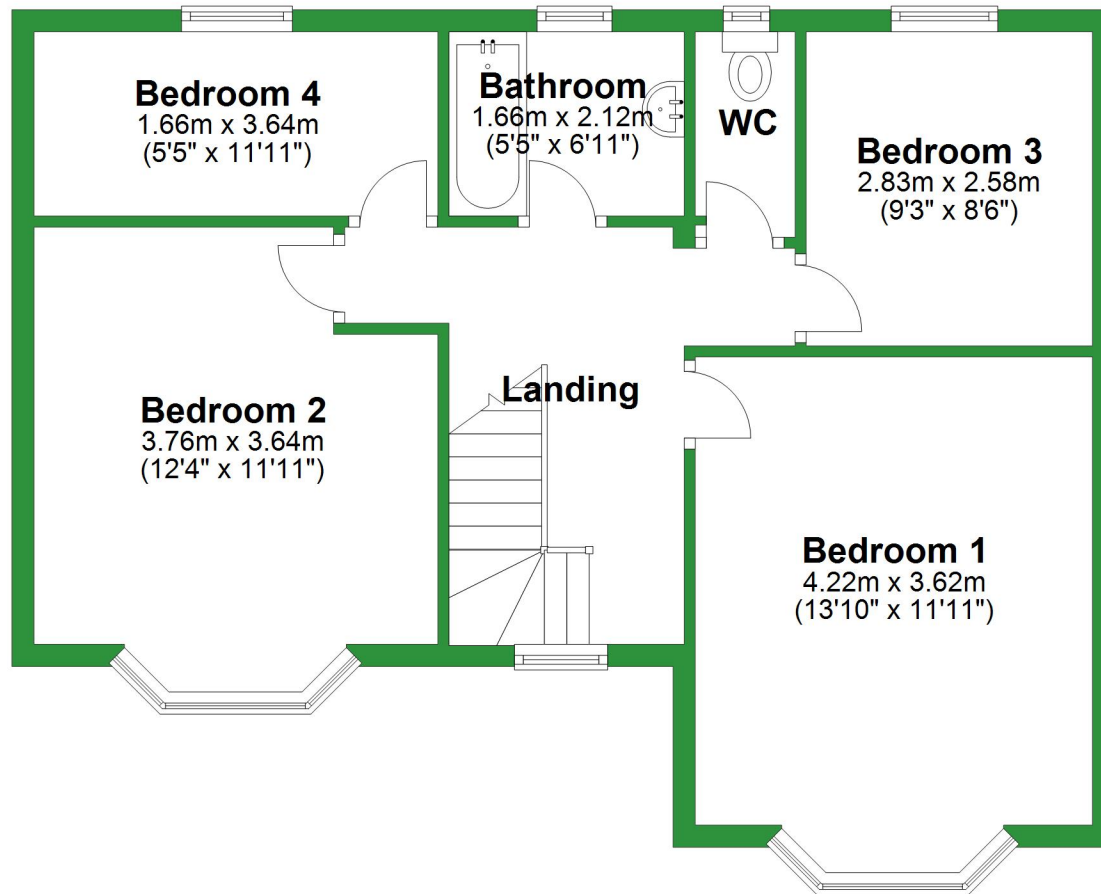

# Ground Floor

Approx. 111.1 sq. metres (1196.1 sq. feet)

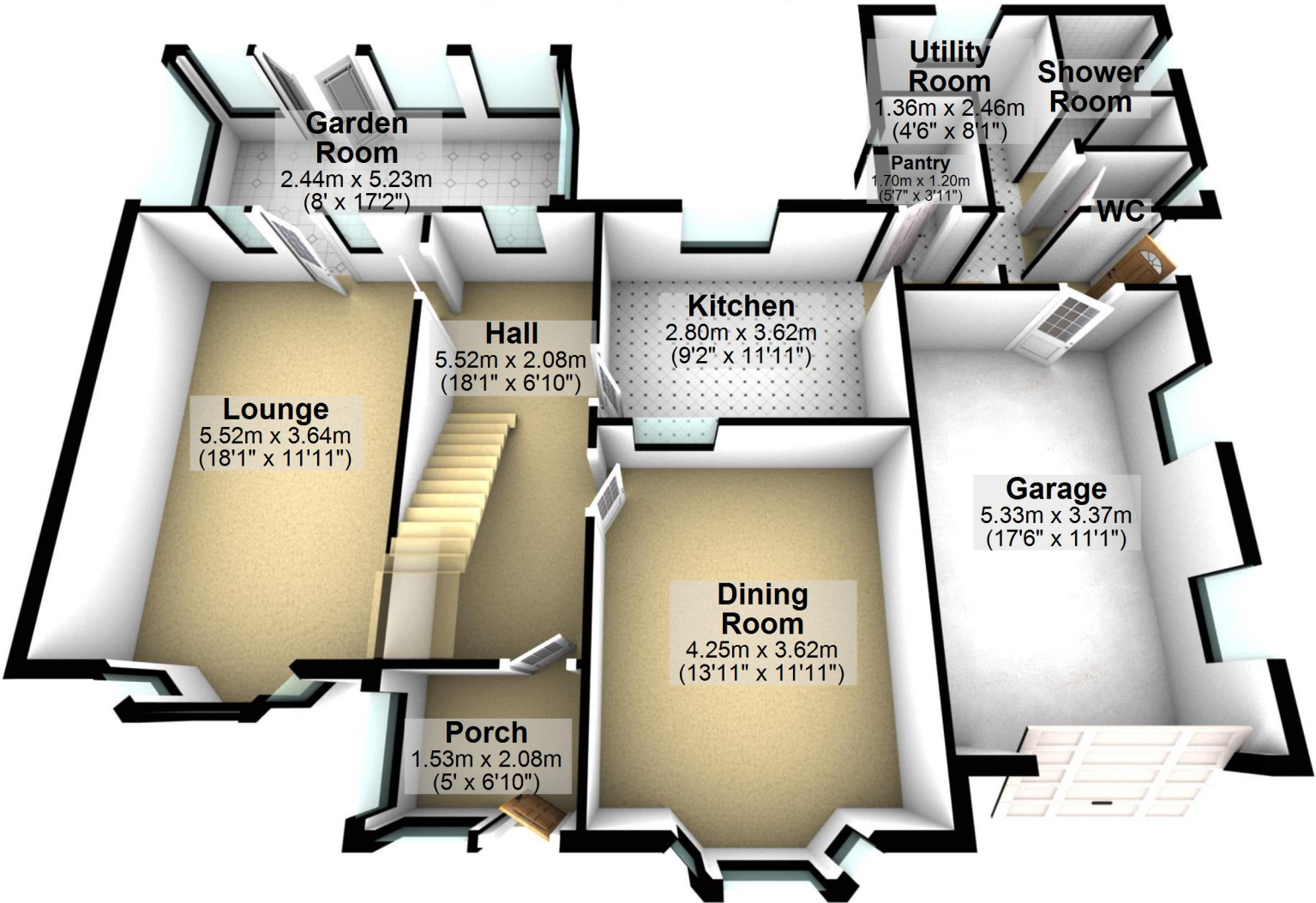

Total area: approx. 170.3 sq. metres (1832.6 sq. feet)

For illustrative purposes only. Not to scale. All sizes are approximate.  
Plan produced using PlanUp.

# First Floor

Approx. 59.1 sq. metres (636.5 sq. feet)

**Bedroom 4**  
1.66m x 3.64m  
(5'5" x 11'11")

**Bathroom**  
1.66m x 2.12m  
(5'5" x 6'11")

**WC**

**Bedroom 3**  
2.83m x 2.58m  
(9'3" x 8'6")

**Bedroom 2**  
3.76m x 3.64m  
(12'4" x 11'11")

**Landing**

**Bedroom 1**  
4.22m x 3.62m  
(13'10" x 11'11")

