

Ground Floor

Approx. 100.3 sq. metres (1079.6 sq. feet)

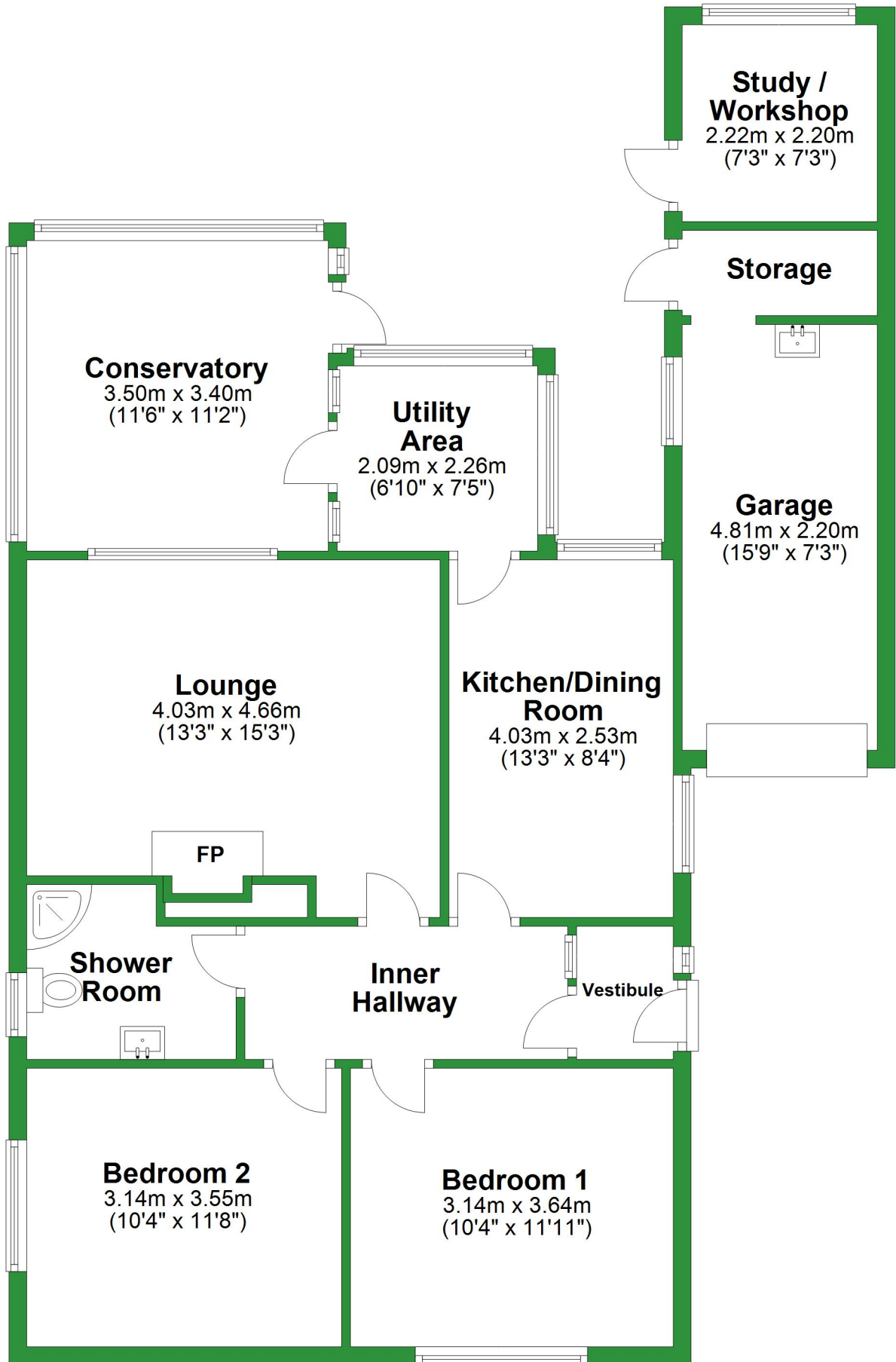

Total area: approx. 100.3 sq. metres (1079.6 sq. feet)

For illustrative purposes only. Not to scale. All sizes are approximate.
Plan produced using PlanUp.

Ground Floor

Approx. 100.3 sq. metres (1079.6 sq. feet)

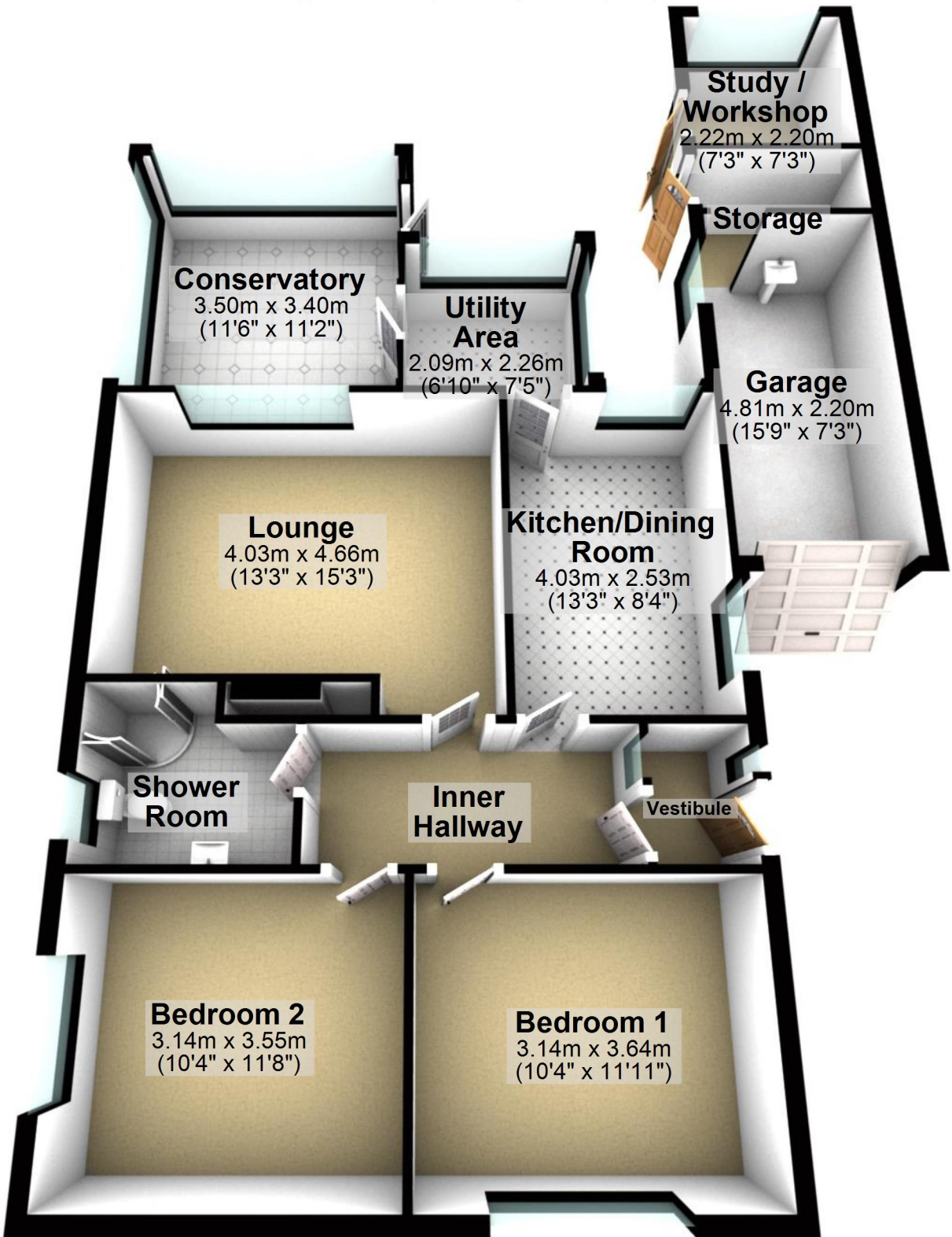

Total area: approx. 100.3 sq. metres (1079.6 sq. feet)

For illustrative purposes only. Not to scale. All sizes are approximate.
Plan produced using PlanUp.