

# Ground Floor

Approx. 29.7 sq. metres (319.7 sq. feet)

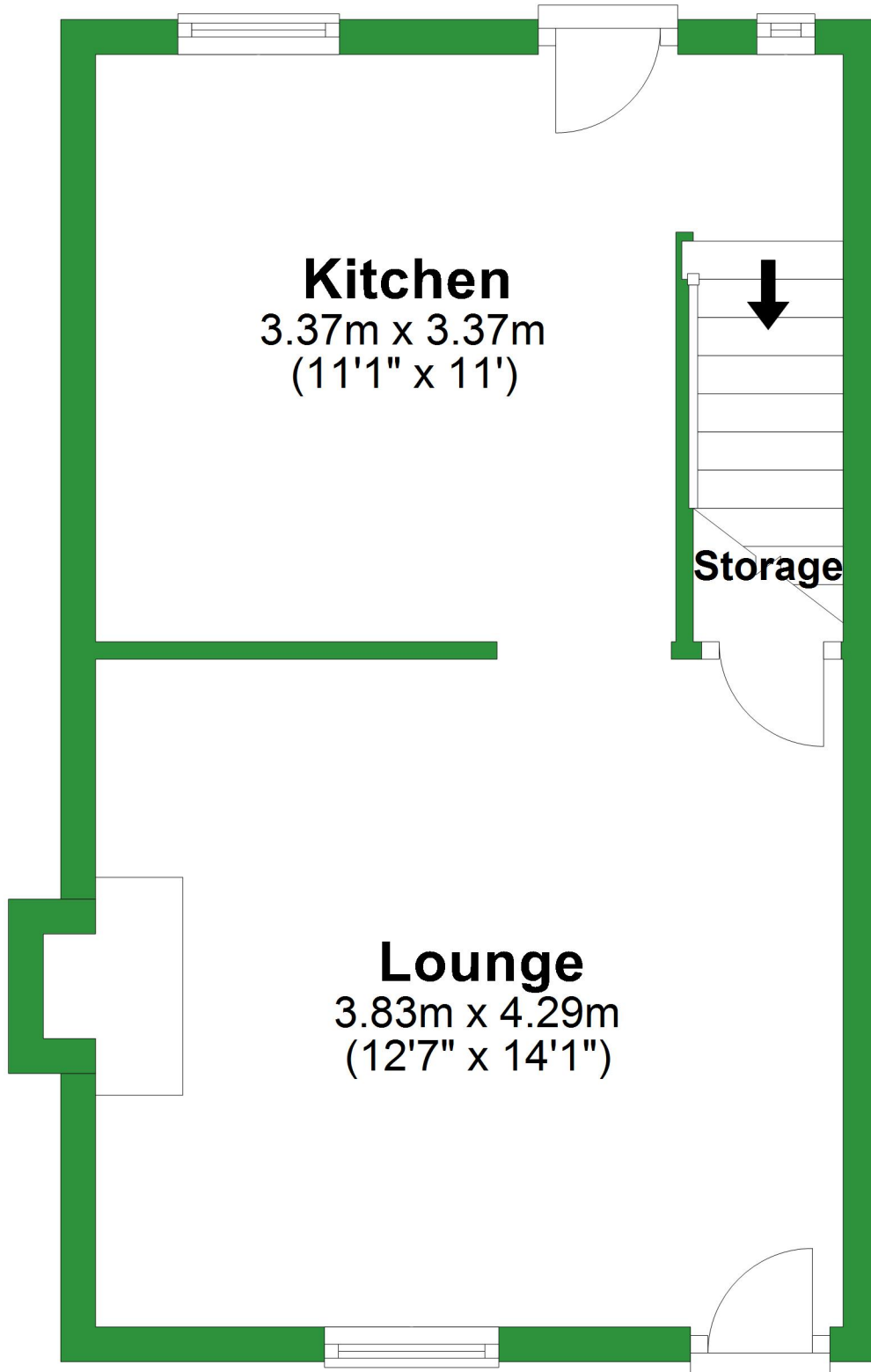

Total area: approx. 61.0 sq. metres (656.8 sq. feet)

For illustrative purposes only. Not to scale. All sizes are approximate.

Plan produced using PlanUp.

# First Floor

Approx. 31.3 sq. metres (337.1 sq. feet)

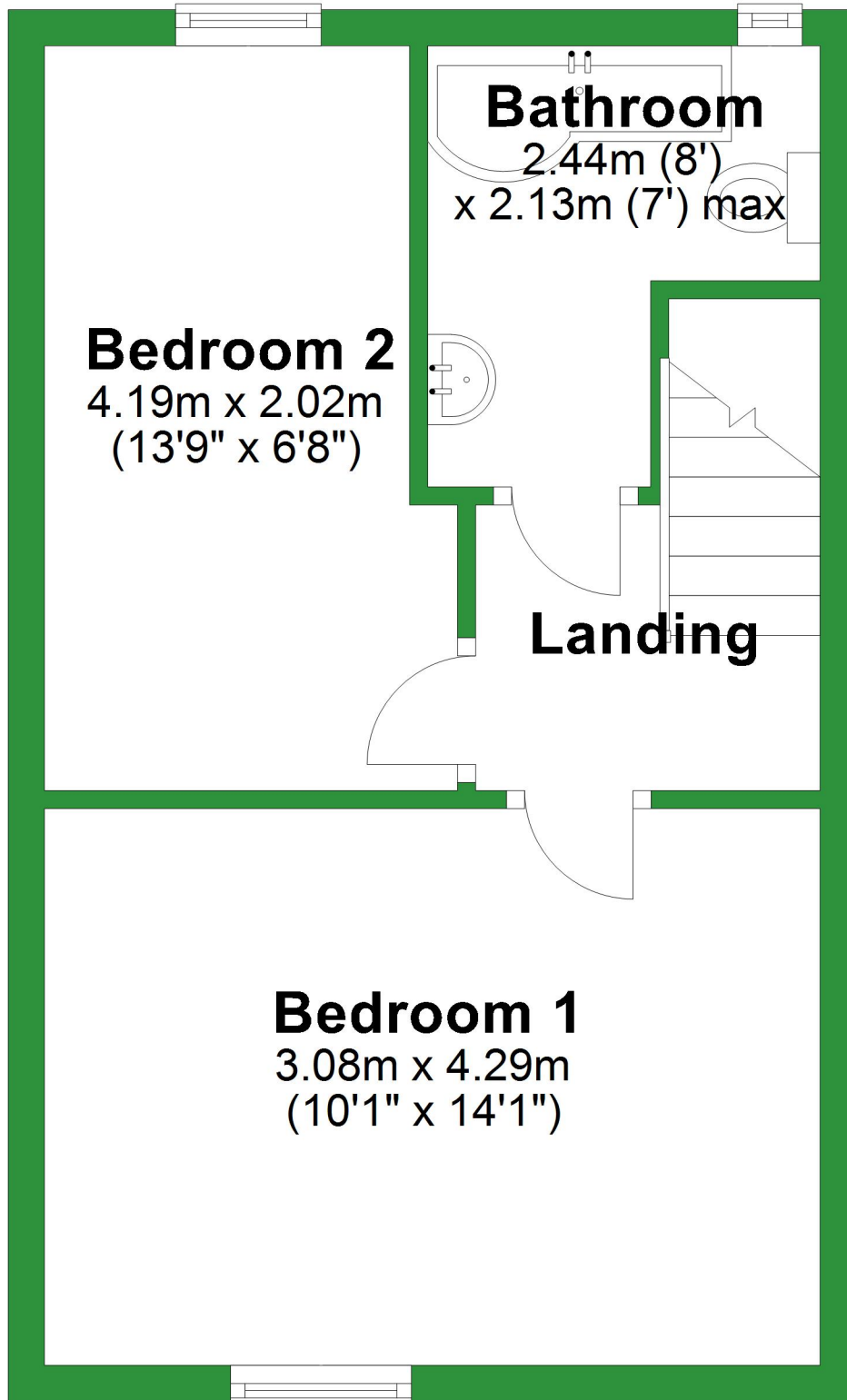

# Ground Floor

Approx. 29.7 sq. metres (319.7 sq. feet)

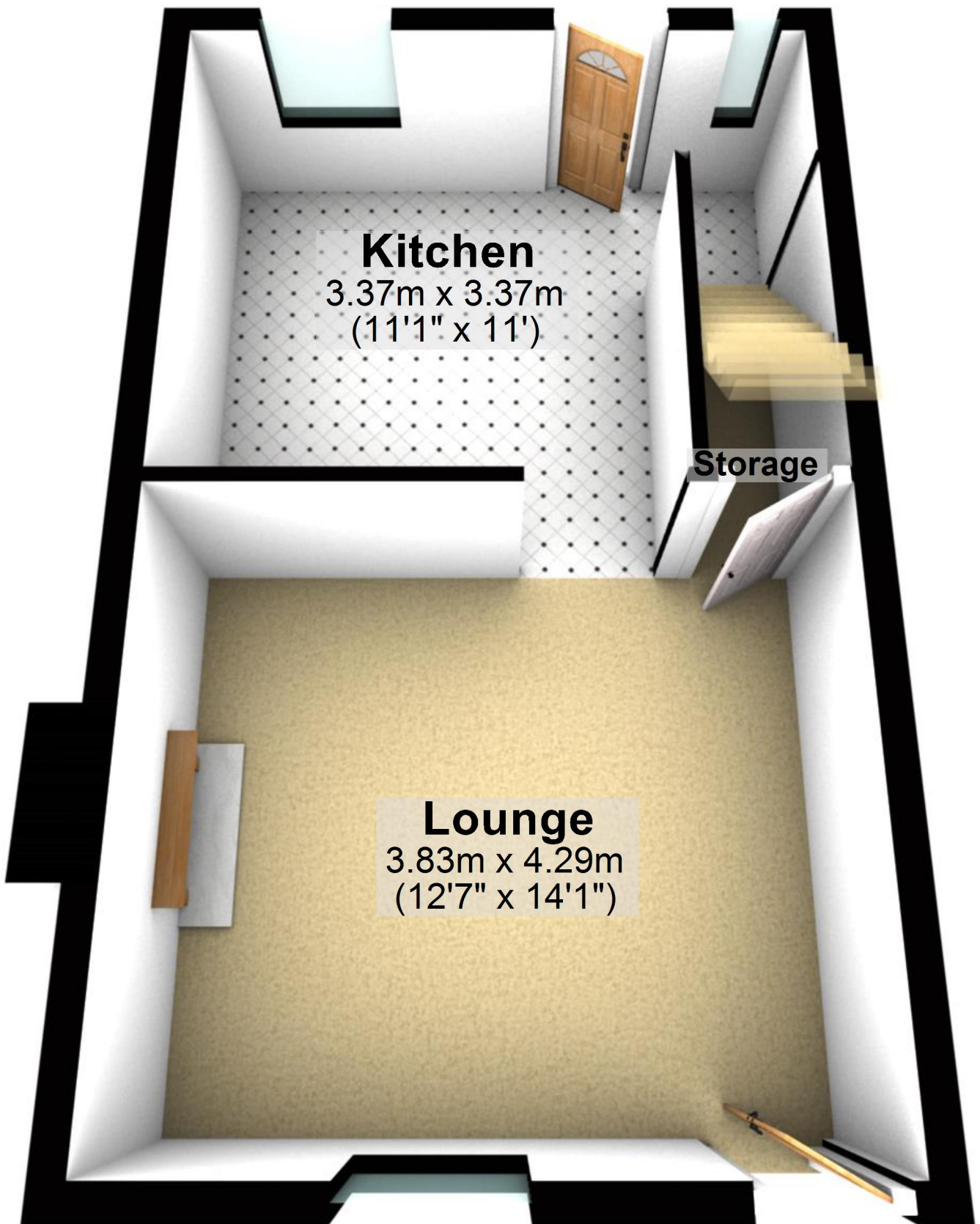

## Kitchen

3.37m x 3.37m  
(11'1" x 11')

Storage

## Lounge

3.83m x 4.29m  
(12'7" x 14'1")

Total area: approx. 61.0 sq. metres (656.8 sq. feet)

For illustrative purposes only. Not to scale. All sizes are approximate.

Plan produced using PlanUp.

# First Floor

Approx. 31.3 sq. metres (337.1 sq. feet)

## Bathroom

2.44m (8')  
x 2.13m (7') max

## Bedroom 2

4.19m x 2.02m  
(13'9" x 6'8")

## Landing

## Bedroom 1

3.08m x 4.29m  
(10'1" x 14'1")

