

# Ground Floor

Approx. 37.6 sq. metres (404.7 sq. feet)

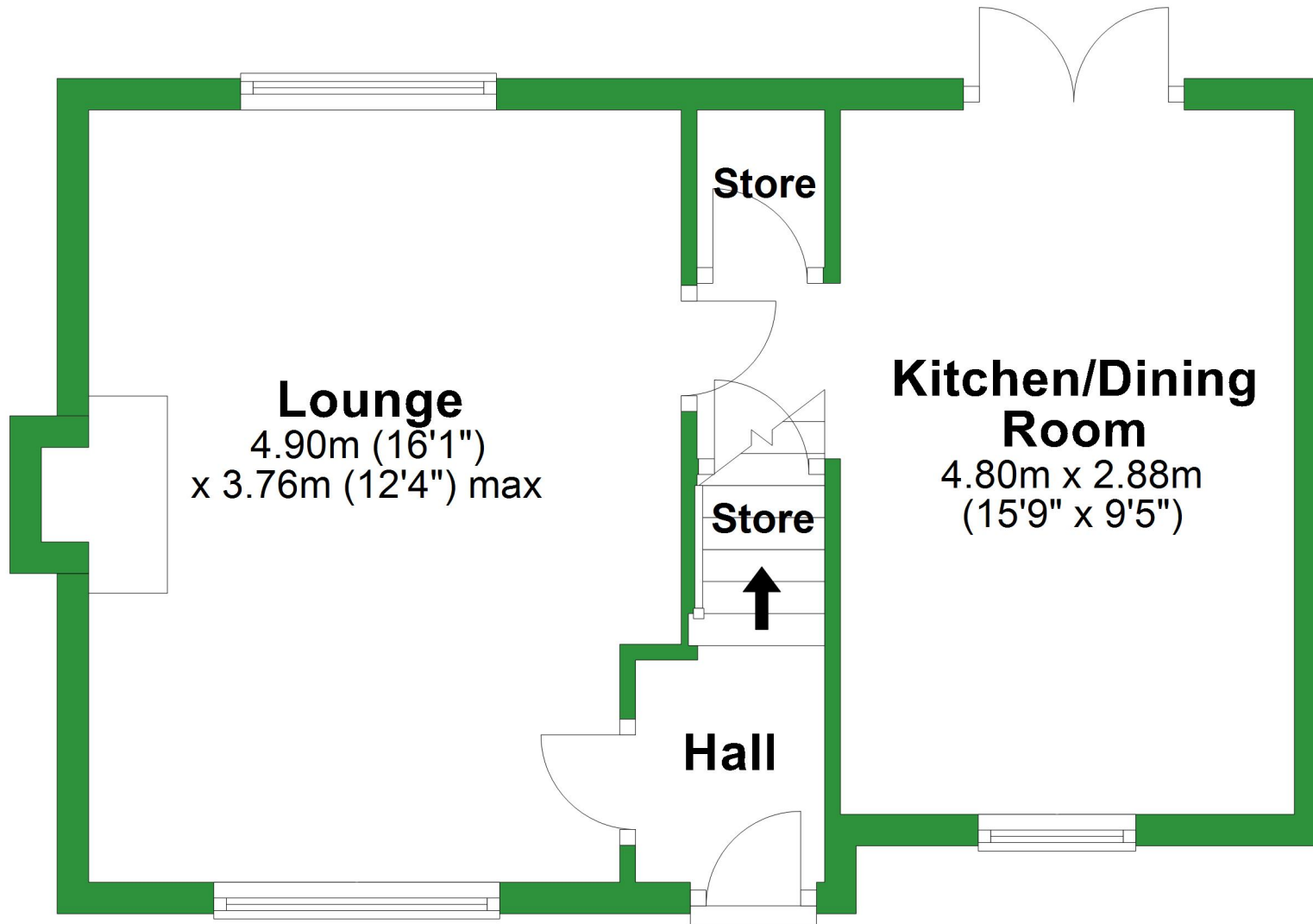

Total area: approx. 72.2 sq. metres (777.3 sq. feet)

For illustrative purposes only. Not to scale. All sizes are approximate.  
Plan produced using PlanUp.

# First Floor

Approx. 34.6 sq. metres (372.6 sq. feet)

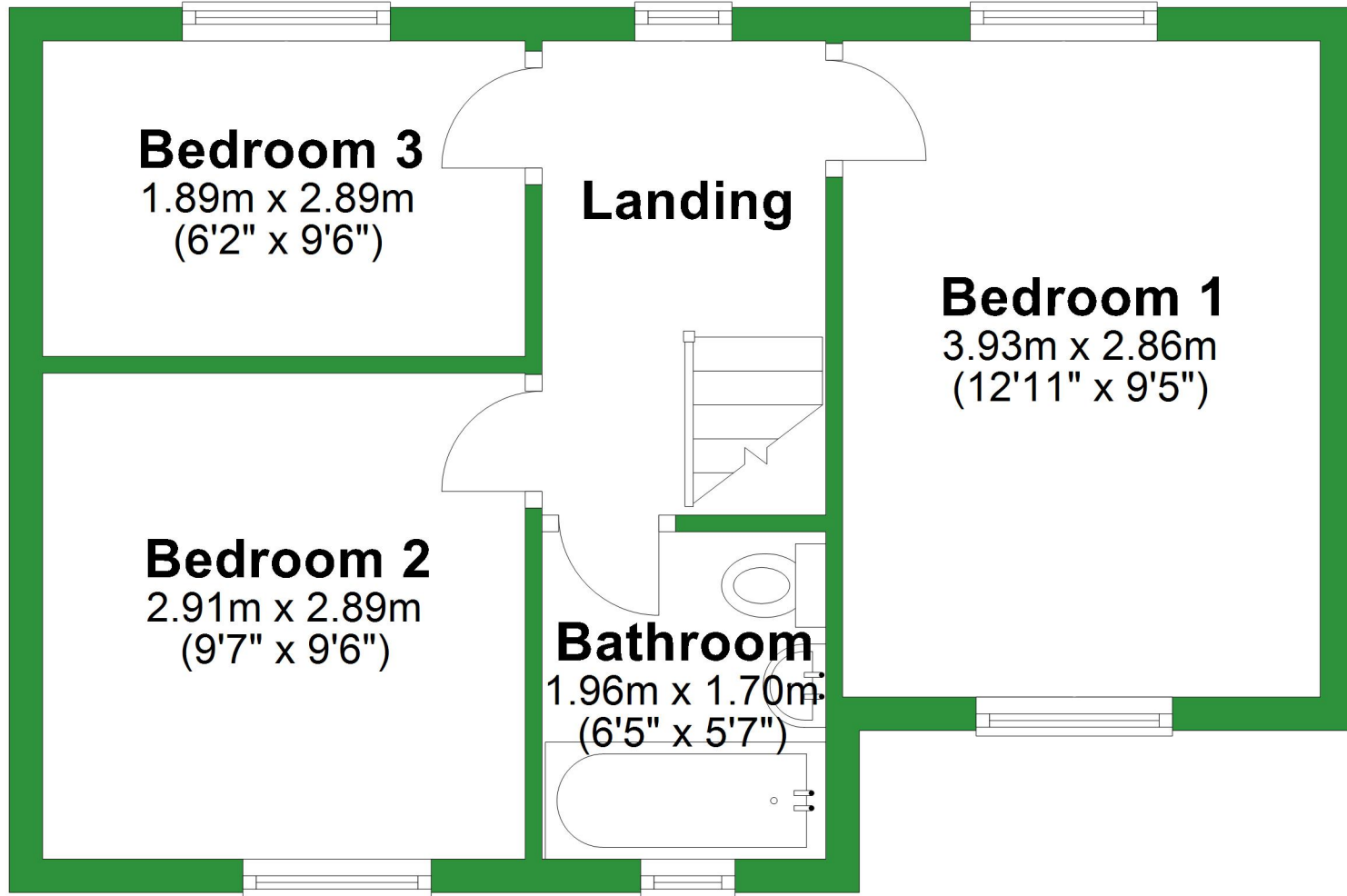

# Ground Floor

Approx. 37.6 sq. metres (404.7 sq. feet)

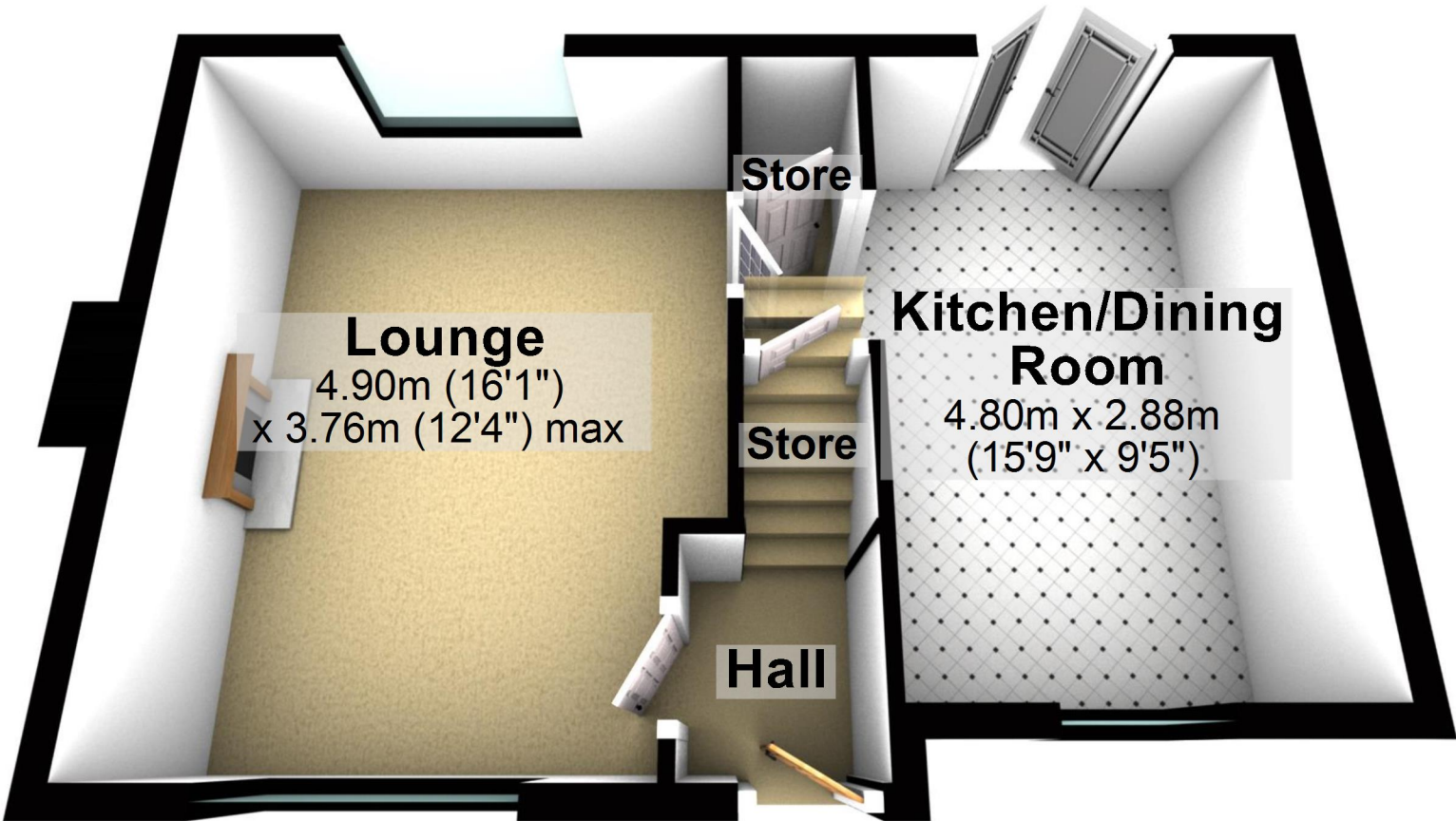

Total area: approx. 72.2 sq. metres (777.3 sq. feet)

For illustrative purposes only. Not to scale. All sizes are approximate.

Plan produced using PlanUp.

# First Floor

Approx. 34.6 sq. metres (372.6 sq. feet)

**Bedroom 3**  
1.89m x 2.89m  
(6'2" x 9'6")

**Landing**

**Bedroom 1**  
3.93m x 2.86m  
(12'11" x 9'5")

**Bedroom 2**  
2.91m x 2.89m  
(9'7" x 9'6")

**Bathroom**  
1.96m x 1.70m  
(6'5" x 5'7")

