

# Ground Floor

Approx. 37.4 sq. metres (402.1 sq. feet)

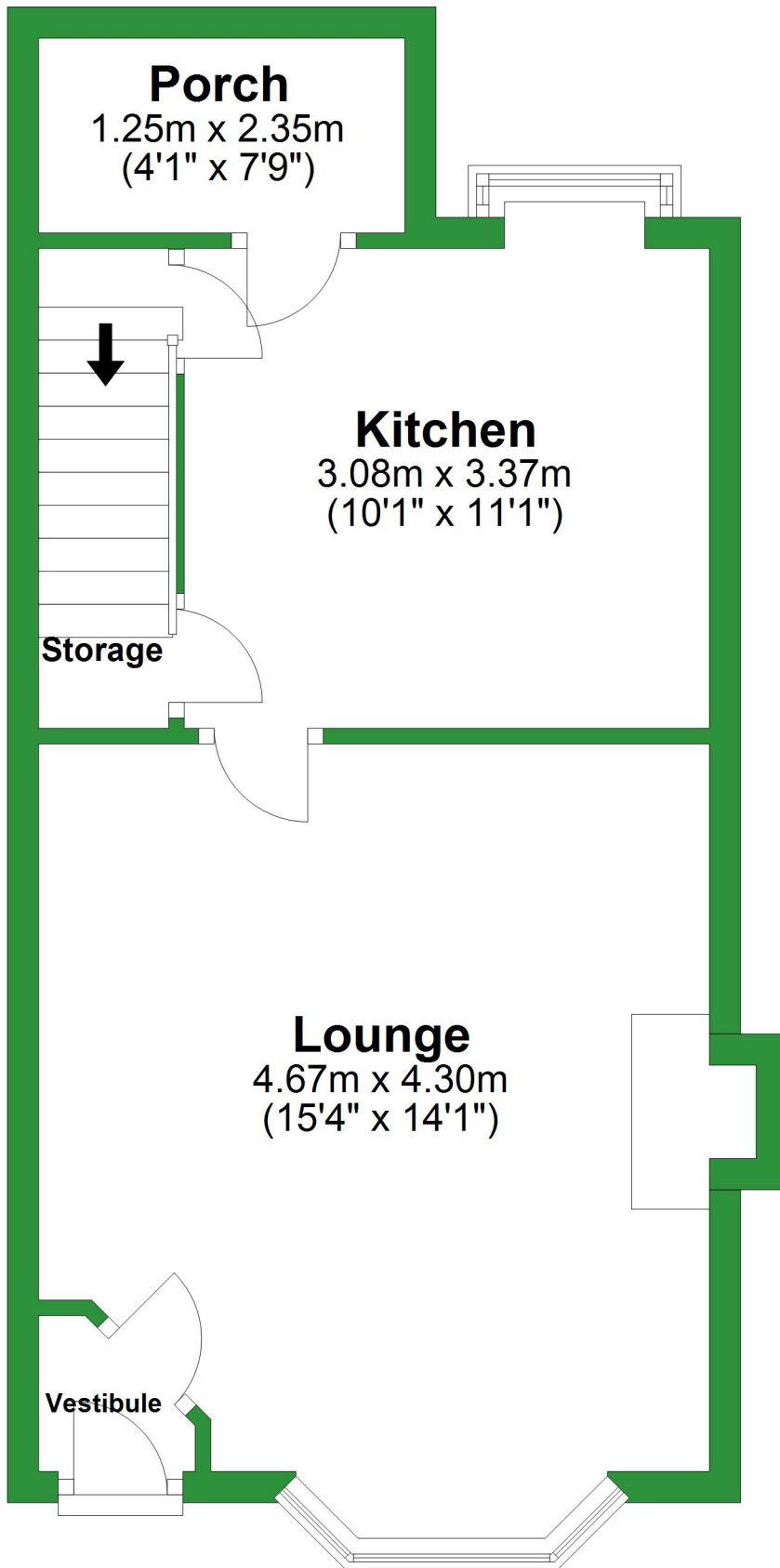

Total area: approx. 71.2 sq. metres (765.9 sq. feet)

For illustrative purposes only. Not to scale. All sizes are approximate.

Plan produced using PlanUp.

# First Floor

Approx. 33.8 sq. metres (363.8 sq. feet)

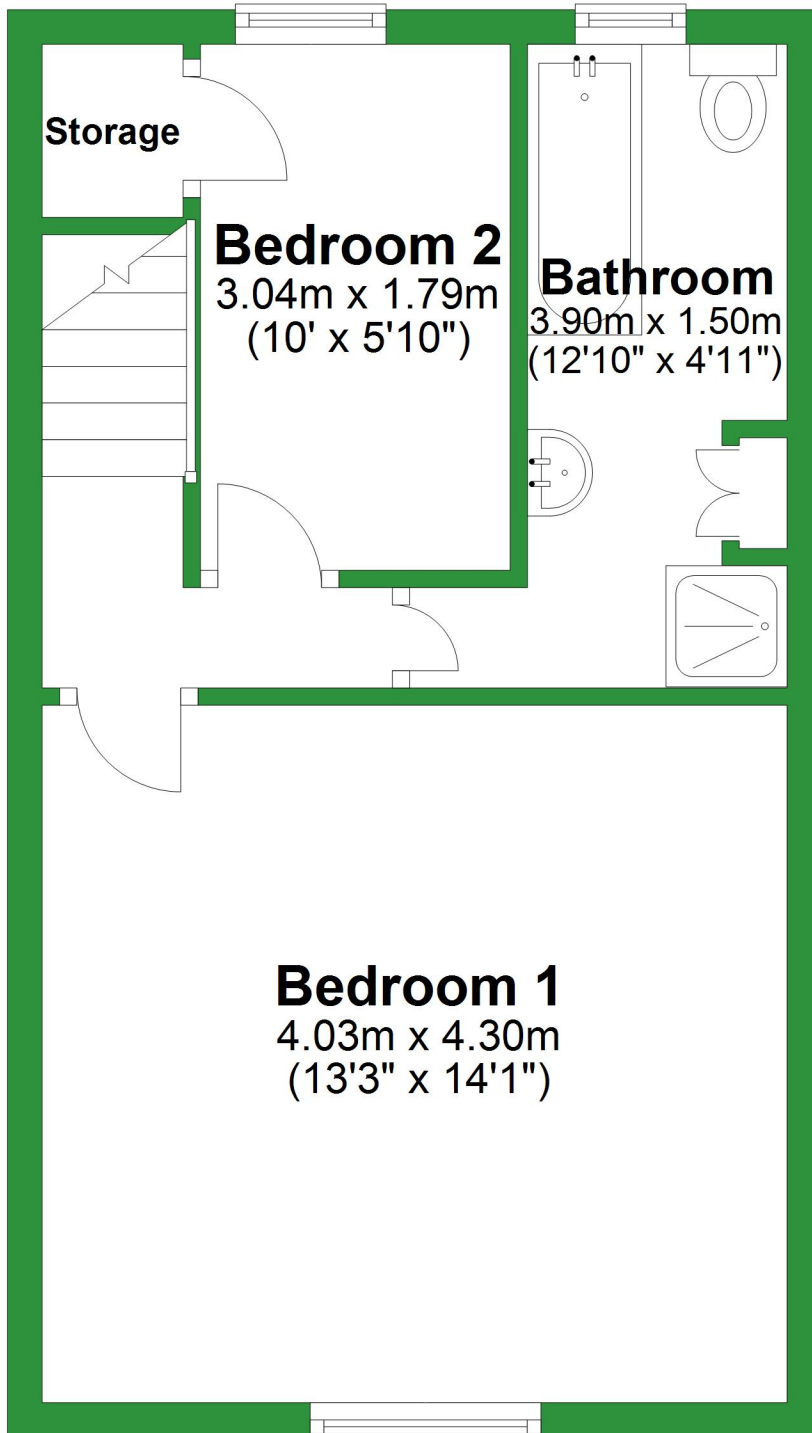

# Ground Floor

Approx. 37.4 sq. metres (402.1 sq. feet)

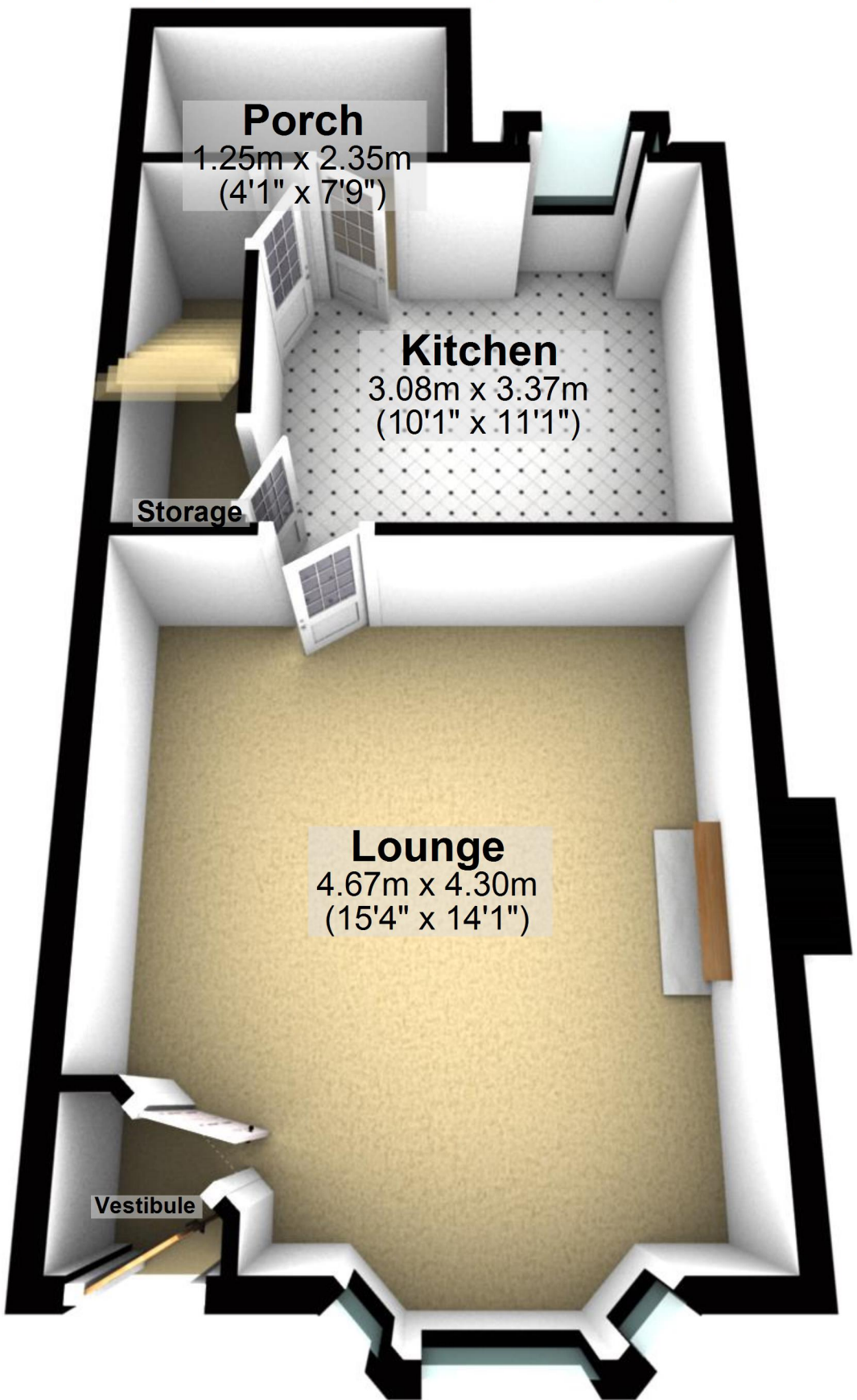

## Porch

1.25m x 2.35m  
(4'1" x 7'9")

## Kitchen

3.08m x 3.37m  
(10'1" x 11'1")

Storage

## Lounge

4.67m x 4.30m  
(15'4" x 14'1")

Vestibule

Total area: approx. 71.2 sq. metres (765.9 sq. feet)

For illustrative purposes only. Not to scale. All sizes are approximate.

Plan produced using PlanUp.

# First Floor

Approx. 33.8 sq. metres (363.8 sq. feet)

