

# Ground Floor

Approx. 77.9 sq. metres (838.5 sq. feet)

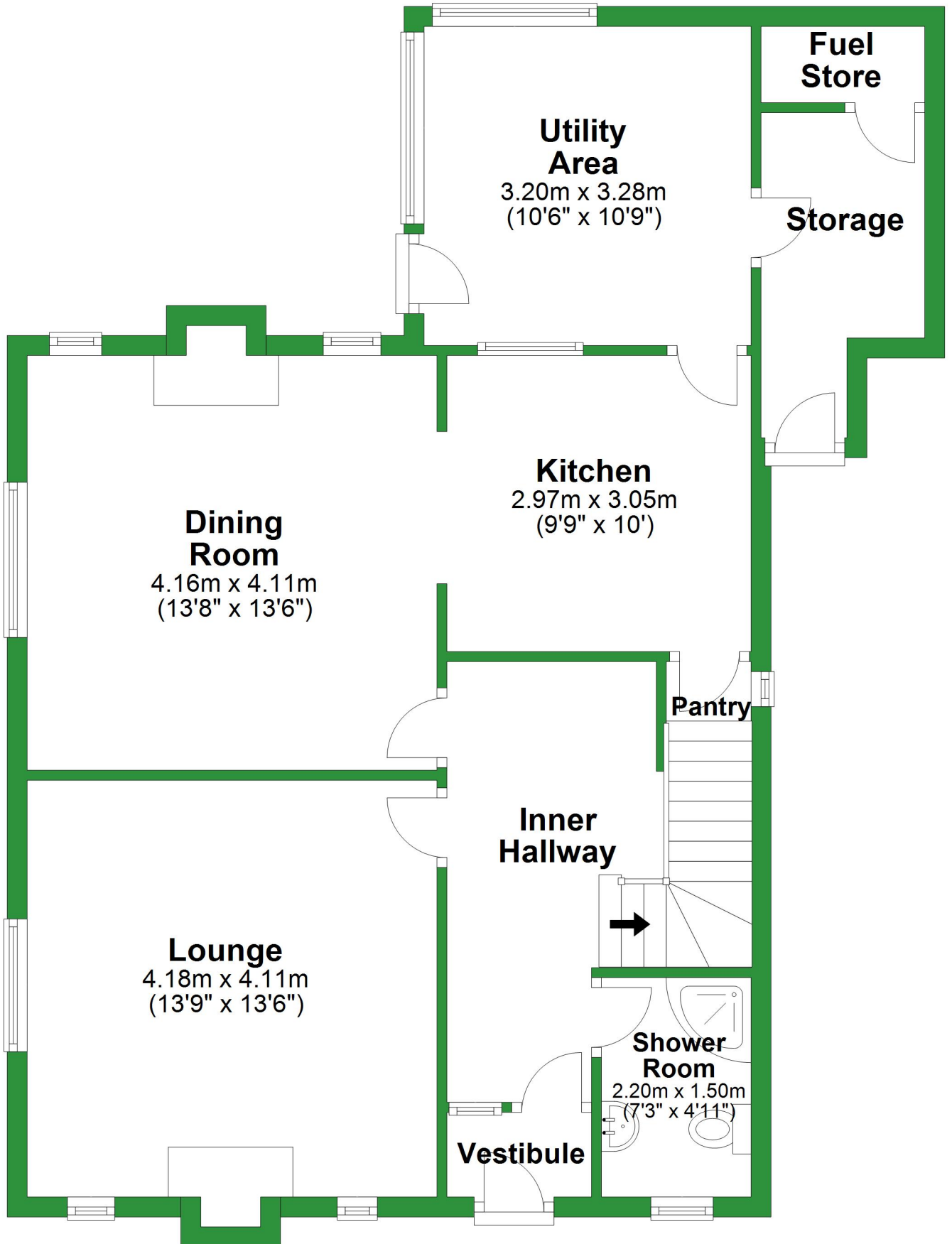

Total area: approx. 139.2 sq. metres (1498.0 sq. feet)

For illustrative purposes only. Not to scale. All sizes are approximate.  
Plan produced using PlanUp.

# First Floor

Approx. 61.3 sq. metres (659.5 sq. feet)

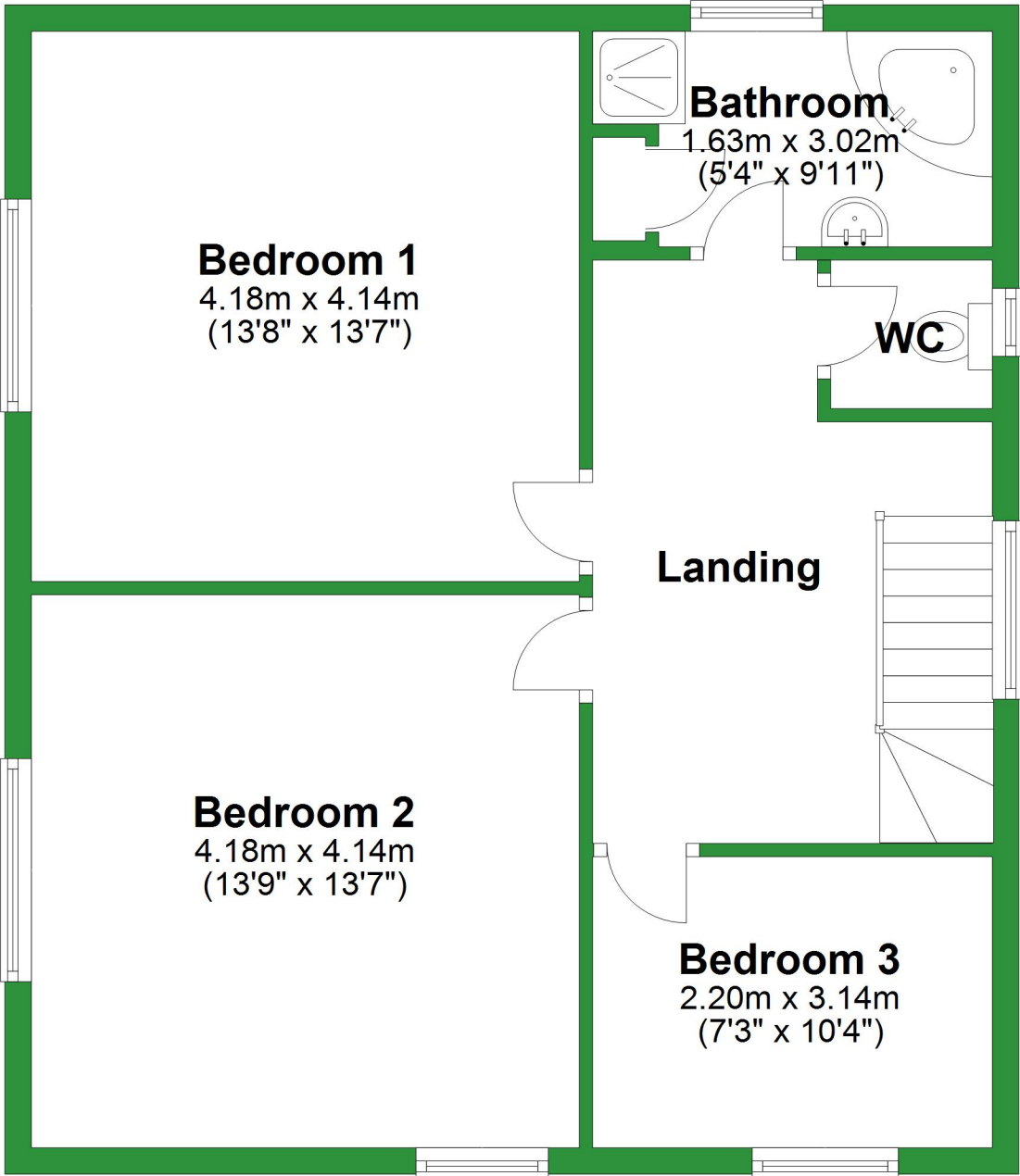

# Ground Floor

Approx. 77.9 sq. metres (838.5 sq. feet)

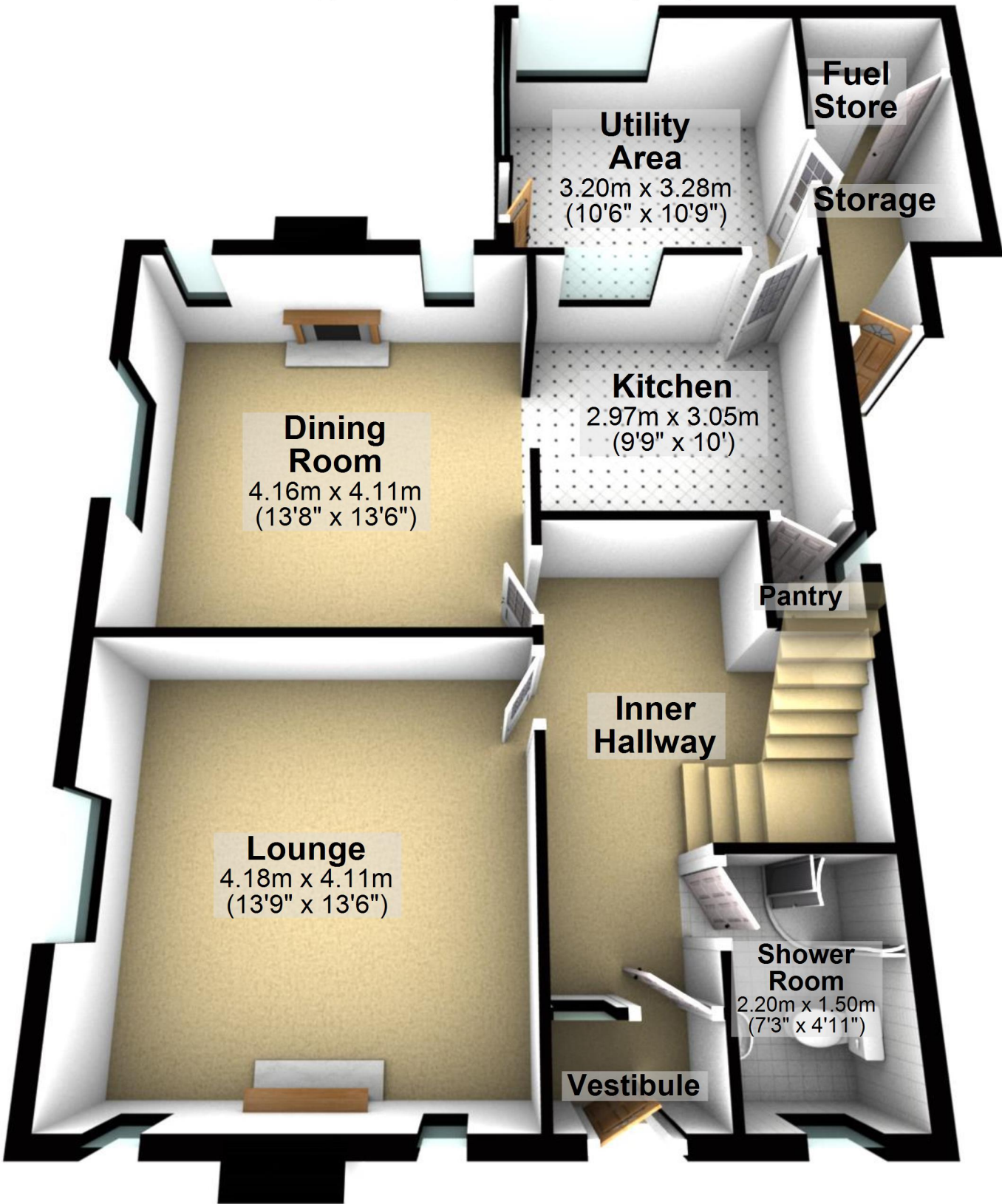

Total area: approx. 139.2 sq. metres (1498.0 sq. feet)

For illustrative purposes only. Not to scale. All sizes are approximate.  
Plan produced using PlanUp.

# First Floor

Approx. 61.3 sq. metres (659.5 sq. feet)

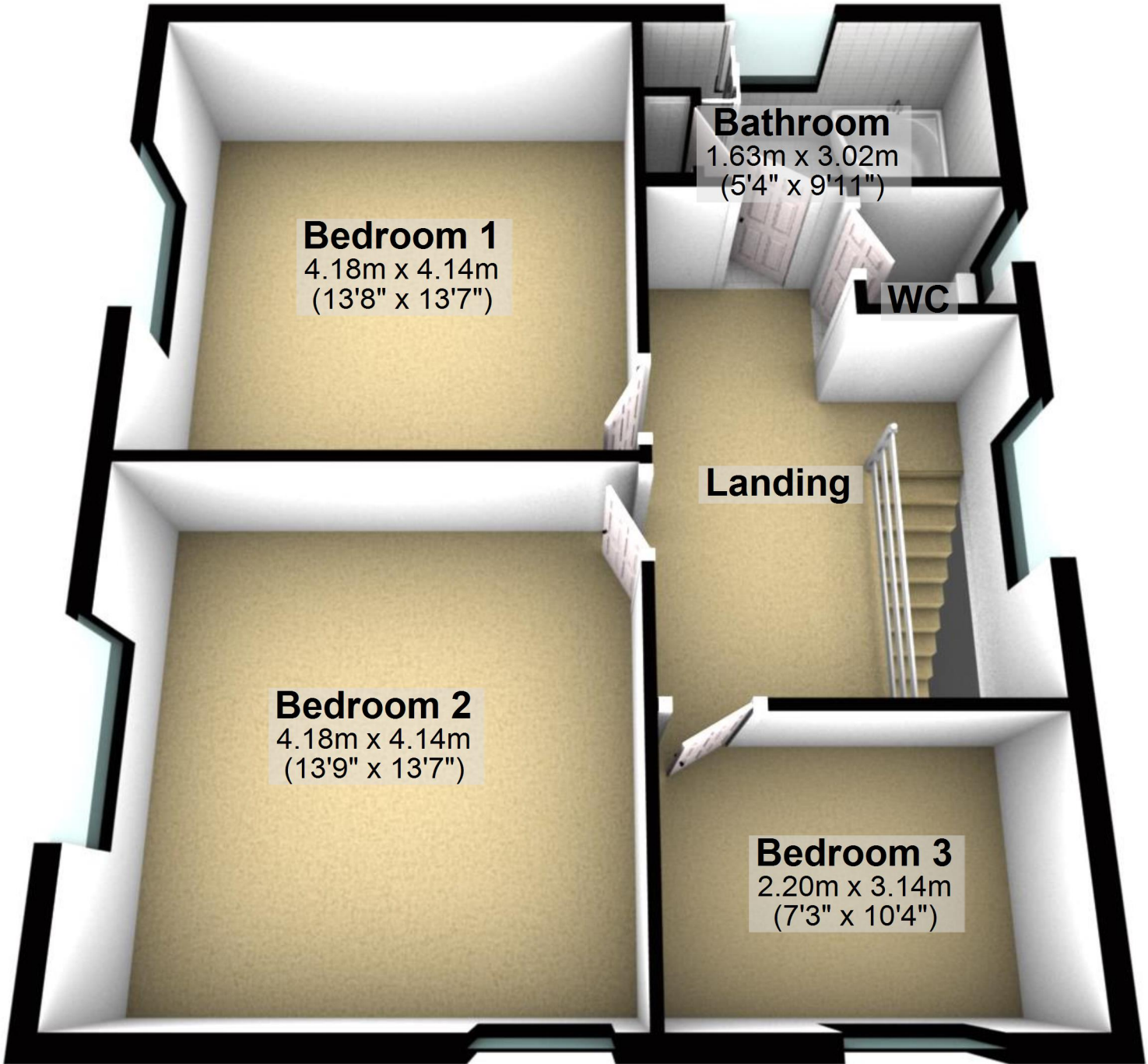

**Bedroom 1**  
4.18m x 4.14m  
(13'8" x 13'7")

**Bathroom**  
1.63m x 3.02m  
(5'4" x 9'11")

**WC**

**Landing**

**Bedroom 2**  
4.18m x 4.14m  
(13'9" x 13'7")

**Bedroom 3**  
2.20m x 3.14m  
(7'3" x 10'4")