

# Ground Floor

Approx. 46.7 sq. metres (503.1 sq. feet)

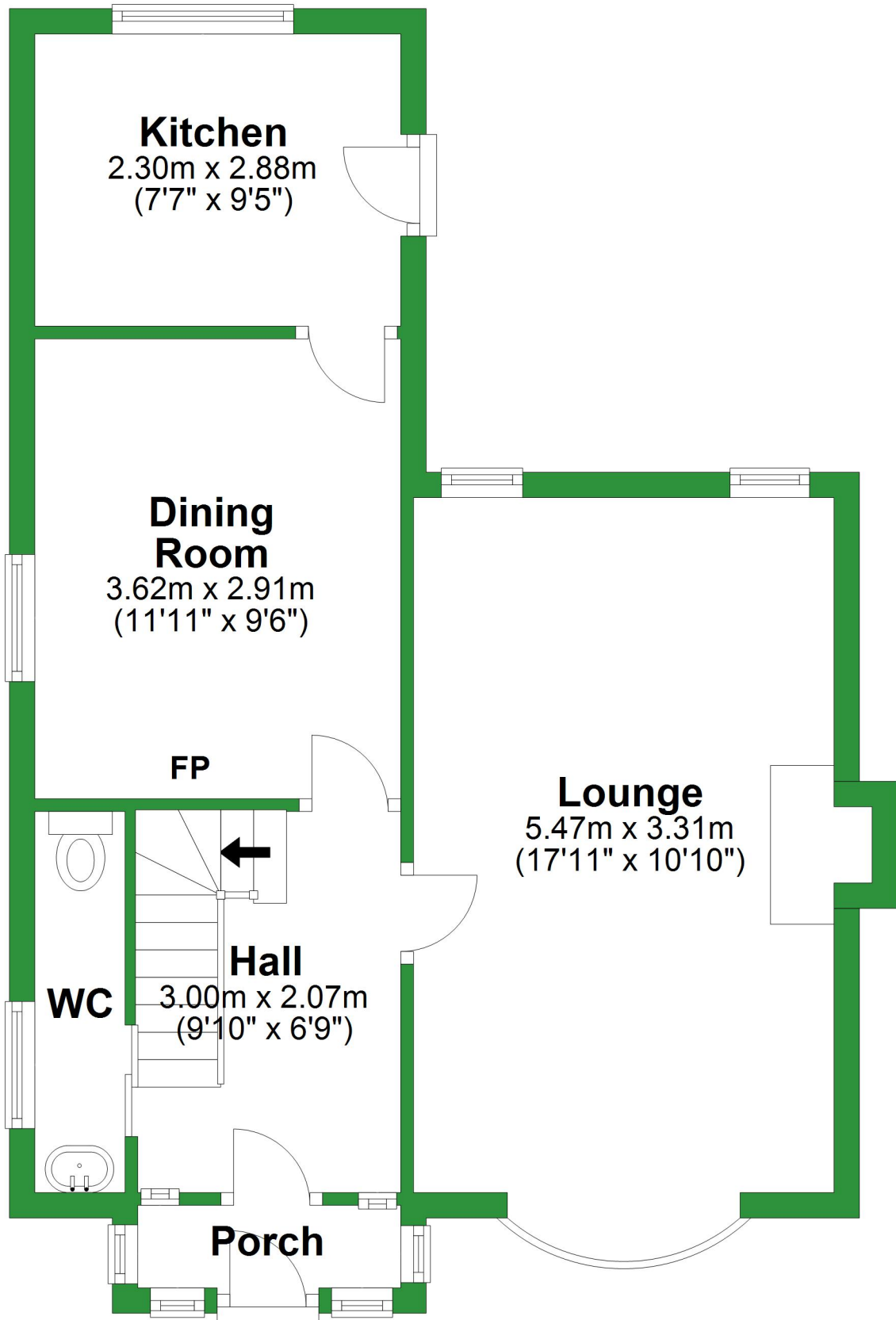

Total area: approx. 78.8 sq. metres (848.0 sq. feet)

For illustrative purposes only. Not to scale. All sizes are approximate.

Plan produced using PlanUp.

# First Floor

Approx. 32.0 sq. metres (344.9 sq. feet)

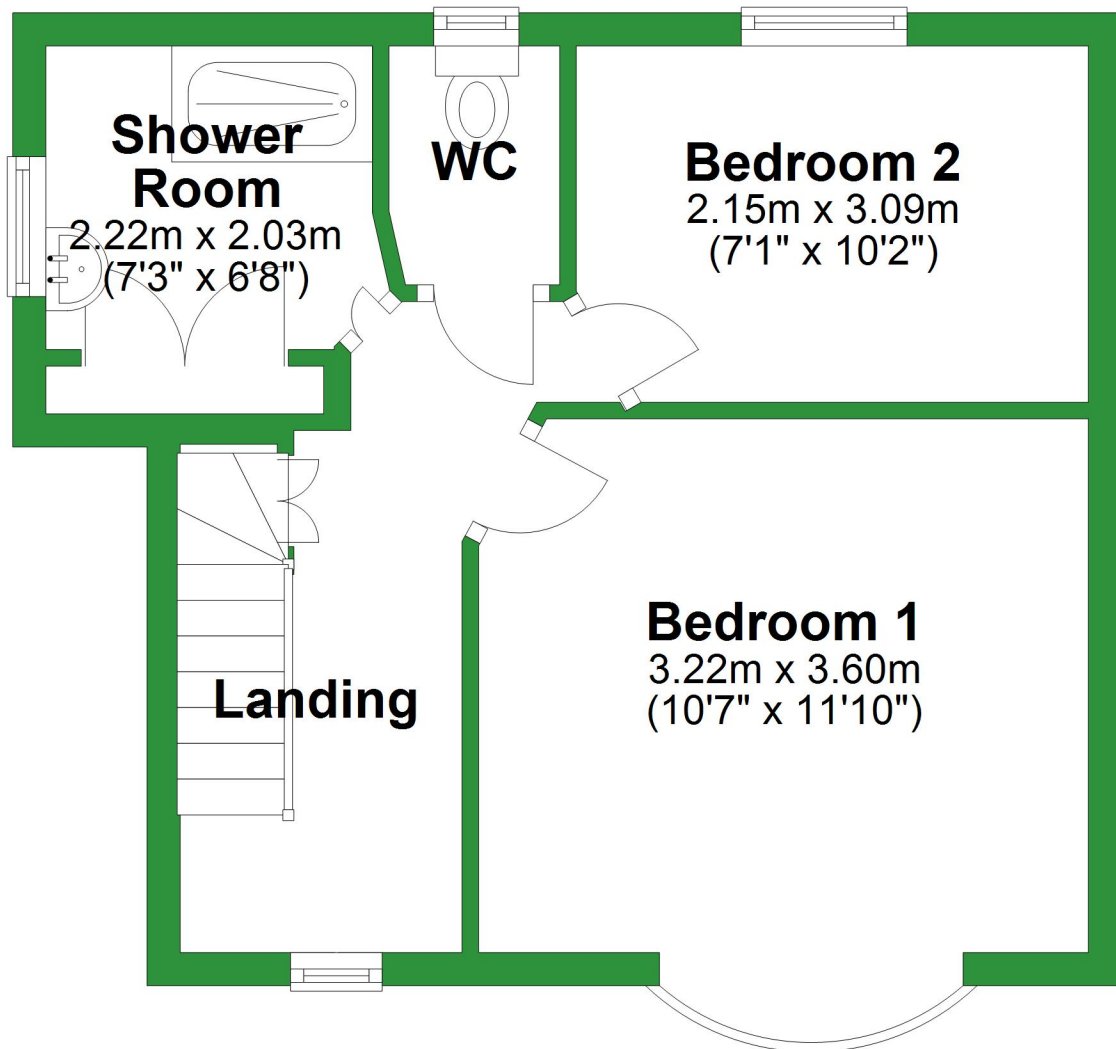

# Ground Floor

Approx. 40.6 sq. metres (437.3 sq. feet)

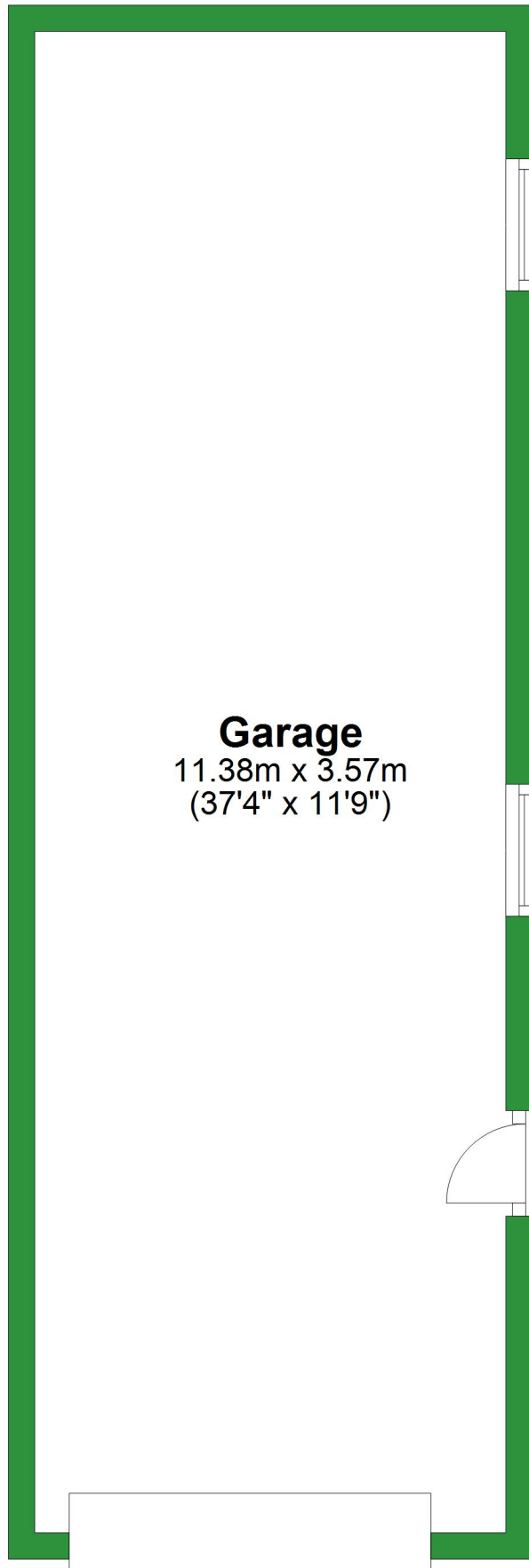

Total area: approx. 40.6 sq. metres (437.3 sq. feet)

For illustrative purposes only. Not to scale. All sizes are approximate.  
Plan produced using PlanUp.

# Ground Floor

Approx. 46.7 sq. metres (503.1 sq. feet)

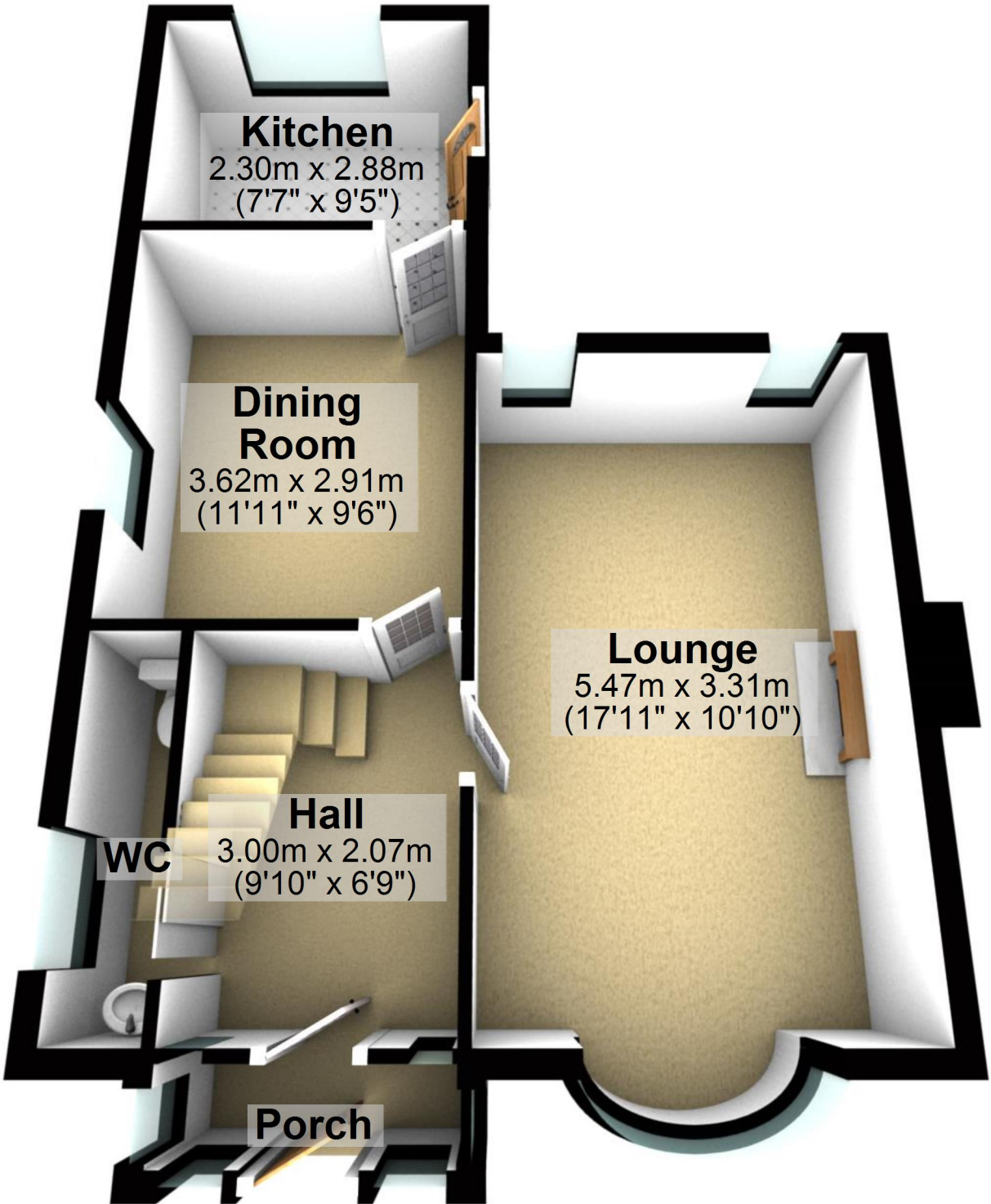

Total area: approx. 78.8 sq. metres (848.0 sq. feet)

For illustrative purposes only. Not to scale. All sizes are approximate.

Plan produced using PlanUp.

# First Floor

Approx. 32.0 sq. metres (344.9 sq. feet)

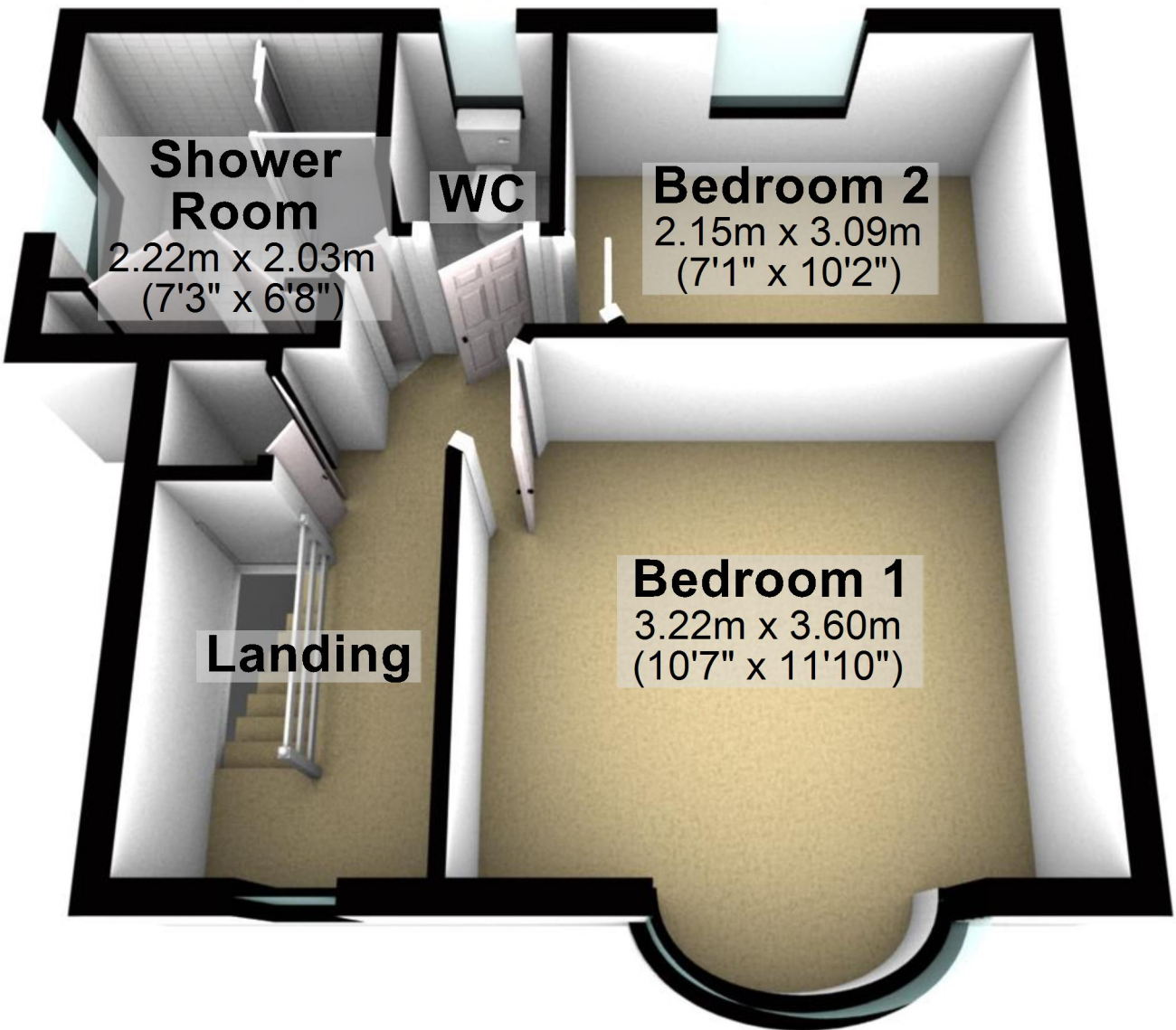

**Shower Room**

2.22m x 2.03m  
(7'3" x 6'8")

**WC**

**Bedroom 2**

2.15m x 3.09m  
(7'1" x 10'2")

**Landing**

**Bedroom 1**

3.22m x 3.60m  
(10'7" x 11'10")

# Ground Floor

Approx. 40.6 sq. metres (437.3 sq. feet)

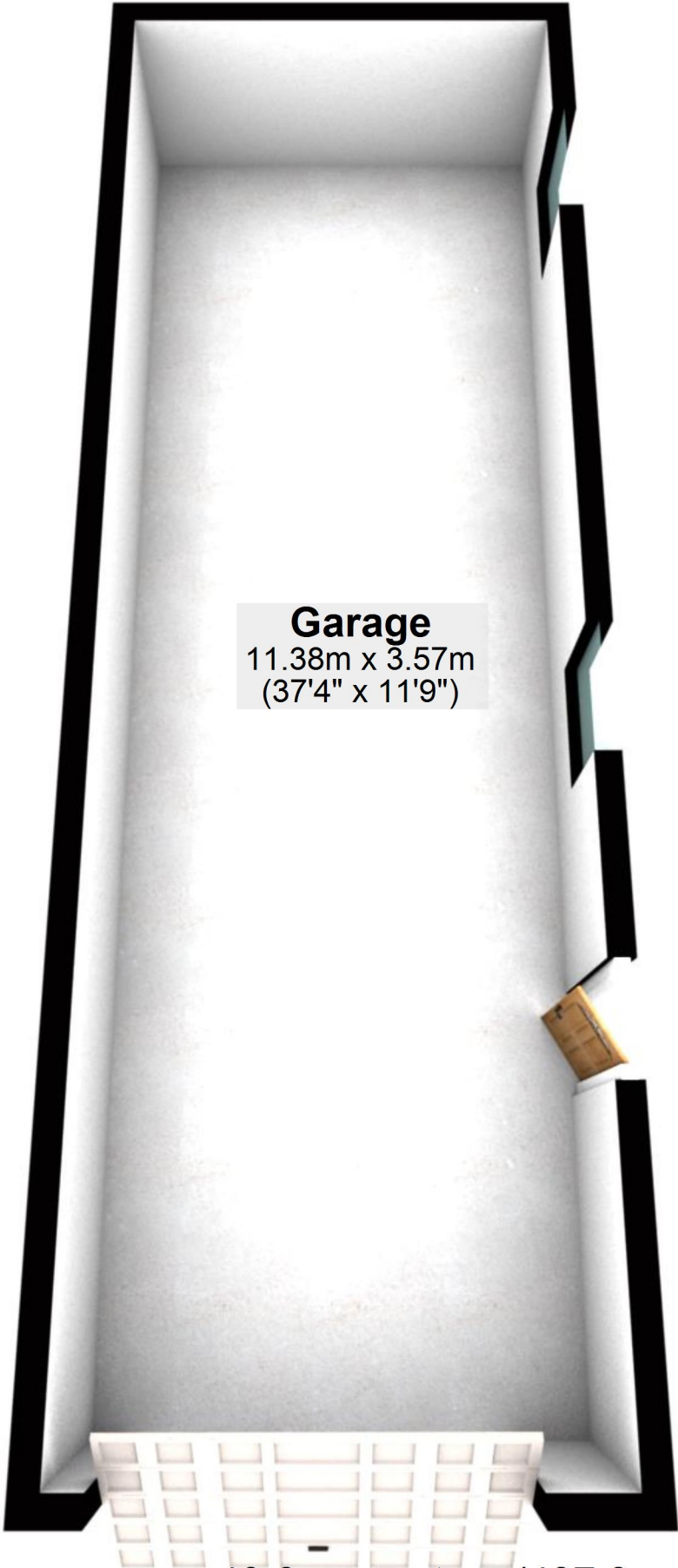

## Garage

11.38m x 3.57m  
(37'4" x 11'9")

Total area: approx. 40.6 sq. metres (437.3 sq. feet)

For illustrative purposes only. Not to scale. All sizes are approximate.

Plan produced using PlanUp.