

# Ground Floor

Approx. 64.7 sq. metres (696.0 sq. feet)

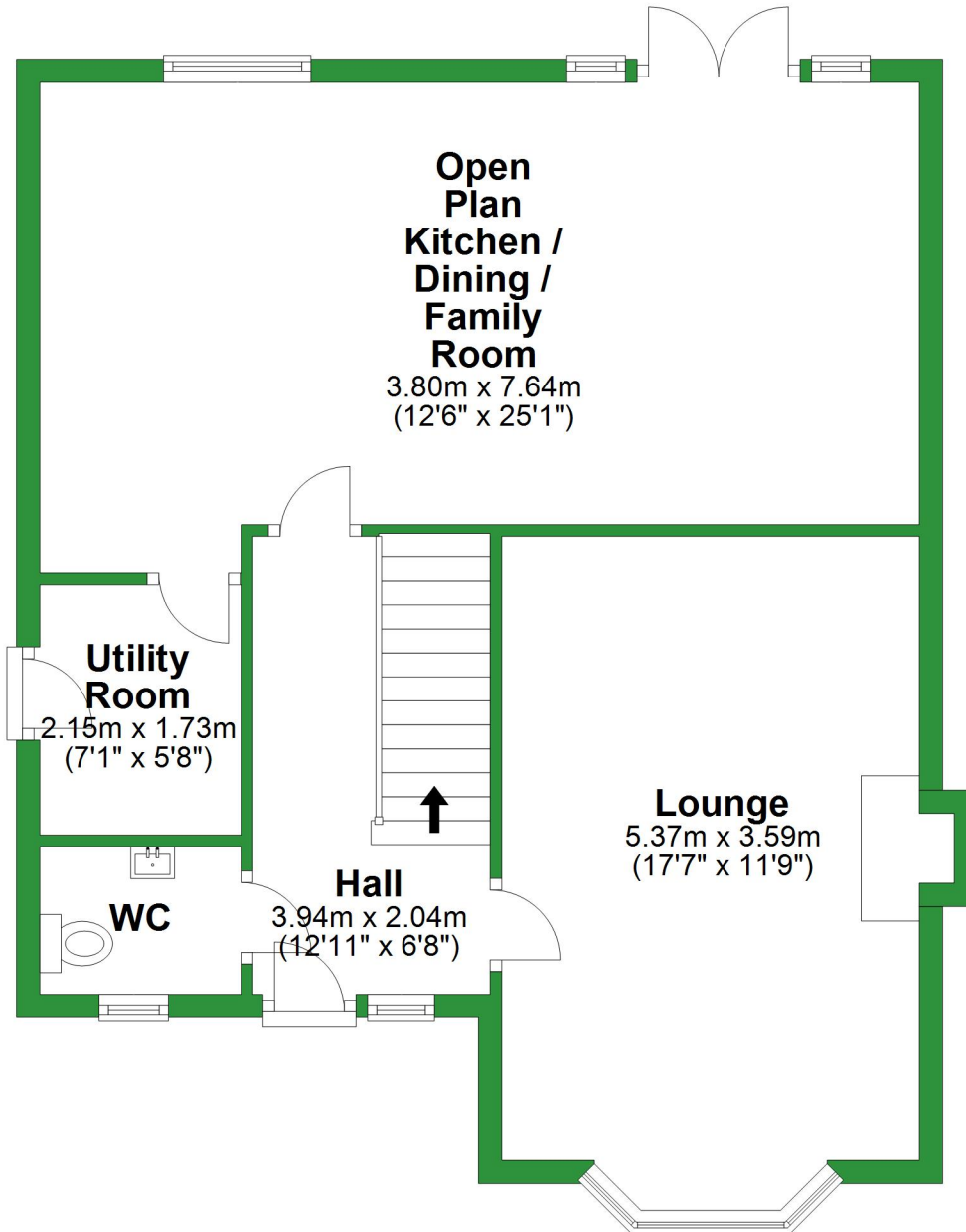

Total area: approx. 130.4 sq. metres (1403.4 sq. feet)

For illustrative purposes only. Not to scale. All sizes are approximate.

Plan produced using PlanUp.

# First Floor

Approx. 65.7 sq. metres (707.4 sq. feet)

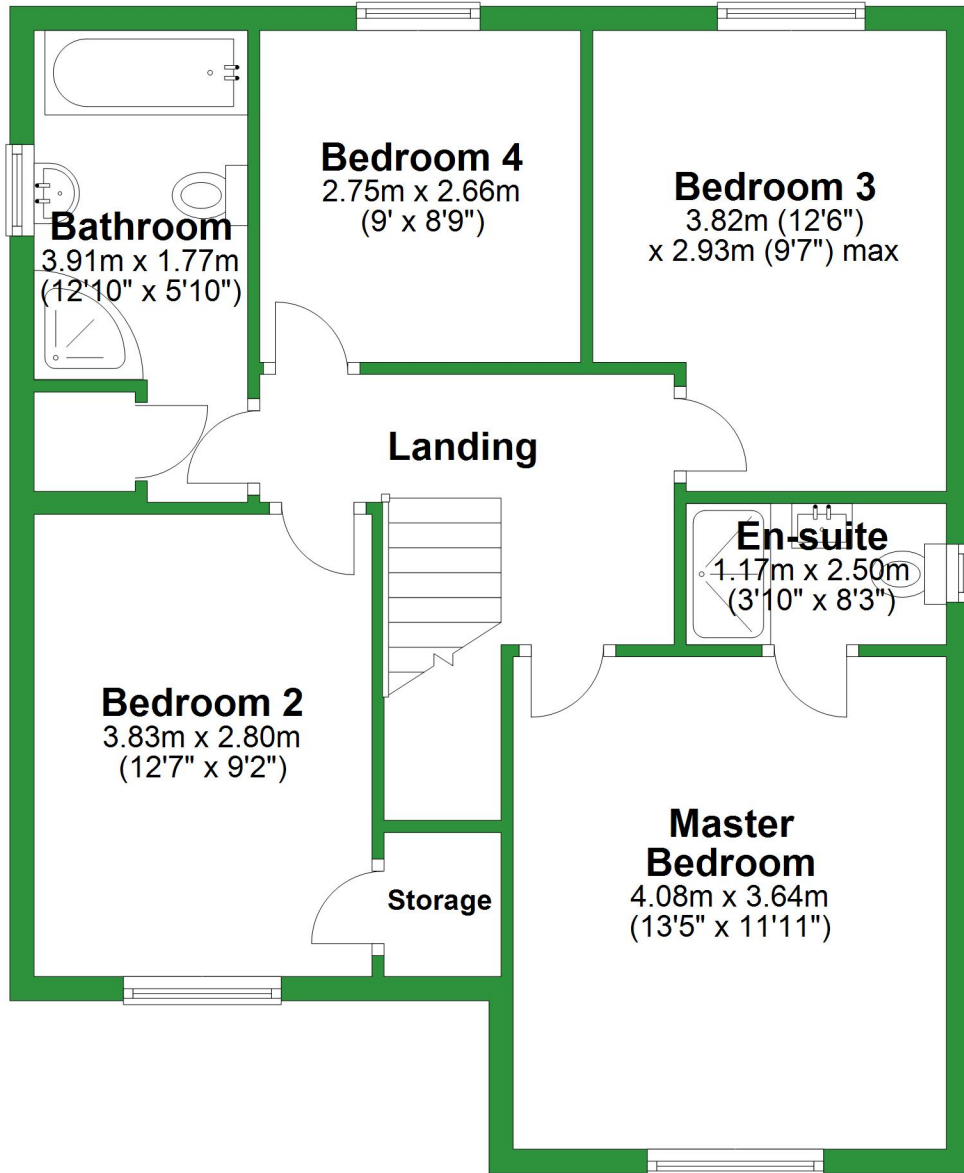

# Ground Floor

Approx. 64.7 sq. metres (696.0 sq. feet)

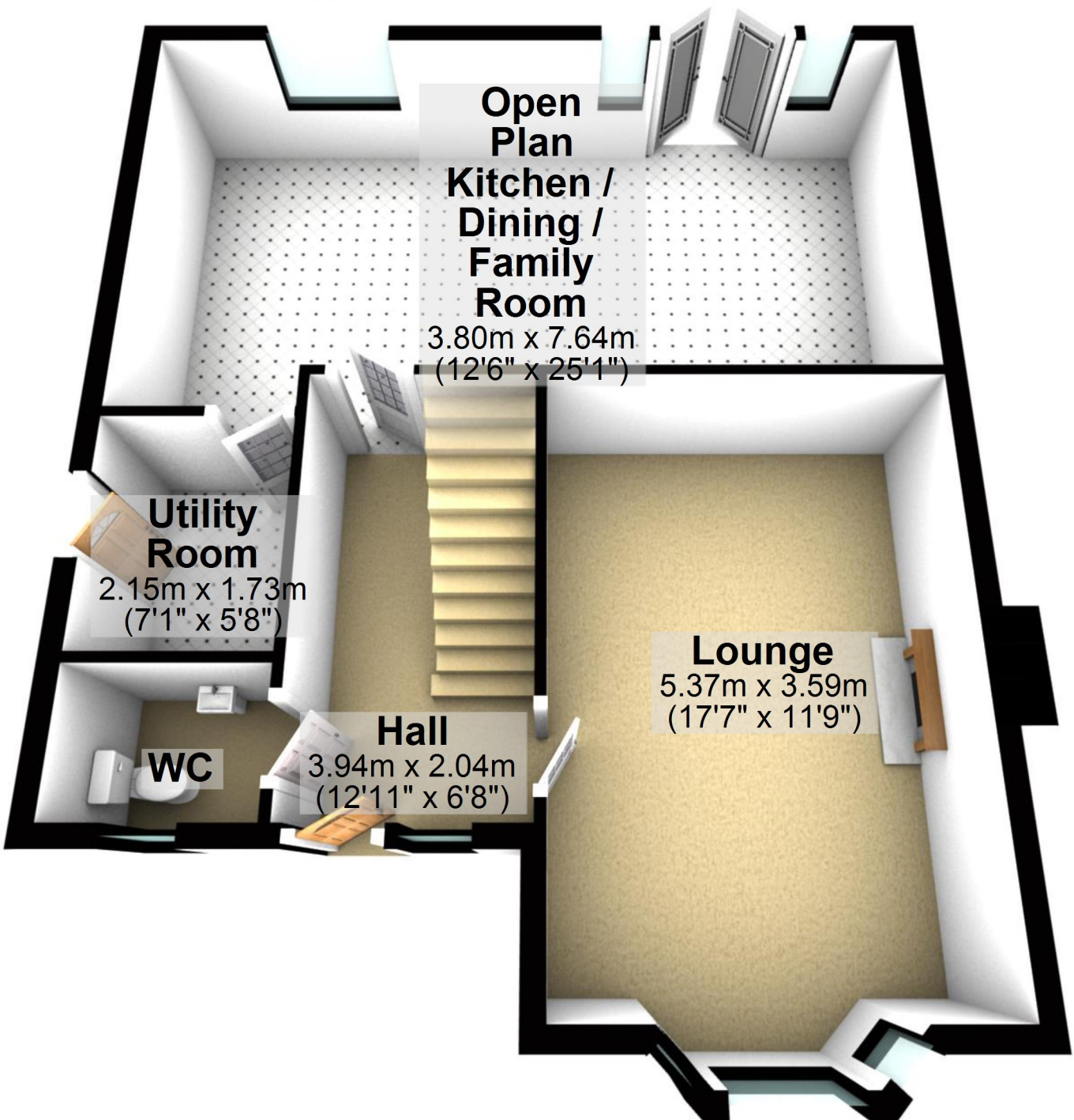

Total area: approx. 130.4 sq. metres (1403.4 sq. feet)

For illustrative purposes only. Not to scale. All sizes are approximate.

Plan produced using PlanUp.

# First Floor

Approx. 65.7 sq. metres (707.4 sq. feet)

