

# Ground Floor

Approx. 60.8 sq. metres (654.8 sq. feet)

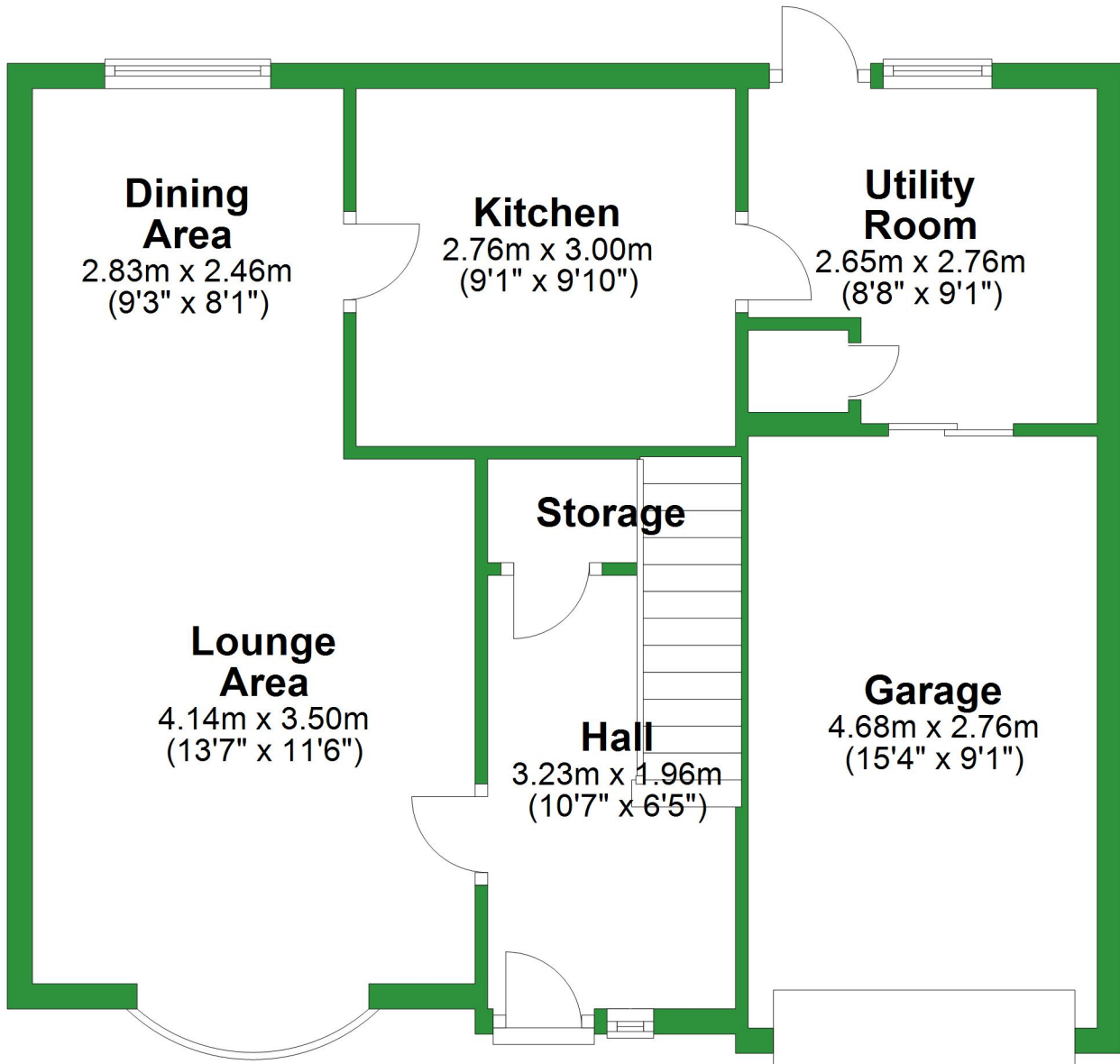

Total area: approx. 100.2 sq. metres (1078.5 sq. feet)

For illustrative purposes only. Not to scale. All sizes are approximate.  
Plan produced using PlanUp.

# First Floor

Approx. 39.4 sq. metres (423.7 sq. feet)

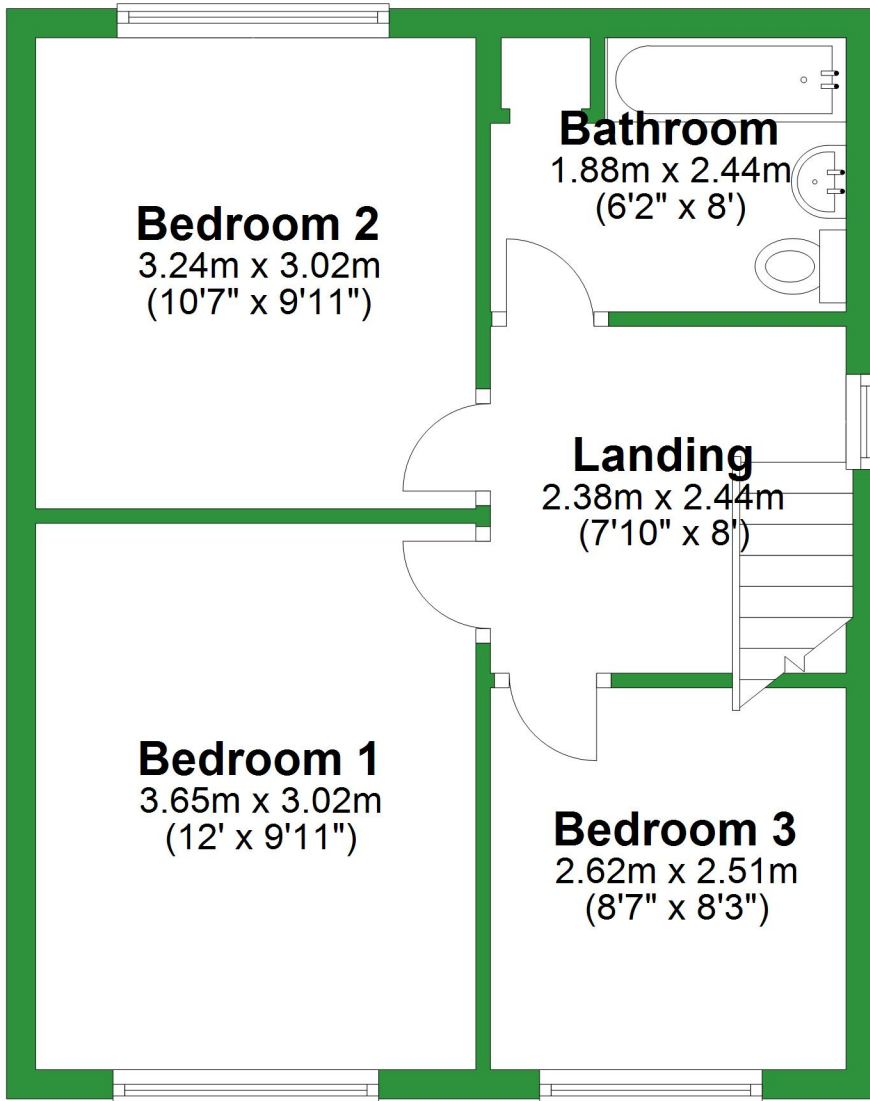

# Ground Floor

Approx. 60.8 sq. metres (654.8 sq. feet)

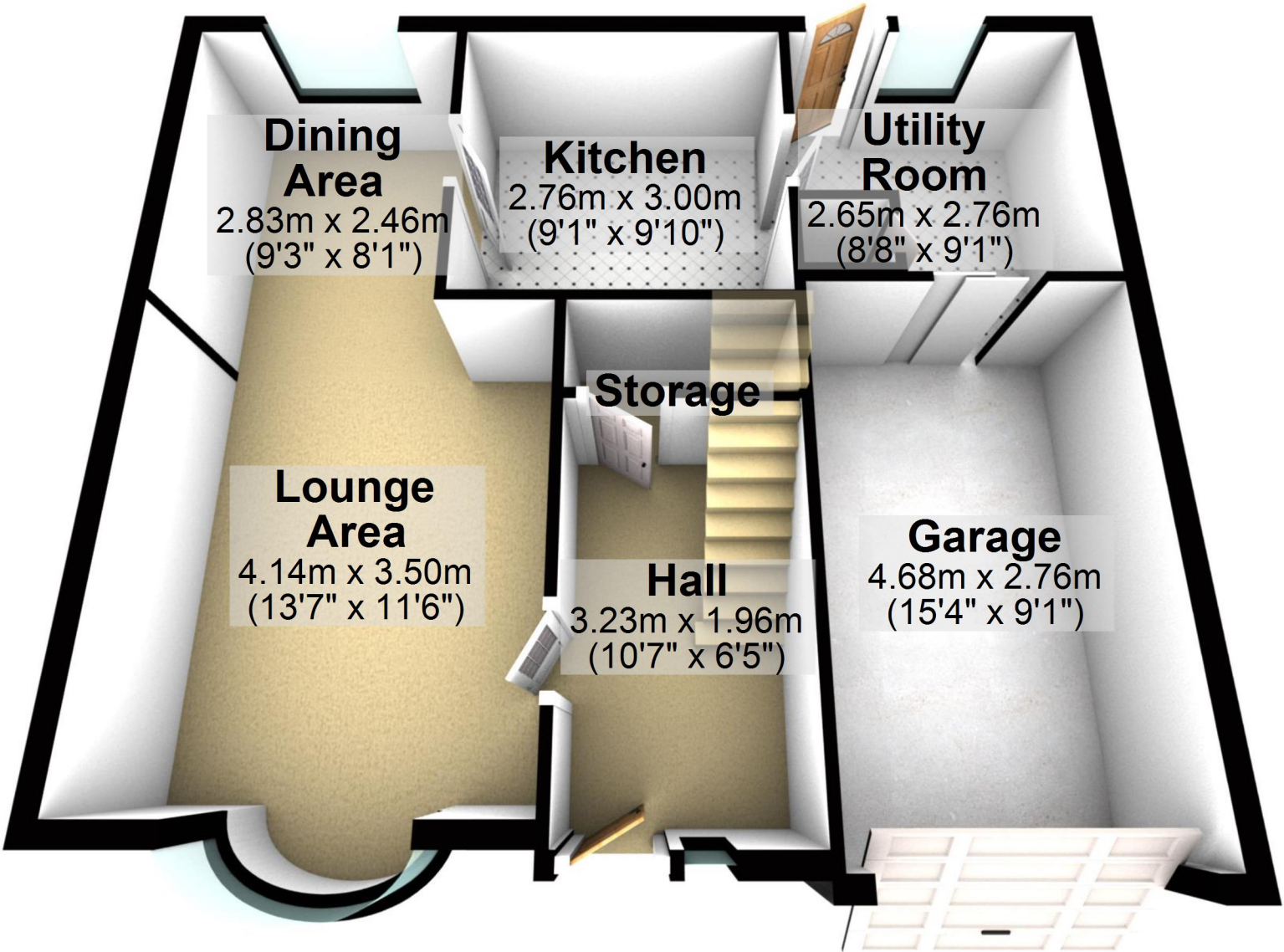

Total area: approx. 100.2 sq. metres (1078.5 sq. feet)

For illustrative purposes only. Not to scale. All sizes are approximate.

Plan produced using PlanUp.

# First Floor

Approx. 39.4 sq. metres (423.7 sq. feet)

**Bedroom 2**  
3.24m x 3.02m  
(10'7" x 9'11")

**Bathroom**  
1.88m x 2.44m  
(6'2" x 8')

**Landing**  
2.38m x 2.44m  
(7'10" x 8')

**Bedroom 1**  
3.65m x 3.02m  
(12' x 9'11")

**Bedroom 3**  
2.62m x 2.51m  
(8'7" x 8'3")

