

# Ground Floor

Approx. 119.2 sq. metres (1283.2 sq. feet)

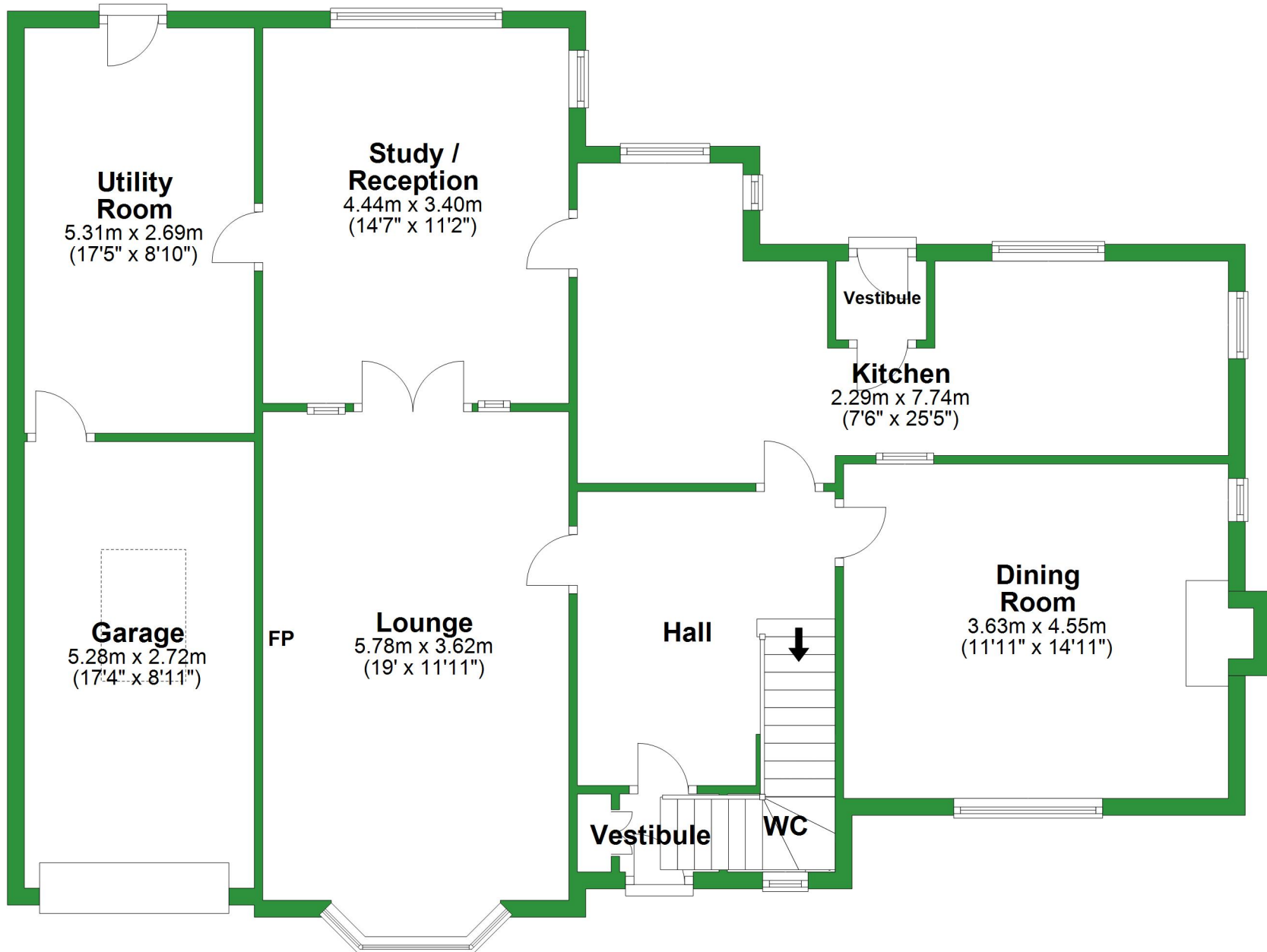

Total area: approx. 193.4 sq. metres (2081.2 sq. feet)

For illustrative purposes only. Not to scale. All sizes are approximate.  
Plan produced using PlanUp.

## First Floor

Approx. 74.1 sq. metres (798.0 sq. feet)

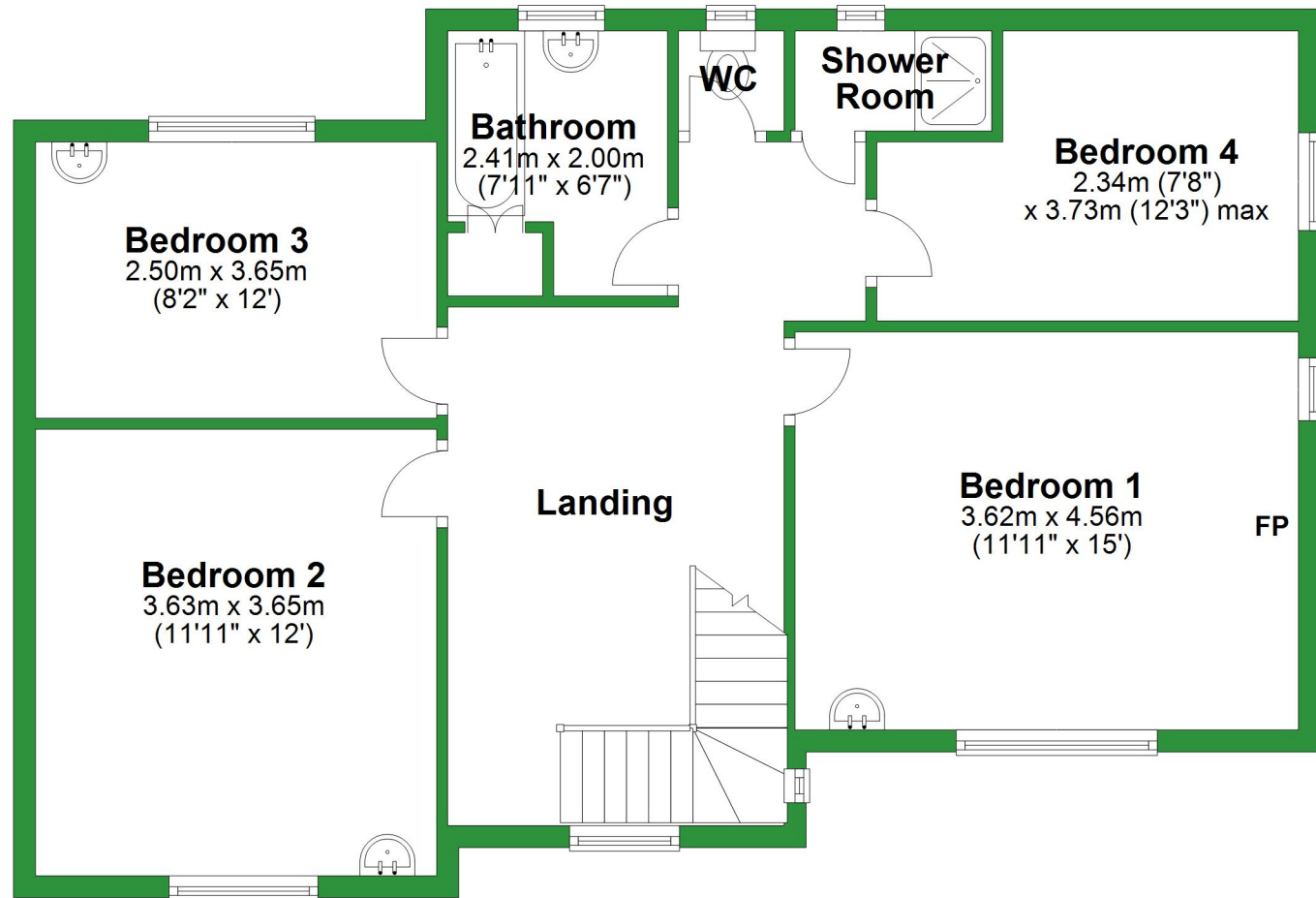

## Ground Floor

Approx. 119.2 sq. metres (1283.2 sq. feet)

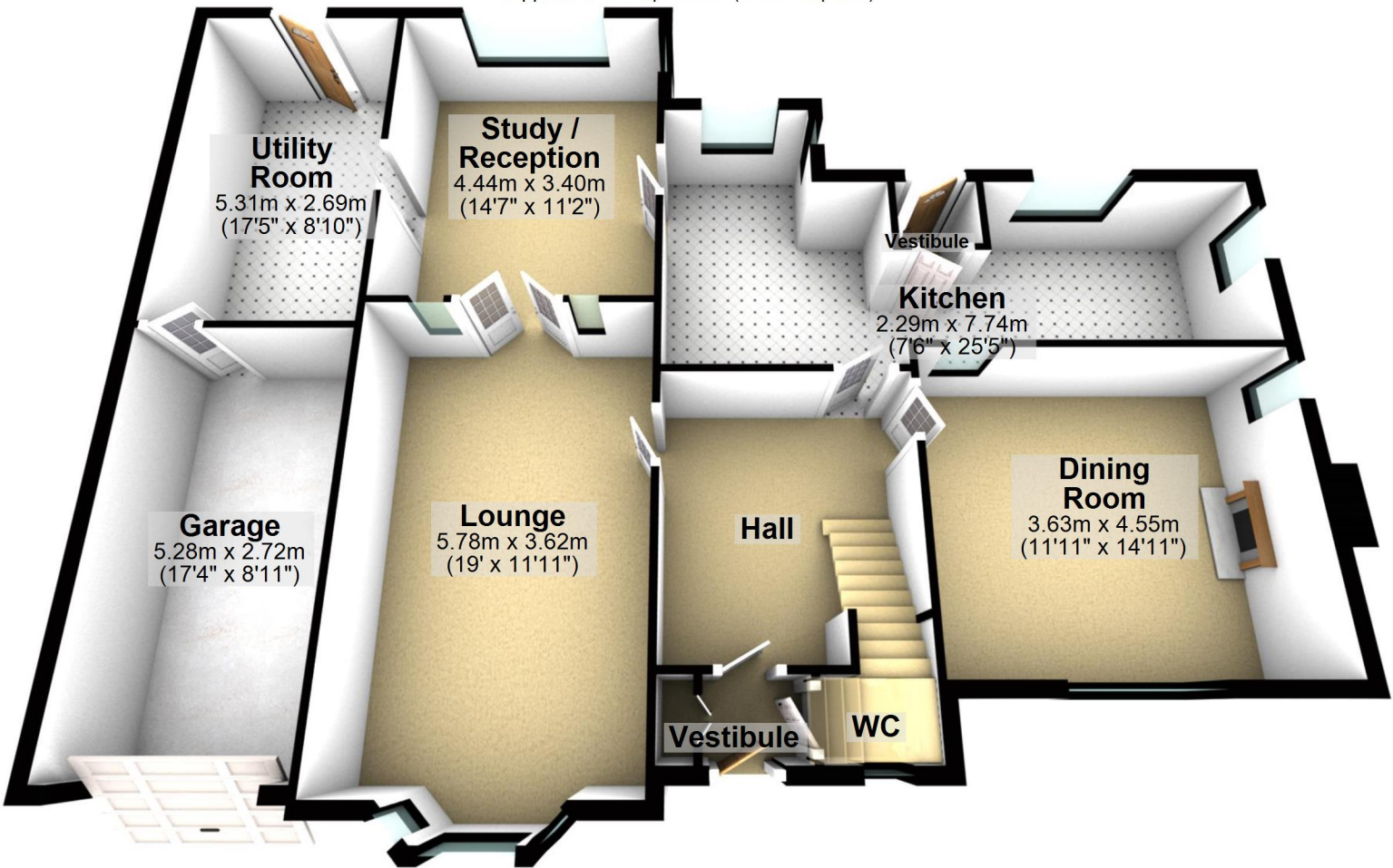

Total area: approx. 193.4 sq. metres (2081.2 sq. feet)

For illustrative purposes only. Not to scale. All sizes are approximate.  
Plan produced using PlanUp.

## First Floor

Approx. 74.1 sq. metres (798.0 sq. feet)

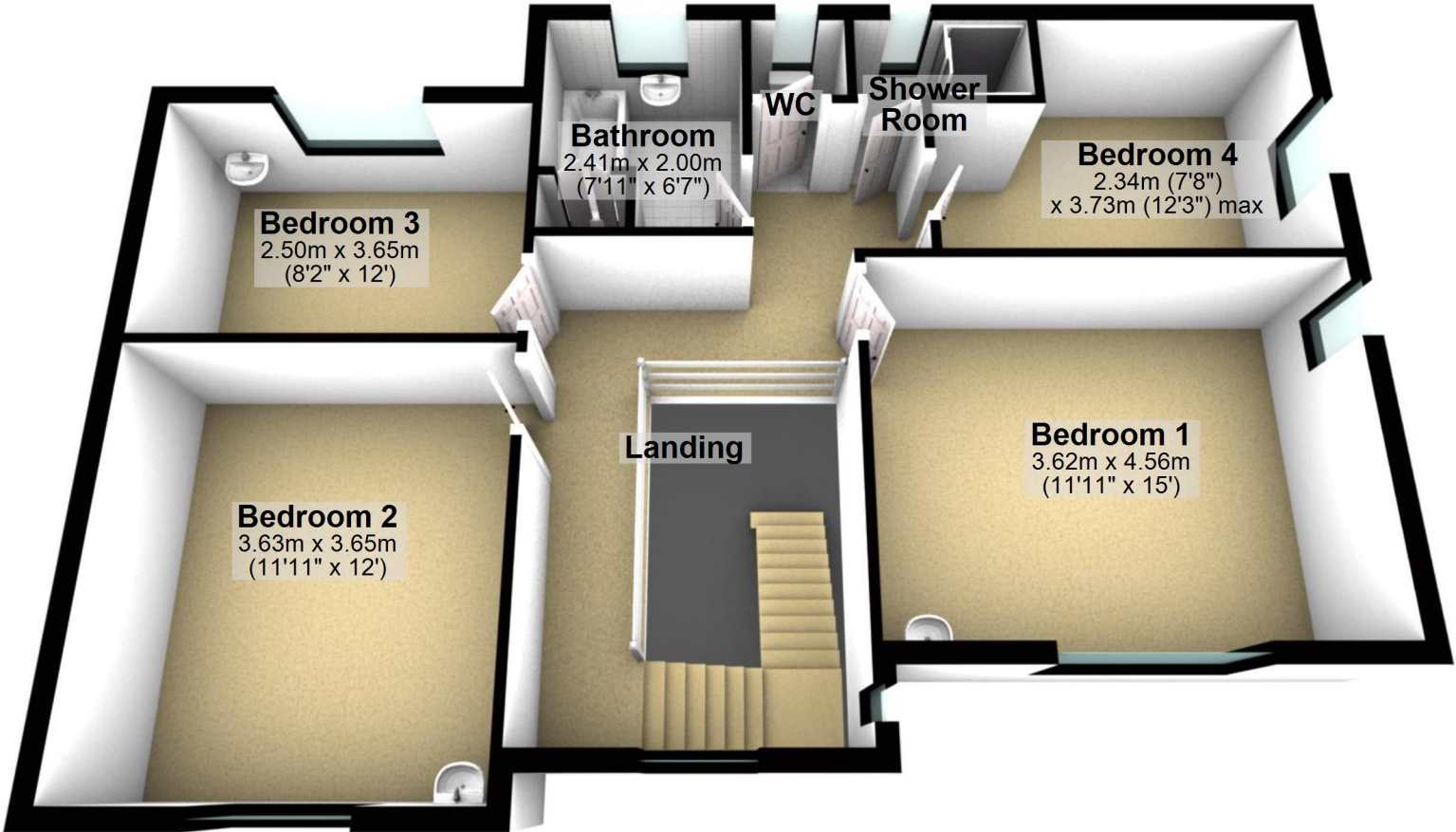

**Bedroom 3**  
2.50m x 3.65m  
(8'2" x 12')

**Bathroom**  
2.41m x 2.00m  
(7'11" x 6'7")

**WC**

**Shower Room**

**Bedroom 4**  
2.34m (7'8")  
x 3.73m (12'3") max

**Bedroom 2**  
3.63m x 3.65m  
(11'11" x 12')

**Landing**

**Bedroom 1**  
3.62m x 4.56m  
(11'11" x 15')