

First Floor

Approx. 41.2 sq. metres (443.2 sq. feet)

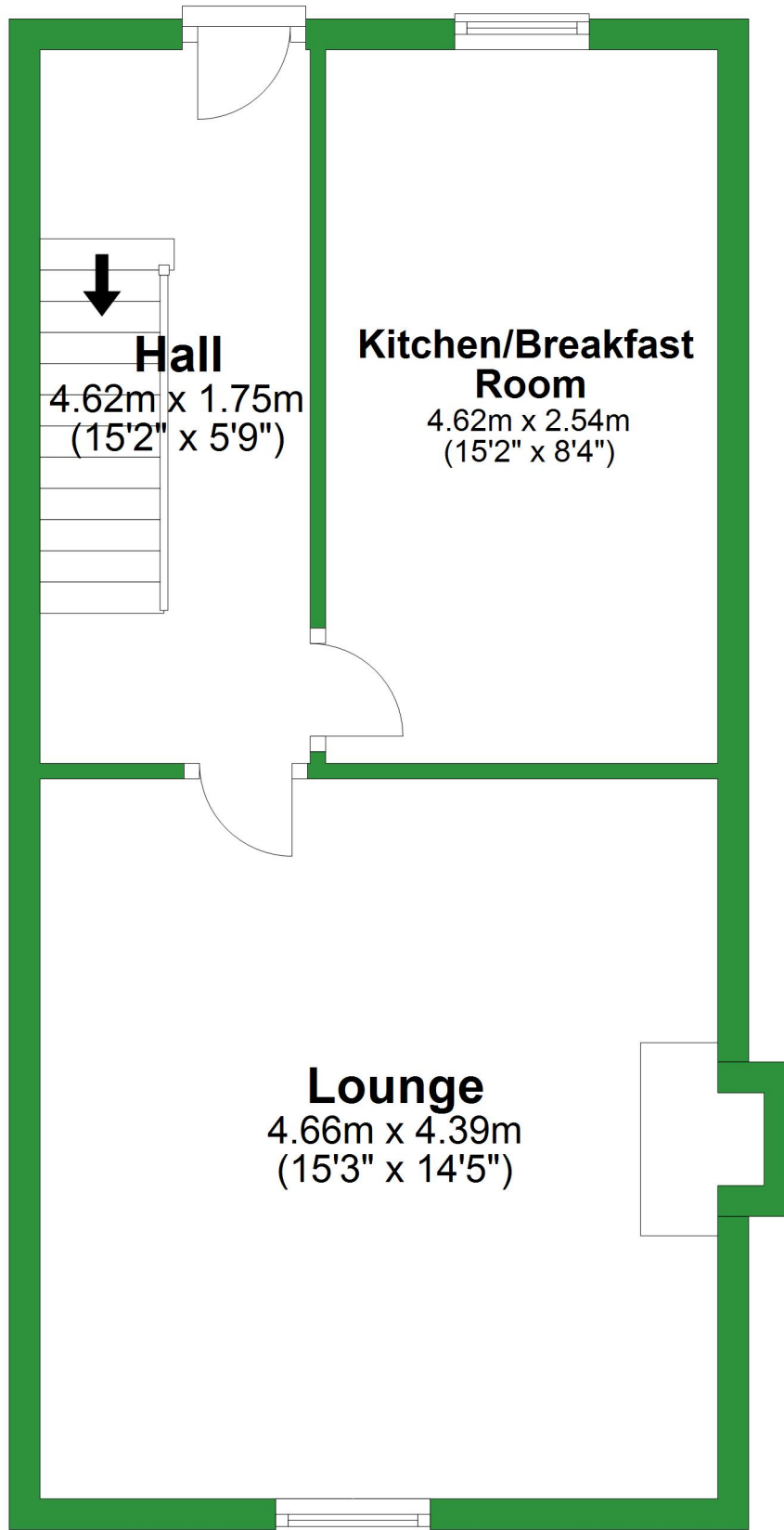

Total area: approx. 82.4 sq. metres (886.5 sq. feet)

For illustrative purposes only. Not to scale. All sizes are approximate.
Plan produced using PlanUp.

Second Floor

Approx. 41.2 sq. metres (443.2 sq. feet)

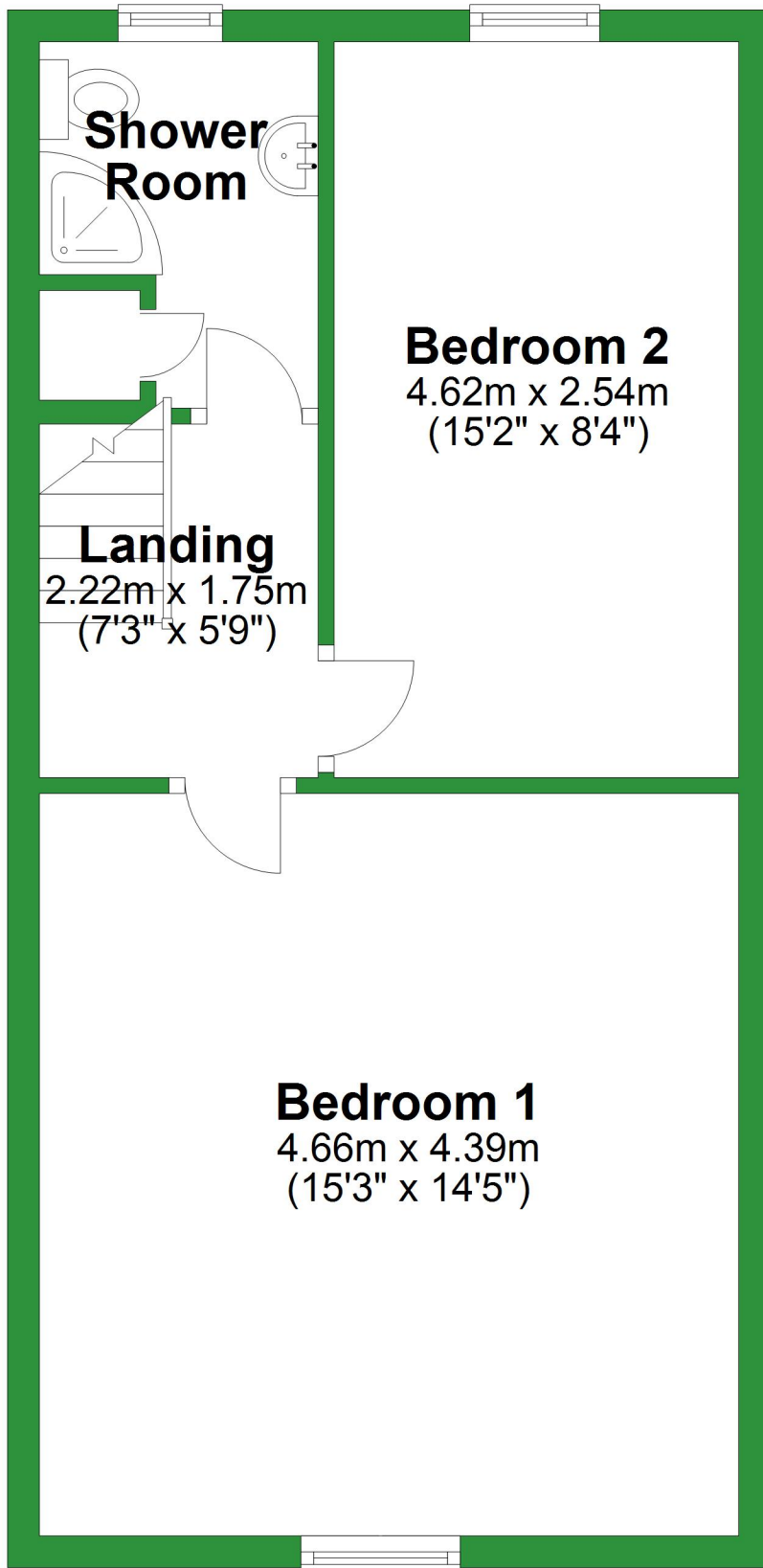

First Floor

Approx. 41.2 sq. metres (443.2 sq. feet)

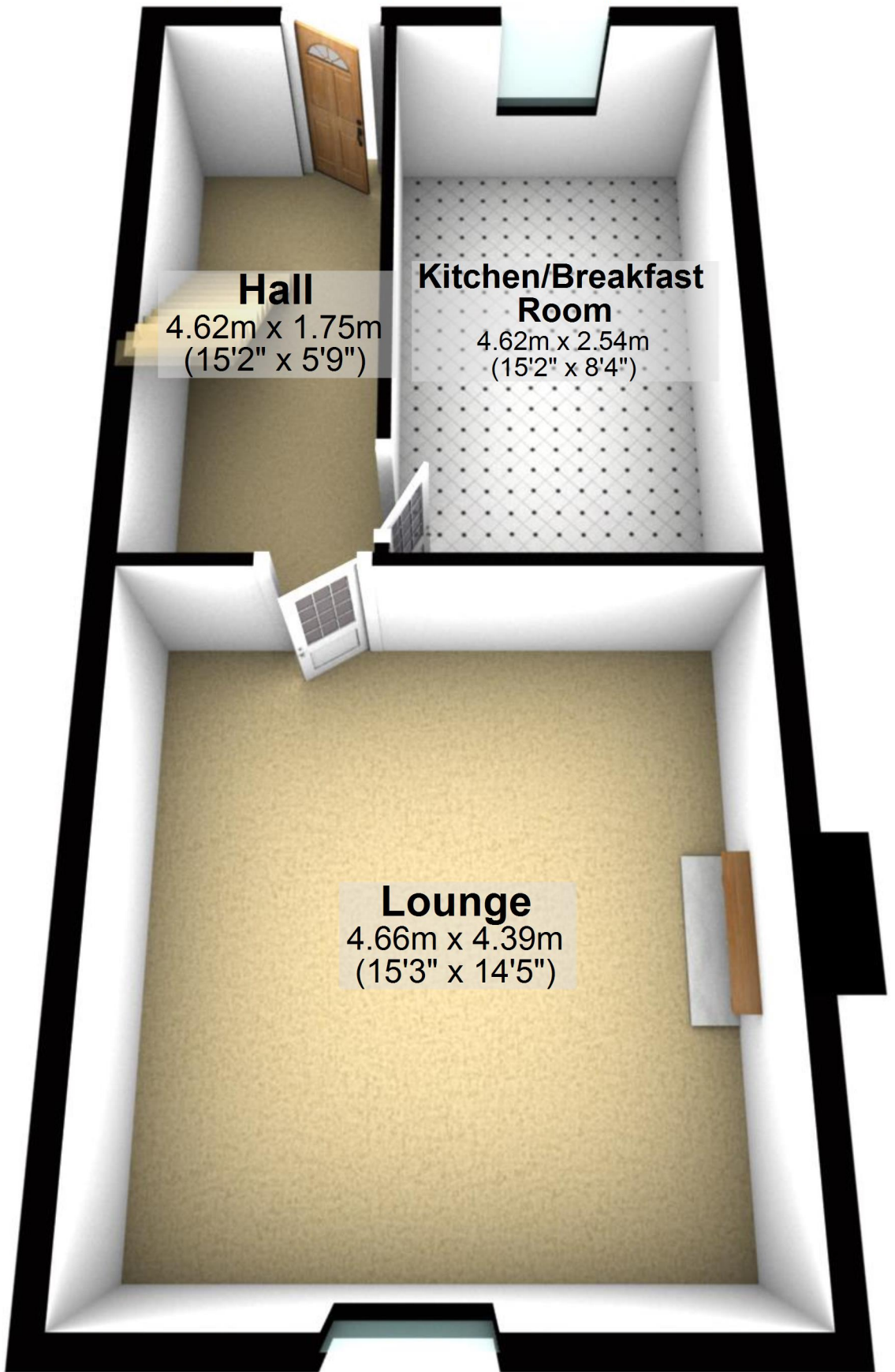

Hall

4.62m x 1.75m
(15'2" x 5'9")

Kitchen/Breakfast Room

4.62m x 2.54m
(15'2" x 8'4")

Lounge

4.66m x 4.39m
(15'3" x 14'5")

Total area: approx. 82.4 sq. metres (886.5 sq. feet)

For illustrative purposes only. Not to scale. All sizes are approximate.

Plan produced using PlanUp.

Second Floor

Approx. 41.2 sq. metres (443.2 sq. feet)



Shower Room

Bedroom 2
4.62m x 2.54m
(15'2" x 8'4")

Landing
2.22m x 1.75m
(7'3" x 5'9")

Bedroom 1
4.66m x 4.39m
(15'3" x 14'5")