

# Ground Floor

Approx. 63.0 sq. metres (678.3 sq. feet)

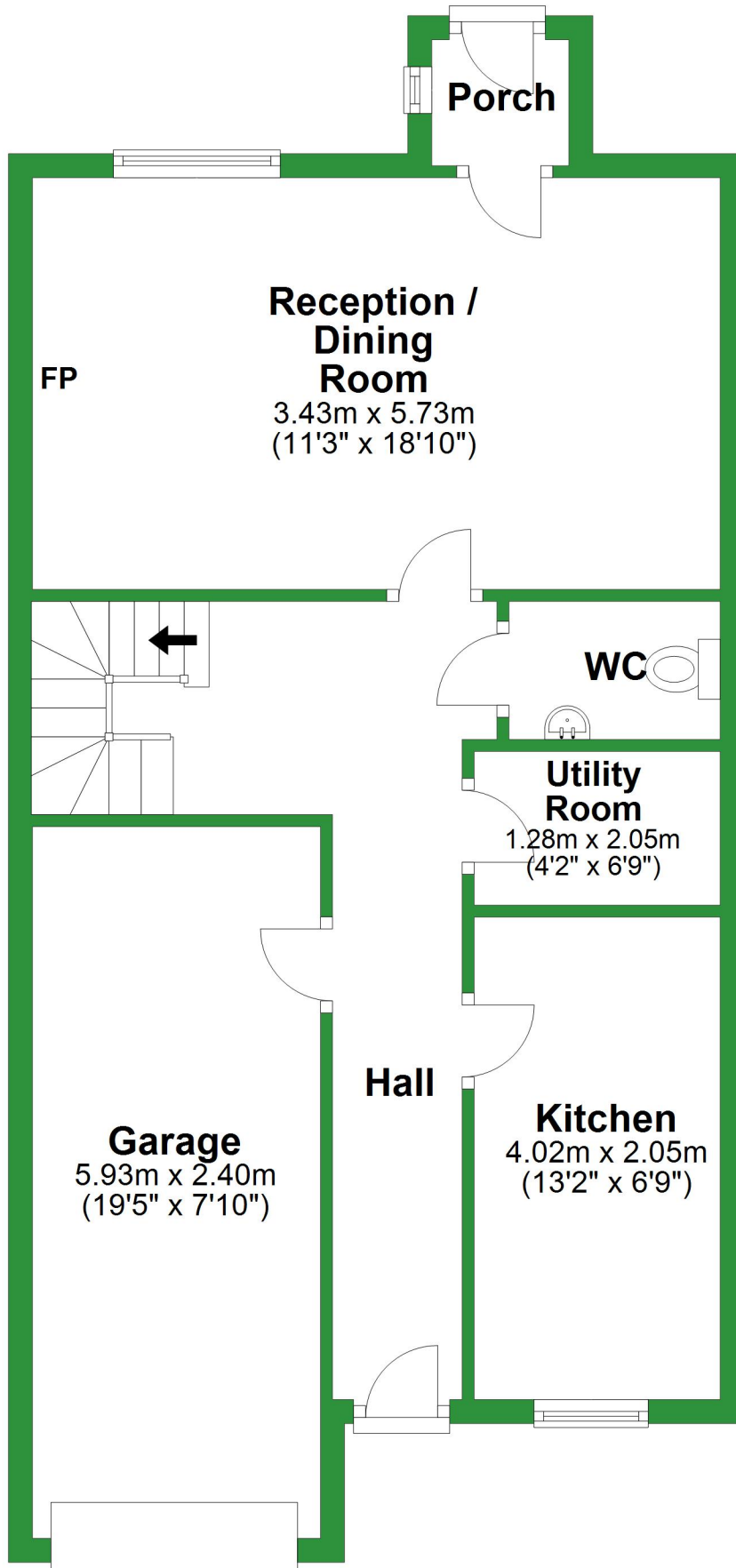

Total area: approx. 179.9 sq. metres (1936.7 sq. feet)

For illustrative purposes only. Not to scale. All sizes are approximate.  
Plan produced using PlanUp.

# First Floor

Approx. 58.3 sq. metres (627.8 sq. feet)

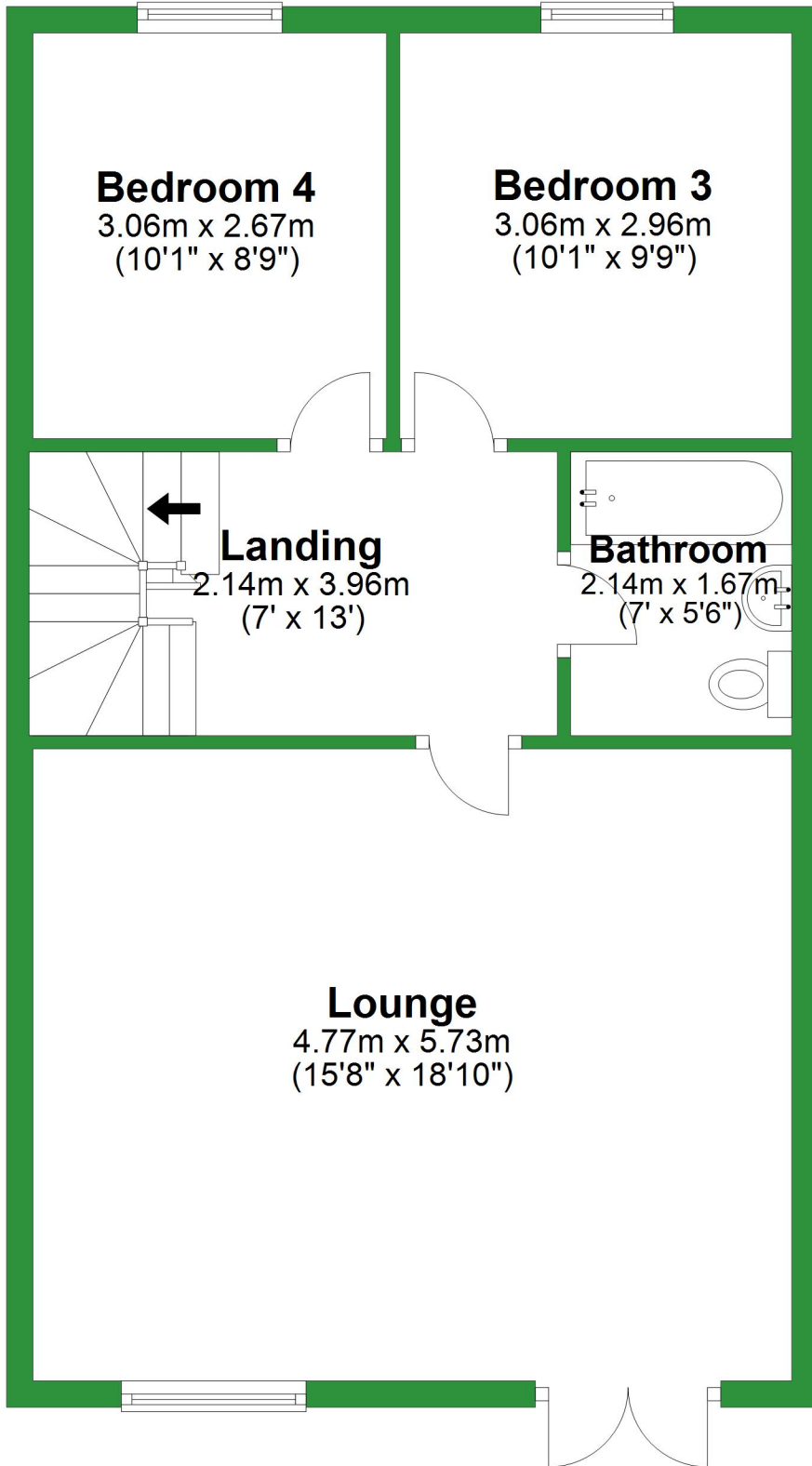

# Second Floor

Approx. 58.6 sq. metres (630.6 sq. feet)

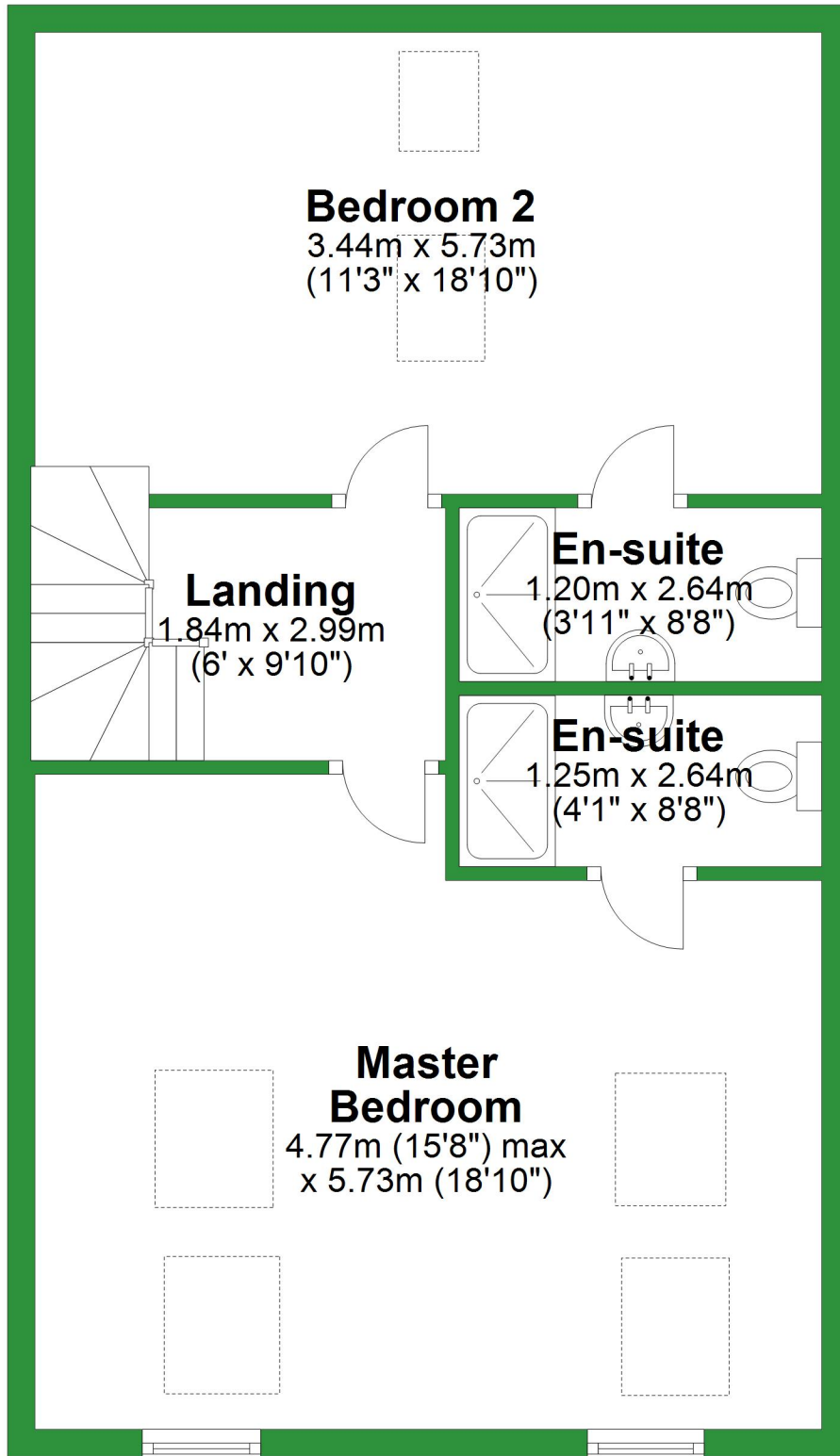

# Ground Floor

Approx. 63.0 sq. metres (678.3 sq. feet)

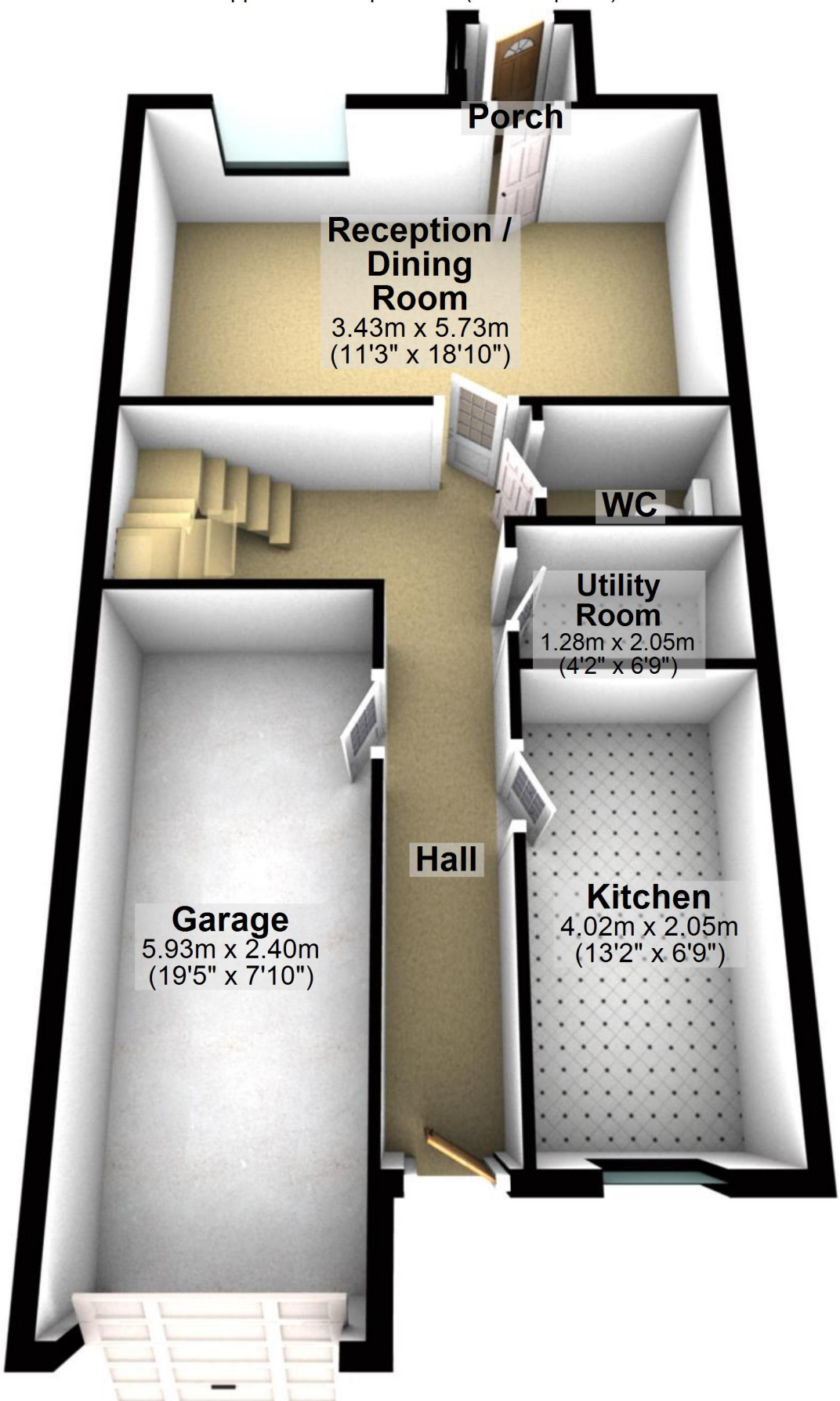

Total area: approx. 179.9 sq. metres (1936.7 sq. feet)

For illustrative purposes only. Not to scale. All sizes are approximate.

Plan produced using PlanUp.

# First Floor

Approx. 58.3 sq. metres (627.8 sq. feet)

## Bedroom 4

3.06m x 2.67m  
(10'1" x 8'9")

## Bedroom 3

3.06m x 2.96m  
(10'1" x 9'9")

## Landing

2.14m x 3.96m  
(7' x 13')

## Bathroom

2.14m x 1.67m  
(7' x 5'6")

## Lounge

4.77m x 5.73m  
(15'8" x 18'10")

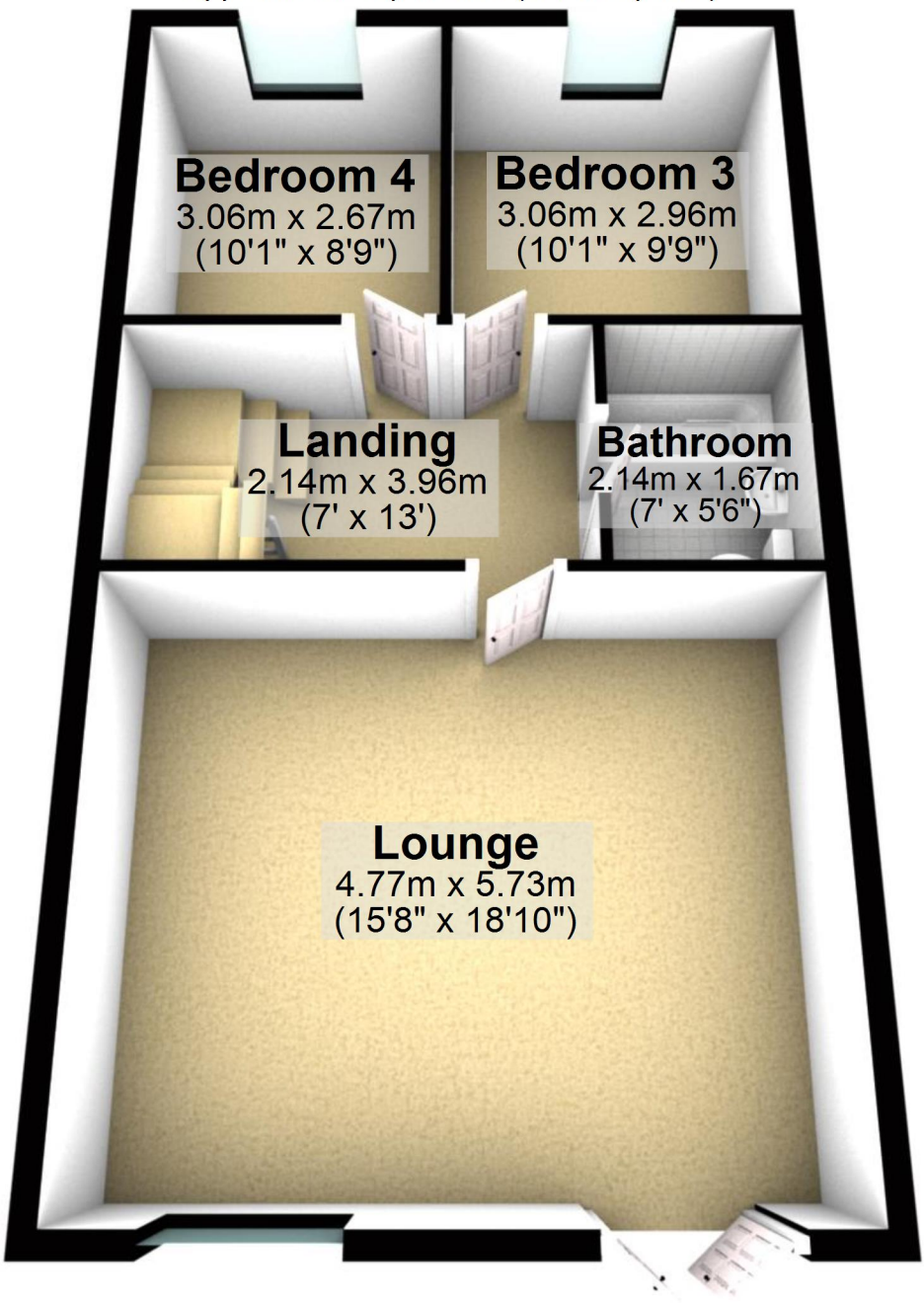



## Second Floor

Approx. 58.6 sq. metres (630.6 sq. feet)

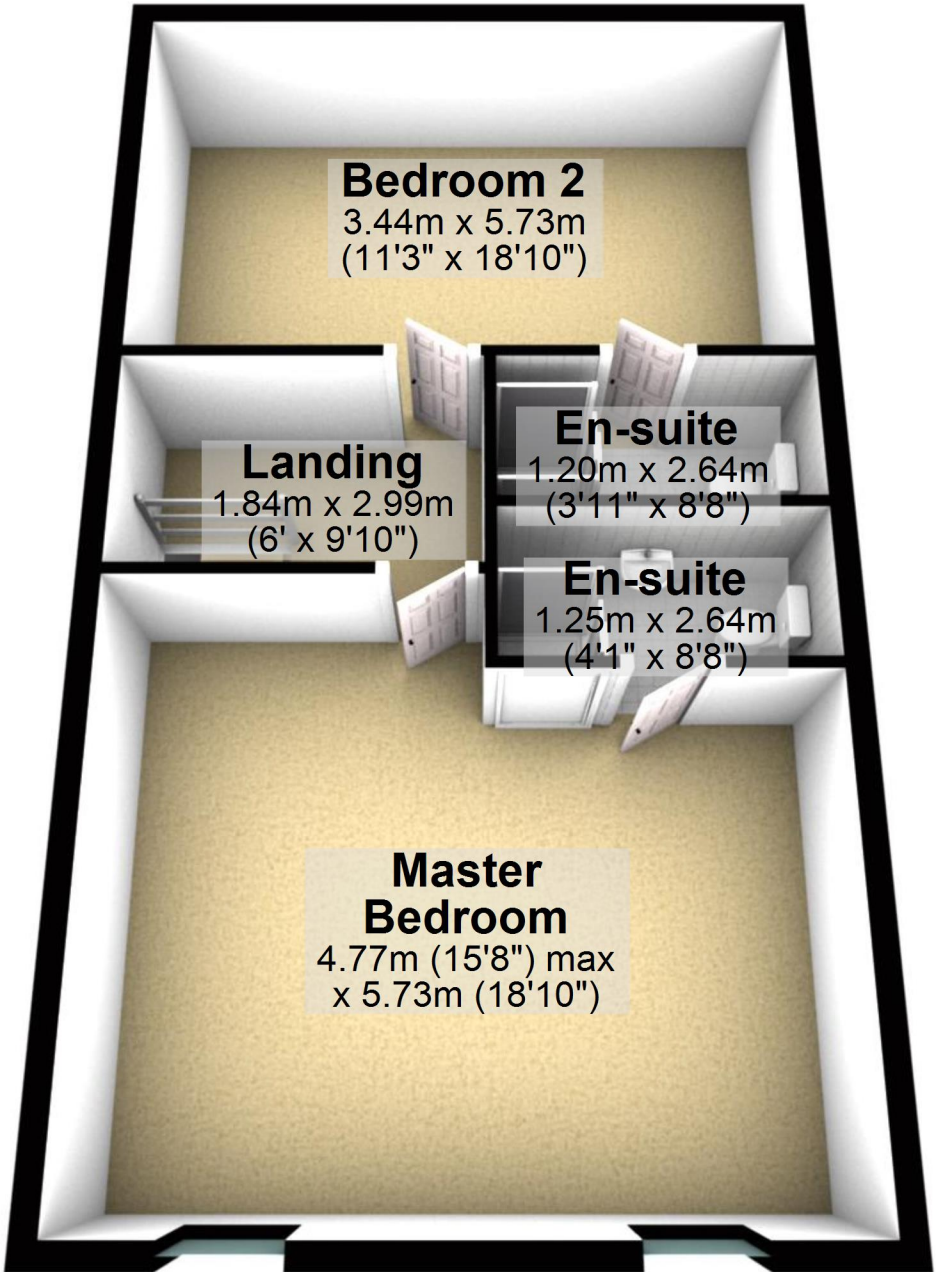

### Bedroom 2

3.44m x 5.73m  
(11'3" x 18'10")

### Landing

1.84m x 2.99m  
(6' x 9'10")

### En-suite

1.20m x 2.64m  
(3'11" x 8'8")

### En-suite

1.25m x 2.64m  
(4'1" x 8'8")

### Master Bedroom

4.77m (15'8") max  
x 5.73m (18'10")