

# Ground Floor

Approx. 47.5 sq. metres (511.3 sq. feet)

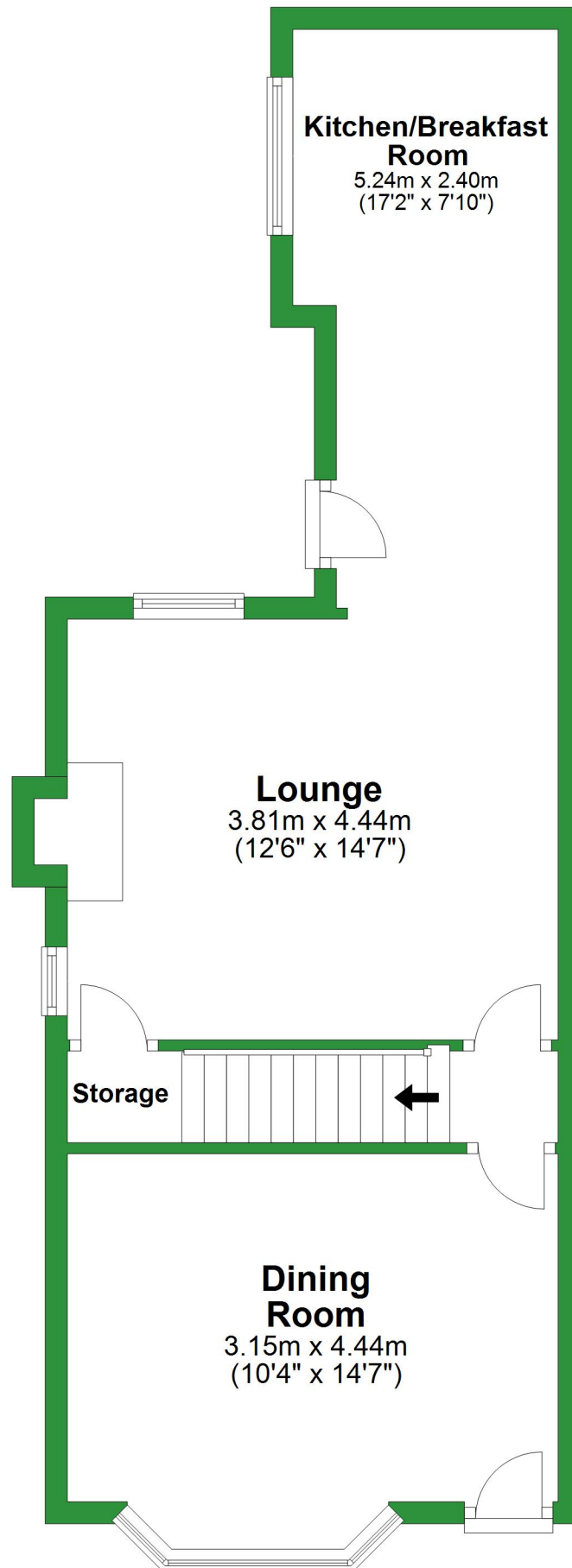

Total area: approx. 95.4 sq. metres (1027.0 sq. feet)

For illustrative purposes only. Not to scale. All sizes are approximate.  
Plan produced using PlanUp.

## First Floor

Approx. 35.5 sq. metres (381.9 sq. feet)

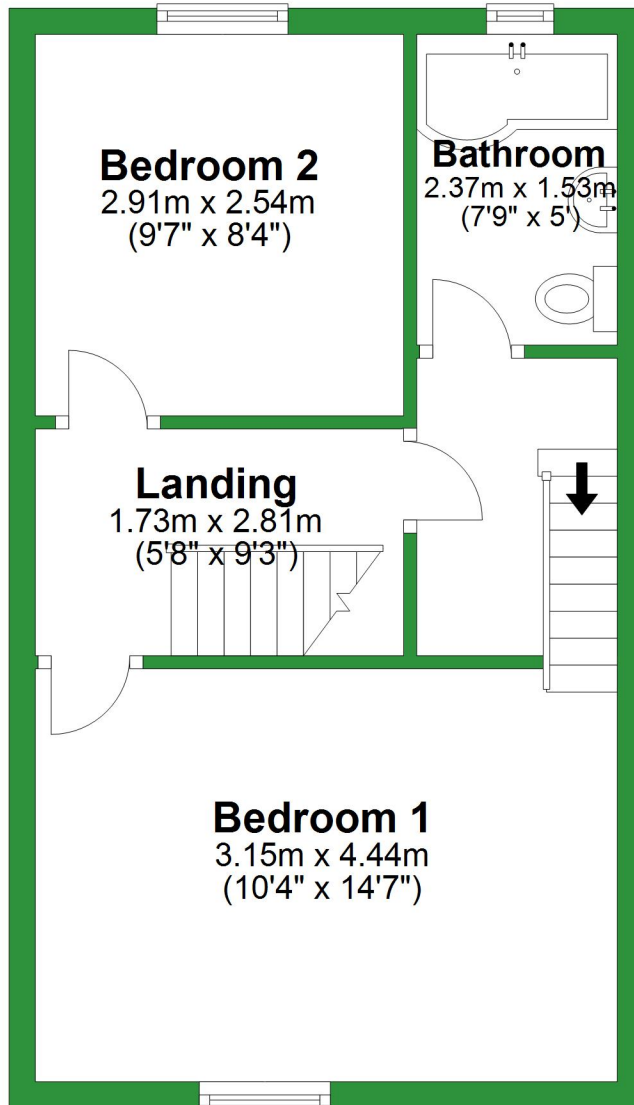

## Second Floor

Approx. 12.4 sq. metres (133.8 sq. feet)

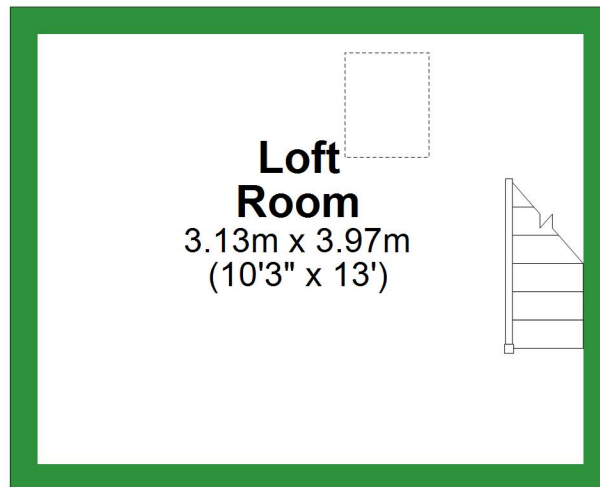

# Ground Floor

Approx. 47.5 sq. metres (511.3 sq. feet)

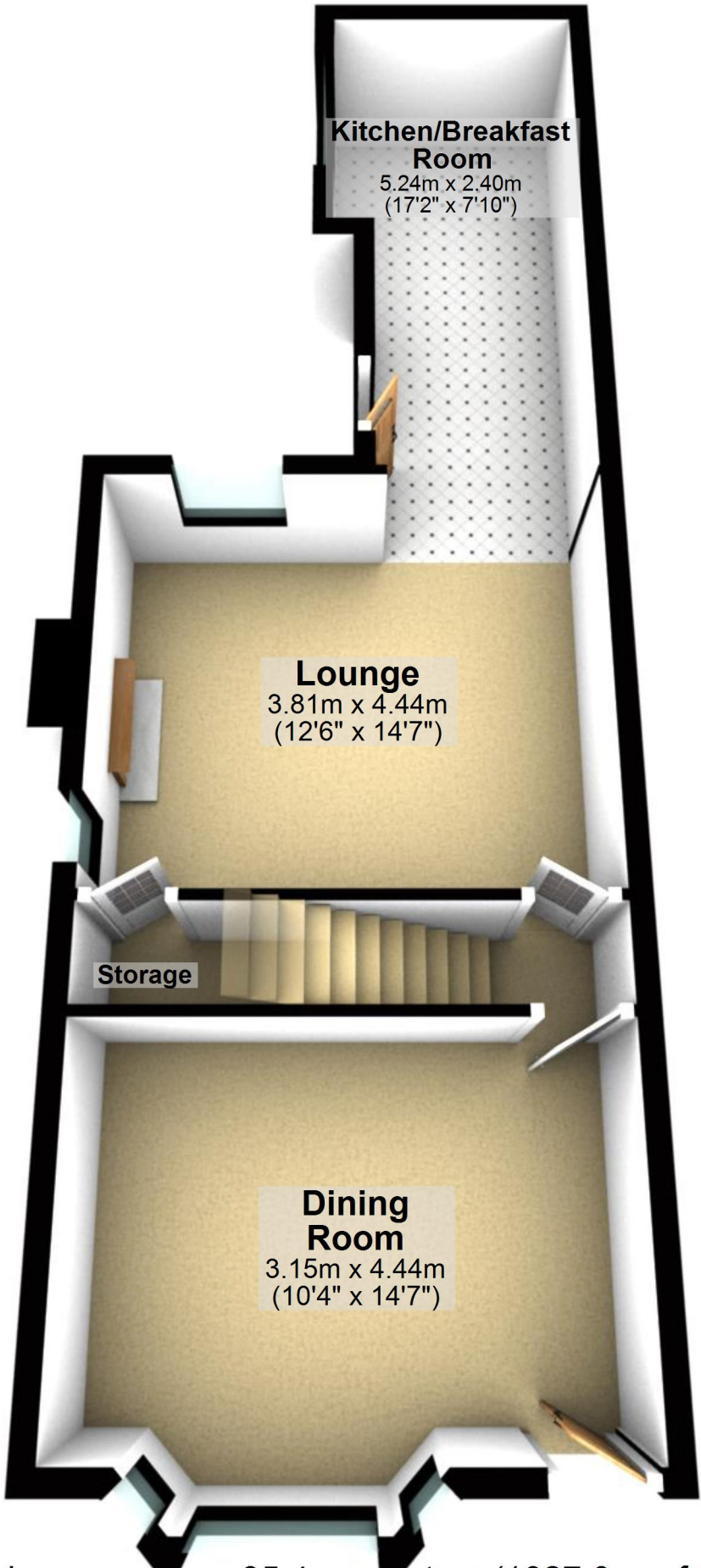

## Kitchen/Breakfast Room

5.24m x 2.40m  
(17'2" x 7'10")

## Lounge

3.81m x 4.44m  
(12'6" x 14'7")

Storage

## Dining Room

3.15m x 4.44m  
(10'4" x 14'7")

Total area: approx. 95.4 sq. metres (1027.0 sq. feet)

For illustrative purposes only. Not to scale. All sizes are approximate.

Plan produced using PlanUp.

## First Floor

Approx. 35.5 sq. metres (381.9 sq. feet)

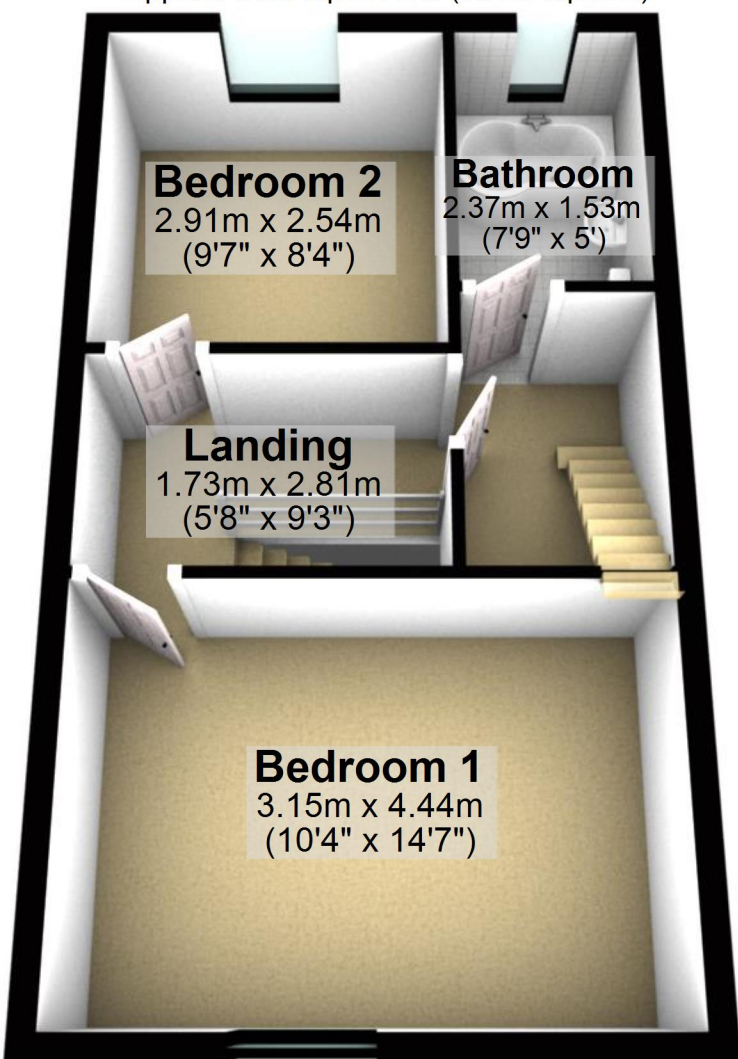

## Second Floor

Approx. 12.4 sq. metres (133.8 sq. feet)

### Loft Room

3.13m x 3.97m  
(10'3" x 13')

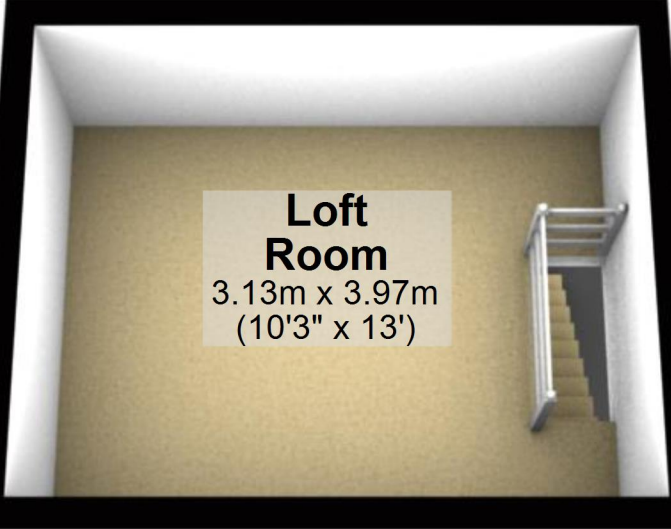
A 3D architectural rendering of a loft room. The room has a light-colored carpeted floor and white walls. A staircase with a white railing is visible on the right side, leading up from the room. The room is framed by a thick black border.