

# Ground Floor

Approx. 60.1 sq. metres (646.9 sq. feet)

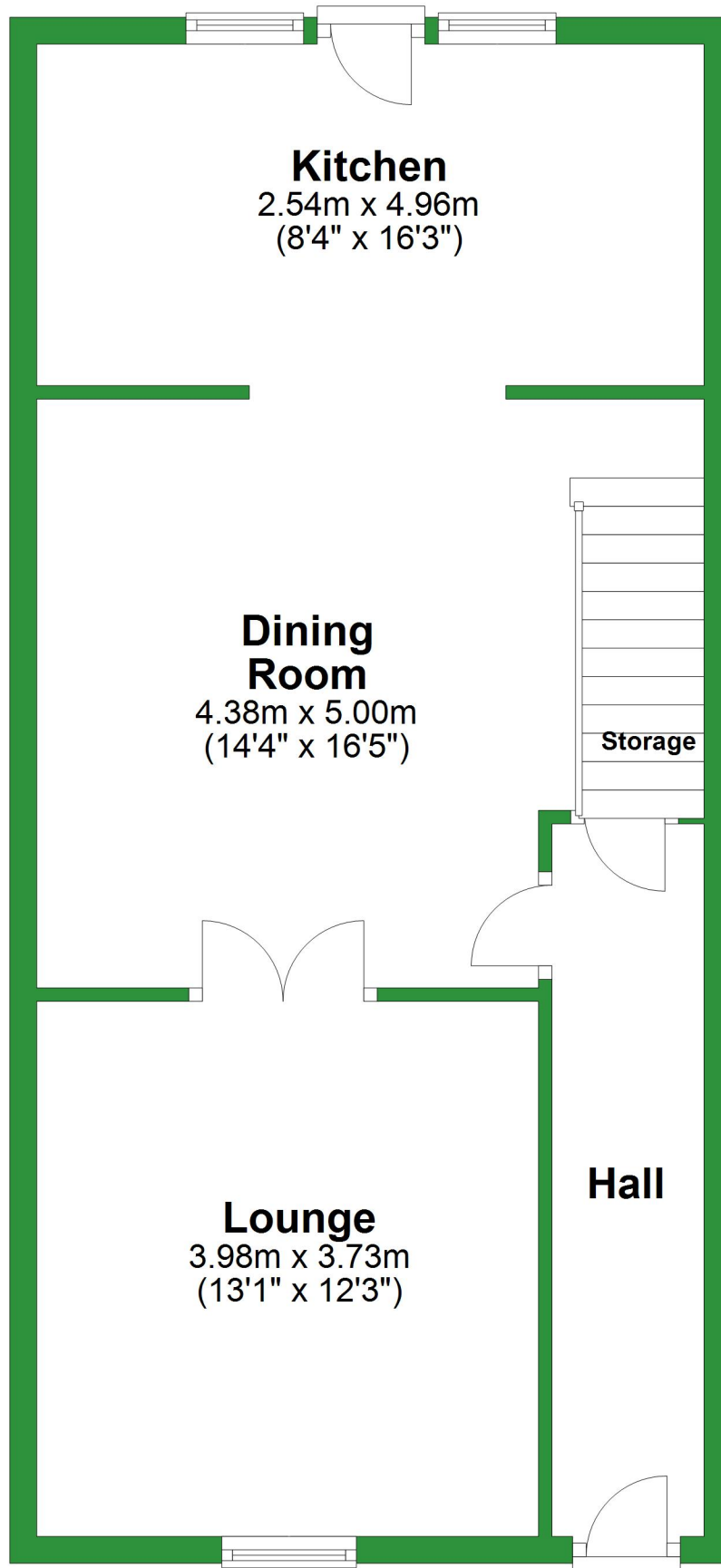

Total area: approx. 103.0 sq. metres (1108.6 sq. feet)

For illustrative purposes only. Not to scale. All sizes are approximate.  
Plan produced using PlanUp.

# First Floor

Approx. 42.9 sq. metres (461.6 sq. feet)

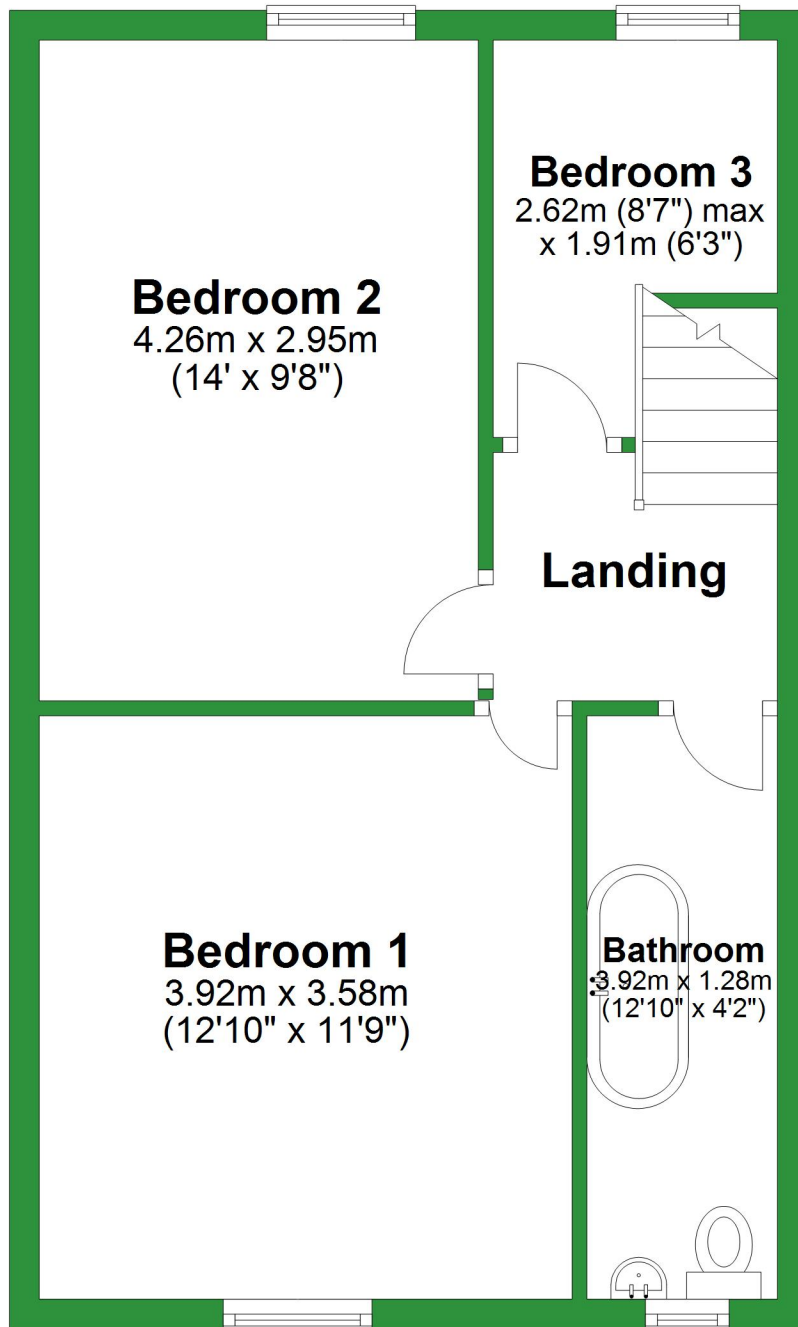

# Ground Floor

Approx. 60.1 sq. metres (646.9 sq. feet)

## Kitchen

2.54m x 4.96m  
(8'4" x 16'3")

## Dining Room

4.38m x 5.00m  
(14'4" x 16'5")

## Lounge

3.98m x 3.73m  
(13'1" x 12'3")

Storage

Hall

Total area: approx. 103.0 sq. metres (1108.6 sq. feet)

For illustrative purposes only. Not to scale. All sizes are approximate.

Plan produced using PlanUp.

# First Floor

Approx. 42.9 sq. metres (461.6 sq. feet)

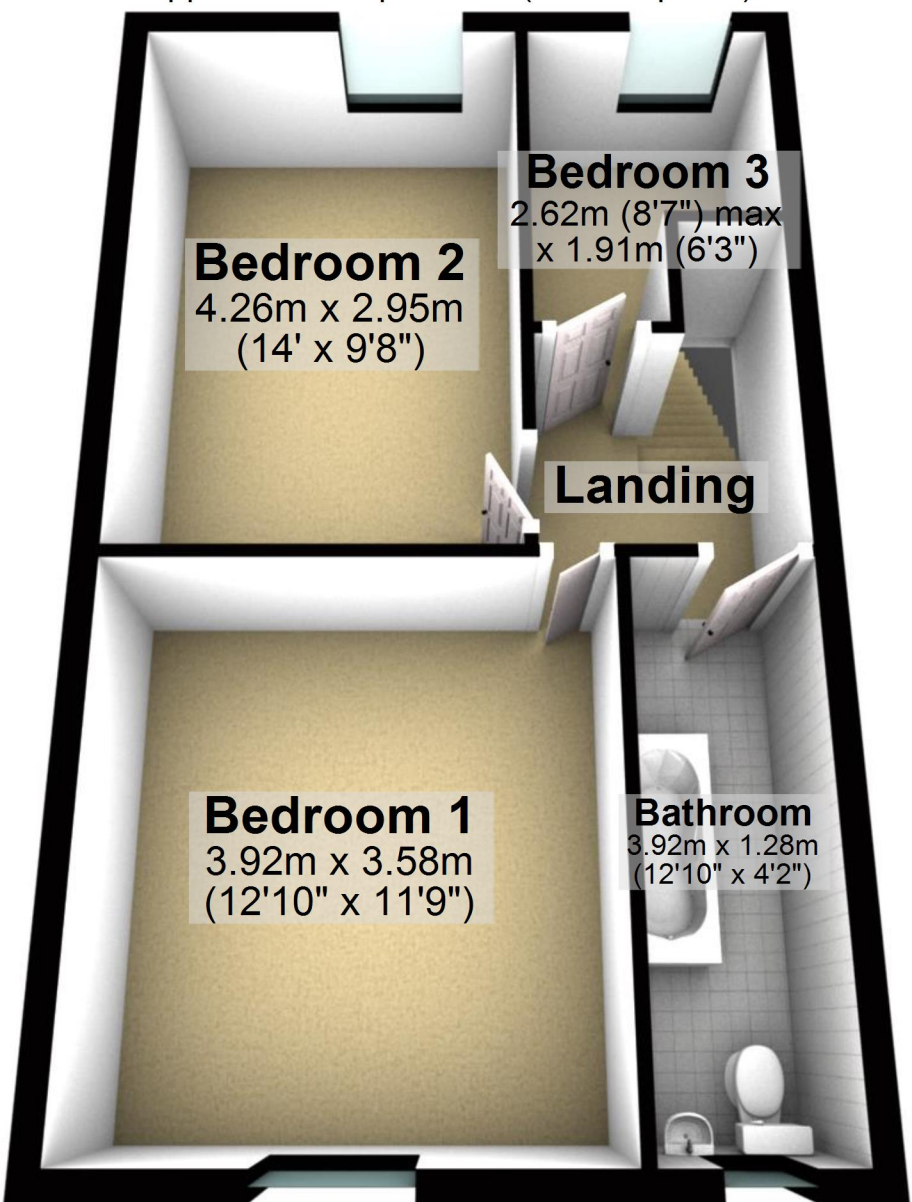

**Bedroom 2**  
4.26m x 2.95m  
(14' x 9'8")

**Bedroom 3**  
2.62m (8'7") max  
x 1.91m (6'3")

**Landing**

**Bedroom 1**  
3.92m x 3.58m  
(12'10" x 11'9")

**Bathroom**  
3.92m x 1.28m  
(12'10" x 4'2")