

# Ground Floor

Approx. 74.5 sq. metres (802.4 sq. feet)

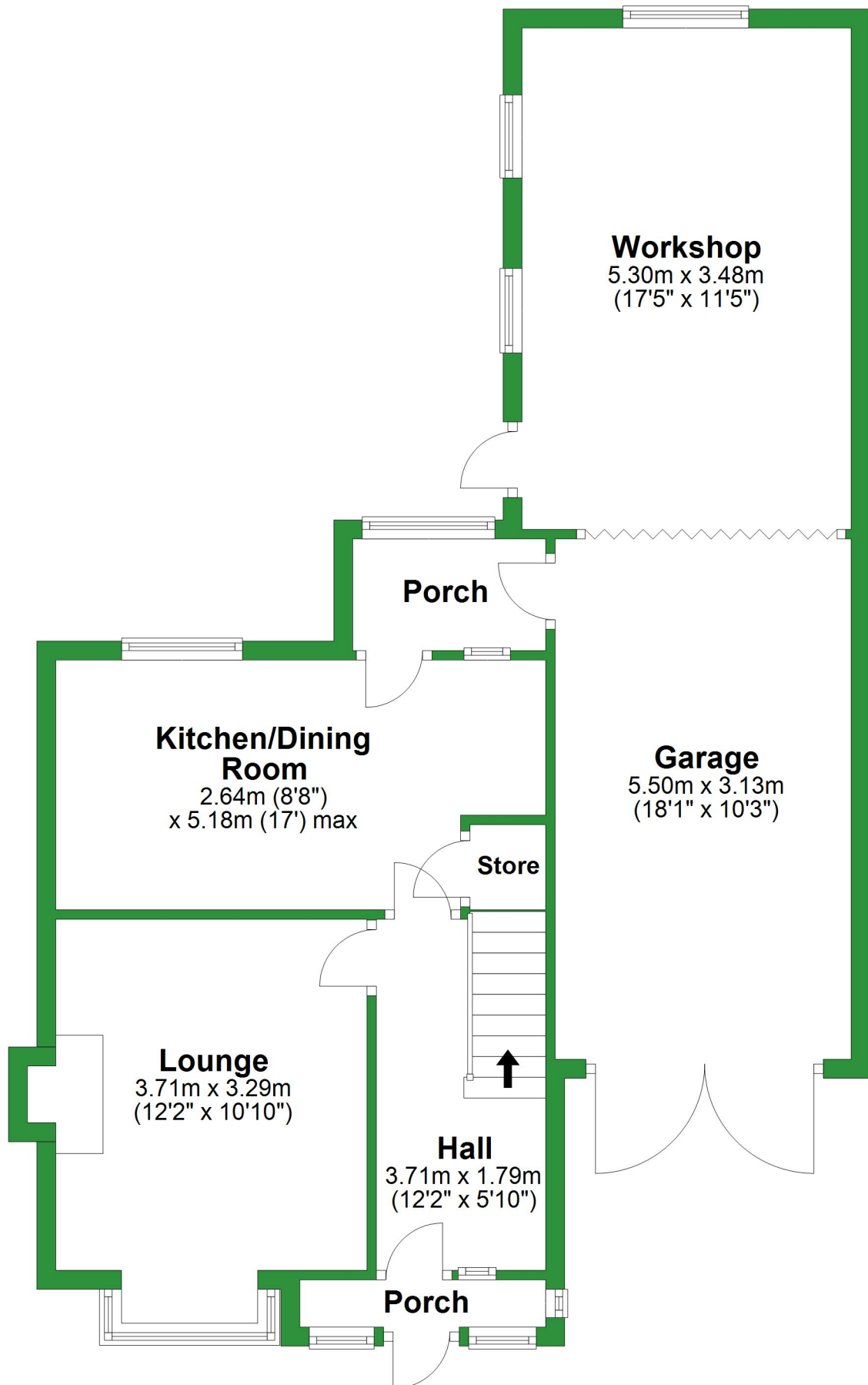

Total area: approx. 108.2 sq. metres (1164.1 sq. feet)

For illustrative purposes only. Not to scale. All sizes are approximate.  
Plan produced using PlanUp.

## First Floor

Approx. 33.6 sq. metres (361.8 sq. feet)

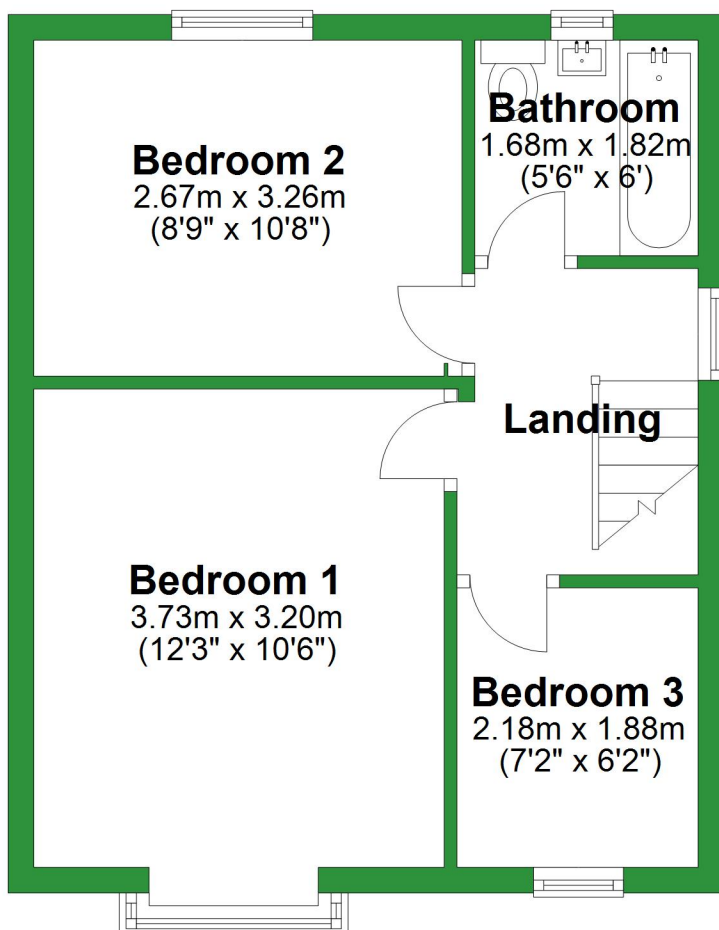

## Ground Floor

Approx. 74.5 sq. metres (802.4 sq. feet)

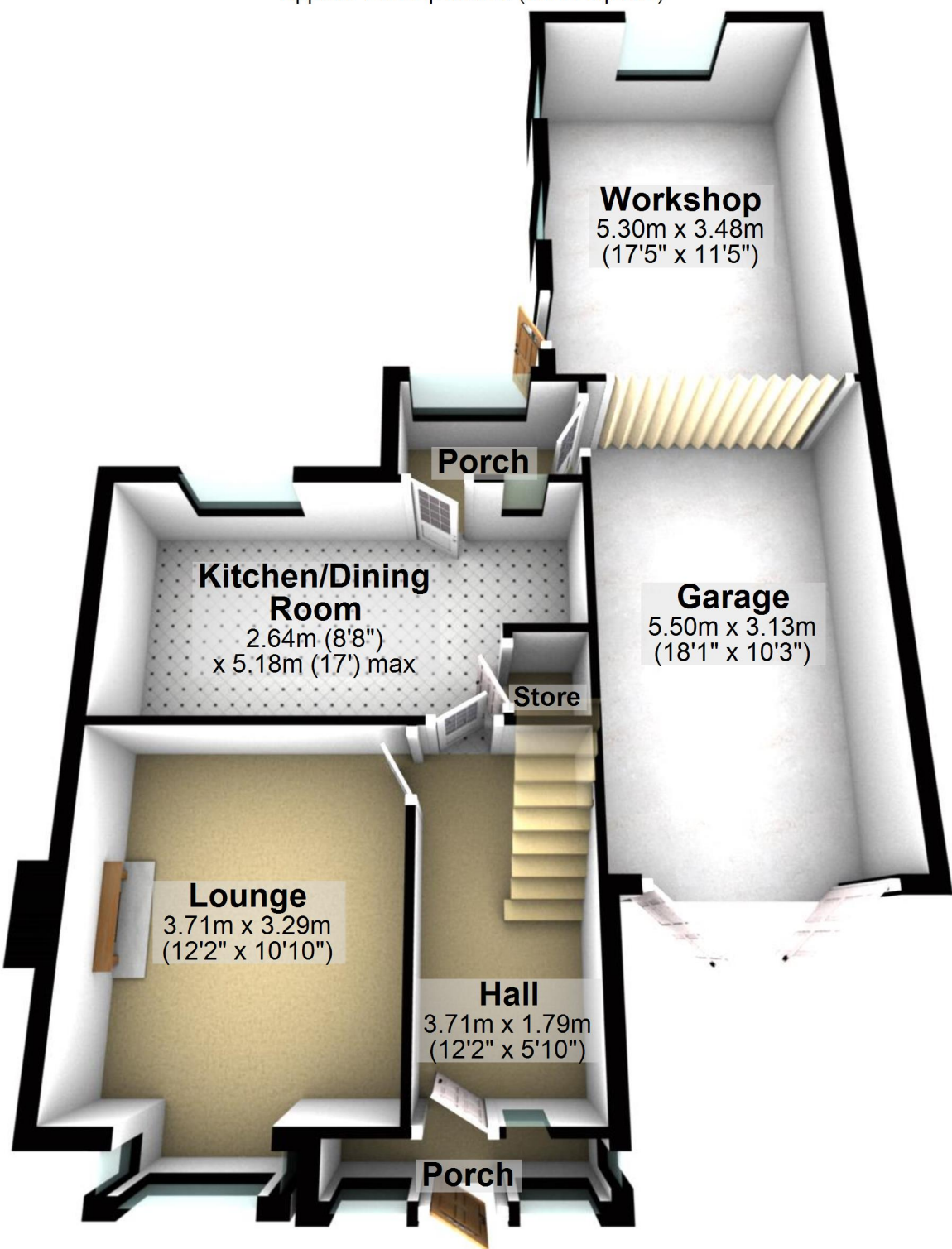

Total area: approx. 108.2 sq. metres (1164.1 sq. feet)

For illustrative purposes only. Not to scale. All sizes are approximate.  
Plan produced using PlanUp.

## First Floor

Approx. 33.6 sq. metres (361.8 sq. feet)

