

# Ground Floor

Approx. 104.5 sq. metres (1124.9 sq. feet)

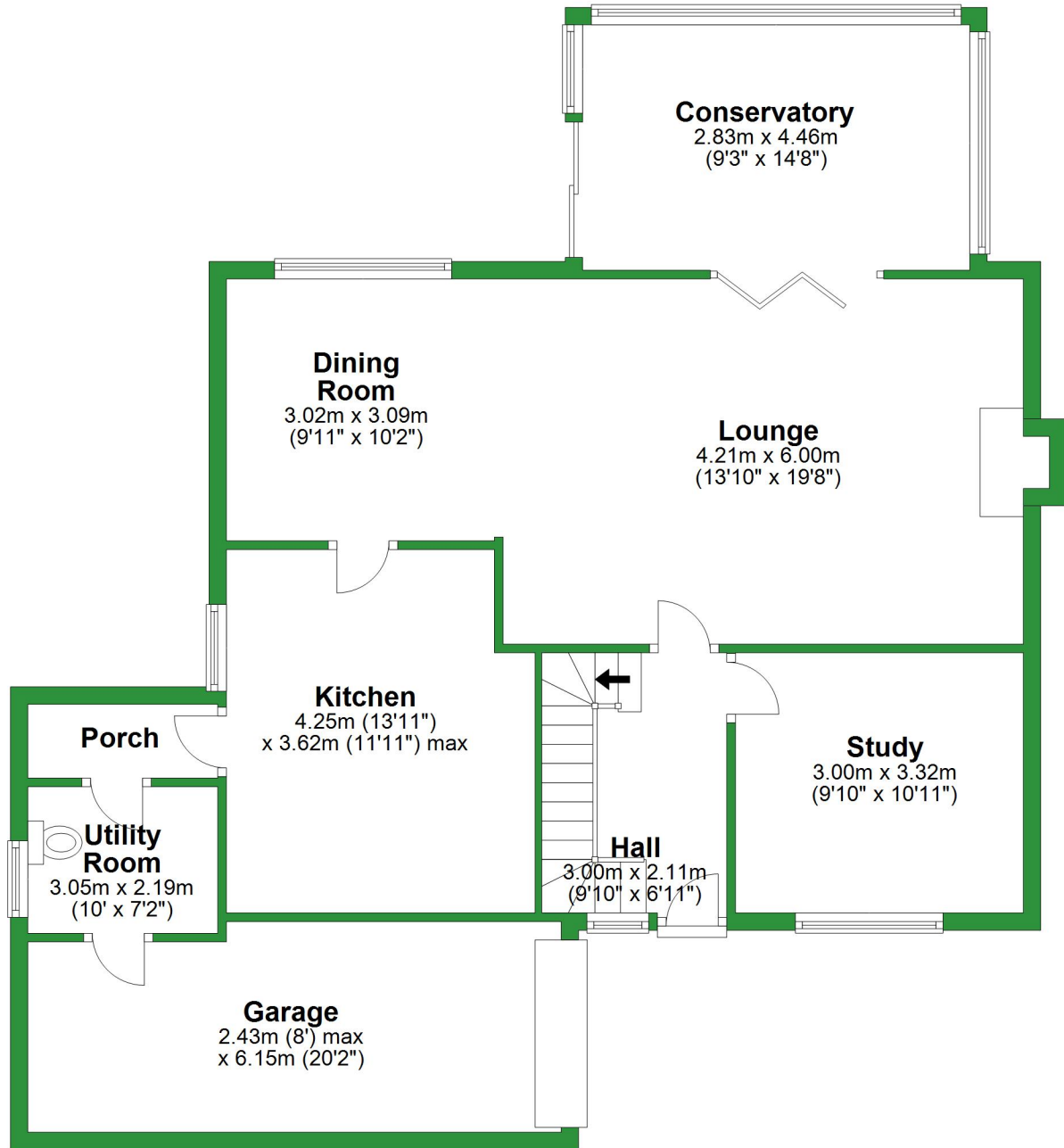

Total area: approx. 171.5 sq. metres (1846.0 sq. feet)

For illustrative purposes only. Not to scale. All sizes are approximate.  
Plan produced using PlanUp.

## First Floor

Approx. 67.0 sq. metres (721.1 sq. feet)

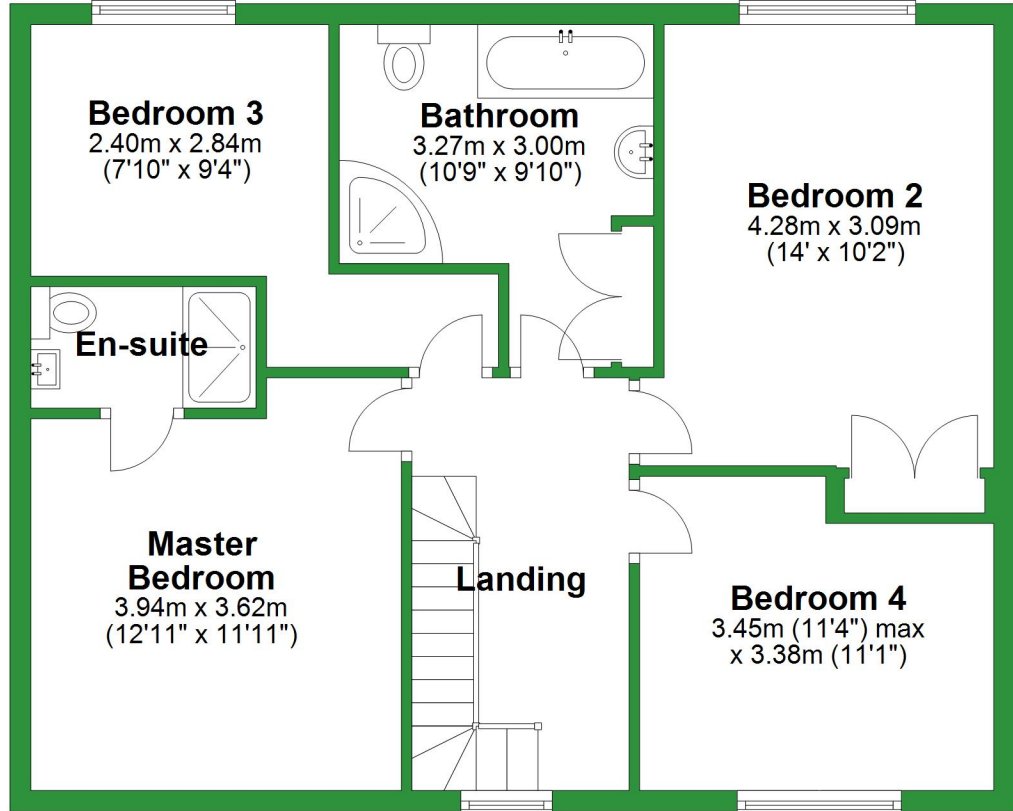

# Ground Floor

Approx. 104.5 sq. metres (1124.9 sq. feet)

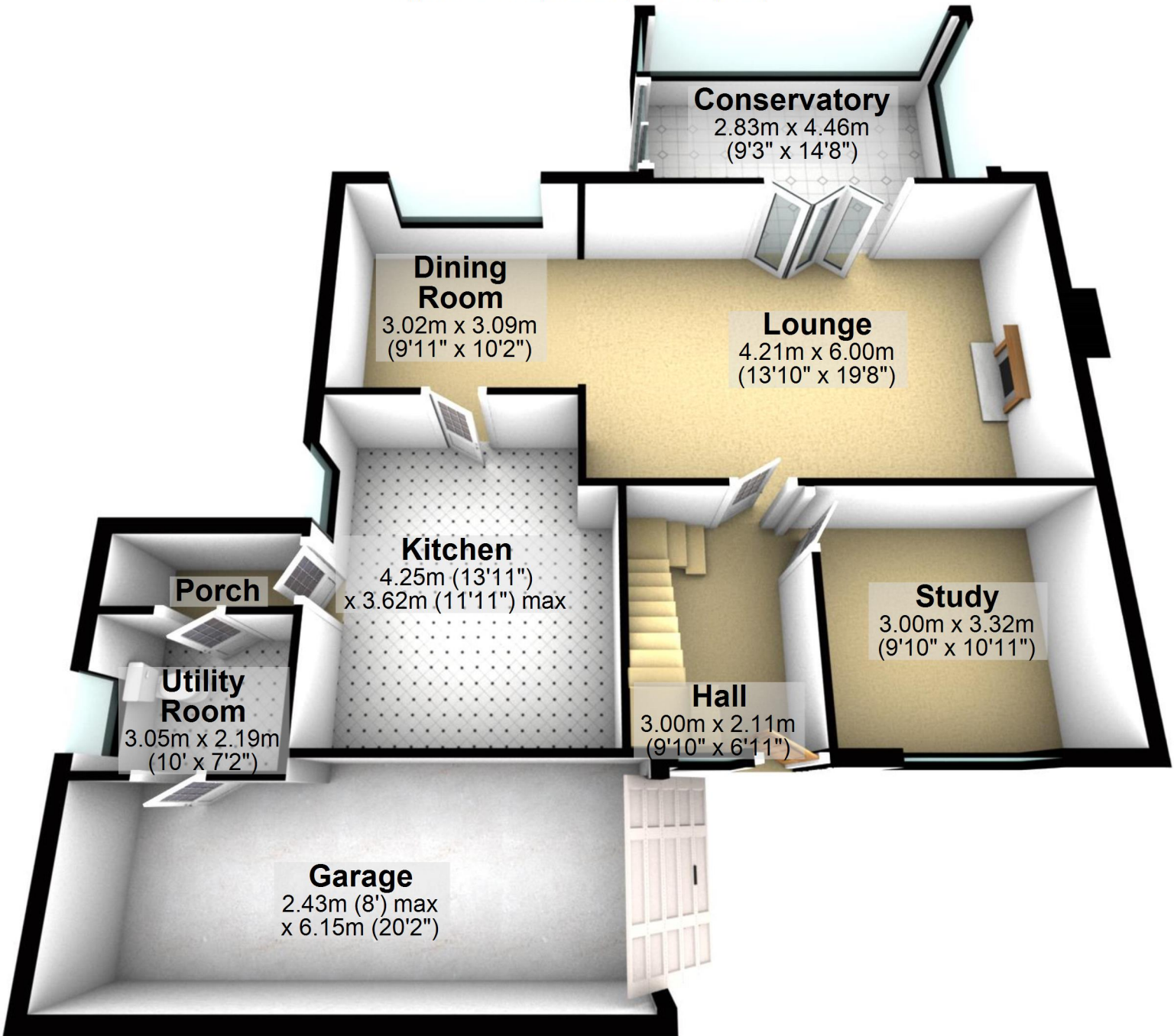

Total area: approx. 171.5 sq. metres (1846.0 sq. feet)

For illustrative purposes only. Not to scale. All sizes are approximate.  
Plan produced using PlanUp.

# First Floor

Approx. 67.0 sq. metres (721.1 sq. feet)

