

# Ground Floor

Approx. 39.2 sq. metres (422.0 sq. feet)

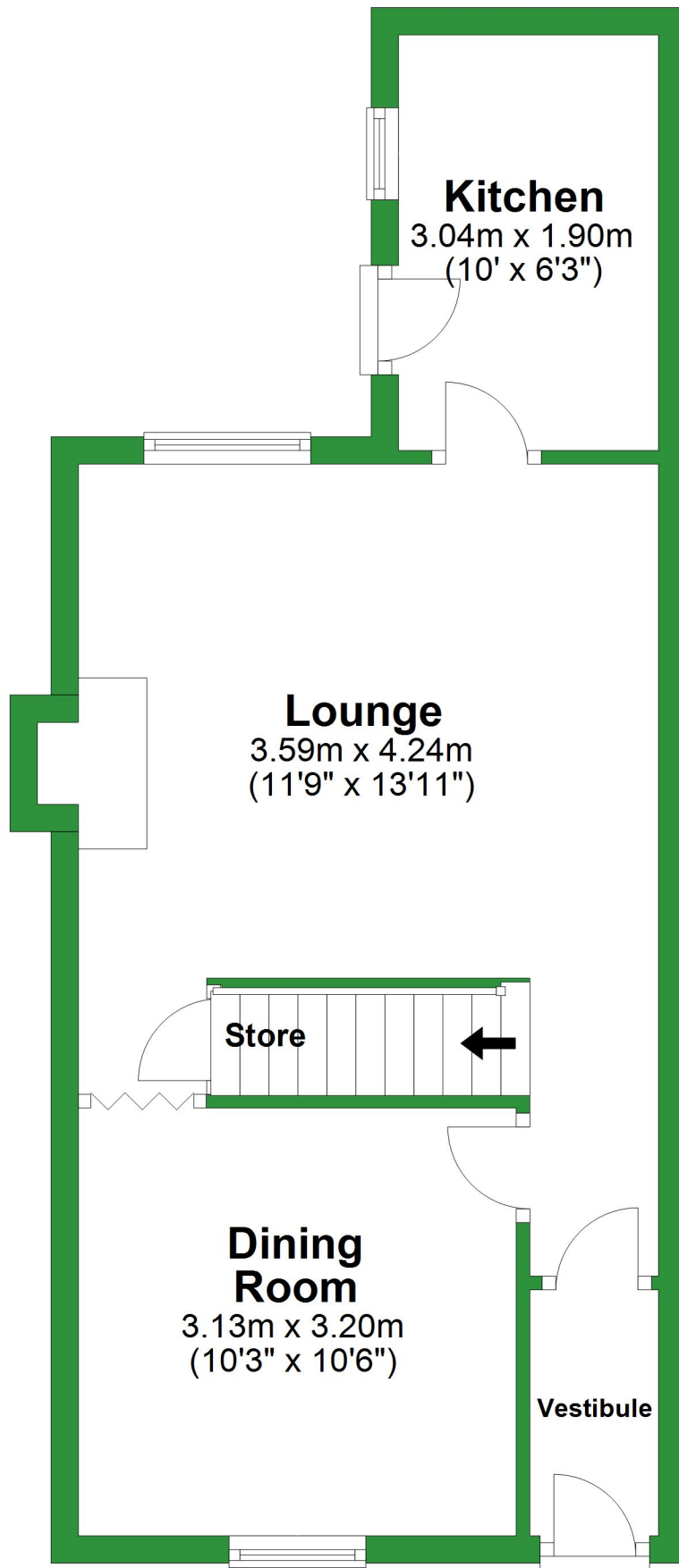

Total area: approx. 72.4 sq. metres (779.8 sq. feet)

For illustrative purposes only. Not to scale. All sizes are approximate.  
Plan produced using PlanUp.

# First Floor

Approx. 33.2 sq. metres (357.8 sq. feet)

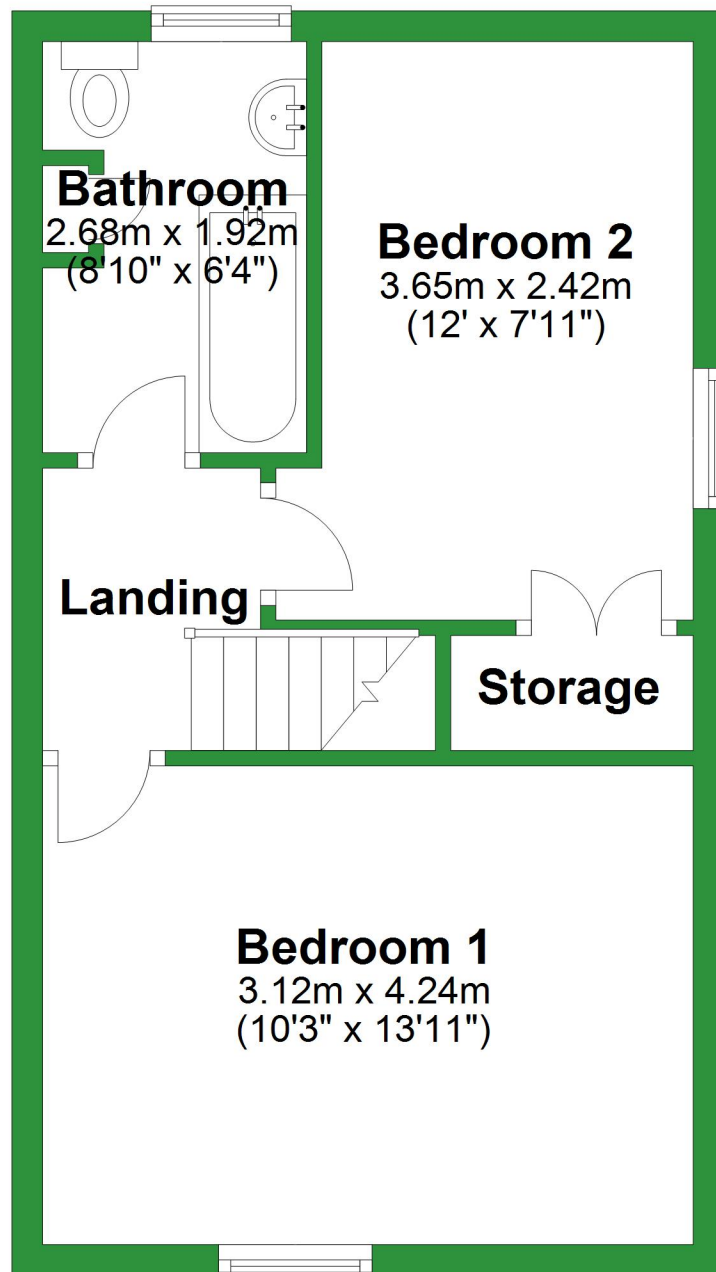

# Ground Floor

Approx. 39.2 sq. metres (422.0 sq. feet)

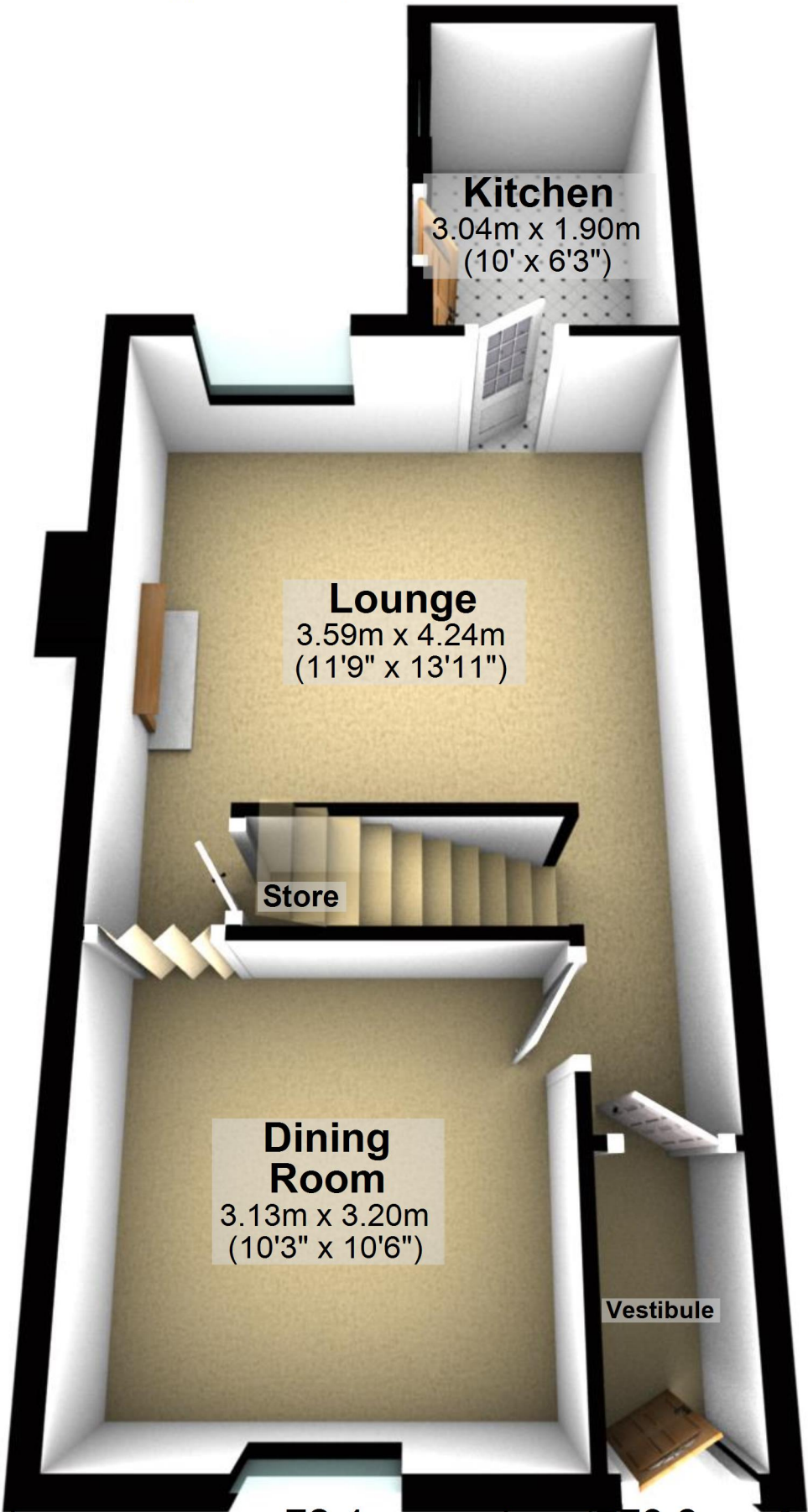

## Kitchen

3.04m x 1.90m  
(10' x 6'3")

## Lounge

3.59m x 4.24m  
(11'9" x 13'11")

## Store

## Dining Room

3.13m x 3.20m  
(10'3" x 10'6")

## Vestibule

Total area: approx. 72.4 sq. metres (779.8 sq. feet)

For illustrative purposes only. Not to scale. All sizes are approximate.

Plan produced using PlanUp.

# First Floor

Approx. 33.2 sq. metres (357.8 sq. feet)

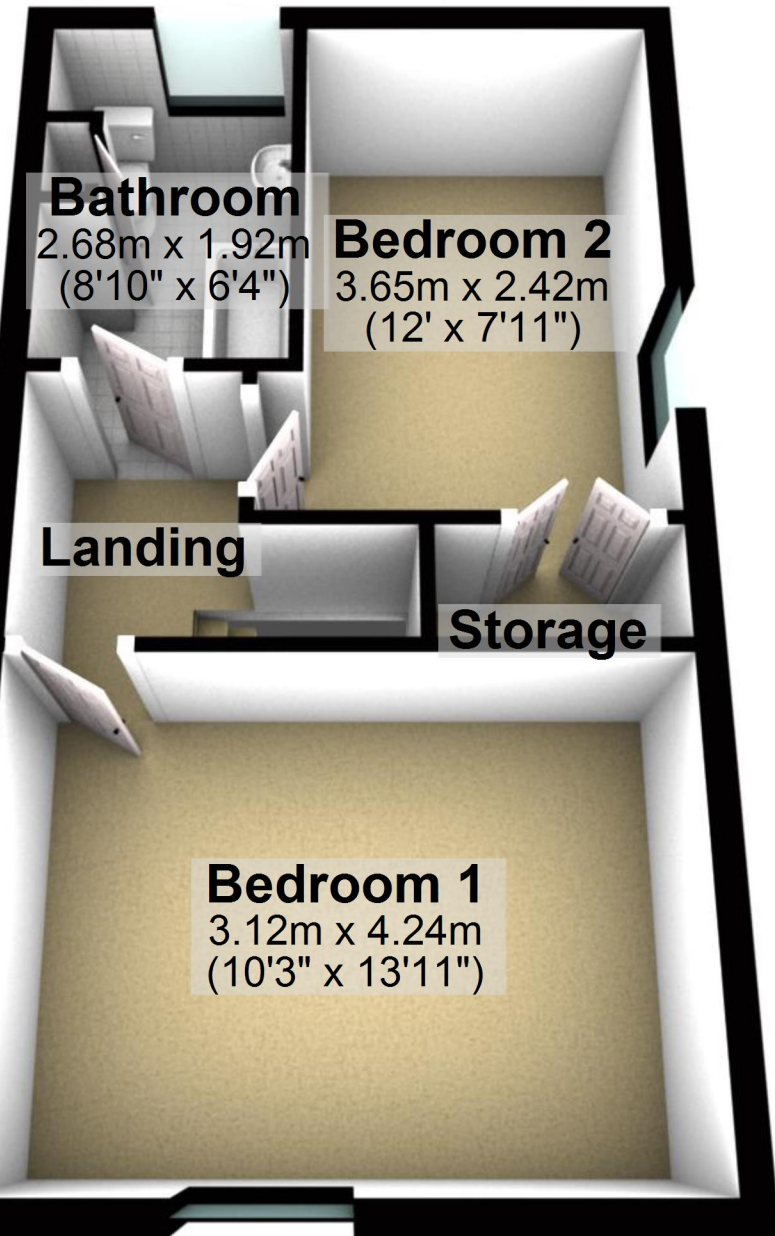

## Bathroom

2.68m x 1.92m  
(8'10" x 6'4")

## Bedroom 2

3.65m x 2.42m  
(12' x 7'11")

## Landing

## Storage

## Bedroom 1

3.12m x 4.24m  
(10'3" x 13'11")