

# Ground Floor

Approx. 42.7 sq. metres (460.0 sq. feet)

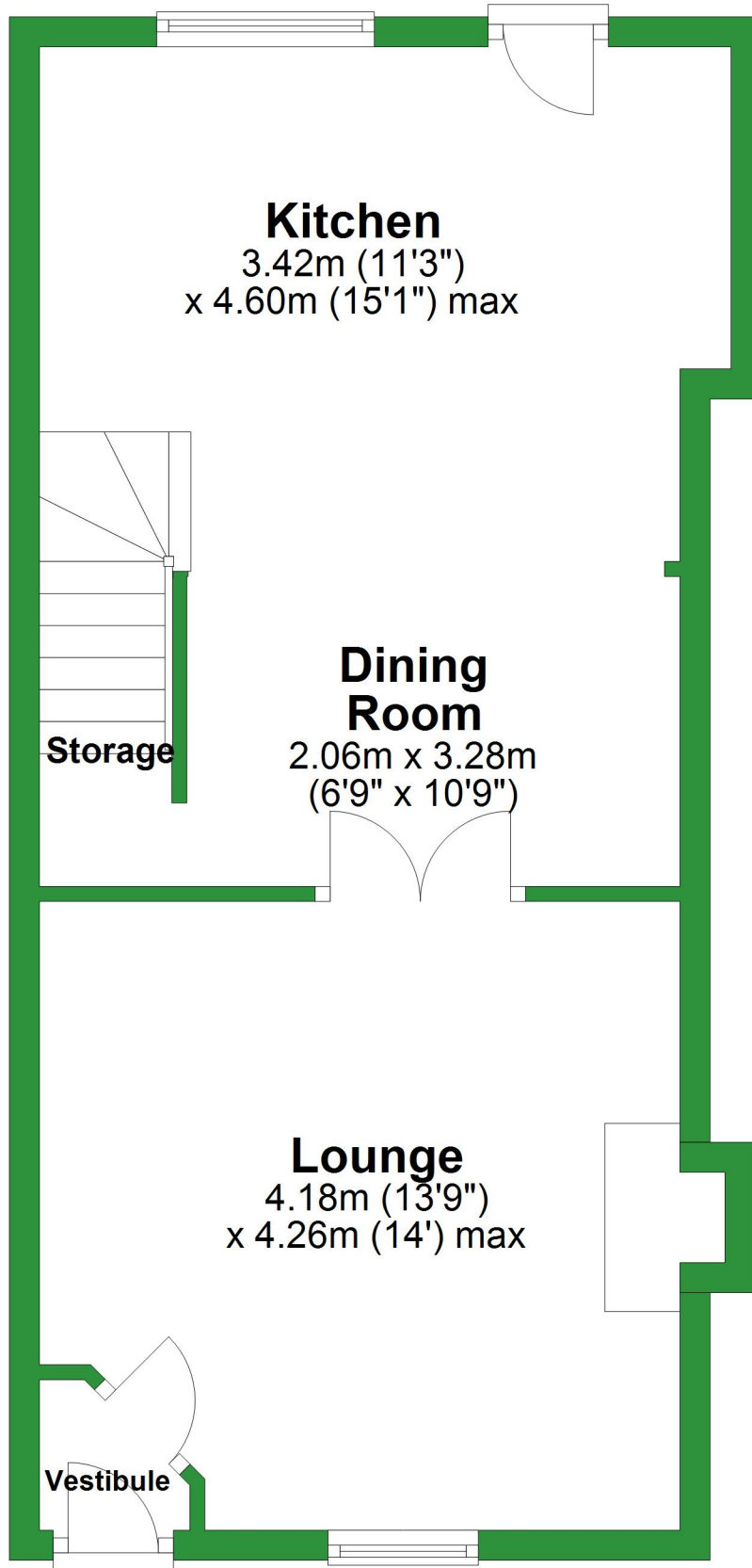

Total area: approx. 85.5 sq. metres (919.9 sq. feet)

For illustrative purposes only. Not to scale. All sizes are approximate.  
Plan produced using PlanUp.

# First Floor

Approx. 42.7 sq. metres (460.0 sq. feet)

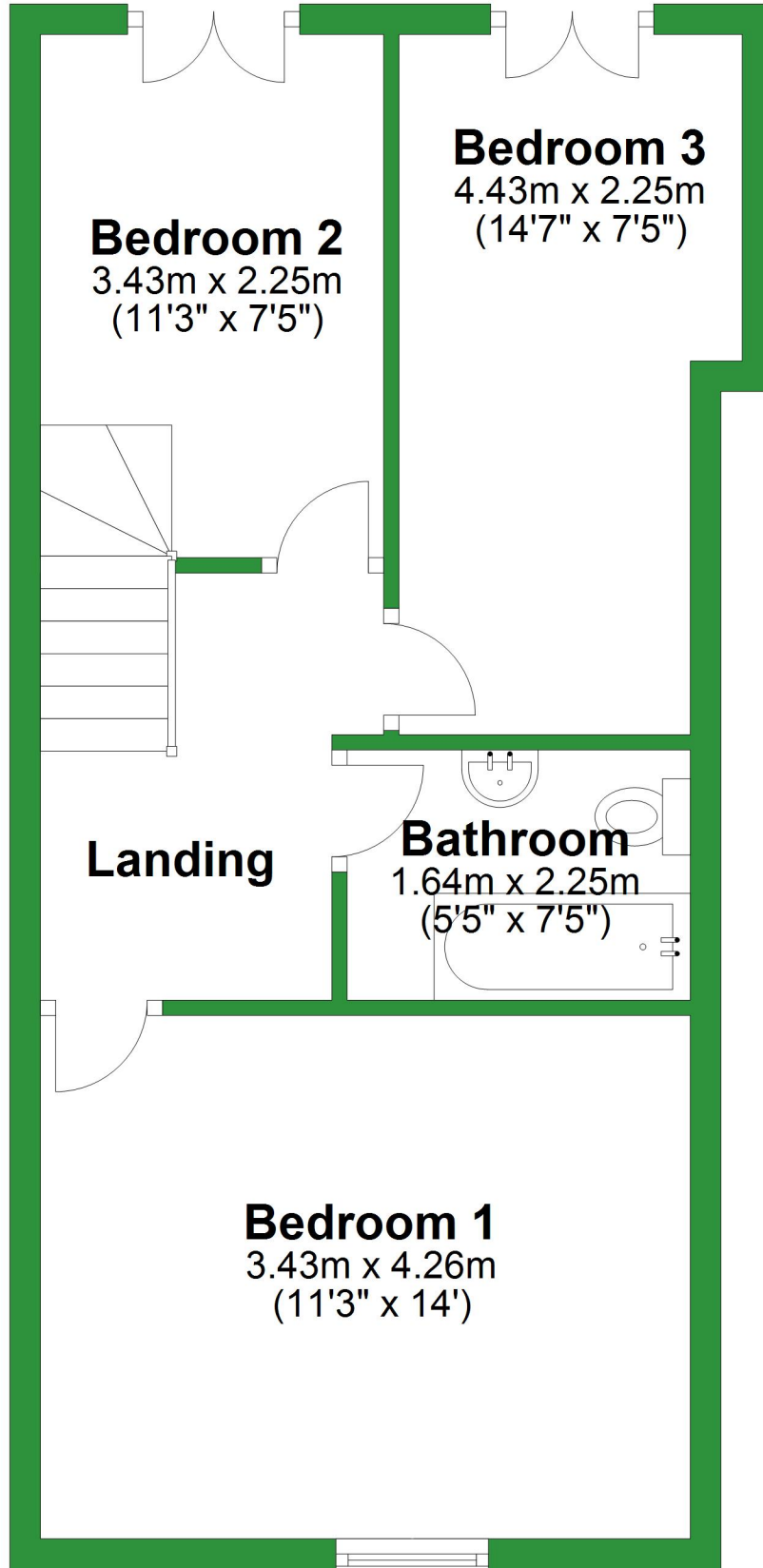

# Ground Floor

Approx. 42.7 sq. metres (460.0 sq. feet)

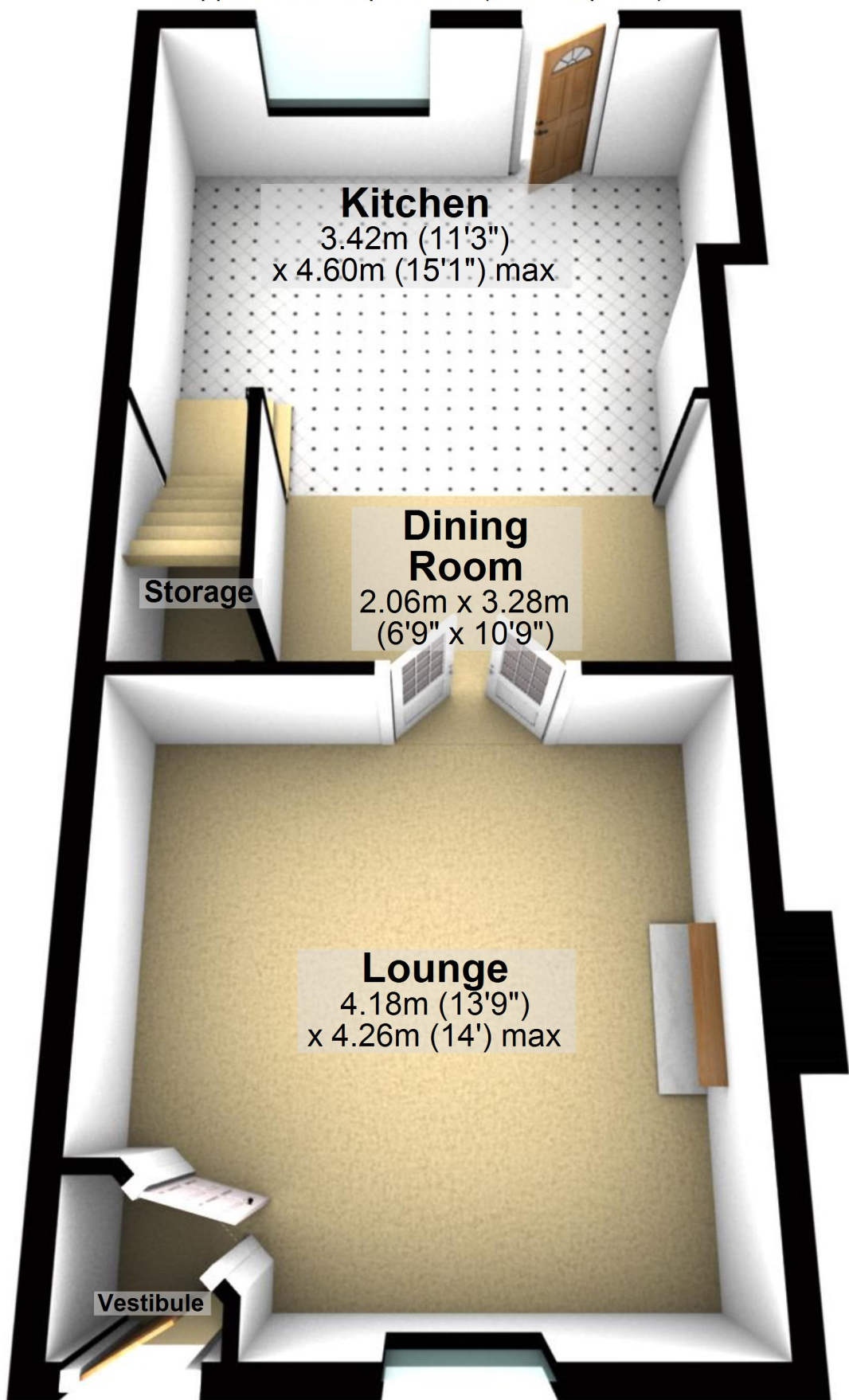

Total area: approx. 85.5 sq. metres (919.9 sq. feet)

For illustrative purposes only. Not to scale. All sizes are approximate.

Plan produced using PlanUp.

# First Floor

Approx. 42.7 sq. metres (460.0 sq. feet)

**Bedroom 2**  
3.43m x 2.25m  
(11'3" x 7'5")

**Bedroom 3**  
4.43m x 2.25m  
(14'7" x 7'5")

**Landing**

**Bathroom**  
1.64m x 2.25m  
(5'5" x 7'5")

**Bedroom 1**  
3.43m x 4.26m  
(11'3" x 14')

