

# Ground Floor

Approx. 57.8 sq. metres (622.6 sq. feet)

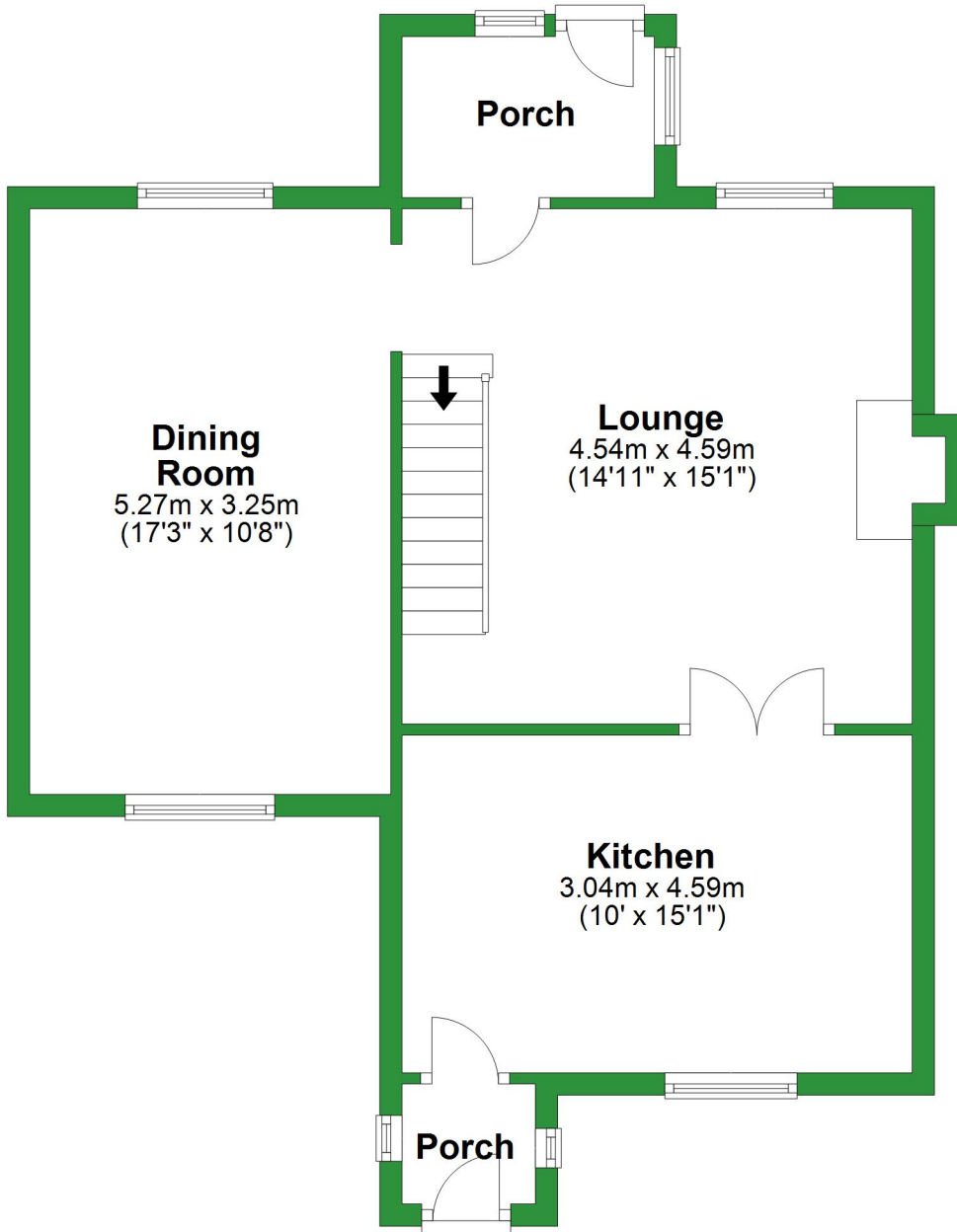

Total area: approx. 111.2 sq. metres (1196.8 sq. feet)

For illustrative purposes only. Not to scale. All sizes are approximate.

Plan produced using PlanUp.

# First Floor

Approx. 53.4 sq. metres (574.3 sq. feet)

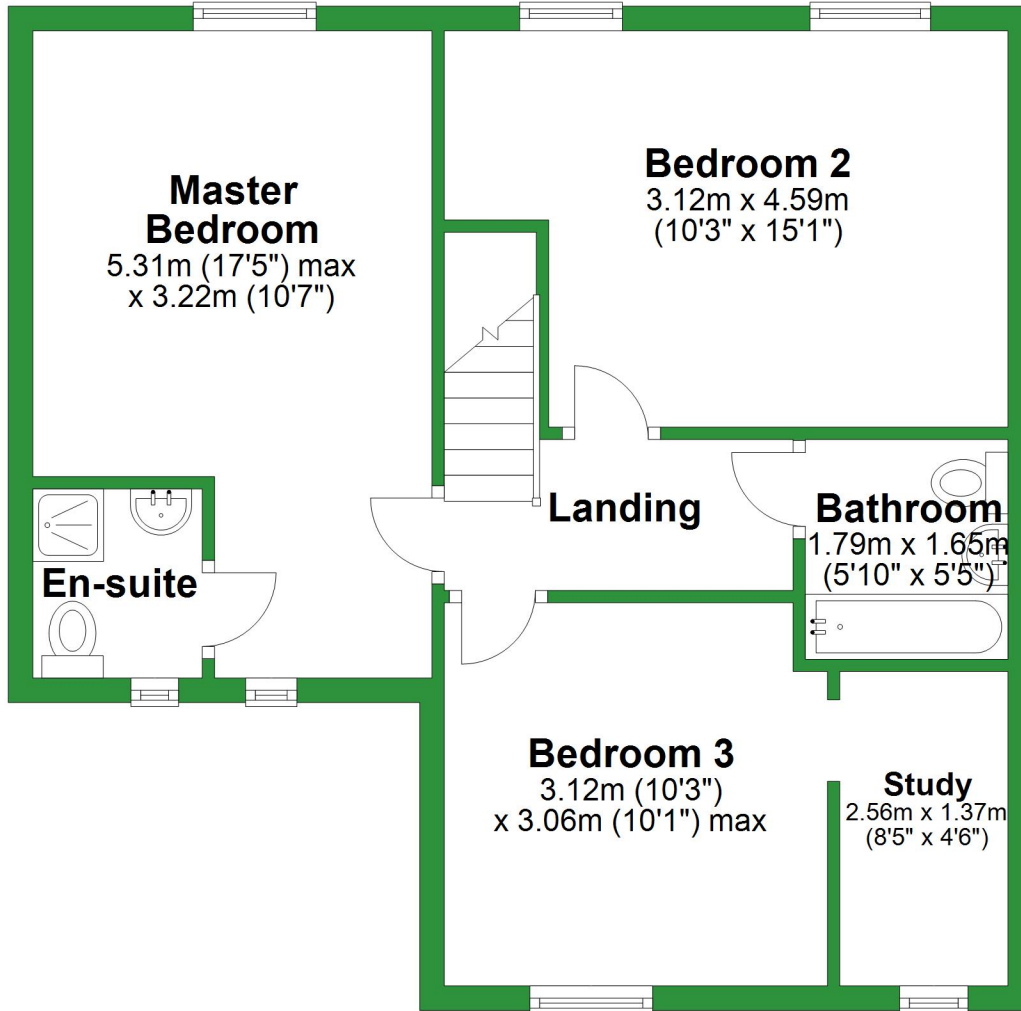

# Ground Floor

Approx. 57.8 sq. metres (622.6 sq. feet)



Total area: approx. 111.2 sq. metres (1196.8 sq. feet)

For illustrative purposes only. Not to scale. All sizes are approximate.

Plan produced using PlanUp.

# First Floor

Approx. 53.4 sq. metres (574.3 sq. feet)

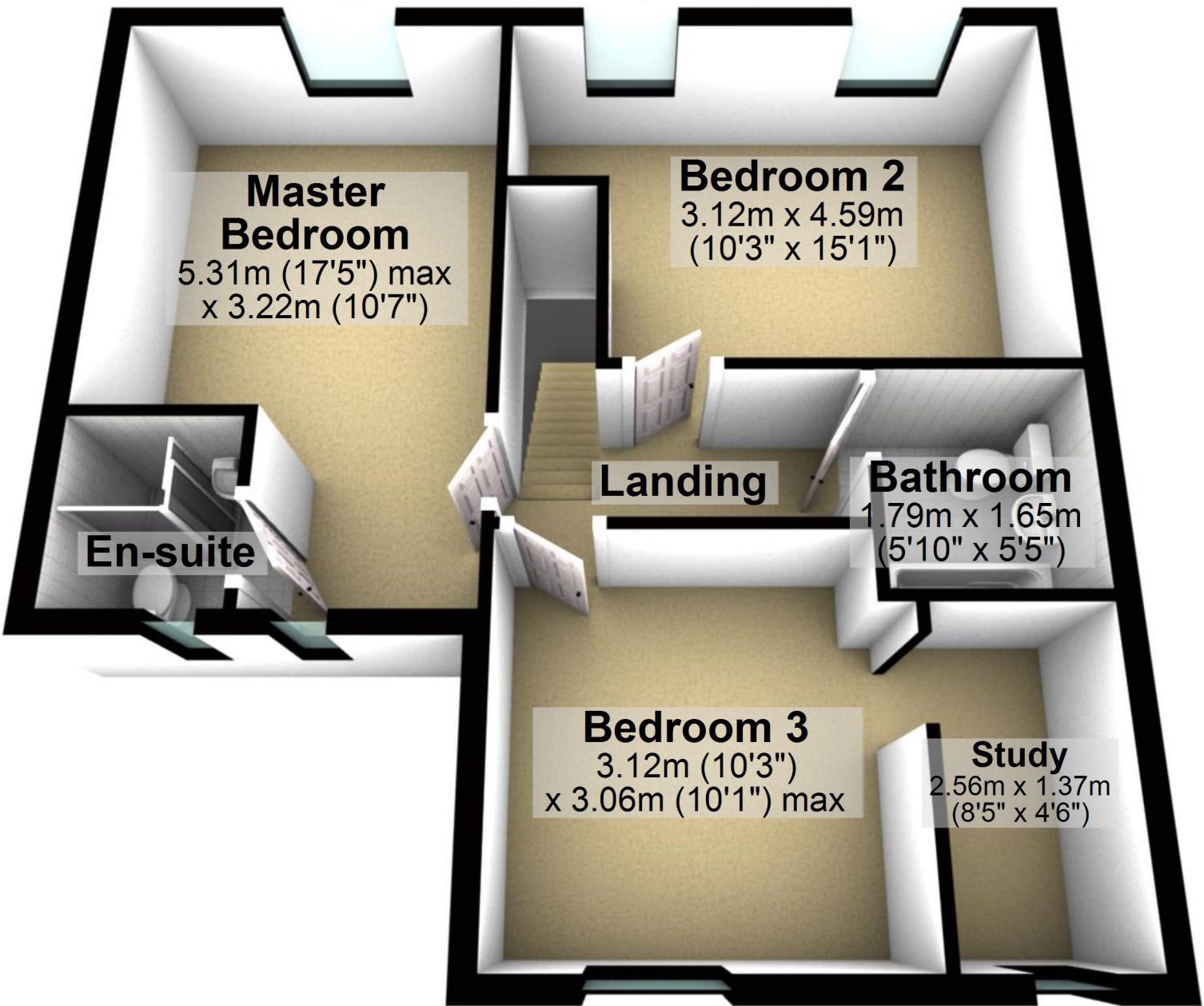

**Master Bedroom**  
5.31m (17'5") max  
x 3.22m (10'7")

**Bedroom 2**  
3.12m x 4.59m  
(10'3" x 15'1")

**En-suite**

**Landing**

**Bathroom**  
1.79m x 1.65m  
(5'10" x 5'5")

**Bedroom 3**  
3.12m (10'3")  
x 3.06m (10'1") max

**Study**  
2.56m x 1.37m  
(8'5" x 4'6")