

# Ground Floor

Approx. 36.9 sq. metres (396.7 sq. feet)

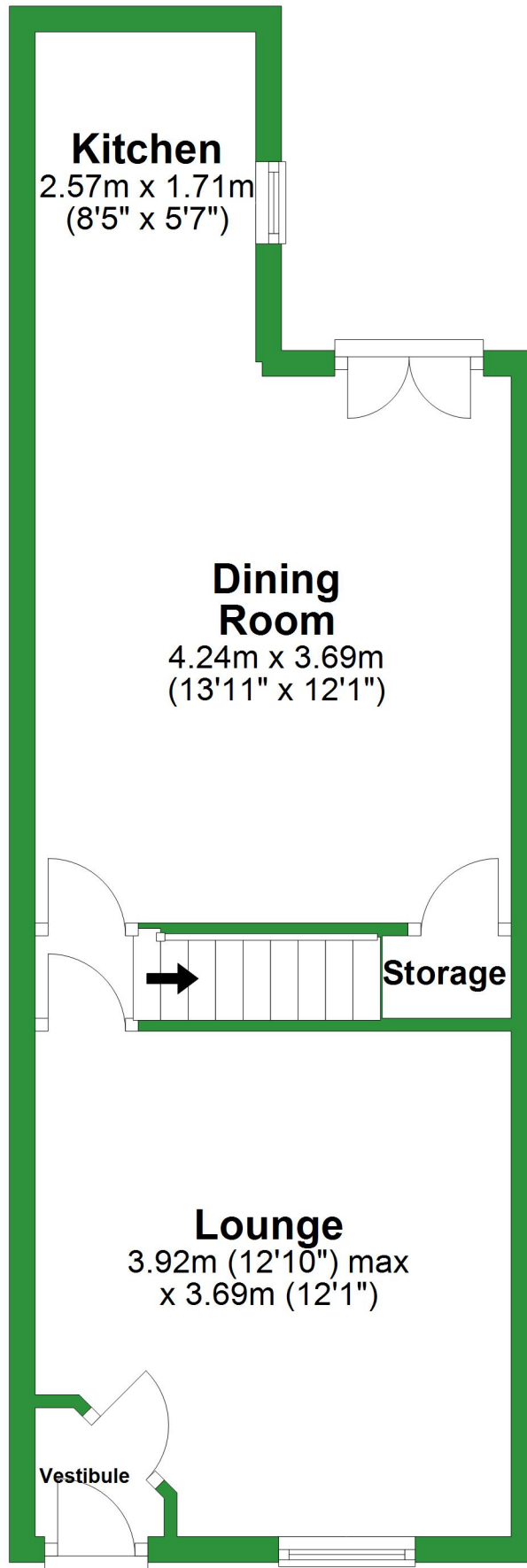

Total area: approx. 70.1 sq. metres (754.2 sq. feet)

For illustrative purposes only. Not to scale. All sizes are approximate.  
Plan produced using PlanUp.

# First Floor

Approx. 33.2 sq. metres (357.5 sq. feet)

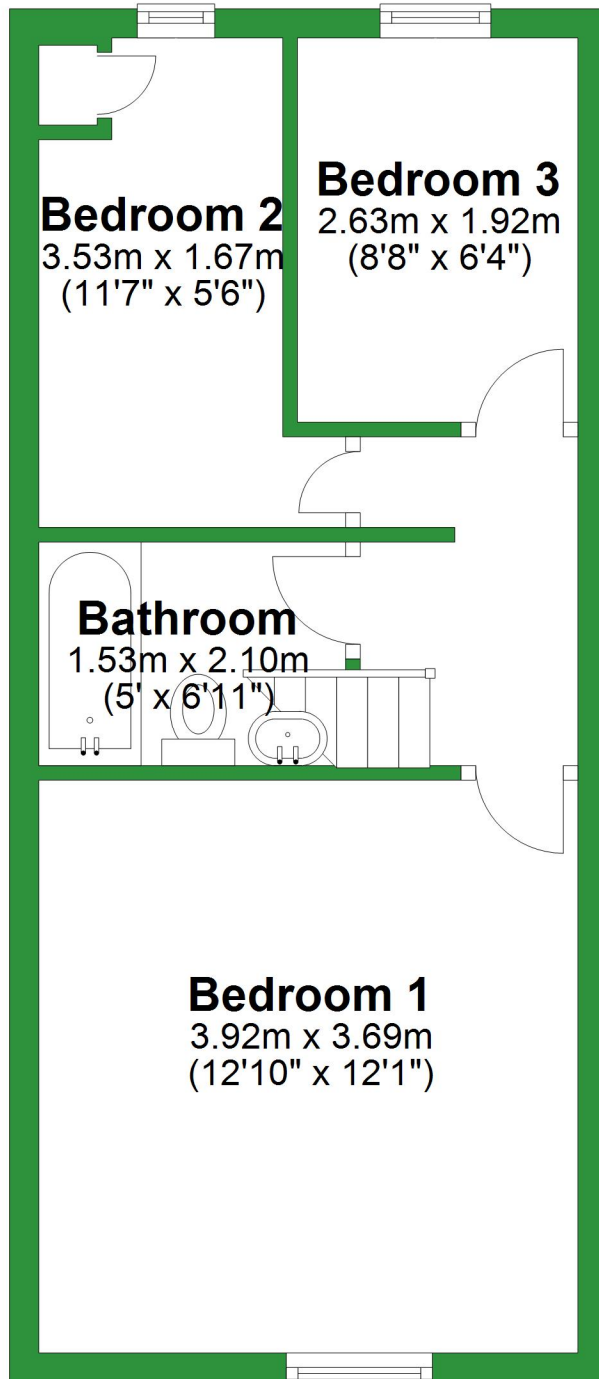

# Ground Floor

Approx. 36.9 sq. metres (396.7 sq. feet)

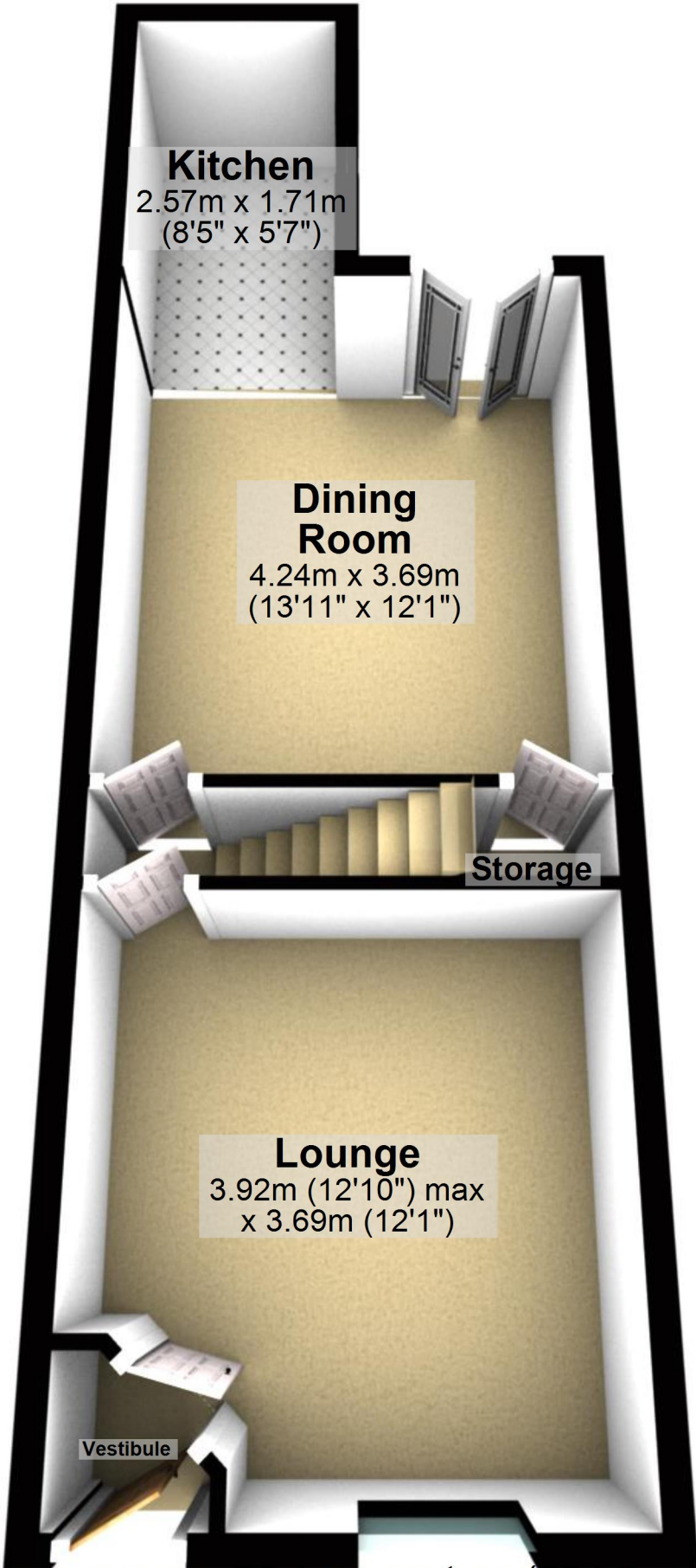

Total area: approx. 70.1 sq. metres (754.2 sq. feet)

For illustrative purposes only. Not to scale. All sizes are approximate.

Plan produced using PlanUp.

# First Floor

Approx. 33.2 sq. metres (357.5 sq. feet)

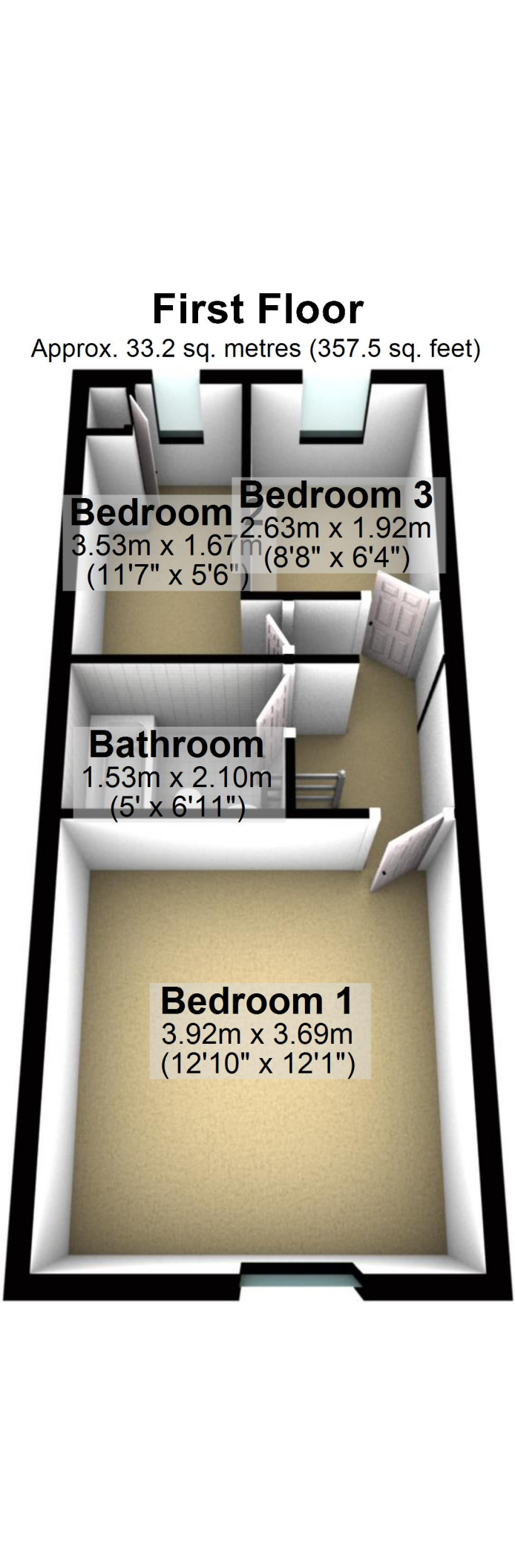

**Bedroom 3**  
2.63m x 1.92m  
(8'8" x 6'4")

**Bedroom 2**  
3.53m x 1.67m  
(11'7" x 5'6")

The floor plan shows a rectangular layout with a large bedroom at the bottom, a bathroom in the middle, and two smaller bedrooms at the top. A central hallway provides access to all rooms. There are two windows at the top and one at the bottom. The walls are white, and the floor is a light tan color. Doors are shown in an open position.

**Bathroom**  
1.53m x 2.10m  
(5' x 6'11")

**Bedroom 1**  
3.92m x 3.69m  
(12'10" x 12'1")