

# Ground Floor

Approx. 39.5 sq. metres (425.2 sq. feet)

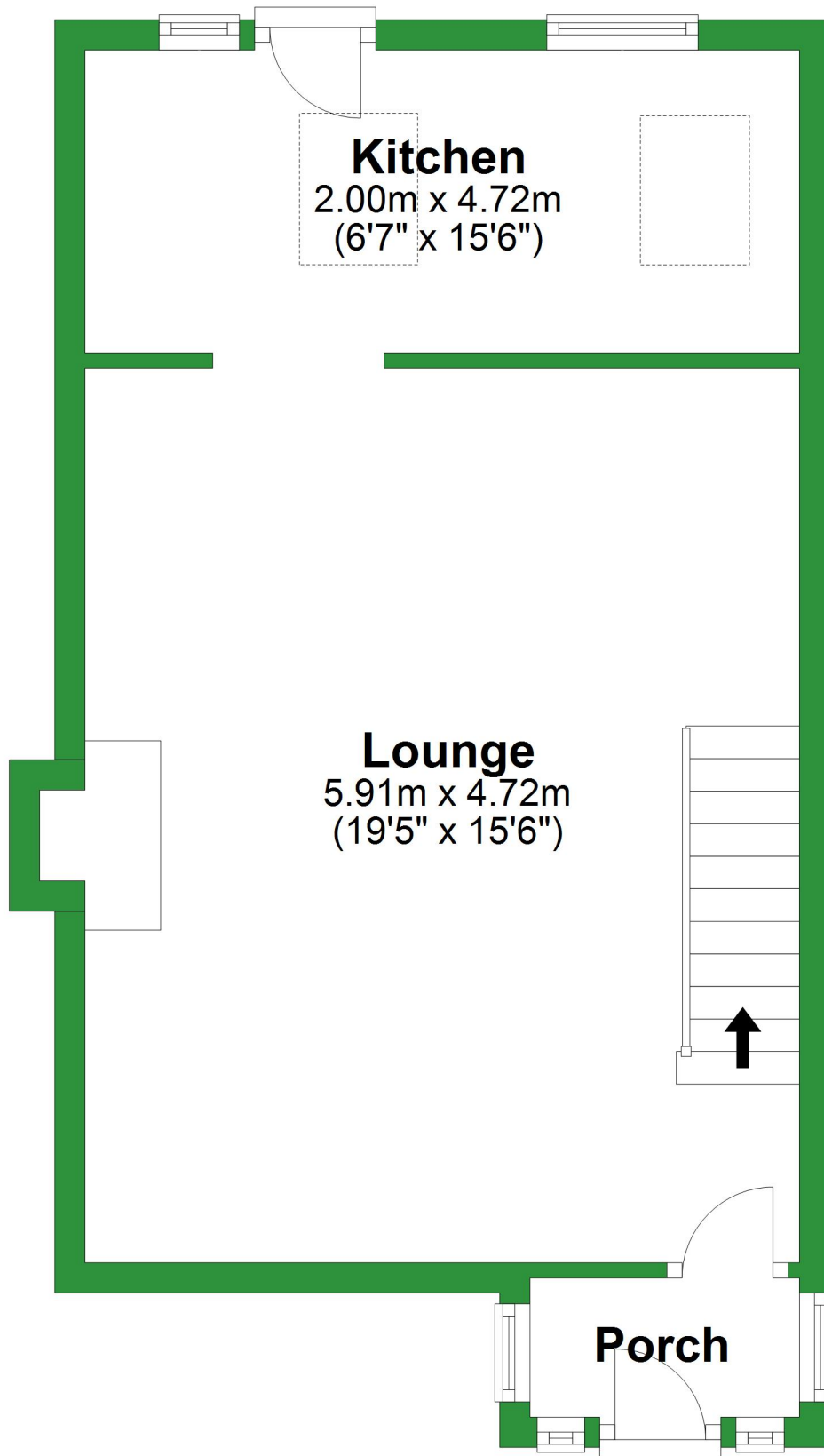

Total area: approx. 70.9 sq. metres (762.9 sq. feet)

For illustrative purposes only. Not to scale. All sizes are approximate.

Plan produced using PlanUp.

# First Floor

Approx. 31.4 sq. metres (337.7 sq. feet)

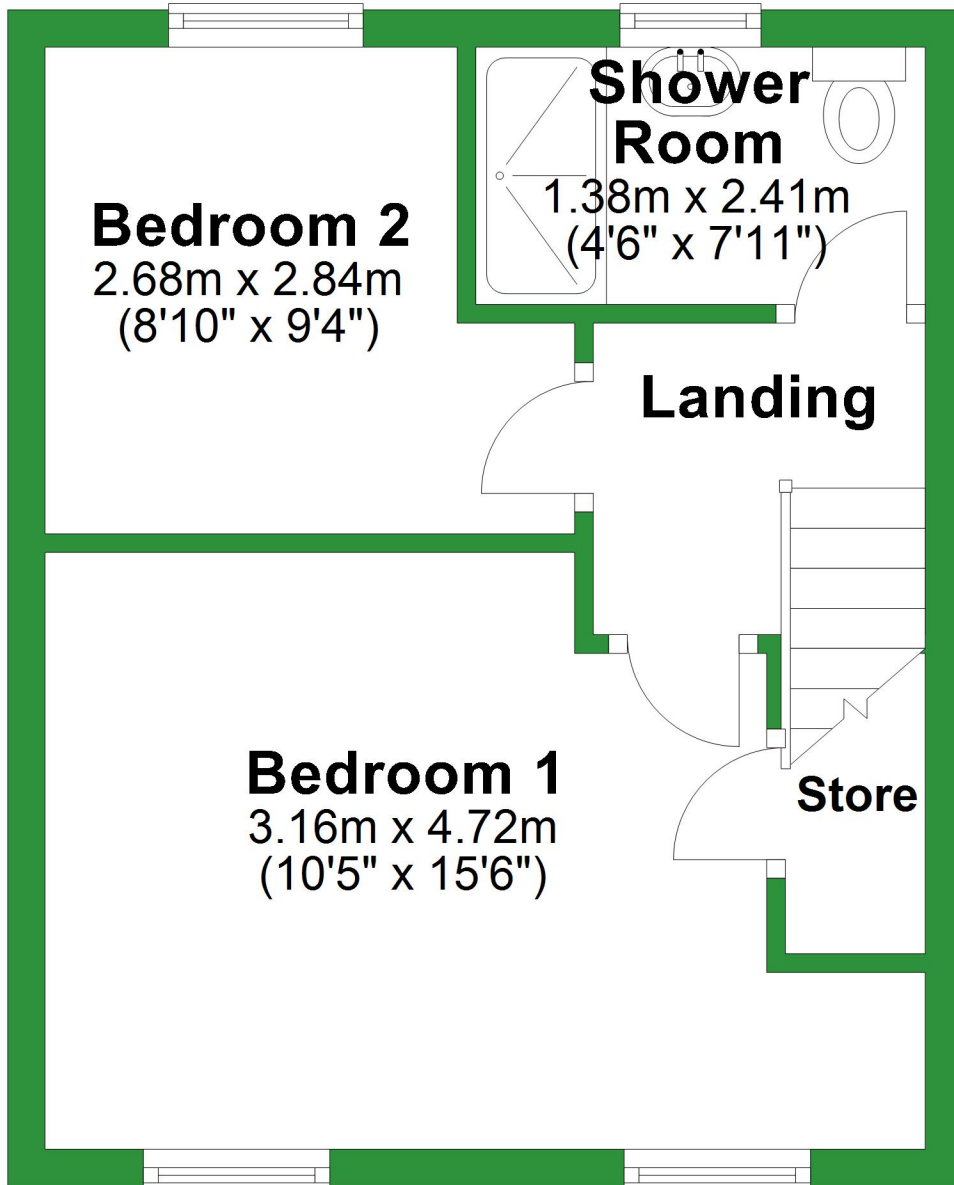

# Ground Floor

Approx. 39.5 sq. metres (425.2 sq. feet)

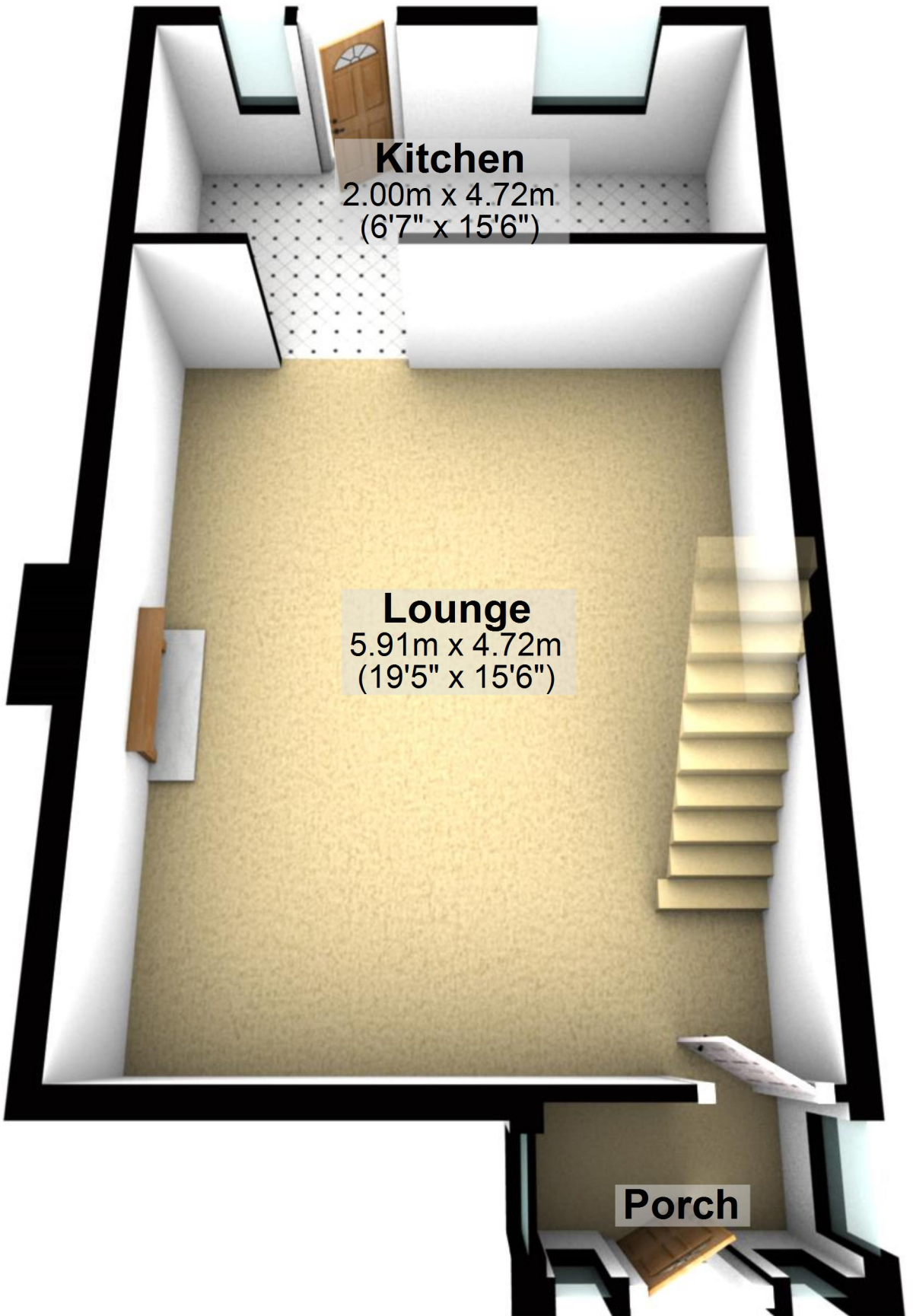

Total area: approx. 70.9 sq. metres (762.9 sq. feet)

For illustrative purposes only. Not to scale. All sizes are approximate.

Plan produced using PlanUp.

# First Floor

Approx. 31.4 sq. metres (337.7 sq. feet)

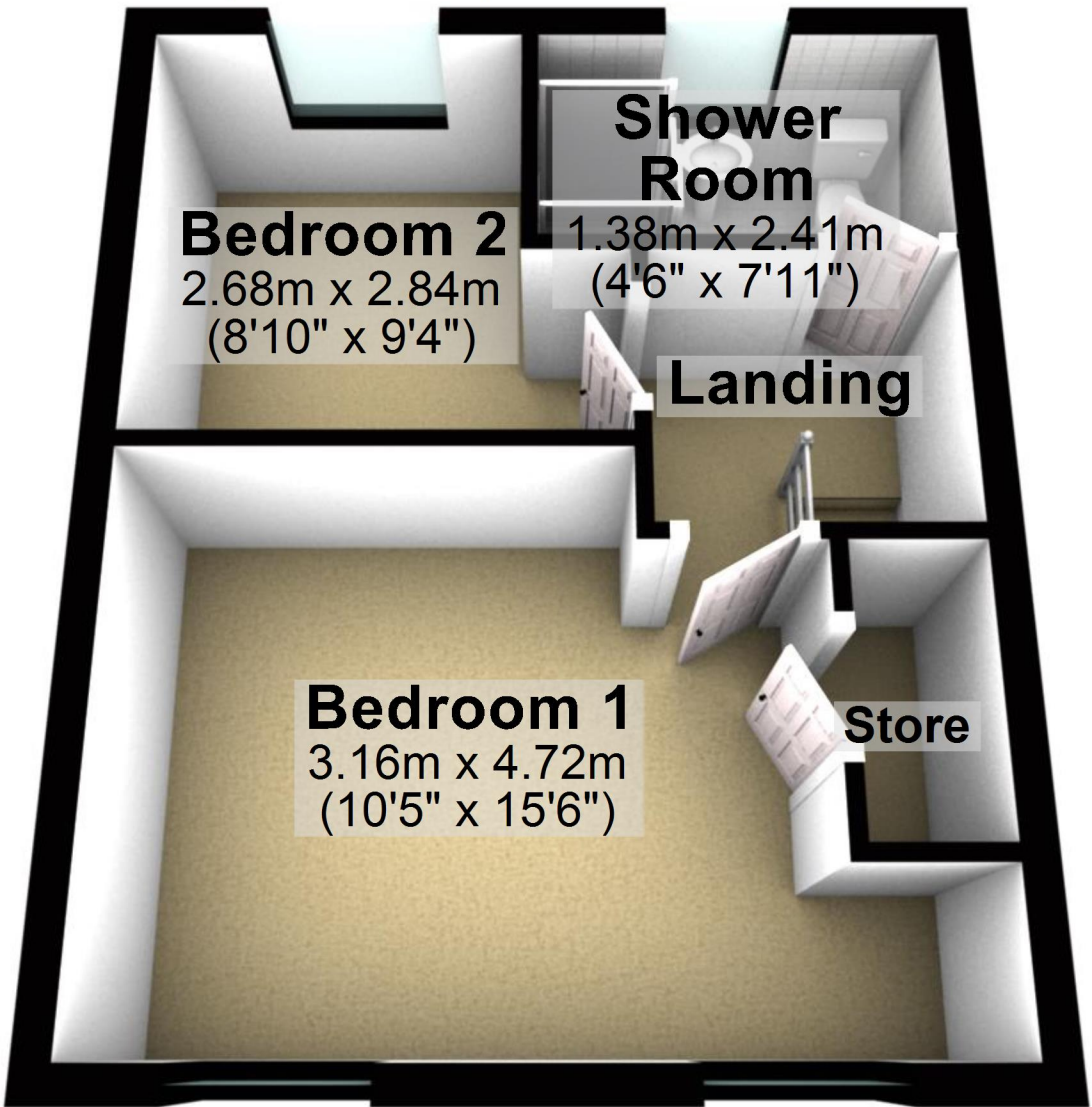

**Bedroom 2**  
2.68m x 2.84m  
(8'10" x 9'4")

**Shower Room**

1.38m x 2.41m  
(4'6" x 7'11")

**Landing**

**Bedroom 1**  
3.16m x 4.72m  
(10'5" x 15'6")

**Store**