

# Ground Floor

Approx. 39.6 sq. metres (425.8 sq. feet)

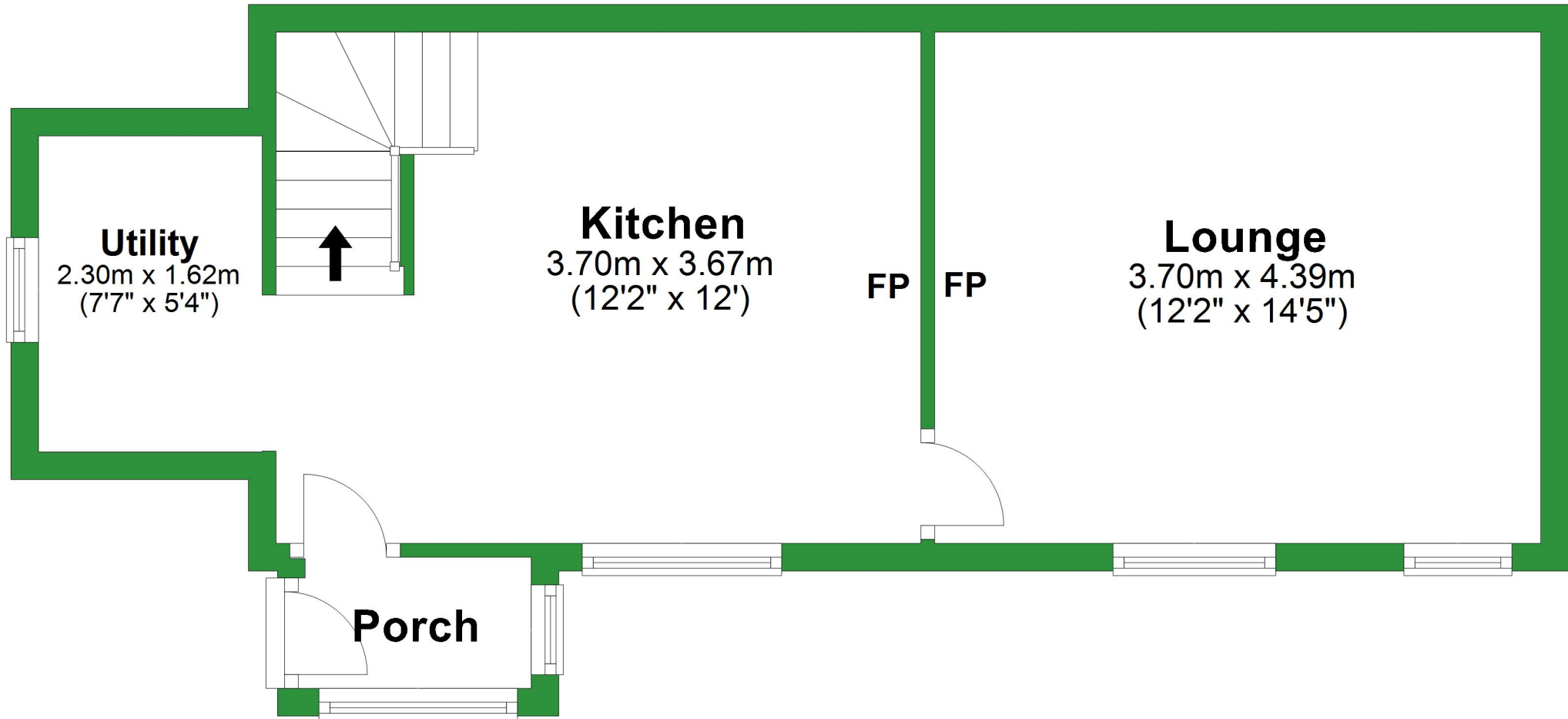

Total area: approx. 111.3 sq. metres (1197.8 sq. feet)

For illustrative purposes only. Not to scale. All sizes are approximate.  
Plan produced using PlanUp.

# First Floor

Approx. 37.8 sq. metres (407.2 sq. feet)

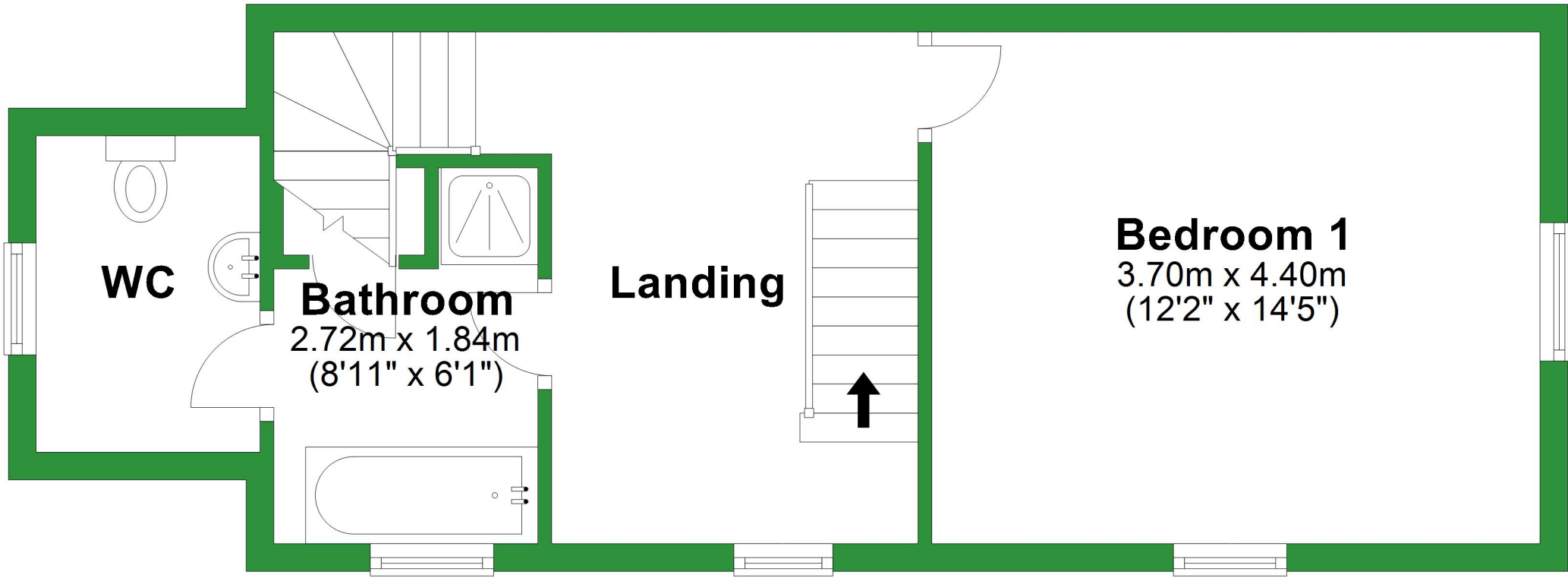

# Second Floor

Approx. 33.9 sq. metres (364.8 sq. feet)

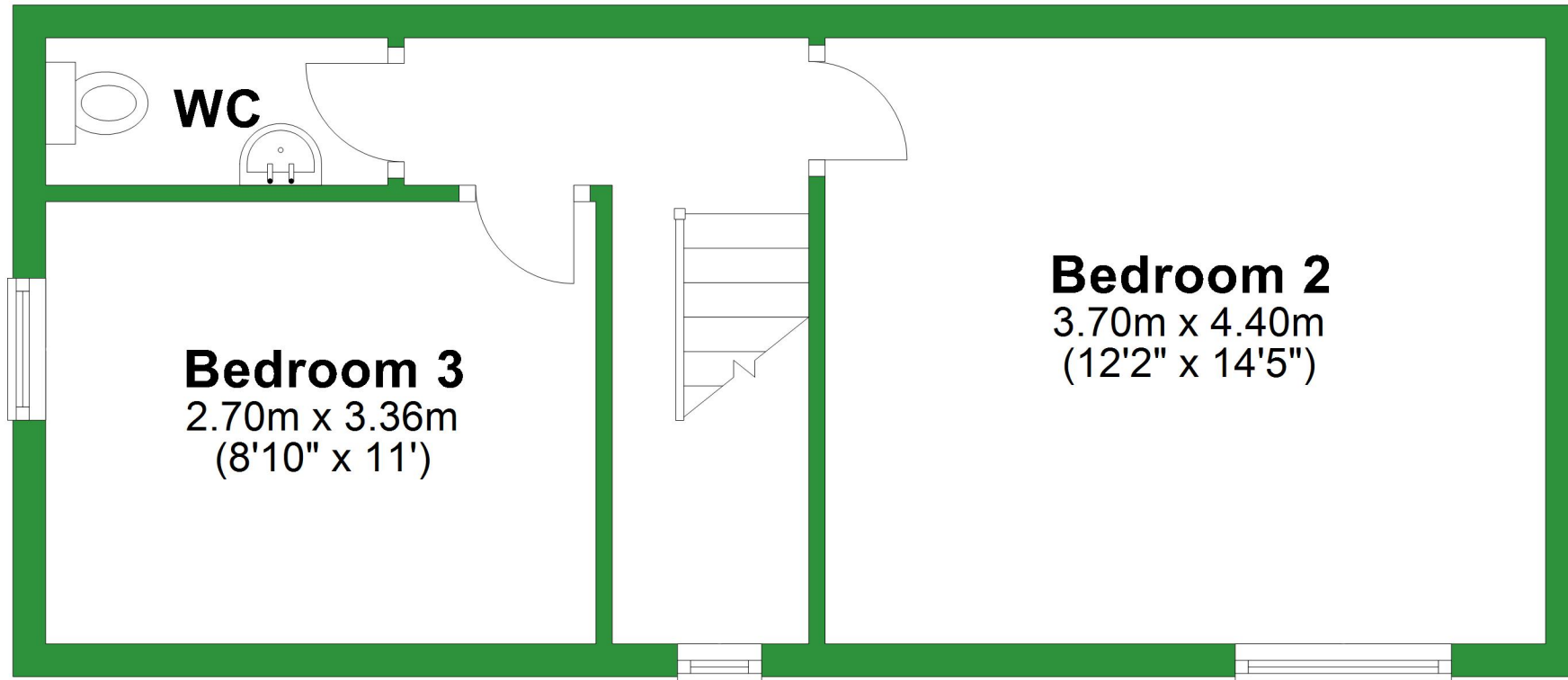

# Ground Floor

Approx. 39.6 sq. metres (425.8 sq. feet)

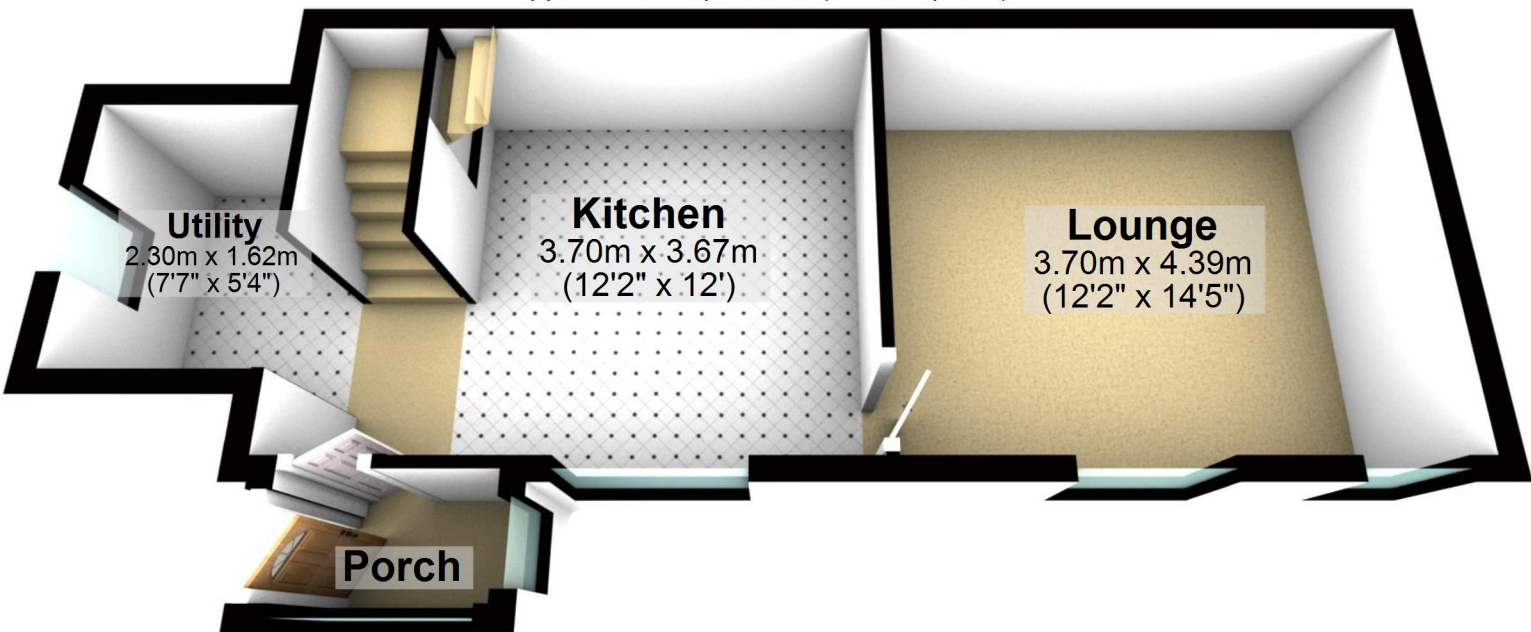

Total area: approx. 111.3 sq. metres (1197.8 sq. feet)

For illustrative purposes only. Not to scale. All sizes are approximate.  
Plan produced using PlanUp.

# First Floor

Approx. 37.8 sq. metres (407.2 sq. feet)

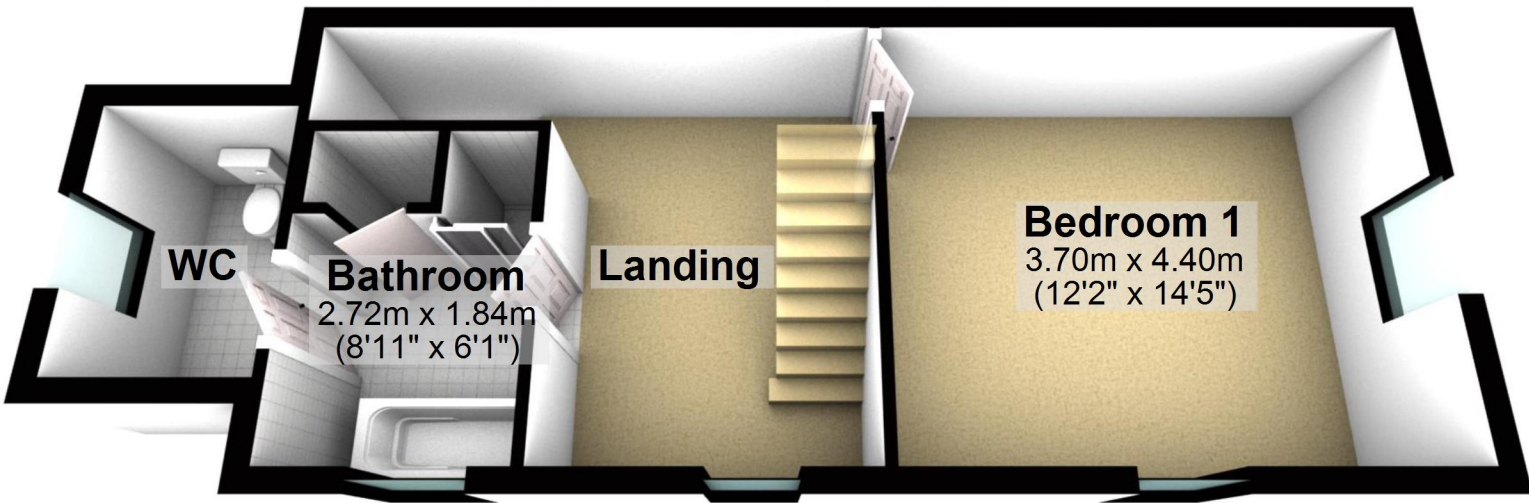

## Second Floor

Approx. 33.9 sq. metres (364.8 sq. feet)

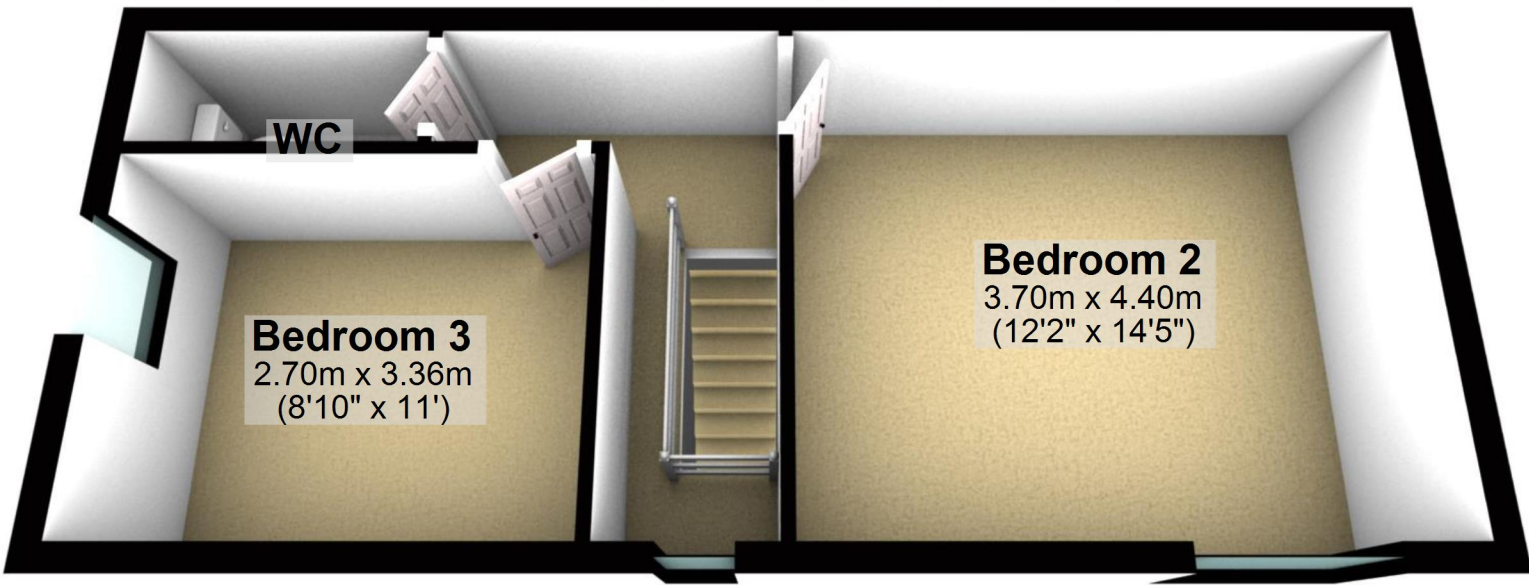

**WC**

**Bedroom 3**  
2.70m x 3.36m  
(8'10" x 11')

**Bedroom 2**  
3.70m x 4.40m  
(12'2" x 14'5")