

# Ground Floor

Approx. 44.6 sq. metres (480.2 sq. feet)

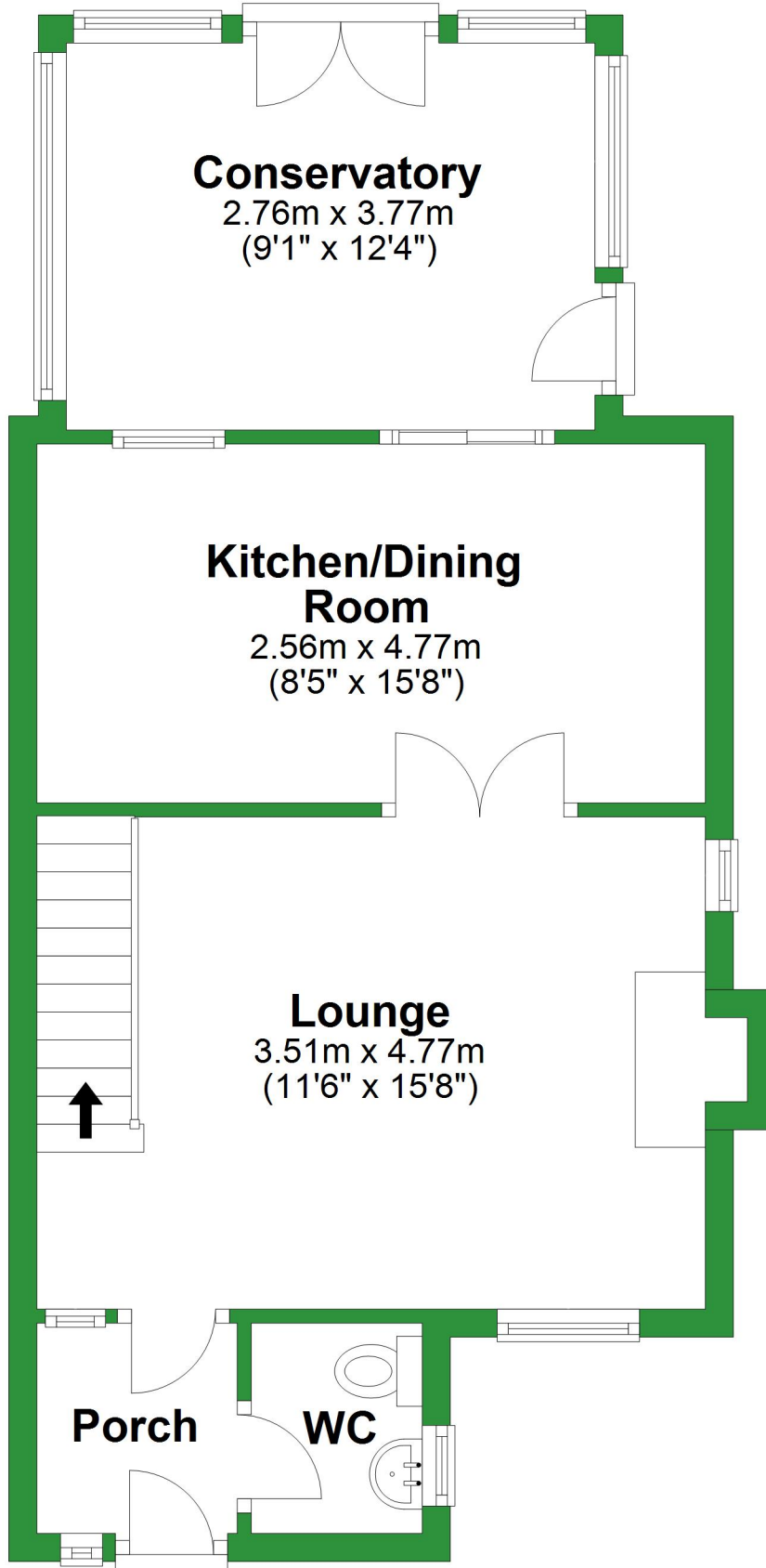

Total area: approx. 74.0 sq. metres (797.0 sq. feet)

For illustrative purposes only. Not to scale. All sizes are approximate.

Plan produced using PlanUp.

# First Floor

Approx. 29.4 sq. metres (316.8 sq. feet)

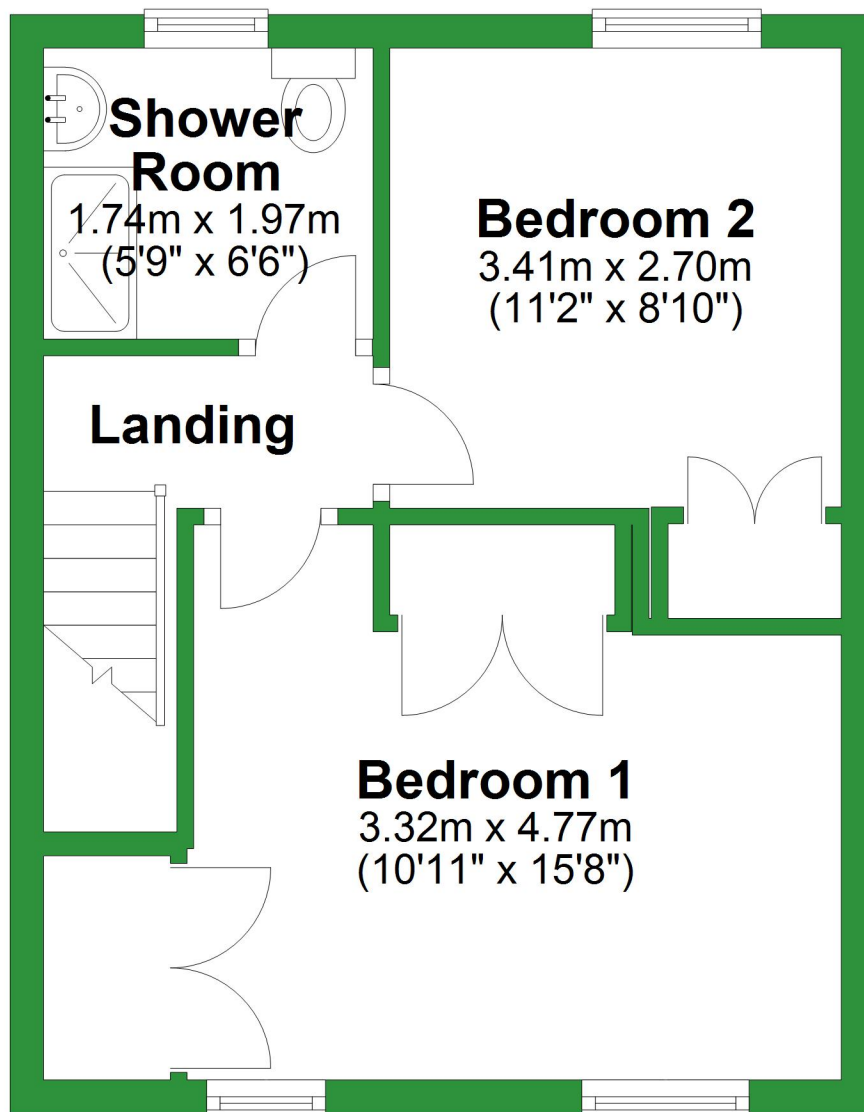

# Ground Floor

Approx. 44.6 sq. metres (480.2 sq. feet)

## Conservatory

2.76m x 3.77m  
(9'1" x 12'4")

## Kitchen/Dining Room

2.56m x 4.77m  
(8'5" x 15'8")

## Lounge

3.51m x 4.77m  
(11'6" x 15'8")

Porch

WC

Total area: approx. 74.0 sq. metres (797.0 sq. feet)

For illustrative purposes only. Not to scale. All sizes are approximate.

Plan produced using PlanUp.

# First Floor

Approx. 29.4 sq. metres (316.8 sq. feet)

## Shower Room

1.74m x 1.97m  
(5'9" x 6'6")

## Bedroom 2

3.41m x 2.70m  
(11'2" x 8'10")

## Landing

## Bedroom 1

3.32m x 4.77m  
(10'11" x 15'8")

