

## Ground Floor

Approx. 129.4 sq. metres (1392.7 sq. feet)

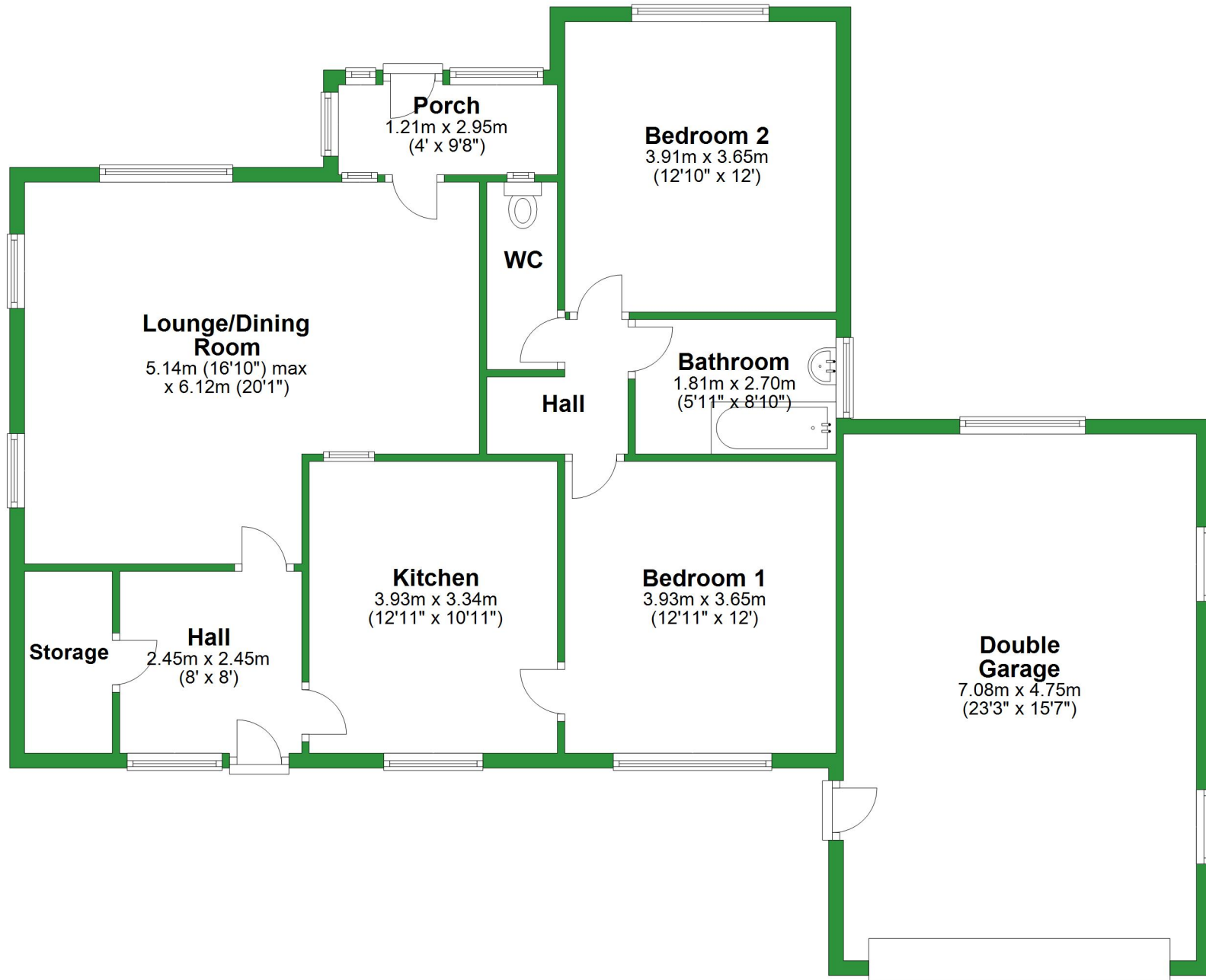

Total area: approx. 129.4 sq. metres (1392.7 sq. feet)

For illustrative purposes only. Not to scale. All sizes are approximate.  
Plan produced using PlanUp.

## Ground Floor

Approx. 129.4 sq. metres (1392.7 sq. feet)

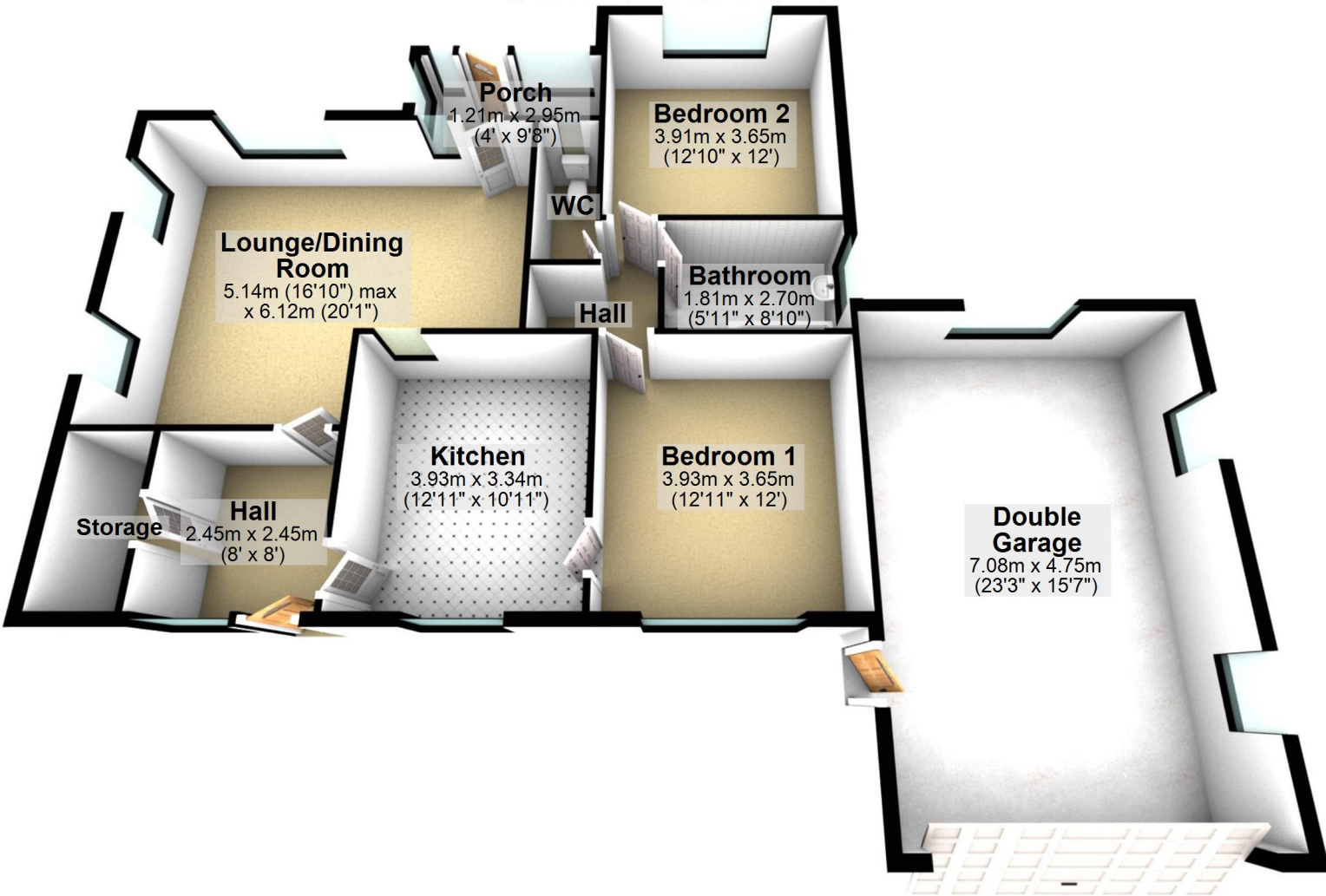

Total area: approx. 129.4 sq. metres (1392.7 sq. feet)

For illustrative purposes only. Not to scale. All sizes are approximate.  
Plan produced using PlanUp.